



**DEPARTMENT OF NATURAL RESOURCES
STATE OF MICHIGAN
TIMBER SALE PROSPECTUS #7368**

SCHEDULED SALE DATE AND TIME: **9:00 a.m. (local time) on January 9, 2024.**

LOCATION: **GAYLORD MGMT UNIT, 1732 WEST M 32, GAYLORD, MI 49735.**

CONTACT NAME: Lucas Merrick

PHONE NUMBER: (989) 732-3541

PROSPECTUS NOTE: All bid openings for the Gaylord Management Unit (Gaylord Field Office and Indian River Field Office) will be held at the Gaylord Field Office regardless of sale location within the unit. All payments and contract executions will now be handled through the Gaylord Field Office. The Indian River Field Office will no longer accept payments or hard paper copies of timber sale bids. Payments for all contracts, use permits, bonds, etc. should be sent to the Gaylord Field Office.

The bidder is advised to inspect the sale area and review the location, estimated volumes, operating costs and contract terms of proposed sales. Please be aware that some landowners may request 60 days or more notice for access across their land.

Notice is hereby given that bids will be received by the Unit Manager, GAYLORD MANAGEMENT UNIT, for certain timber on the following described lands:

Comp 19 Hardwoods (52-020-23) / T29N, R03W, SEC. 26, SWSW.

T29N, R03W, SEC. 27, NW,S1/2SE.

T29N, R03W, SEC. 35, W1/2NW.

Otsego County, Advertised Price \$126,546.30, 148.5 Acres, Hardwood, Sugar Maple.

SALE NOTE: Good Access off of county roads. Oak wilt restrictions with exceptions apply in Payment Unit 2 and bark slip restrictions apply in Payment Units 1 & 3.

TIMBER SALE INFORMATION

Comp 19 Hardwoods (52-020-23)

T29N, R03W, SEC. 26; T29N, R03W, SEC. 27; T29N, R03W, SEC. 35.

Otsego County (Advertised Price \$126,546.30)

SALE NOTE: Good Access off of county roads. Oak wilt restrictions with exceptions apply in Payment Unit 2 and bark slip restrictions apply in Payment Units 1 & 3.

A timber sale contract for this lump sum, sealed bid timber sale will be awarded to the responsible bidder offering the highest sealed bid price. All units of volume listed below were estimated using the Inventory Manager computer program and the new Michigan taper model. Bids must be at or above the following advertised price for each product and species:

<u>PRODUCTS & SPECIES</u>	<u>ESTIMATED UNITS*</u>	<u>ADVERTISED PRICE</u>
Sawtimber		
Basswood	12.5 MBF	\$ 91.00 / MBF
Beech	64.4 MBF	\$ 91.00 / MBF
Mixed Aspen	8.8 MBF	\$ 65.00 / MBF
Red Maple	291.3 MBF	\$ 155.00 / MBF
Red Oak	14.8 MBF	\$ 177.00 / MBF
Sugar Maple	125.6 MBF	\$ 315.00 / MBF
Pulpwood		
Basswood	4 Cords	\$ 16.60 / Cord
Jack Pine	31 Cords	\$ 19.85 / Cord
Mixed Aspen	26 Cords	\$ 24.30 / Cord
Mixed Hardwood	1,373 Cords	\$ 20.75 / Cord
Paper Birch	4 Cords	\$ 15.65 / Cord
Red Oak	44 Cords	\$ 40.35 / Cord

* The total volume is statistically estimated within plus (+) or minus (-) 11.97 percent. There are an estimated 2,768 cords on this timber sale, plus or minus 332 cords at the 95% confidence level. The estimated units are final and not subject to adjustment. Prospective bidders are urged to examine this timber and to make their own estimates of quantity and quality.

BOND AND PAYMENT SCHEDULE:

1. A bond in the amount of \$6,327.32 to insure faithful performance of the conditions of the contract will be deposited by the successful bidder within 21 days of the sale award.
2. Cutting in any sale or unit without the required advance payment would be considered a trespass.
3. Total payment must be paid in advance or according to the following schedule :
 - (a) Ten percent (10%) of the sale value must be paid within 21 days of the sale award.
 - (b) The 10% down payment will be credited towards the first unit cut.
 - (c) Payment for each of the following units must be made before cutting begins in that unit:

PAYMENT UNIT NUMBER	PERCENT OF TOTAL SALE VALUE
01	53.5%
02	28.8%
03	17.7%
4. If no cutting takes place, the 10% down payment will not be refunded.
5. Operations on the contract issued will terminate on 06/30/2027.

SALE STATISTICS

Volumes were calculated in cubic feet using the Michigan taper model. Cubic foot volume includes all wood inside bark for the product indicated. For display purposes, cubic feet were converted to cords and MBF using a simple conversion factor, e.g. 79 cubic feet per cord and 185 cubic feet per MBF. The cubic foot volumes are precise; the cords and MBF volumes are not. Cubic foot volume cannot be directly converted to cords or boards with precision.

SALE VOLUMES

The total estimated sale volume may not equal the sum of the species/products due to the nature of statistical calculations associated with double sampling methodology.

VOLUME		STATISTICAL RANGE IN CORDS		
TOTAL CUBIC FEET	TOTAL CORDS	PERCENT ERROR	MINIMUM	MAXIMUM
218,685	2,768	11.97%	2,437	3,100

VDU VOLUMES

A VDU is a Volume Determination Unit. Volumes and their associated statistics are calculated at the VDU level and summarized to the sale level. There is often a one to one relationship between a VDU and a Payment Unit, but not always, depending on the cruise design. Refer to the VDU TO PAYMENT UNIT table.

VDU	VOLUME		PERCENT ERROR	RANGE IN CORDS	
	TOTAL CUBIC FEET	TOTAL CORDS		MINIMUM	MAXIMUM
2	109,153	1,382	17.25%	1,143	1,620
17	59,913	758	15.32%	642	875
46	49,619	628	22.42%	487	769
TOTAL:	218,685	2,768		2,273	3,264

VDU TO PAYMENT UNIT

When a VDU is associated with more than one Payment Unit (PU), the VDU volumes are assigned to the PU based on acres of the VDU within the PU.

VDU	VDU ACRES	PU	PU ACRES
2	72.4	1	72.4
17	24.5	2	24.5
46	51.6	3	51.6
TOTAL:	148.5		148.5

DESCRIPTION OF TIMBER BY PU (PU)

PU	MARKET GROUP	PRODUCT	QUANTITY	UNIT	ACRES	ADVERTISE PRICE		
1	Beech	Sawtimber	16.0	MBF	72.4	\$67,781.95		
	Mixed Aspen		4.2	MBF				
	<i>Quaking Aspen</i>		4.2	<i>MBF</i>				
	Red Maple		268.1	MBF				
	Sugar Maple		37.3	MBF				
	Mixed Aspen		Pulpwood	2			Cords	
	<i>Quaking Aspen</i>			2			<i>Cords</i>	
	Mixed Hardwood			609			Cords	
	<i>Beech</i>			104			<i>Cords</i>	
	<i>Red Maple</i>			432			<i>Cords</i>	
	<i>Sugar Maple</i>			73			<i>Cords</i>	
	Paper Birch			4			Cords	
2	Basswood	Sawtimber	2.4	MBF	24.5	\$36,399.75		
	Beech		13.7	MBF				
	Mixed Aspen		2.3	MBF				
	<i>B. T. Aspen</i>		2.3	<i>MBF</i>				
	Red Maple		15.9	MBF				
	Red Oak		10.8	MBF				
	Sugar Maple		65.6	MBF				
	Basswood		Pulpwood	1			Cords	
	Jack Pine			31			Cords	
	<i>Jack Pine</i>			<i>Sawtimber</i>			7.5	<i>MBF</i>
	<i>Jack Pine</i>			<i>Pulpwood</i>			16	<i>Cords</i>
	Mixed Aspen			3			Cords	
	<i>B. T. Aspen</i>			3			<i>Cords</i>	
	Mixed Hardwood			354			Cords	
	<i>Beech</i>			42			<i>Cords</i>	
	<i>Black Cherry</i>			6			<i>Cords</i>	
	<i>Ironwood</i>			15			<i>Cords</i>	
	<i>Red Maple</i>			67			<i>Cords</i>	
	<i>Sugar Maple</i>			224			<i>Cords</i>	
	Red Oak			42			Cords	
3	Basswood	Sawtimber	10.1	MBF	51.6	\$22,364.60		
	Beech		34.7	MBF				
	Mixed Aspen		2.3	MBF				
	<i>Quaking Aspen</i>		2.3	<i>MBF</i>				
	Red Maple		7.3	MBF				
	Red Oak		4.0	MBF				
	Sugar Maple		22.7	MBF				
	Basswood		Pulpwood	3			Cords	
	Mixed Aspen			21			Cords	
	<i>Quaking Aspen</i>			21			<i>Cords</i>	
	Mixed Hardwood			410			Cords	
	<i>Beech</i>			79			<i>Cords</i>	
	<i>Ironwood</i>			9			<i>Cords</i>	
	<i>Red Maple</i>			10			<i>Cords</i>	
	<i>Sugar Maple</i>			312			<i>Cords</i>	
	Red Oak			2			Cords	
TOTAL:				517.4	MBF			
TOTAL:			1,482	Cords				

Sale Specific Conditions & Requirements

Sale Name: Comp 19 Hardwoods

Sale Number: 52-020-23 Seq#: 2

1 - Sale Area

1.2 - Boundaries

1.2.1 - Painted boundaries (9/19)

The sale boundary and Payment Unit boundaries are marked and identified by blue and red paint. Exterior sale boundary lines against private property are marked with blue paint. Exterior sale boundary lines against state are marked with red paint. Retention patches are marked with red paint; no harvesting activities may occur within these areas. Regeneration gaps within the sale boundary are identified with teal paint. The painted boundary line trees are not Included Timber and are to be protected unless marked with orange paint.

2 - Timber Specifications

2.1 - Included Timber

2.1.1 - Clearcut unit(s) with unmerchantable trees (6/14)

Within Payment Unit(s) 2, cut all trees that are two (2) inches or more at DBH, except red and white pine. Additionally, cut all scotch pine, regardless of merchantability.

2.1.3 - Cut tree marked unit(s) (12/08)

Within Payment Unit(s) 1 & 3, all trees are designated for cutting when marked with orange paint above and below stump height, regardless of merchantability. In addition, within Payment Unit 1, all trees taller than six (6) feet in height within regeneration gaps are designated for cutting.

2.2 - Utilization

2.2.3 - Stump heights (4/07)

Stump heights within Payment Unit 2 shall not exceed 6 inches for all trees. This is in order to facilitate planting operations.

3 - Payments

3.3 - Pre-measured Sales

3.3.4 - Dividing payment units (7/14)

Payment Unit(s) may be divided at the request of the Purchaser and upon approval of the Unit Manager. Dividing Payment Units is a contract modification which requires a Timber Sale Contract Amendment. There will be only one division per Payment Unit.

3.4 - Damaged Timber

3.4.1 - Damaged timber (7/16)

General Condition and Requirement 3.4 Damaged Timber, defines liquidated damages for undesignated live merchantable trees which are cut or injured.

No damage is acceptable to undesignated live merchantable trees. Within the Sale Area, if more than 5% of trees (> 4.5" DBH) within a specified area of the sale are damaged, liquidated damages will be assessed for all trees damaged. Rates will be in accordance with General Condition and Requirement 3.4 Damaged Timber.

4 - Transportation

4.1 - Construction

4.1.3 - Slash and earthen piles (8/04)

Piles or windrows of earth along roads and landings that have been widened or constructed shall be leveled. Slash from road maintenance or construction, including stumps, shall be dispersed throughout the sale.

4.1.12 - No new roads (1/12)

No new roads will be permitted in any Payment Unit. All operations are limited to existing roads. Skid trails only will be allowed.

4.2 - Maintenance

4.2.3 - Road maintenance (8/13)

The following road maintenance may be needed: Within 60 days of completion of hauling, or if no hauling occurs for 60 days, the road must be maintained and graded. This includes cleaning of drainage areas, grading, crowning and filling with gravel, if necessary. Damages will be assessed if grading/repair does not occur.

4.2.5 - Two wheel drive condition (2/04)

All existing trail roads on and adjacent to the sale area must be passable by two-wheel drive traffic for the duration of the sale.

5 - Operations

5.1 - Notification

5.1.3 - Well heads and natural gas pipelines (11/15)

The Purchaser is responsible for contacting the MISS DIG 811 30 days prior to operating equipment in the vicinity of well heads or natural gas pipelines.

5.2 - Conduct of Operations

5.2.1 - Slash

5.2.1.8 - Slash height (12/08)

No slash or tree tops may exceed 24 inches in height.

5.2.2 - Hazard Trees/Snags

5.2.2.1 - Den trees (10/16)

Obvious hollow and/or den trees shall be protected and left standing unless they are a safety hazard.

5.2.3 - Operating Restrictions

5.2.3.3 - Bark slippage restriction (3/09)

Within Payment Unit(s) 1 & 3, unless changed by written agreement, cutting and skidding are not permitted during the period of April 15 to July 15. This restriction is because of bark slippage.

5.2.3.5 - Oak wilt restriction (1/18)

Within Payment Unit 2, unless changed by written agreement, cutting, skidding, hauling within the sale and brushing of access roads to the sale are not permitted during the period of April 15 to July 15. Operations may be allowed if specific steps are taken to prevent damaging uncut oak during the high risk period. Those steps may include completing all road brushing before April 15th and clearing a tree-length buffer along uncut oak cover before April 15th. This is necessary to reduce the spread of oak wilt. For more information, contact the Unit Manager or his/her representative.

5.2.3.11 - Coppice regeneration protection (4/10)

Timber harvesting in Payment Unit 2 must be completed before significant sprouting occurs in that Payment Unit so as to minimize damage to the new regeneration. Any post harvest operations, such as chipping, must be completed before sprouting of regeneration occurs. If it is anticipated that chipping will be delayed, then tops shall be carried to one central location or left unchipped. The Unit Manager or his/her representative may cease such operations if sprouting occurs before the operation is complete.

5.2.4 - Dead and Down Creation

5.2.4.3 - Dead and down creation, dead trees (6/07)

Except as provided for in General Condition and Requirement 5.2.2, no dead trees, standing or down, are to be cut, skidded, or processed.

5.2.32 - Decking/landing restoration (9/13)

All decking and landing areas must have the surface area restored to a condition equal to or better than before. This is to ensure the proper regeneration of the stand. Wood debris, chips and "cookies" from trimmings must be removed or scattered away from landing and loading areas and may not be windrowed on the edge.

5.2.38 - No decking against live trees (2/04)

Cut products may not be decked against unmarked or designated leave trees.

5.4 - Soil Protection

5.4.1 - Rutting restriction, general (7/16)

Operations are to cease immediately if equipment and weather conditions result in rutting of roads and/or skid trails which is 12 inches or greater in depth and 50 feet in length. The Unit Manager or his/her representative may restrict hauling and/or skidding if ruts exceed the specified depth. With the Unit Manager or his/her representative's approval, the Purchaser may return to the area when the risk of rutting has decreased.

5.4.2 - Skid trails (2/04)

Skid trails up and down slopes should be avoided. If however this is unavoidable, these trails will be left in a non-erodible condition using water bars, logs, and slash. Placing of slash on these skid trails while logging is ongoing may alleviate need for any further action. At the direction of the sale administrator, seed, fertilizer, and mulch may also be required.

5.8 - Protection of Endangered Species

5.8.5 - Protection of raptor nests (3/13)

All trees with raptor nests will be protected if found during harvesting operations. Notification will be made to the Unit Manager or his/her representative who will notify the Wildlife Biologist so an on-site evaluation and recommendation can be made, if necessary.

6 - Safety and Fire Prevention

6.2 - Signing

6.2.1 - Road posting (10/20)

The Purchaser is responsible for posting and maintaining caution signs on Marlette Road and state forest roads used for hauling prior to beginning operations. The road must be posted at appropriate distances from the Sale Area to warn of logging activity and truck traffic. Signs must be removed when harvest operations are suspended or completed. The Purchaser will provide these signs.



TIMBER SALE MAP

This information provided by authority of Part 525, 1994 PA 451, as amended.

Forest Management Unit Gaylord		County Otsego	Mapped By Crew	Date 09/11/2023	Page 1	of 1
Township 29N	Range 03W	Section(s) and Subdivision(s) 26 - SW/SW, 27 - S1/2SE,NW, 35 - W1/2NW		Scale 1:15,840		

Cover Type				Density	
A = Aspen	H = Hemlock	N = Marsh	U = Upland Brush	0 = Non Stocked	5 = Pole Timber Medium
B = Paper Birch	J = Jack Pine	O = Oak	UM = Upland Mixed	1 = Seedling Sapling Poor	6 = Pole Timber Well
C = Cedar	L = Lowland Brush	P = Lowland Poplar	V = Bog or Marsh	2 = Seedling Sapling Medium	7 = Saw Timber Poor
D = Treed Bog	LM = Lowland Mixed	Q = Mixed Swamp Conifer	W = White Pine	3 = Seedling Sapling Well	8 = Saw Timber Medium
E = Swamp Hdwoods	M = Mpl, Bch, Brch	R = Red Pine	X = Non Stocked	4 = Pole Timber Poor	9 = Saw Timber Well
F = Spruce Fir	MC = Mixed Conifer	S = Black Spruce	Z = Water		
G = Grass	MD = Mixed Deciduous	T = Tamarack			

PU	Acres
1	72.4
2	24.5
3	51.6

Comp 19 Hardwoods

Compartment 019
148.5 Acres

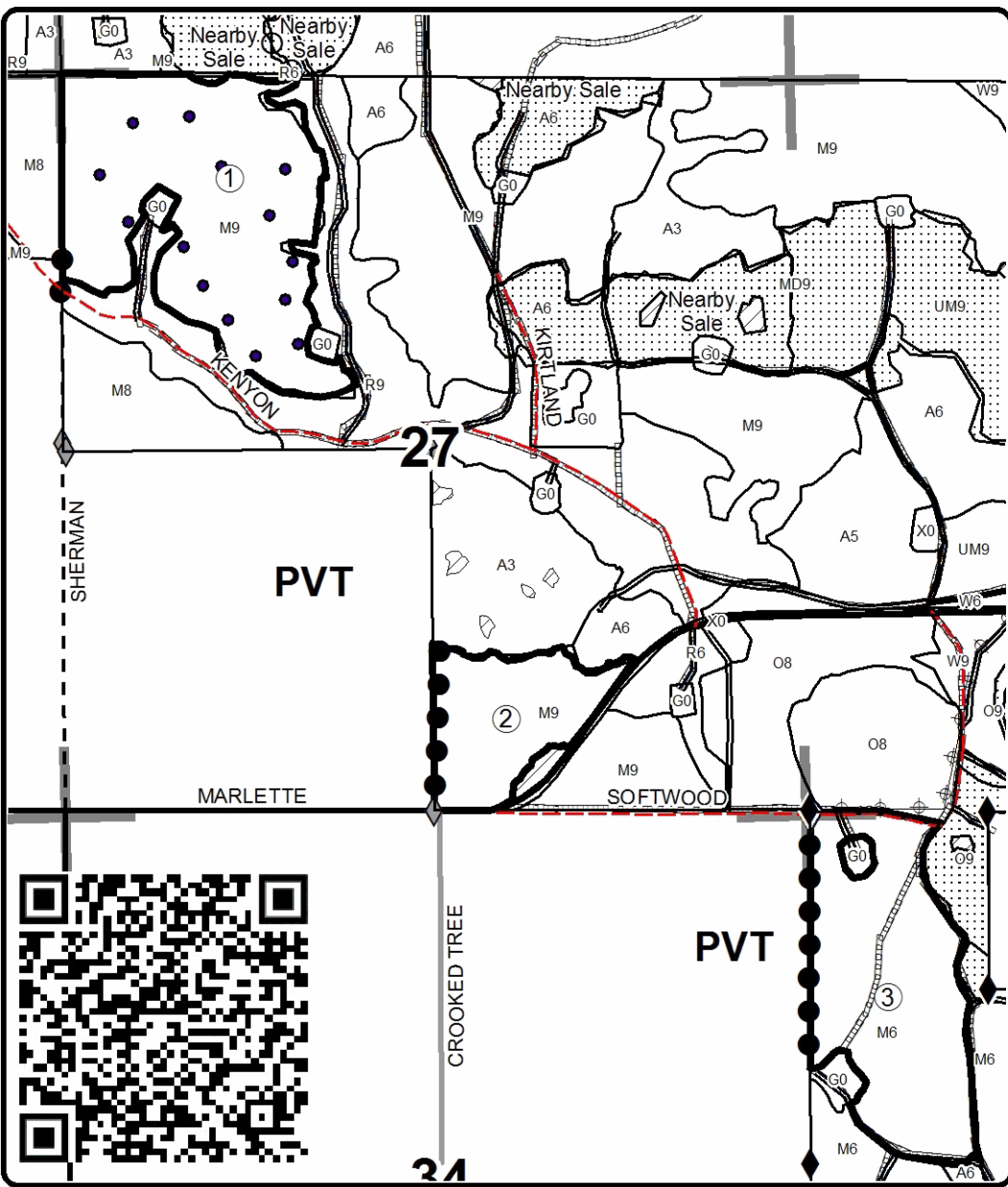

Legend

- Regen Gaps (Teal)
- ▭ Against State (Red)
- Private Line (Blue)
- ▨ Retention Area
- Pipeline
- ⊕ Powerline
- ▭ Stand Boundaries
- Secondary Forest Road
- Paved Road
- - Gravel Road
- - - County Road - Seasonal
- Private
- ▨ Nearby Timber Sales
- Section Corners
- ② Payment Unit

Locator Map
1:100,000

