



**DEPARTMENT OF NATURAL RESOURCES  
STATE OF MICHIGAN  
TIMBER SALE PROSPECTUS #7634**

**SCHEDULED SALE DATE AND TIME: 9:00 a.m. (local time) on May 5, 2025.**

**LOCATION: GRAYLING MGMT UNIT, 1955 HARTWICK PINES ROAD, GRAYLING, MI 49738.**

**CONTACT NAME: Tom Barnes**

**PHONE NUMBER: (231) 384-7732**

**PROSPECTUS NOTE:** All sales on this Prospectus have received damage from the Ice Storm in late March 2025. The Purchaser should harvest the wood as soon as possible.

The bidder is advised to inspect the sale area and review the location, estimated volumes, operating costs and contract terms of proposed sales. Please be aware that some landowners may request 60 days or more notice for access across their land.

Notice is hereby given that bids will be received by the Unit Manager, GRAYLING MANAGEMENT UNIT, for certain timber on the following described lands:

Ice-Salvage Garden (72-007-25) / T28N, R03W, SEC. 10, NW, W1/2NE.

T28N, R03W, SEC. 3, E1/2SW, W1/2SE.

T28N, R03W, SEC. 4, SWNE, S1/2SW, NWSE.

T28N, R03W, SEC. 9, E1/2NW, N1/2NE, SENE.

Crawford County, Advertised Price \$28,408.80, 178.5 Acres, Red Pine.

SALE NOTE: This is an ice storm red pine salvage sale. This sale will be scaled at a landing by Sale Administrator.

Note that this is a 1-year contract. This should be cut as soon as possible. No extensions for this sale will be granted.

Work with Sale Administrator to negotiate a scale schedule.

Producer should use georeferenced map as guide as there are no visual markers of sale boundary other than timber type changes or roads.

Contact pipeline company prior to harvest operations.

See sale spec 7.2.3 for details on extensions for sale not impacted by ice storm.

## TIMBER SALE INFORMATION

### Ice-Salvage Garden (72-007-25)

T28N, R03W, SEC. 10; T28N, R03W, SEC. 3; T28N, R03W, SEC. 4; T28N, R03W, SEC. 9.  
Crawford County (Advertised Price \$28,408.80)

SALE NOTE: This is an ice storm red pine salvage sale. This sale will be scaled at a landing by Sale Administrator.

Note that this is a 1-year contract. This should be cut as soon as possible. No extensions for this sale will be granted.

Work with Sale Administrator to negotiate a scale schedule.

Producer should use georeferenced map as guide as there are no visual markers of sale boundary other than timber type changes or roads.

Contact pipeline company prior to harvest operations.

See sale spec 7.2.3 for details on extensions for sale not impacted by ice storm.

A timber sale contract for this scaled, sealed bid timber sale will be awarded to the responsible bidder offering the highest sealed bid price. All units of volume listed below were estimated using the Inventory Manager computer program and the new Michigan taper model. Bids must be at or above the following advertised price for each product and species:

<u>PRODUCTS &amp; SPECIES</u>	<u>ESTIMATED UNITS*</u>	<u>ADVERTISED PRICE</u>
Pulpwood		
Red Pine	1,246 Cords	\$ 22.80 / Cord

\* The estimated units are final and not subject to adjustment. Prospective bidders are urged to examine this timber and to make their own estimates of quantity and quality.

### **BOND AND PAYMENT SCHEDULE:**

1. A bond in the amount of \$1,420.44 to insure faithful performance of the conditions of the contract will be deposited by the successful bidder within 21 days of the sale award.
2. Cutting in any sale or unit without the required advance payment would be considered a trespass.
3. Total payment must be paid in advance or according to the following schedule:
  - (a) Ten percent (10%) of the sale value must be paid within 21 days of the sale award.
  - (b) The 10% down payment will be credited towards the first unit cut.
  - (c) Payment for each of the following units must be made before cutting begins in that unit:

PAYMENT UNIT NUMBER	PERCENT OF TOTAL SALE VALUE
01	4.3%
02	18.2%
03	4.3%
04	6.4%
05	22.8%
06	17.2%
07	26.8%
4. If no cutting takes place, the 10% down payment will not be refunded.
5. Operations on the contract issued will terminate on 06/30/2026.

### **SALE STATISTICS**

Volumes were calculated in cubic feet using the Michigan taper model. Cubic foot volume includes all wood inside bark for the product indicated. For display purposes, cubic feet were converted to cords and MBF using a simple conversion factor, e.g. 79 cubic feet per cord and 185 cubic feet per MBF. The cubic foot volumes are precise; the cords and MBF volumes are not. Cubic foot volume cannot be directly converted to cords or boards with precision.

### **SALE VOLUMES**

The total estimated sale volume may not equal the sum of the species/products due to the nature of statistical calculations associated with double sampling methodology.

VOLUME		STATISTICAL RANGE IN CORDS		
TOTAL CUBIC FEET	TOTAL CORDS	PERCENT ERROR	MINIMUM	MAXIMUM
98,446	1,246	0.00%	1,246	1,246

## VDU VOLUMES

A VDU is a Volume Determination Unit. Volumes and their associated statistics are calculated at the VDU level and summarized to the sale level. There is often a one to one relationship between a VDU and a Payment Unit, but not always, depending on the cruise design. Refer to the VDU TO PAYMENT UNIT table.

	VOLUME			RANGE IN CORDS	
VDU	TOTAL CUBIC FEET	TOTAL CORDS	PERCENT ERROR	MINIMUM	MAXIMUM
15	16,881	214	0.00%	214	214
18	26,497	335	0.00%	335	335
20	6,354	80	0.00%	80	80
22	22,452	284	0.00%	284	284
28	17,927	227	0.00%	227	227
30	4,155	53	0.00%	53	53
218	4,180	53	0.00%	53	53
<b>TOTAL:</b>	<b>98,446</b>	<b>1,246</b>		<b>1,246</b>	<b>1,246</b>

## VDU TO PAYMENT UNIT

When a VDU is associated with more than one Payment Unit (PU), the VDU volumes are assigned to the PU based on acres of the VDU within the PU.

VDU	VDU ACRES	PU	PU ACRES
15	30.6	6	30.6
18	48.1	7	48.1
20	11.5	4	11.5
22	40.7	5	40.7
28	32.5	2	32.5
30	7.5	1	7.5
218	7.6	3	7.6
<b>TOTAL:</b>	<b>178.5</b>		<b>178.5</b>

## DESCRIPTION OF TIMBER BY PU (PU)

PU	MARKET GROUP	PRODUCT	QUANTITY	UNIT	ACRES	ADVERTISE PRICE
1	Red Pine	Pulpwood	53	Cords	7.5	\$1,208.40
2	Red Pine	Pulpwood	227	Cords	32.5	\$5,175.60
3	Red Pine	Pulpwood	53	Cords	7.6	\$1,208.40
4	Red Pine	Pulpwood	80	Cords	11.5	\$1,824.00
5	Red Pine	Pulpwood	284	Cords	40.7	\$6,475.20
6	Red Pine	Pulpwood	214	Cords	30.6	\$4,879.20
7	Red Pine	Pulpwood	335	Cords	48.1	\$7,638.00
<b>TOTAL:</b>			<b>1,246</b>	<b>Cords</b>		

## **Sale Specific Conditions & Requirements**

**Sale Name: Ice-Salvage Garden**

**Sale Number: 72-007-25 Seq#: 1**

### **1 - Sale Area**

#### **1.2 - Boundaries**

##### **1.2.1 - Painted Boundaries (9/19)**

The sale boundary and Payment Unit boundaries are marked and identified by blue paint, cover type changes, and roads (See Timber Sale Map). Exterior sale boundary lines against private property are marked with blue paint. Exterior sale boundary lines against state are unmarked and identified by the timber type change from red pine to hardwood. The painted boundary line trees are Included Timber and are only to be cut when a clear sale boundary has been identified.

### **2 - Timber Specifications**

#### **2.1 - Included Timber**

##### **2.1.1 - Clearcut Unit(s) with Unmerchantable Trees (6/14)**

Within Payment Unit(s) 1, 2, 6 and 7, cut all trees that are two (2) inches or more at DBH.

##### **2.1.4 - Designated Timber Unit(s) (6/17)**

Within Payment Unit(s) 3-5, all red pine trees the have crown loss of 50% or more, or are overly bent and at risk of breaking are designated for cutting which meet minimum piece specifications in 2.2 Utilization. Work with Sale Administrator to remove any other identified high-risk trees. In addition, to reduce the risk of oak wilt, all residual merchantable oak must be cut.

##### **2.1.11 - Description of Timber Note (2/04)**

Note that this is an ice storm salvage sale. All Payment Units will be scaled by Sale Administrator. Chipping of the Sale Area will not be required but is encouraged. If sale is chipped, the Purchaser must provide electronic confirmation of scale tickets at minimum twice per week. To convert red pine chip weight to cords, we will use a conversion of 1 cord = 1.9 tons or 1 cord = 3,800 pounds. This is from the USDA's Timber Management Field Book, 2008 Edition table 2.10 Weight Table for Various Woods.

Species other than red pine will be scaled as follows:

Mixed aspen: \$16.50/cd

White pine: \$19.00/cd

Jack pine: \$13.50/cd

Mixed hardwood: \$14.00/cd

Mixed oak: \$7.50/cd

#### **2.2 - Utilization**

##### **2.2.3 - Stump Heights (12/24)**

Stump heights within the Sale Area shall not exceed six (6) inches for all trees. This is in order to facilitate planting operations.

### **3 - Payments**

#### **3.2 - Scaled Sales**

##### **3.2.1 - Scale Location (2/04)**

Forest products will be placed for measurement at designated areas by the Sale Administrator. In addition, negotiate with Sale Administrator to determine frequency of scaling.

#### **3.4 - Damaged Timber**

##### **3.4.1 - Damaged Timber (12/24)**

General Condition and Requirement 3.4 Damaged Timber, defines liquidated damages for undesigned live merchantable

trees which are cut or injured. In addition, within Payment Units 2, 3, and 4, extreme care should be taken to avoid damage to tree seedlings and saplings.

Within the Sale Area, if more than 50% of the tree seedlings or saplings (1/4" to 4.5" DBH) within a specified portion of the Sale Area are damaged, liquidated damages will be assessed at \$300 per acre for all acreage within that specified portion of the Sale Area that was damaged.

No damage is acceptable to undesignated live merchantable trees. Within the Sale Area, if more than 5% of trees (> 4.5" DBH) within a specified area of the sale are damaged, liquidated damages will be assessed for all trees damaged.

## **4 - Transportation**

### **4.1 - Construction**

#### **4.1.3 - Slash and Earthen Piles (8/04)**

Piles or windrows of earth along roads and landings that have been widened or constructed shall be leveled. Slash from road maintenance or construction, including stumps, shall be chipped, utilized or otherwise removed from the sale.

#### **4.1.6 - Road Construction (4/24)**

Construction of new roads or improvements of existing roads shall be done in such a way as to minimize the environmental and visual impacts. Merchantable trees shall be cut and utilized unless otherwise directed. Non-merchantable trees shall be severed and laid flat on the ground. Slash shall be chipped, utilized or otherwise removed from the sale. Stumps shall be set upright, not left on edge, and be moved at least 10 feet away from the road edge. Disturbed soil shall be feathered into the woods and not left in berms or windrows. In addition, the access to Payment Unit 4 will need a new road built from Sherman Road to the west. The length of this new road is about 550 feet. See Timber Sale Map for location. The Producer is responsible for road construction, but the State will provide the gravel needed.

#### **4.1.7 - Road Closure (10/11)**

All new roads built into the sale must be blocked to vehicle traffic upon completion of the sale. Overgrown roads that are reopened shall be considered new roads. In general, this will require constructing a four (4') foot high berm of stumps and logs covered with earth. Stumps and brush must be placed along the remainder of the trail. These roads must be rendered impassable to cars and trucks. All stumps from road building and landing construction must be reserved to block any newly constructed roads upon completion of the sale. These stumps must be scattered along the road system to prohibit vehicular movement. Contact the Sale Administrator for specific details of design and placement.

#### **4.1.11 - Permits (2/12)**

The Purchaser will secure any necessary permits that may be required.

### **4.2 - Maintenance**

#### **4.2.5 - Two Wheel Drive Condition (2/04)**

All existing trail roads on and adjacent to the Sale Area must be passable by two-wheel drive traffic for the duration of the sale.

## **5 - Operations**

### **5.1 - Notification**

#### **5.1.3 - Well Heads and Natural Gas Pipelines (11/15)**

The Purchaser is responsible for contacting the gas or pipeline company 30 days prior to operating equipment in the vicinity of well heads or natural gas pipelines. Contact Linn Operating INC. at 231-922-7302 for more details. Written permission is required before harvest operations begin and must be submitted to the Unit Manager.

### **5.2 - Conduct of Operations**

#### **5.2.32 - Decking/Landing Restoration (9/13)**

All decking and landing areas must have the surface area restored to a condition equal to or better than before. This is to ensure the proper regeneration of the stand. Wood debris, chips and "cookies" from trimmings must be chipped or removed from Sale Area.

#### 5.2.33 - Gas Well Revegetation (12/08)

In the event that the gas well is utilized for a landing, the site must be revegetated with a seeding mixture specified by the Unit Manager or his/her representative.

### 5.8 - Protection of Endangered Species

#### 5.8.5 - Protection of Raptor Nests (3/13)

All trees with raptor nests will be protected if found during harvesting operations. Notification will be made to the Unit Manager or his/her representative who will notify the Wildlife Biologist so an onsite evaluation and recommendation can be made, if necessary.

## 6 - Safety and Fire Prevention

### 6.2 - Signing

#### 6.2.1 - Road Posting (10/20)

The Purchaser is responsible for posting and maintaining caution signs on Sherman Road prior to beginning operations. The road must be posted at appropriate distances from the Sale Area to warn of logging activity and truck traffic. Signs must be removed when harvest operations are suspended or completed. The Purchaser will provide these signs.

## 7 - Other Conditions

### 7.2 - Extensions

#### 7.2.2 - No Extensions (3/09)

This is a ice storm red pine salvage harvest. There will be no extensions granted for this sale.

#### 7.2.3 - Salvage Extension (6/13)

This is a salvage sale with a short contract length. The sale must be harvested promptly. One (1), twelve (12) month extension can be applied to one (1) other State Forest Timber Sale Contract owned by the purchaser or owned by one (1) designated sub-contractor of the Purchaser that works this contract. To qualify, the contract expiration date of the contract to be extended must be within twelve (12) months from the issue date of this contract. If this is the first extension on the other State Forest Timber Sale Contract, then the 5% extension fee will be waived. If this is an additional extension, the 10% fee will be reduced to 5%. The salvage extension must be used before this contract is closed-out. This specification does not alleviate the purchaser from any contractual obligations of the extended State Forest Timber Sale Contract. Per General Condition & Requirement 7.2, extensions are at the sole discretion of the DNR.

### 7.5 - Loss

#### 7.5.1 - Deteriorating Timber (7/09)

The Sale Area has received damage from the 2025 ice storm. The Purchaser should harvest the wood as soon as possible. The Department of Natural Resources is held free of responsibility of any further damage or deterioration due to delay in harvesting.

**TIMBER SALE MAP**

This information provided by authority of Part 525, 1994 PA 451, as amended.

Sale Number

**72-007-25**

Date

**04/24/2025**

Forest Management Unit

Grayling Mgt Unit

County

Crawford

Mapped By: Michaud

Cruised By: Michaud

Scale

**1:15,840**

Page

**1**

Of

**1**

Township

**28N**

Range

**03W**

Section(s) and E1/2NW,N1/2NE,SENE;

Subdivision(s) Sec. 10 NW,W1/2NE; Sec. 3 E1/2SW,W1/2SE; Sec. 4 SWNE,S1/2SW,NWSE; Sec. 9

**Cover Type**

A = Aspen	J = Jack Pine	O = Oak	U = Upland Brush
B = Paper Birch	K = Rock	P = Lowland Poplar	UM = Upland Mix Forest
C = Cedar	L = Lowland Brush	Q = Mixed Swamp Conifer	V = Bog or Marsh
D = Treed Bog	LM = Lowland Mix Forest	R = Red Pine	W = White Pine
E = Swamp Hardwoods	M = Maple, Beech, Birch	S = Black Spruce	X = Non Stocked
F = Spruce/Fir	MC = Mixed Conifer	T = Tamarack	Y = Sand
G = Grass	MD = Mixed Deciduous		Z = Water
H = Hemlock	N = Marsh		

**Density**

0 = Non Stocked	5 = Pole Timber Medium
1 = Seedling Sapling Poor	6 = Pole Timber Well
2 = Seedling Sapling Medium	7 = Saw Timber Poor
3 = Seedling Sapling Well	8 = Saw Timber Medium
4 = Pole Timber Poor	9 = Saw Timber Well

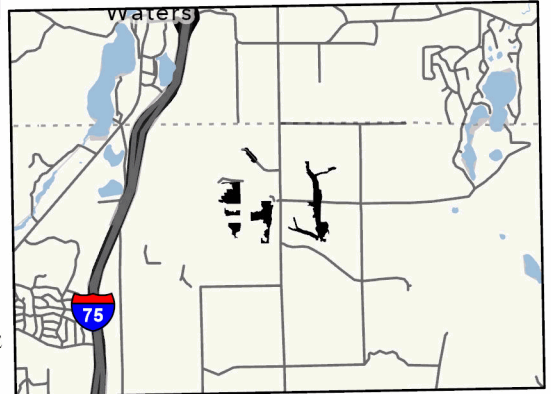
**Locator Map 1:150,000**

Payment Unit Number	Acres	Payment Unit Number	Acres
1	7.5	5	40.7
2	32.5	6	30.6
3	7.6	7	48.1
4	11.5		

**Ice-Salvage Garden****178.5 Acres**

0 0.25 0.5 1 Miles

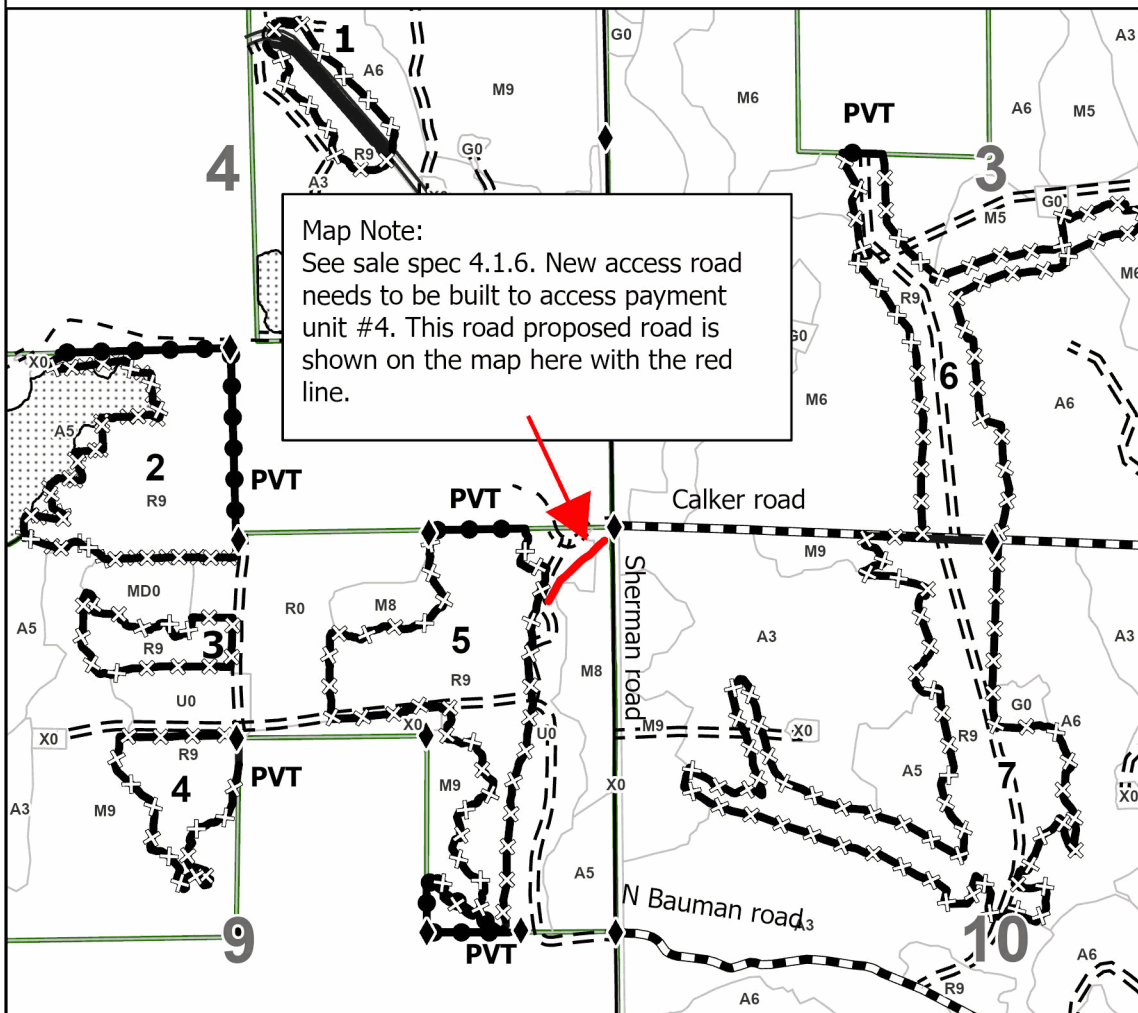
**Legend**

- Sale Boundary
- Against State (Unpainted)
- Against State (Cover Type Change)
- Private Line (Blue)
- Primary Forest Road
- Forest Access Route
- Administrative Access Only
- Paved Road
- Government Gravel/Dirt
- Private Gravel/Dirt
- Recreational Trails
- Field Grade Corner

Use QR Code to open Map in App

