



**DEPARTMENT OF NATURAL RESOURCES  
STATE OF MICHIGAN  
TIMBER SALE PROSPECTUS #7678**

**SCHEDULED SALE DATE AND TIME: 3:00 p.m. (local time) on July 29, 2025.**

**LOCATION: NAUBINWAY DNR FIELD OFFICE, PO BOX 287, W11569 US2, NAUBINWAY, MI 49762.**

**CONTACT NAME: Josh Brinks**

**PHONE NUMBER: (906) 203-0210**

**PROSPECTUS NOTE:** The bidder is advised to inspect the sale area and review the location, estimated volumes, operating costs and contract terms of proposed sales. Please be aware that some landowners may request 60 days or more notice for access across their land.

Notice is hereby given that bids will be received by the Unit Manager, SAULT STE MARIE MANAGEMENT UNIT, for certain timber on the following described lands:

Bird is the Word HW (45-118-24) / T44N, R08W, SEC. 27, S1/2SE.

T44N, R08W, SEC. 34, N1/2NW, N1/2NE, SENE.

T44N, R08W, SEC. 35, NW, S1/2NE, NESW, N1/2SE.

Mackinac County, Advertised Price \$102,452.70, 255.1 Acres, Hardwood, Sugar Maple.

**SALE NOTE:** A recreation site such as a trail, pathway, or campground is within the sale area or the vicinity. Certain restrictions/specifications may be applicable including time restrictions.

## TIMBER SALE INFORMATION

Bird is the Word HW (45-118-24)  
T44N, R08W, SEC. 27; T44N, R08W, SEC. 34; T44N, R08W, SEC. 35.  
Mackinac County (Advertised Price \$102,452.70)

SALE NOTE: A recreation site such as a trail, pathway, or campground is within the sale area or the vicinity. Certain restrictions/specifications may be applicable including time restrictions.

A timber sale contract for this lump sum, sealed bid timber sale will be awarded to the responsible bidder offering the highest sealed bid price. All units of volume listed below were estimated using the Inventory Manager computer program and the new Michigan taper model. Bids must be at or above the following advertised price for each product and species:

<u>PRODUCTS &amp; SPECIES</u>	<u>ESTIMATED UNITS*</u>	<u>ADVERTISED PRICE</u>
Sawtimber		
Basswood	15.3 MBF	\$ 68.00 / MBF
Black Cherry	2.2 MBF	\$ 103.00 / MBF
Sugar Maple	177.4 MBF	\$ 333.00 / MBF
Pulpwood		
Basswood	121 Cords	\$ 7.75 / Cord
Mixed Hardwood	2,025 Cords	\$ 15.70 / Cord
Quaking Aspen	50 Cords	\$ 24.00 / Cord
Red Pine	85 Cords	\$ 96.25 / Cord

\* The total volume is statistically estimated within plus (+) or minus (-) 11.75 percent. There are an estimated 2,746 cords on this timber sale, plus or minus 323 cords at the 95% confidence level. The estimated units are final and not subject to adjustment. Prospective bidders are urged to examine this timber and to make their own estimates of quantity and quality.

### **BOND AND PAYMENT SCHEDULE:**

- A bond in the amount of \$5,122.64 to insure faithful performance of the conditions of the contract will be deposited by the successful bidder within 21 days of the sale award.
- Cutting in any sale or unit without the required advance payment would be considered a trespass.
- Total payment must be paid in advance or according to the following schedule :
  - Ten percent (10%) of the sale value must be paid within 21 days of the sale award.
  - The 10% down payment will be credited towards the first unit cut.
  - Payment for each of the following units must be made before cutting begins in that unit:
 

PAYMENT UNIT NUMBER	PERCENT OF TOTAL SALE VALUE
01	11.8%
02	9.0%
03	15.3%
04	12.1%
05	12.8%
06	4.4%
07	12.5%
08	11.5%
09	10.6%
- If no cutting takes place, the 10% down payment will not be refunded.
- Operations on the contract issued will terminate on 12/31/2028.

### **SALE STATISTICS**

Volumes were calculated in cubic feet using the Michigan taper model. Cubic foot volume includes all wood inside bark for the product indicated. For display purposes, cubic feet were converted to cords and MBF using a simple conversion factor, e.g. 79 cubic feet per cord and 185 cubic feet per MBF. The cubic foot volumes are precise; the cords and MBF volumes are not. Cubic foot volume cannot be directly converted to cords or boards with precision.

### **SALE VOLUMES**

The total estimated sale volume may not equal the sum of the species/products due to the nature of statistical calculations associated with double sampling methodology.

VOLUME		STATISTICAL RANGE IN CORDS		
TOTAL CUBIC FEET	TOTAL CORDS	PERCENT ERROR	MINIMUM	MAXIMUM
216,947	2,746	11.75%	2,423	3,069

VDU VOLUMES

A VDU is a Volume Determination Unit. Volumes and their associated statistics are calculated at the VDU level and summarized to the sale level. There is often a one to one relationship between a VDU and a Payment Unit, but not always, depending on the cruise design. Refer to the VDU TO PAYMENT UNIT table.

	VOLUME			RANGE IN CORDS	
VDU	TOTAL CUBIC FEET	TOTAL CORDS	PERCENT ERROR	MINIMUM	MAXIMUM
234	216,947	2,746	11.75%	2,423	3,069
TOTAL:	216,947	2,746		2,423	3,069

VDU TO PAYMENT UNIT

When a VDU is associated with more than one Payment Unit (PU), the VDU volumes are assigned to the PU based on acres of the VDU within the PU.

VDU	VDU ACRES	PU	PU ACRES
234	255.1	1	30.2
		2	22.8
		3	39.0
		4	31.3
		5	32.5
		6	11.0
		7	32.0
		8	29.2
		9	27.1
TOTAL:	255.1		255.1

**DESCRIPTION OF TIMBER BY PU (PU)**

PU	MARKET GROUP	PRODUCT	QUANTITY	UNIT	ACRES	ADVERTISE PRICE
1	Basswood	Sawtimber	1.8	MBF	30.2	\$12,113.60
	Black Cherry		0.3	MBF		
	Sugar Maple		21.0	MBF		
	Basswood	Pulpwood	14	Cords		
	Mixed Hardwood		239	Cords		
	<i>Black Cherry</i>		6	<i>Cords</i>		
	<i>Sugar Maple</i>		233	<i>Cords</i>		
	Quaking Aspen		6	Cords		
	Red Pine		10	Cords		
2	Basswood	Sawtimber	1.4	MBF	22.9	\$9,203.45
	Black Cherry		0.2	MBF		
	Sugar Maple		15.9	MBF		
	Basswood	Pulpwood	11	Cords		
	Mixed Hardwood		181	Cords		
	<i>Black Cherry</i>		5	<i>Cords</i>		
	<i>Sugar Maple</i>		176	<i>Cords</i>		
	Quaking Aspen		4	Cords		
	Red Pine		8	Cords		
3	Basswood	Sawtimber	2.2	MBF	39.1	\$15,691.55
	Black Cherry		0.2	MBF		
	Sugar Maple		27.2	MBF		
	Basswood	Pulpwood	19	Cords		
	Mixed Hardwood		315	Cords		
	<i>Beech</i>		3	<i>Cords</i>		
	<i>Black Cherry</i>		8	<i>Cords</i>		
	<i>Ironwood</i>		3	<i>Cords</i>		
	<i>Sugar Maple</i>		301	<i>Cords</i>		
	Quaking Aspen		9	Cords		
	Red Pine		12	Cords		
4	Basswood	Sawtimber	1.9	MBF	31.0	\$12,437.85
	Black Cherry		0.3	MBF		
	Sugar Maple		21.6	MBF		
	Basswood	Pulpwood	15	Cords		
	Mixed Hardwood		246	Cords		
	<i>Black Cherry</i>		7	<i>Cords</i>		
	<i>Sugar Maple</i>		239	<i>Cords</i>		
	Quaking Aspen		6	Cords		
	Red Pine		10	Cords		
5	Basswood	Sawtimber	2.0	MBF	32.6	\$13,095.60
	Black Cherry		0.3	MBF		
	Sugar Maple		22.7	MBF		
	Basswood	Pulpwood	15	Cords		
	Mixed Hardwood		258	Cords		
	<i>Black Cherry</i>		7	<i>Cords</i>		
	<i>Sugar Maple</i>		251	<i>Cords</i>		
	Quaking Aspen		6	Cords		
	Red Pine		11	Cords		
6	Basswood	Sawtimber	0.7	MBF	11.2	\$4,508.65
	Black Cherry		0.1	MBF		
	Sugar Maple		7.8	MBF		
	Basswood	Pulpwood	5	Cords		
	Mixed Hardwood		88	Cords		
	<i>Black Cherry</i>		2	<i>Cords</i>		
	<i>Sugar Maple</i>		86	<i>Cords</i>		
	Quaking Aspen		2	Cords		

**DESCRIPTION OF TIMBER BY PU (PU), CON'T**

PU	MARKET GROUP	PRODUCT	QUANTITY	UNIT	ACRES	ADVERTISE PRICE
6 con't	Red Pine	Pulpwood	4	Cords		
7	Basswood	Sawtimber	1.9	MBF	31.8	\$12,794.80
	Black Cherry		0.3	MBF		
	Sugar Maple		22.1	MBF		
	Basswood	Pulpwood	15	Cords		
	Mixed Hardwood		252	Cords		
	<i>Black Cherry</i>		7	<i>Cords</i>		
	<i>Sugar Maple</i>		245	<i>Cords</i>		
	Quaking Aspen		6	Cords		
	Red Pine		11	Cords		
8	Basswood	Sawtimber	1.8	MBF	29.2	\$11,754.90
	Black Cherry		0.3	MBF		
	Sugar Maple		20.3	MBF		
	Basswood	Pulpwood	14	Cords		
	Mixed Hardwood		231	Cords		
	<i>Black Cherry</i>		6	<i>Cords</i>		
	<i>Sugar Maple</i>		225	<i>Cords</i>		
	Quaking Aspen		6	Cords		
	Red Pine		10	Cords		
9	Basswood	Sawtimber	1.6	MBF	27.1	\$10,852.30
	Black Cherry		0.2	MBF		
	Sugar Maple		18.8	MBF		
	Basswood	Pulpwood	13	Cords		
	Mixed Hardwood		215	Cords		
	<i>Black Cherry</i>		6	<i>Cords</i>		
	<i>Sugar Maple</i>		209	<i>Cords</i>		
	Quaking Aspen		5	Cords		
	Red Pine		9	Cords		
TOTAL:			194.9	MBF		
TOTAL:			2,281	Cords		

## **Sale Specific Conditions & Requirements**

**Sale Name: Bird is the Word HW**

**Sale Number: 45-118-24 Seq#: 2**

### **1 - Sale Area**

#### **1.2 - Boundaries**

##### **1.2.1 - Painted Boundaries (9/19)**

The sale boundary and Payment Unit boundaries are marked and identified by blue, red and yellow paint. Exterior sale boundary lines against private property are marked with blue paint. Exterior sale boundary lines against state are marked with red paint. Interior Payment Unit boundaries are marked with yellow paint. The painted boundary line trees are not Included Timber and are to be protected unless marked with orange paint.

### **2 - Timber Specifications**

#### **2.1 - Included Timber**

##### **2.1.3 - Cut Tree Marked Unit(s) (12/08)**

Within Payment Unit(s) 1-9, all trees are designated for cutting when marked with orange paint above and below stump height, regardless of merchantability. In addition, any aspen that are two (2) inches or more at DBH and all merchantable fir are designated for cutting.

##### **2.1.11 - Description of Timber Note (2/04)**

Note that Mixed Hardwood includes basswood, beech, black cherry and sugar maple.

### **3 - Payments**

#### **3.3 - Pre-measured Sales**

##### **3.3.4 - Dividing Payment Units (7/14)**

Payment Unit(s) 1-9 may be divided at the request of the Purchaser and upon approval of the Unit Manager. Dividing Payment Units is a contract modification which requires a Timber Sale Contract Amendment. There will be only one division per Payment Unit.

### **4 - Transportation**

#### **4.1 - Construction**

##### **4.1.3 - Slash and Earthen Piles (8/04)**

Piles or windrows of earth along roads and landings that have been widened or constructed shall be leveled. Slash from road maintenance or construction, including stumps, shall be dispersed throughout the sale.

##### **4.1.4 - Timber Removed for Construction (3/23)**

Trees cut or damaged in the process of pre-approved road, landing, or skid trail construction will be decked in an area separate from other Designated Timber and not removed until measured by the Sale Administrator. Payment will be made at contract prices or average prices, if not on the contract.

##### **4.1.6 - Road Construction (4/24)**

Construction of new roads or improvements of existing roads shall be done in such a way as to minimize the environmental and visual impacts. Merchantable trees shall be cut and utilized unless otherwise directed. Non-merchantable trees shall be severed and laid flat on the ground. Slash shall be scattered, and not left in windrows and kept a minimum of 10 feet back from the road edge. Stumps shall be set upright, not left on edge, and be moved at least 10 feet away from the road edge. Disturbed soil shall be feathered into the woods and not left in berms or windrows.

##### **4.1.7 - Road Closure (10/11)**

All new roads built into the sale must be blocked to vehicle traffic upon completion of the sale. Overgrown roads that are reopened shall be considered new roads. In general, this will require constructing a four (4') foot high berm of stumps and logs covered with earth. These roads must be rendered impassable to cars and trucks. Contact the Sale Administrator for

specific details of design and placement.

## 4.2 - Maintenance

### 4.2.1 - Hauling Restriction (12/08)

Hauling is restricted on Dollar Lake Road and Streeter Road. The restriction may occur during spring breakup.

### 4.2.3 - Road maintenance (8/13)

The following road maintenance is required: Within 60 days of completion of hauling, or if no hauling occurs for 60 days, the road must be maintained and graded. This includes cleaning of drainage areas, grading, crowning and filling with gravel, if necessary. Damages will be assessed if grading/repair does not occur.

### 4.2.5 - Two Wheel Drive Condition (2/04)

All existing trail roads on and adjacent to the Sale Area must be passable by two-wheel drive traffic for the duration of the sale.

## 5 - Operations

### 5.2 - Conduct of Operations

#### 5.2.1 - Slash

##### 5.2.1.11 - Slash for Reforestation (3/21)

To facilitate reforestation, the Sale Area shall be left with slash evenly distributed. Tops shall not be crushed or ran over unless in a main skid trail. Preferably, unbroken tops shall be left whole and intact, and placed within gaps created during harvesting operations.

#### 5.2.2 - Hazard Trees/Snags

##### 5.2.2.1 - Den Trees (10/16)

Obvious hollow and/or den trees shall be protected and left standing unless they are a safety hazard.

#### 5.2.3 - Operating Restrictions

##### 5.2.3.3 - Bark Slippage Restriction (3/09)

Within Payment Unit(s) 1-9, unless changed by written agreement, cutting and skidding are not permitted during the period of May 1 to July 15. This restriction is because of bark slippage.

##### 5.2.32 - Decking/Landing Restoration (9/13)

All decking and landing areas must have the surface area restored to a condition equal to or better than before. This is to ensure the proper regeneration of the stand. Wood debris, chips and "cookies" from trimmings must be removed or scattered away from landing and loading areas and may not be windrowed on the edge.

##### 5.2.38 - No Decking Against Live Trees (2/04)

Cut products may not be decked against unmarked or designated leave trees.

##### 5.2.39 - ORV Trail/Route Protection (4/18)

The ORV trail(s) or route(s) is shown on the Timber Sale Map. Do not cut trees or damage posts with yellow ORV markers. Maintain a 20-foot-wide slash, debris, and rut free zone daily using the ORV trail or route as the centerline. No decking may occur within 50 feet of the ORV trail(s) or route(s). Do not run equipment down the ORV trail(s) or route(s).

##### 5.2.41 - Snowmobile Trail Protection (9/11)

The snowmobile trail is shown on the Timber Sale Map. Do not cut or damage posts with orange trail markers or traffic control signs. If the trail is used, it must be maintained and restored to a condition equal to or better than before the sale. The road maintenance/restoration must be done prior to December 1. If the trail is used for hauling, it must be graded to the satisfaction of the Unit Manager or his/her representative prior to December 1. If the trail road is to be used for hauling during the snowmobile season, then a snow-covered base must be left on the trail. The snowmobile trail may only be crossed at right angles. Maintain a 20-foot-wide slash, debris, and rut free zone daily using the snowmobile trail as the centerline. No decking of forest products will be permitted within 50 ft of the snowmobile trail.

### 5.8 - Protection of Endangered Species

#### 5.8.5 - Protection of Raptor Nests (3/13)

All trees with raptor nests will be protected if found during harvesting operations. Notification will be made to the Unit Manager or his/her representative who will notify the Wildlife Biologist so an onsite evaluation and recommendation can be made, if necessary.

#### 5.8.7 - Protection of Walking Fern Habitat (9/08)

If walking fern is discovered on boulders within the sale area, operations in that immediate area should be suspended and the Unit Manager contacted. The contract may be amended to protect these sites. An area surrounding the boulders could be designated as a "no-cut" zone with appropriate adjustments made to the State Forest Timber Sale Contract.

#### 5.8.8 - Protected Species, Other (2/12)

Within Payment Units 1-9, the harvesting time period may be altered if it is determined that there are black throated blue warbler present in the Sale Area. If found, no cutting or skidding may occur during the time period of May 16 to August 16. This restriction is because of potential warbler habitat that exists in the Sale Area.

## 6 - Safety and Fire Prevention

### 6.2 - Signing

#### 6.2.1 - Road Posting (10/20)

The Purchaser is responsible for posting and maintaining caution signs on Dollar Lake Road and Streeter Road prior to beginning operations. The road must be posted at appropriate distances from the Sale Area to warn of logging activity and truck traffic. Signs must be removed when harvest operations are suspended or completed. The Purchaser will provide these signs.

#### 6.2.2 - Snowmobile Trail Posting (10/20)

The Purchaser is responsible for posting and maintaining caution signs on the snowmobile trail prior to beginning operations during the snowmobile season (approximately December 1 to March 31). The trail must be posted at appropriate distances from the Sale Area to warn of logging activity and truck traffic. Signs must be removed when harvest operations are suspended or completed. The Purchaser will provide these signs.

#### 6.2.3 - Recreational Trail Posting (10/20)

The Purchaser is responsible for posting and maintaining caution signs on the ORV trail and the Motorcycle trail prior to beginning operations. The trail must be posted at appropriate distances from the Sale Area to warn of logging activity and truck traffic at both ends of the trail. Signs must be removed when harvest operations are suspended or completed. The Purchaser will provide these signs.



**TIMBER SALE MAP**

This information provided by authority of Part 525, 1994 PA 451, as amended.

Sale Number  
**45-118-24**Date  
**06/12/2025**

Forest Management Unit

County

Mapped By: Plato

Scale

Page

Of

Sault Ste Marie Mgt Unit

Mackinac

Cruised By: Naubinway FO Staff

1:20,000

1

1

Township

Range

Section(s) and

44N

08W

Subdivision(s) Sec. 27 S1/2SE; Sec. 34 N1/2NW,N1/2NE,SENE; Sec. 35 NW,S1/2NE,NESW,N1/2SE;

**Cover Type**

A = Aspen	J = Jack Pine	O = Oak	U = Upland Brush
B = Paper Birch	K = Rock	P = Lowland Poplar	UM = Upland Mix Forest
C = Cedar	L = Lowland Brush	Q = Mixed Swamp Conifer	V = Bog or Marsh
D = Treed Bog	LM = Lowland Mix Forest	R = Red Pine	W = White Pine
E = Swamp Hardwoods	M = Maple, Beech, Birch	S = Black Spruce	X = Non Stocked
F = Spruce/Fir	MC = Mixed Conifer	T = Tamarack	Y = Sand
G = Grass	MD = Mixed Deciduous		Z = Water
H = Hemlock	N = Marsh		

**Density**

0 = Non Stocked	5 = Pole Timber Medium
1 = Seedling Sapling Poor	6 = Pole Timber Well
2 = Seedling Sapling Medium	7 = Saw Timber Poor
3 = Seedling Sapling Well	8 = Saw Timber Medium
4 = Pole Timber Poor	9 = Saw Timber Well

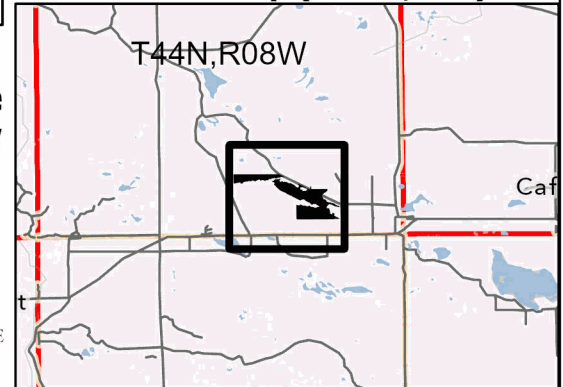
**Locator Map (1:200,000)**

PU #	Acres	PU #	Acres
1	30.2	6	11.2
2	22.9	7	31.8
3	39.1	8	29.2
4	31	9	27.1
5	32.6		

**Bird is the  
Word HW**  
**255.1  
Acres**

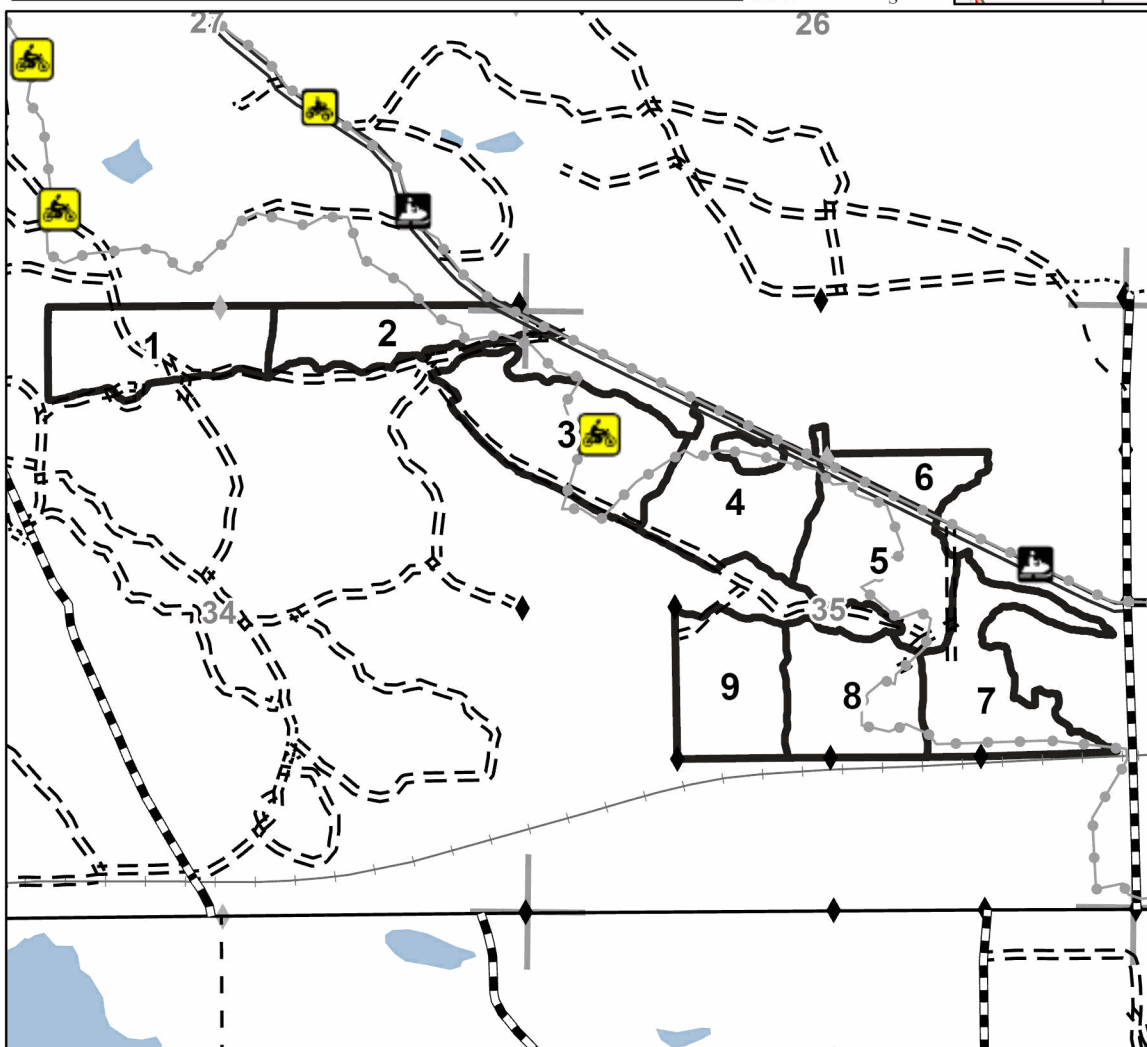

0 0.3 0.6 1.2 Miles

**Legend**

- Sale Boundary (Red)
- Payment Unit (Yellow)
- Private Line (Blue)
- Stand
- Recreational Trail
- Paved Road
- Gravel Road
- Active Railroad
- Primary Forest Road
- Forest Access Route
- Administrative Access Only
- Paved Road
- Government Gravel/Dirt
- Field Grade Corner
- Survey Grade Corner
- Section Corners
- Nearby Sales

Use QR Code to open Map in App

