

**TIMBER SALE MAP**

This information provided by authority of Part 525, 1994 PA 451, as amended.

Sale Number

32-021-25

Date

05/15/2025

Forest Management Unit

Gwinn Mgt Unit

County

Marquette

Mapped By: Kyle Gould

Cruised By:

Scale

1:10,000

Page

1

Of

1

Township

47N

Range

25W

Section(s) and
Subdivision(s) Section 22**Cover Type**

| | | | |
|---------------------|-------------------------|-------------------------|------------------------|
| A = Aspen | J = Jack Pine | O = Oak | U = Upland Brush |
| B = Paper Birch | K = Rock | P = Lowland Poplar | UM = Upland Mix Forest |
| C = Cedar | L = Lowland Brush | Q = Mixed Swamp Conifer | V = Bog or Marsh |
| D = Treed Bog | LM = Lowland Mix Forest | R = Red Pine | W = White Pine |
| E = Swamp Hardwoods | M = Maple, Beech, Birch | S = Black Spruce | X = Non Stocked |
| F = Spruce/Fir | MC = Mixed Conifer | T = Tamarack | Y = Sand |
| G = Grass | MD = Mixed Deciduous | Z = Water | |
| H = Hemlock | N = Marsh | | |

Density

| | |
|-----------------------------|------------------------|
| 0 = Non Stocked | 5 = Pole Timber Medium |
| 1 = Seedling Sapling Poor | 6 = Pole Timber Well |
| 2 = Seedling Sapling Medium | 7 = Saw Timber Poor |
| 3 = Seedling Sapling Well | 8 = Saw Timber Medium |
| 4 = Pole Timber Poor | 9 = Saw Timber Well |

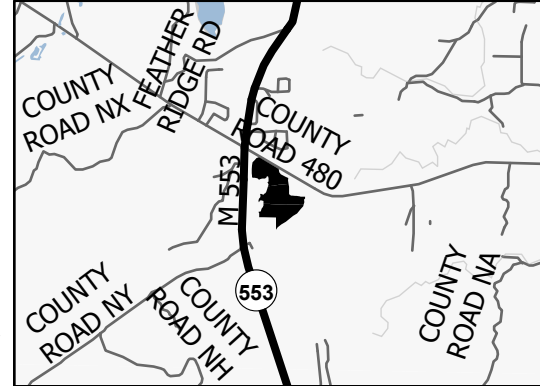
Locator Map 1:100,000

| Payment Unit Number | Acres |
|---------------------|-------|
| 1 | 25.6 |
| 2 | 26.6 |
| 3 | 25.2 |

**Comp 273
Contract Marking****77.4 Acres**

0 0.15 0.3 0.6 Miles

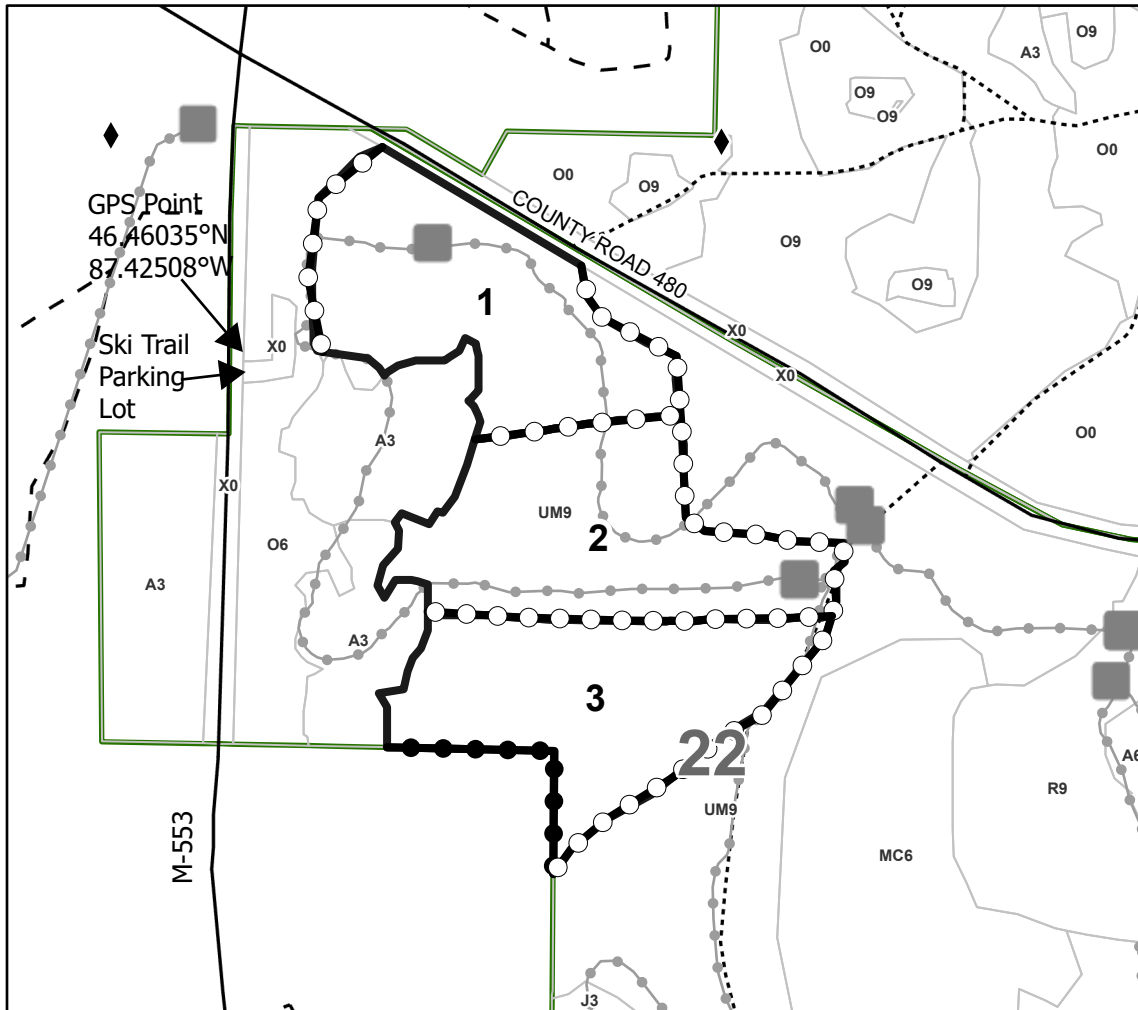
**Legend**

- Against State (red)
- Private Line (Blue)
- Payment Unit (Yellow)
- Administrative Access Only
- Paved Road
- Private Gravel/Dirt
- Recreational Trails
- Survey Grade Corner

Use QR Code to
open Map in App