

**TIMBER SALE MAP**

This information provided by authority of Part 525, 1994 PA 451, as amended.

Sale Number

**45-118-24**

Date

**06/12/2025**

Forest Management Unit

Sault Ste Marie Mgt Unit

County

Mackinac

Mapped By: Plato

Cruised By: Naubinway FO Staff

Scale

1:20,000

Page

1

Of

1

Township

44N

Range

08W

Section(s) and

Subdivision(s) Sec. 27 S1/2SE; Sec. 34 N1/2NW,N1/2NE,SENE; Sec. 35 NW,S1/2NE,NESW,N1/2SE;

**Cover Type**

A = Aspen	J = Jack Pine	O = Oak	U = Upland Brush
B = Paper Birch	K = Rock	P = Lowland Poplar	UM = Upland Mix Forest
C = Cedar	L = Lowland Brush	Q = Mixed Swamp Conifer	V = Bog or Marsh
D = Treed Bog	LM = Lowland Mix Forest	R = Red Pine	W = White Pine
E = Swamp Hardwoods	M = Maple, Beech, Birch	S = Black Spruce	X = Non Stocked
F = Spruce/Fir	MC = Mixed Conifer	T = Tamarack	Y = Sand
G = Grass	MD = Mixed Deciduous	Z = Water	
H = Hemlock	N = Marsh		

**Density**

0 = Non Stocked	5 = Pole Timber Medium
1 = Seedling Sapling Poor	6 = Pole Timber Well
2 = Seedling Sapling Medium	7 = Saw Timber Poor
3 = Seedling Sapling Well	8 = Saw Timber Medium
4 = Pole Timber Poor	9 = Saw Timber Well

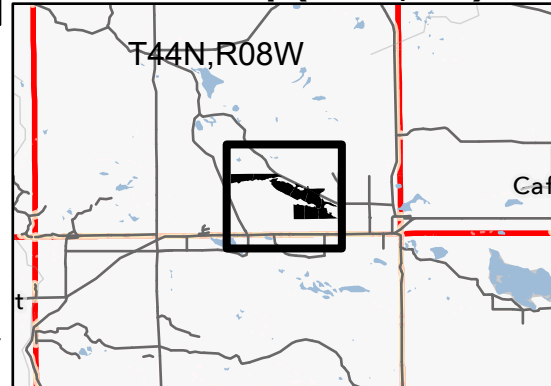
**Locator Map (1:200,000)**

PU #	Acres	PU #	Acres
1	30.2	6	11
2	22.8	7	32
3	39	8	29.2
4	31.3	9	27.1
5	32.5		

**Bird is the  
Word HW****255.1  
Acres**

0 0.3 0.6 1.2 Miles

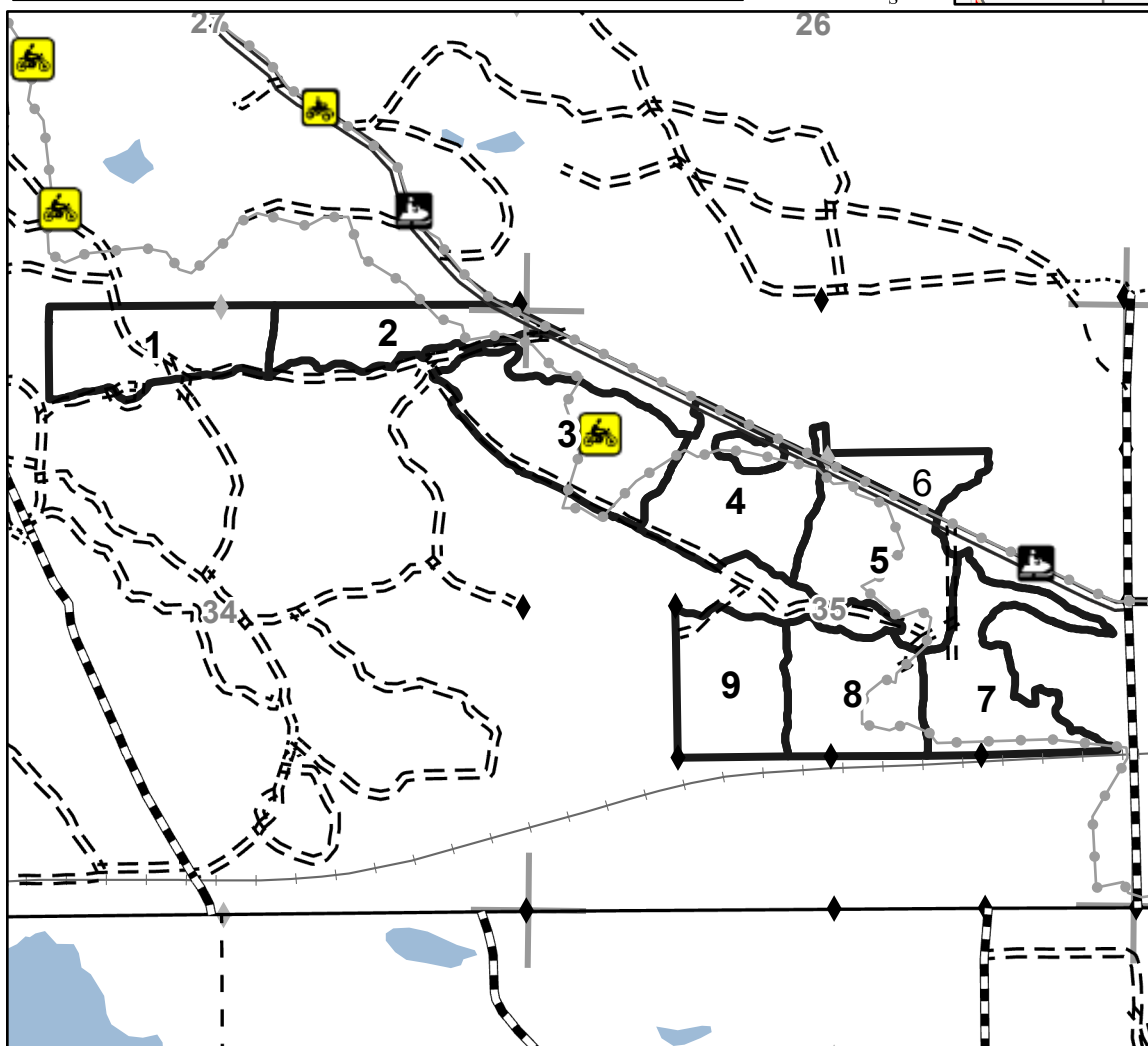
**Legend**

- Sale Boundary (Red)
- Payment Unit (Yellow)
- Private Line (Blue)
- Stand
- Recreational Trail
- Paved Road
- Gravel Road
- Active Railroad
- Primary Forest Road
- Forest Access Route
- Administrative Access Only
- Paved Road
- Government Gravel/Dirt
- Field Grade Corner
- Survey Grade Corner
- Section Corners
- Nearby Sales

Use QR Code to open Map in App

