



**DEPARTMENT OF NATURAL RESOURCES  
STATE OF MICHIGAN  
TIMBER SALE PROSPECTUS #7620**

**SCHEDULED SALE DATE AND TIME: 3:00 p.m. (local time) on July 23, 2025.**

**LOCATION: BALDWIN OFFICE, 2468 W 24TH STREET, BALDWIN, MI 49304.**

**PROSPECTUS NOTE:** The bidder is advised to inspect the sale area and review the location, estimated volumes, operating costs and contract terms of proposed sales. Please be aware that some landowners may request 60 days or more notice for access across their land.

Notice is hereby given that bids will be received by the Unit Manager, CADILLAC MANAGEMENT UNIT, for certain timber on the following described lands:

**Oaknado** (63-001-25) / T18N, R13W, SEC. 1 , N1/2NW.

T18N, R13W, SEC. 2 , NENE.

T19N, R13W, SEC. 35, SESE.

T19N, R13W, SEC. 36, SWSW.

Lake County, Advertised Price \$30,615.15, 25.2 Acres, Hardwood, Red Oak.

SALE NOTE: A recreation site such as a trail, pathway, or campground is within the sale area or the vicinity.  
Certain restrictions/specifications may be applicable including time restrictions.

**Back Side Pine** (63-024-24) / T22N, R05W, SEC. 1 , NWNW,SWSW.

T22N, R05W, SEC. 10, SENE,E1/2SE.

T22N, R05W, SEC. 11, NW,W1/2NE,W1/2SW.

T22N, R05W, SEC. 12, NWNW.

T22N, R05W, SEC. 2 , NW,NE,NWSW,S1/2SW,SWSE.

Missaukee County, Advertised Price \$88,969.95, 188.9 Acres, Red Pine, Jack Pine.

SALE NOTE: A recreation site such as a trail, pathway, or campground is within the sale area or the vicinity.  
Certain restrictions/specifications may be applicable including time restrictions.

**Tetris Mix** (63-025-24) / T22N, R09W, SEC. 10, NE.

T22N, R09W, SEC. 11, SWNW,E1/2SW.

T22N, R09W, SEC. 12, NENW,S1/2NW,N1/2SW,SESW.

T22N, R09W, SEC. 2 , N1/2NE.

T23N, R09W, SEC. 35, SWSE.

Wexford County, Advertised Price \$113,666.80, 142.5 Acres, Aspen, Hardwood.

SALE NOTE: A recreation site such as a trail, pathway, or campground is within the sale area or the vicinity.  
Certain restrictions/specifications may be applicable including time restrictions.

## BID INSTRUCTIONS (VER. 10/10/2022):

### 1. Scheduled Bid Location, Date, and Time (2/11)

Bids must be received by the Unit Manager, BALDWIN OFFICE, 2468 W 24th Street, Baldwin, MI 49304, no later than 3:00 p.m. (local time) on July 23, 2025. For further information concerning this sale, contact David Fisher at 231-745-4651 extension 9064.

### 2. Bidder's Qualifications (10/22)

If all or part of a timber sale was prepared by a private contractor, the contractor and that contractor's company are not permitted to bid on the timber sale. A person must be 18 years of age or older to purchase timber. Permanent employees of the Department of Natural Resources or members of their immediate household may not bid. Former employees, in the permanent or seasonal class, may not bid until 3 months after the last day of active duty. Bids will not be accepted from individuals or companies appearing on the DNR/FRD No-Bid List. This list contains the names of purchasers who previously failed to execute a contract within 21-days or who have a history of poor performance.

### 3. Preparation of Sealed Bids (5/16)

Bid Forms may be completed online thru Michigan DNR Timber Sale Online Bidding (OLB) at [www.michigan.gov/timberbidding](http://www.michigan.gov/timberbidding) or by completing the hardcopy Bid Form found in the Timber Sale Prospectus. Hardcopy Bid Forms shall be manually signed in ink. Registration in OLB is considered your 'signature' for all bids submitted thru that system. Bid prices must be entered for each species and product in the Bid Price column for all material subject to bidding and all fill-in blanks must be completed. If erasures or other changes appear on the hardcopy Bid Form, each erasure or change must be initialed by the person signing the bid.

### 4. Submission of Sealed Bids (5/16)

Bid forms may be obtained from the Unit Manager or thru OLB. Bids may be submitted hardcopy or thru OLB. All hardcopy bids must be submitted on the bid form and in an envelope clearly identified as described in this section. NOTE: Only one bid form per bid envelope. Sealed bids must be submitted to the Unit office designated in the prospectus and must be submitted at or prior to the time established in the prospectus. The envelope should show on the outside (a) the sale name or number and (b) the date and time of bid opening, as shown in the prospectus. Bids received after the time specified in the sale prospectus are late bids and will be rejected.

It is possible for a bidder to submit multiple bids on a single sale. For example, a bid may be submitted hardcopy and a bid may be submitted thru OLB. Or, two bidders from the same company could both submit bids on the same sale. If this were to happen, the State would accept all bids received and award the contract accordingly. All bidding and contractual requirements would apply to all bids received.

### 5. Public Opening of Sealed Bids (7/16)

If conditions permit, the sealed bids will be publicly opened and posted at the time and place set in the prospectus.

If a bidder, present at a bid opening, has submitted bids on more than one sale, that bidder may withdraw their unopened bid envelopes or announce the withdrawal of their online bid after being declared the successful bidder on one sale.

### 6. Award of Contract (1/11)

Award of the contract will be made to the Bidder whose bid, conforming to the prospectus, is most advantageous to the State of Michigan on the basis of total value at rates bid for the estimated quantities. The State reserves the right to reject any bid or waive any minor irregularity in bids received. A written award mailed (or otherwise furnished) to the successful Bidder shall be deemed to result in a binding contract without further action by either party.

### 7. Down Payment (1/11)

The Bidder to whom award is made must make a down payment within 21 days of the sale award. The amount of the down payment will be calculated as shown in the Bond and Payment Schedule of this prospectus. Only cash may be used to meet this requirement.

### 8. Performance Security (1/11)

As guarantee of faithful performance, a cash bond, certificate of deposit, surety bond or irrevocable letter of credit (LOC) is required within 21 days of the sale award. The amount of the performance security is shown in the Bond and

Payment Schedule of this prospectus. If an LOC or surety is used, the coverage must extend for at least 6 months beyond the contract expiration.

#### 9. Worker's Compensation (10/22)

Purchaser shall obtain worker's compensation insurance to cover claims under Michigan's Worker's Disability Compensation Act of 1969 or similar employee benefit act of any other state applicable to an employee. Verification of Worker's Disability Compensation Act Compliance must be completed and submitted within 21 days of contract award and prior to the issuance of the timber sale contract. In addition, if applicable, Notice of Exclusion or Certificate of Insurance must also be submitted.

#### 10. Timber Sale Contract (10/22)

Additional conditions and requirements common to all timber sales are listed on the timber sale contract (R4031) and are available on line at [www.michigan.gov/timber](http://www.michigan.gov/timber). Contact the Unit Manager for additional information or a sample contract. Within 21 days of the date of the award letter, the bidder must sign the contract and provide the required down payment, performance security, and verification of worker's disability compensation. The down payment and performance security shall be in accordance with the provisions of the timber sale contract, in the sums stated in this prospectus. If these actions are not taken, then the Bidder, the Bidder's corporation, and the corporation's principals may not be permitted to bid on State timber sales for a period of 3 months after the first offense, 6 months after the second offense, and 1 year after the third offense. An offense will only be counted against the Bidder for 5 years. In addition, the Bidder certifies that if awarded this contract, the Bidder will complete the timber sale contract in accordance with its terms and any modifications thereof including requirements to purchase, cut, and remove the included timber by the expiration date.

Payment Unit values in the State Forest Timber Sale Contract are calculated based on the advertised value of the Payment Unit as a percentage of the total advertised value of the contract. The advertised value of each Payment Unit is given in the Description of Timber by Payment Unit table on the Timber Sale Information page. For example, if the value of Payment Unit 1 is advertised as \$1,500 and the total Timber Sale value is advertised as \$10,000, the contract price for Payment Unit 1 will be 15% of the total bid price ( $\$1,500/\$10,000 * 100$ ).

#### 11. Disclaimer of Estimates and Bidder's Warranty of Inspection (10/22)

Before submitting this bid, the Bidder is advised and cautioned to inspect the sale area, review the requirements of the sale contract, and take other steps as may be reasonably necessary to ascertain the location, estimated volumes, construction estimates, and operating costs of the proposed sale. Failure to do so will not relieve the Bidder from responsibility for completing the contract.

The Bidder warrants that this bid is submitted solely on the basis of the Bidder's examination and inspection of the quality and quantity of the timber offered for sale and the Bidder's opinion of the value thereof and the costs of recovery. No reliance should be placed on the State of Michigan's estimates of timber quality, quantity or costs of recovery. Bidder further acknowledges that the State of Michigan: (i) expressly disclaims any warranty of fitness of timber for any purpose; (ii) offers this timber as is without any warranty of quality (merchantability) or quantity and (iii) expressly disclaims any warranty as to the quantity or quality of timber sold.

#### 12. Certification and Chain-of-Custody (10/22)

Unless otherwise indicated in the contract under section 7 – Other Conditions of the Sale Specific Conditions & Requirements, the area encompassed by this timber sale is certified to the standards of the Forest Stewardship Council (FSC) - Certificate #SCS-FM/COC-00090N and the Sustainable Forestry Initiative (SFI) - Certificate #NSF-SFIS-5Y031-SF5. Forest products from this sale may be delivered to the mill as "FSC 100% and / or SFI certified" as long as the contractor hauling the forest products is chain-of-custody (COC) certified or covered under a COC certificate from the destination mill. The purchaser is responsible for maintaining COC after leaving the sale area.

#### 13. Good Neighbor Authority (GNA) Requirements (10/22)

If the name of this timber sales contains the acronym GNA, it is authorized by the Good Neighbor Authority (GNA) and covered by various agreements between the U.S. Forest Service and the State. The timber sale occurs on federal land and the following conditions apply:

GNA contracts on US Forest Service land will not be awarded to purchasers on the Federal list of excluded parties. The System for Award Management (SAM) will be checked for active excluded parties prior to award of contract. In

addition, the Bidder to whom award is made must complete an Assurance Regarding Felony Conviction or Tax Delinquent Status for Corporate Applicants (AD-3031).

14. Good Neighbor Authority (GNA) Requirements, con't (10/22)

Bidder certifies, by signing this bid form, that to the best of Bidder's knowledge that the following representations are accurate and complete.

- a. That the Bidder and its principals are not presently debarred, suspended, proposed for debarment, declared ineligible, or voluntary excluded from timber sales (covered transactions) by any Federal department or agency.
- b. That the Bidder and its principals have not within a 3-year period preceding this bid been convicted of or had a civil judgment rendered against them for commission of fraud or a criminal offense in connection with obtaining , attempting to obtain, or performing a public (Federal, State, or local) transaction or contract under a public transaction; violation of Federal or State antitrust statutes or commission of embezzlement, theft, forgery, bribery, falsification or destruction of records, making false statements, or receiving stolen property.
- c. That the Bidder and its principals are not presently indicted for or otherwise criminally or civilly charged by a governmental entity (Federal, State, or local) with commission of any of the offenses enumerated in paragraph b of this certification.
- d. That the Bidder and its principals have not within a 3-year period preceding this bid had one or more public transactions (Federal, State, or local) terminated for breach or default of a timber or forest product contract.

Bidders that cannot certify this requirement, in whole or in part, shall submit an explanation with their bid.

Scott Bowen  
Director

## TIMBER SALE INFORMATION

Oaknado (63-001-25)

T18N, R13W, SEC. 1; T18N, R13W, SEC. 2; T19N, R13W, SEC. 35; T19N, R13W, SEC. 36.  
Lake County (Advertised Price \$30,615.15)

**SALE NOTE:** A recreation site such as a trail, pathway, or campground is within the sale area or the vicinity. Certain restrictions/specifications may be applicable including time restrictions.

A timber sale contract for this lump sum, sealed bid timber sale will be awarded to the responsible bidder offering the highest sealed bid price. All units of volume listed below were estimated using the Inventory Manager computer program and the new Michigan taper model. Bids must be at or above the following advertised price for each product and species:

<u>PRODUCTS &amp; SPECIES</u>	<u>ESTIMATED UNITS*</u>	<u>ADVERTISED PRICE</u>
Sawtimber		
B. T. Aspen	8.9 MBF	\$ 98.00 / MBF
Black/Red (Hybrid) Oak	98.4 MBF	\$ 101.00 / MBF
Red Oak	16.4 MBF	\$ 164.00 / MBF
White Oak	10.0 MBF	\$ 106.00 / MBF
Pulpwood		
B. T. Aspen	7 Cords	\$ 22.65 / Cord
Black/Red (Hybrid) Oak	305 Cords	\$ 34.00 / Cord
Misc. Species 2	41 Cords	\$ 10.00 / Cord
Red Maple	62 Cords	\$ 17.00 / Cord
Red Oak	47 Cords	\$ 34.00 / Cord
White Oak	68 Cords	\$ 34.00 / Cord
White Pine	6 Cords	\$ 25.40 / Cord

\* The total volume is statistically estimated within plus (+) or minus (-) 15.67 percent. There are an estimated 847 cords on this timber sale, plus or minus 133 cords at the 95% confidence level. The estimated units are final and not subject to adjustment. Prospective bidders are urged to examine this timber and to make their own estimates of quantity and quality.

### **BOND AND PAYMENT SCHEDULE:**

- A bond in the amount of \$1,531.00 to insure faithful performance of the conditions of the contract will be deposited by the successful bidder within 21 days of the sale award.
- Cutting in any sale or unit without the required advance payment would be considered a trespass.
- Total payment must be paid in advance or according to the following schedule :
  - Ten percent (10%) of the sale value must be paid within 21 days of the sale award.
  - The 10% down payment will be credited towards the first unit cut.
  - Payment for each of the following units must be made before cutting begins in that unit:
 

PAYMENT UNIT NUMBER	PERCENT OF TOTAL SALE VALUE
01	49.6%
02	50.4%
- If no cutting takes place, the 10% down payment will not be refunded.
- Operations on the contract issued will terminate on 09/30/2027.

### **SALE STATISTICS**

Volumes were calculated in cubic feet using the Michigan taper model. Cubic foot volume includes all wood inside bark for the product indicated. For display purposes, cubic feet were converted to cords and MBF using a simple conversion factor, e.g. 79 cubic feet per cord and 185 cubic feet per MBF. The cubic foot volumes are precise; the cords and MBF volumes are not. Cubic foot volume cannot be directly converted to cords or boards with precision.

### **SALE VOLUMES**

The total estimated sale volume may not equal the sum of the species/products due to the nature of statistical calculations associated with double sampling methodology.

VOLUME			STATISTICAL RANGE IN CORDS	
TOTAL CUBIC FEET	TOTAL CORDS	PERCENT ERROR	MINIMUM	MAXIMUM
66,909	847	15.67%	714	980

**VDU VOLUMES**

A VDU is a Volume Determination Unit. Volumes and their associated statistics are calculated at the VDU level and summarized to the sale level. There is often a one to one relationship between a VDU and a Payment Unit, but not always, depending on the cruise design. Refer to the VDU TO PAYMENT UNIT table.

	VOLUME			RANGE IN CORDS	
VDU	TOTAL CUBIC FEET	TOTAL CORDS	PERCENT ERROR	MINIMUM	MAXIMUM
13	32,718	414	22.99%	319	509
29	34,190	433	22.02%	338	528
<b>TOTAL:</b>	<b>66,909</b>	<b>847</b>		<b>656</b>	<b>1,037</b>

**VDU TO PAYMENT UNIT**

When a VDU is associated with more than one Payment Unit (PU), the VDU volumes are assigned to the PU based on acres of the VDU within the PU.

VDU	VDU ACRES	PU	PU ACRES
13	12.0	1	12.0
29	13.2	2	13.2
<b>TOTAL:</b>	<b>25.2</b>		<b>25.2</b>

**DESCRIPTION OF TIMBER BY PAYMENT UNIT (PU)**

PU	MARKET GROUP	PRODUCT	QUANTITY	UNIT	ACRES	ADVERTISE PRICE	
1	B. T. Aspen	Sawtimber	7.6	MBF	12.0	\$15,181.45	
	Black/Red (Hybrid		55.0	MBF			
	Red Oak		7.8	MBF			
	White Oak		7.7	MBF			
	B. T. Aspen	Pulpwood	5	Cords			
	Black/Red (Hybrid		108	Cords			
	Misc. Species 2		23	Cords			
	Red Maple		31	Cords			
	Red Oak		27	Cords			
	White Oak		39	Cords			
2	B. T. Aspen	Sawtimber	1.3	MBF	13.2	\$15,433.70	
	Black/Red (Hybrid		43.4	MBF			
	Red Oak		8.6	MBF			
	White Oak		2.3	MBF			
	B. T. Aspen	Pulpwood	2	Cords			
	Black/Red (Hybrid		197	Cords			
	Misc. Species 2		18	Cords			
	Red Maple		31	Cords			
	Red Oak		20	Cords			
	White Oak		29	Cords			
	White Pine		6	Cords			
TOTAL:			133.7	MBF			
TOTAL:			536	Cords			

## **Sale Specific Conditions & Requirements**

**Sale Name: Oaknado**

**Sale Number: 63-001-25 Seq#: 1**

### **1 - Sale Area**

#### **1.2 - Boundaries**

##### **1.2.1 - Painted Boundaries (9/19)**

The sale boundary and Payment Unit boundaries are marked and identified by red paint. Exterior sale boundary lines against state are marked with red paint. The painted boundary line trees are not Included Timber and are to be protected.

### **2 - Timber Specifications**

#### **2.1 - Included Timber**

##### **2.1.2 - Clearcut Unit(s) w/o Unmerchantable Trees (8/11)**

Within Payment Unit(s) 1-2, cut all trees which meet minimum piece specifications in 2.2 Utilization, except do not cut any red pine trees or trees marked with green paint.

##### **2.1.11 - Description of Timber Note (2/04)**

Note that Misc. species 1 is dead oak which is designated for cutting.

#### **2.2 - Utilization**

##### **2.2.1 - Full Tree Skidding Required (5/24)**

Within Payment Unit(s) 1-2, full tree skidding is required and must occur during snow off, unfrozen ground conditions. All trees are to be dragged from the stump to the landing to provide ground scarification, though undesigned trees, protected regeneration, and retention pockets should be avoided. This requirement is to expose mineral soil to promote regeneration.

##### **2.2.10 - No Chipping Tops and Limbs (8/16)**

Within Payment Unit(s) 1-2, chipping of the bole, 2 inches in diameter or greater, is allowed. Chipping of limbs or portions of the tree less than 2 inches in diameter is not permitted. Limbs and the remaining top must be left on site and scattered.

##### **2.2.11 - Chipping Restriction (9/14)**

If chipping occurs on this sale, then no woody debris present on the ground at the start of the sale may be chipped. In addition, brush or chips may not be stored or stockpiled on-site for more than 30 days.

### **3 - Payments**

#### **3.4 - Damaged Timber**

##### **3.4.2 - Special Protection Trees (4/14)**

The Purchaser shall not cut live or dead special protection trees within cutting units or clearings. Special protection trees are marked with green paint. If the Purchaser's operations have cut or damaged special protection trees through carelessness, the Purchaser shall pay \$500 as fixed, agreed and liquidated damages for each special protection tree cut or damaged. Such payment does not constitute ownership of the undesigned timber.

### **4 - Transportation**

#### **4.1 - Construction**

##### **4.1.12 - No New Roads (1/12)**

No new roads will be permitted in any Payment Unit. All operations are limited to existing roads. Skid trails only will be allowed.

#### **4.2 - Maintenance**

##### **4.2.1 - Hauling Restriction (12/08)**

Hauling may be restricted on forest roads by the Unit Manager or his/her representative. The restriction may occur during spring breakup or may occur during wet weather conditions.

##### **4.2.2 - Fill Material (4/07)**

To maintain roads, fill material may be needed in areas where "holes" exist or may be expected to develop. This fill material should be placed before trucking begins.

#### 4.2.4 - Grading (10/16)

For completion of the sale, state forest roads must be graded. In general, this will require a road grader or bulldozer to shape up the roads after forest products have been hauled off site. This includes cleaning of drainage areas, grading, crowning and filling with gravel, if necessary. The grading equipment to be used must be approved by the Unit Manager or his/her representative.

#### 4.2.5 - Two Wheel Drive Condition (2/04)

All existing trail roads on and adjacent to the Sale Area must be passable by two-wheel drive traffic for the duration of the sale.

### 4.3 - Public Right-of-Way

#### 4.3.2 - County R-O-W (12/06)

The County must be contacted prior to crossing or harvesting in the County Road R-O-W. This applies to Payment Units 1-2 and Centerline Road.

## 5 - Operations

### 5.1 - Notification

#### 5.1.1 - Pre-sale Conference (10/16)

A pre-sale conference on site between the Purchaser and Sale Administrator is required prior to beginning any operations to determine landing and road locations. The Unit Manager or his/her representative must be contacted at least 5 days in advance to schedule the conference.

#### 5.1.4 - Post-Sale Conference (10/16)

A post-sale conference on site between the Purchaser and sale administrator is required 5 days prior to the completion of active logging operations to determine clean-up and repair of landings, road edges, and the fulfillment of other contract specifications.

### 5.2 - Conduct of Operations

#### 5.2.1 - Slash

##### 5.2.1.1 - Slash Within Sale Area (9/16)

No trees are to be felled outside the Sale Area, and all slash is to be kept at least 10 feet back from the red paint line. If sale boundary lines are along a public road or highway, then slash must be removed 50' from these lines per General Condition & Requirement 5.2.1.

##### 5.2.1.8 - Slash Height (12/08)

No slash or tree tops may exceed 24 inches in height.

##### 5.2.1.12 - Slash for Prescribed Burning (1/05)

To facilitate prescribed burning, slash shall be moved at least 10 feet inside the sale boundary. Slash cannot be piled or placed near residual trees.

#### 5.2.2 - Hazard Trees/Snags

##### 5.2.2.1 - Den Trees (10/16)

Obvious hollow and/or den trees shall be protected and left standing unless they are a safety hazard.

#### 5.2.3 - Operating Restrictions

##### 5.2.3.4 - Oak Wilt Restriction, No Exceptions (1/18)

Within Payment Units 1-2, cutting, skidding, hauling within the sale and brushing of access roads to the sale are not permitted during the period of April 15 to July 15. No exceptions will be granted. This is necessary to reduce the spread of oak wilt.

#### 5.2.4 - Dead and Down Creation



#### 5.2.4.7 - Dead and Down Creation: Hare, Grouse, Deer and Other Species (5/15)

To improve horizontal cover habitat for snowshoe hare, grouse, deer, and other species, the Purchaser is to push over one live, healthy, log-sized hardwood species per two acres. These trees should be tipped over with the root ball still attached so the base of the tree is suspended off the ground. The crown of the fallen tree should be at or near ground level after it is pushed over.

#### 5.2.29 - Shrub Protection (1/20)

Do not cut or damage hawthorn, witch-hazel, dogwood or junberry. These woody-shrub plants are highly beneficial to various wildlife species.

#### 5.2.32 - Decking/Landing Restoration (9/13)

All decking and landing areas must have the surface area restored to a condition equal to or better than before. This is to ensure the proper regeneration of the stand. Wood debris, chips and "cookies" from trimmings must be removed or scattered away from landing and loading areas and may not be windrowed on the edge.

#### 5.2.38 - No Decking Against Live Trees (2/04)

Cut products may not be decked against unmarked or designated leave trees.

#### 5.2.39 - ORV Trail/Route Protection (4/18)

The ORV trail or route is shown on the Timber Sale Map. Do not cut trees or damage posts with yellow ORV markers. Trees with yellow ORV markers shall be cut off above the markers and at least 5 feet above ground. All stumps within 5 feet of the trail must be cut flush with the ground. Maintain a 20-foot-wide slash, debris, and rut free zone daily using the ORV trail or route as the centerline. Skidding across the trail or route may only occur in locations approved by the Sale Administrator.

#### 5.2.40 - Pathway Protection (10/10)

The motorcycle single-track trail and is shown on the Timber Sale Map. Do not cut trees or damage posts with markers. Maintain a 20-foot-wide slash, debris, and rut free zone daily, using the pathway as the centerline. Do not run equipment down the pathway. Skidding across the trail may only occur in locations approved by the Sale Administrator.

#### 5.2.41 - Snowmobile Trail Protection (9/11)

The snowmobile trail is shown on the Timber Sale Map. Do not cut or damage posts with orange trail markers or traffic control signs. If the trail is used, it must be maintained and restored to a condition equal to or better than before the sale. The road maintenance/restoration must be done prior to December 1. If the trail is used for hauling, it must be graded to the satisfaction of the Unit Manager or his/her representative prior to December 1. The snowmobile trail may not be hauled on from December 1 to March 31. Crossing only will be allowed during this time. The snowmobile trail may only be crossed at right angles. Maintain a 20-foot-wide slash, debris, and rut free zone daily using the snowmobile trail as the centerline. No decking of forest products will be permitted along the snowmobile trail. All stumps within 20 feet of the snowmobile trail must be cut at ground level.

### 5.4 - Soil Protection

#### 5.4.1 - Rutting Restriction, General (7/16)

Operations are to cease immediately if equipment and weather conditions result in rutting of roads and/or skid trails which is 12 inches or greater in depth and 50 feet in length. The Unit Manager or his/her representative may restrict hauling and/or skidding if ruts exceed the specified depth. With the Unit Manager or his/her representative's approval, the Purchaser may return to the area when the risk of rutting has decreased.

#### 5.4.4 - Slope Protection (9/19)

Skid trails and roads on slopes shall be water barred with slash and stumps as soon as use is complete to prevent erosion.

#### 5.4.5 - Soil Caution (11/04)

Care must be taken to minimize soil damage due to the sandy soils.

## 6 - Safety and Fire Prevention

### 6.2 - Signing

#### 6.2.1 - Road Posting (10/20)

The Purchaser is responsible for posting and maintaining caution signs on Centerline Road and the unnamed state road in Payment Unit 1 prior to beginning operations. The road must be posted at appropriate distances from the Sale Area to warn

of logging activity and truck traffic. Signs must be removed when harvest operations are suspended or completed. The Purchaser will provide these signs.

#### 6.2.2 - Snowmobile Trail Posting (10/20)

The Purchaser is responsible for posting and maintaining caution signs on the snowmobile trail prior to beginning operations during the snowmobile season (approximately December 1 to March 31). The trail must be posted at appropriate distances from the Sale Area to warn of logging activity and truck traffic. Signs must be removed when harvest operations are suspended or completed. The Purchaser will provide these signs.

#### 6.2.3 - Recreational Trail Posting (10/20)

The Purchaser is responsible for posting and maintaining caution signs on the motorcycle single track prior to beginning operations. The trail must be posted at appropriate distances from the Sale Area to warn of logging activity and truck traffic at both ends of the trail. Signs must be removed when harvest operations are suspended or completed. The Purchaser will provide these signs.

### 7 - Other Conditions

#### 7.5 - Loss

##### 7.5.1 - Deteriorating Timber (7/09)

The Sale Area has received damage from oak decline. The Purchaser should harvest the wood as soon as possible. The Department of Natural Resources is held free of responsibility of any further damage or deterioration due to delay in harvesting.



**TIMBER SALE MAP**

This information provided by authority of Part 525, 1994 PA 451, as amended.

Sale Number  
**63-001-25**

Date  
**01/17/2025**

Forest Management Unit	County	Mapped By: Park	Scale	Page	Of
Cadillac Mgt Unit	Lake	Cruised By: Park, Lewis	1:10,000	1	1

Township	Range	Section(s) and
18N / 19N	13W	Subdivision(s) Sec. 1 N1/2NW; Sec. 2 NENE; Sec. 35 SESE; Sec. 36 SWSW;

**Cover Type**

A = Aspen	J = Jack Pine	O = Oak	U = Upland Brush
B = Paper Birch	K = Rock	P = Lowland Poplar	UM = Upland Mix Forest
C = Cedar	L = Lowland Brush	Q = Mixed Swamp Conifer	V = Bog or Marsh
D = Treed Bog	LM = Lowland Mix Forest	R = Red Pine	W = White Pine
E = Swamp Hardwoods	M = Maple, Beech, Birch	S = Black Spruce	X = Non Stocked
F = Spruce/Fir	MC = Mixed Conifer	T = Tamarack	Y = Sand
G = Grass	MD = Mixed Deciduous	Z = Water	
H = Hemlock	N = Marsh		

**Density**

0 = Non Stocked	5 = Pole Timber Medium
1 = Seedling Sapling Poor	6 = Pole Timber Well
2 = Seedling Sapling Medium	7 = Saw Timber Poor
3 = Seedling Sapling Well	8 = Saw Timber Medium
4 = Pole Timber Poor	9 = Saw Timber Well

Payment Unit Number	Acres
1	12
2	13.2

**Oaknado**

**25.2 Acres**

**Locator Map 1:100,000**

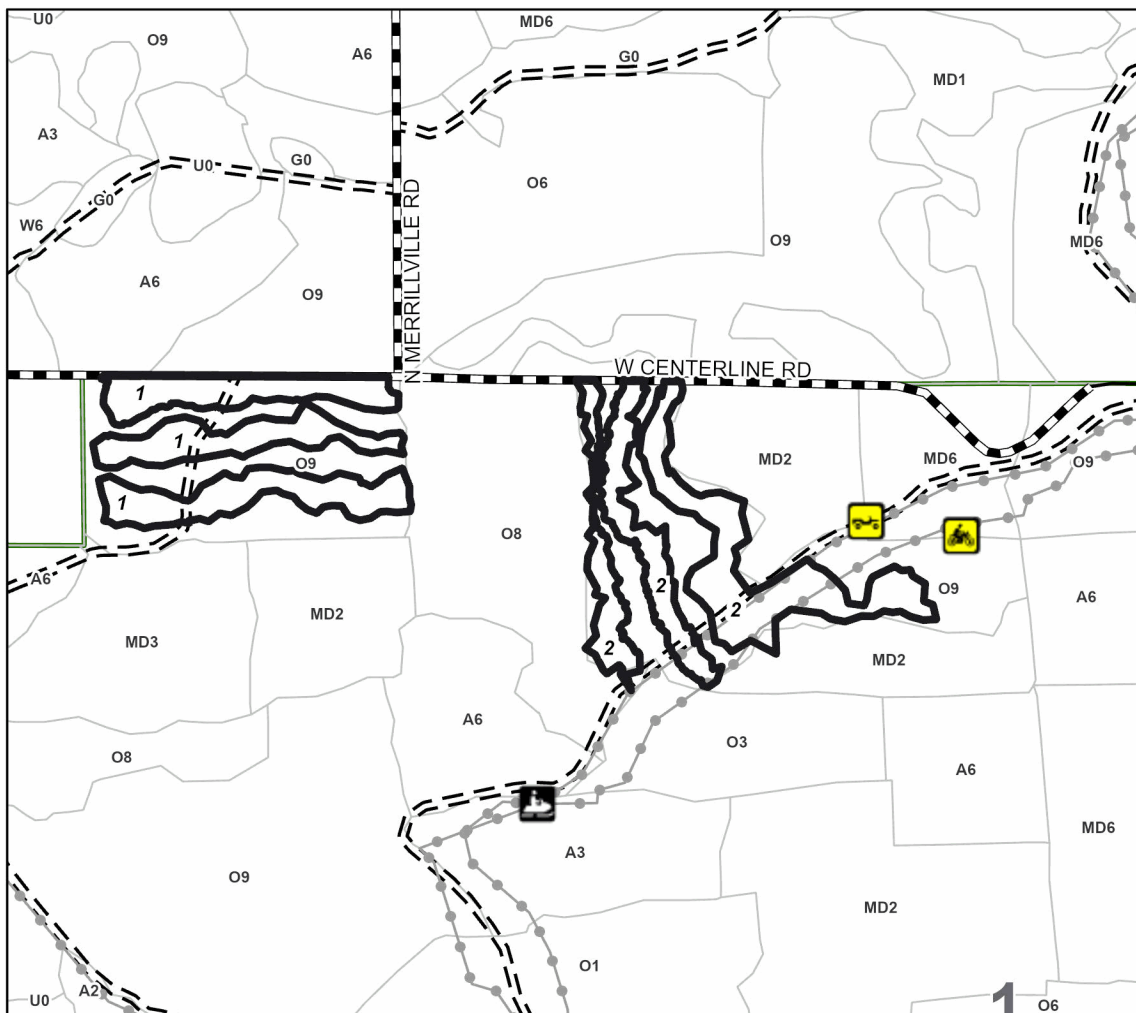
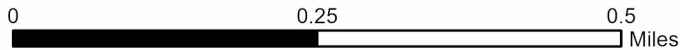
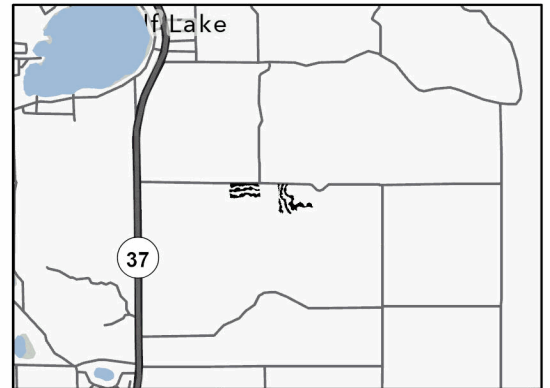

**Legend**

- Against State (Red)
- Forest Access Route
- Paved Road
- Government Gravel/Dirt
- Recreational Trails





## TIMBER SALE INFORMATION

### Back Side Pine (63-024-24)

T22N, R05W, SEC. 1; T22N, R05W, SEC. 10; T22N, R05W, SEC. 11; T22N, R05W, SEC. 12; T22N, R05W, SEC. 2.  
Missaukee County (Advertised Price \$88,969.95)

**SALE NOTE:** A recreation site such as a trail, pathway, or campground is within the sale area or the vicinity. Certain restrictions/specifications may be applicable including time restrictions.

A timber sale contract for this lump sum, sealed bid timber sale will be awarded to the responsible bidder offering the highest sealed bid price. All units of volume listed below were estimated using the Inventory Manager computer program and the new Michigan taper model. Bids must be at or above the following advertised price for each product and species:

<u>PRODUCTS &amp; SPECIES</u>	<u>ESTIMATED UNITS*</u>		<u>ADVERTISED PRICE</u>
Sawtimber			
Jack Pine	114.2	MBF	\$ 38.00 / MBF
Red Oak	11.5	MBF	\$ 121.00 / MBF
Red Pine	544.0	MBF	\$ 73.00 / MBF
White Pine	85.6	MBF	\$ 44.00 / MBF
Pulpwood			
Jack Pine	796	Cords	\$ 10.70 / Cord
Mixed Aspen	32	Cords	\$ 16.60 / Cord
Mixed Hardwood	328	Cords	\$ 12.50 / Cord
Mixed Oak	23	Cords	\$ 24.95 / Cord
Norway Spruce	4	Cords	\$ 8.25 / Cord
Red Pine	778	Cords	\$ 31.10 / Cord
Scotch Pine	2	Cords	\$ 11.90 / Cord
White Pine	96	Cords	\$ 18.60 / Cord

\* The total volume is statistically estimated within plus (+) or minus (-) 13.81 percent. There are an estimated 5,122 cords on this timber sale, plus or minus 708 cords at the 95% confidence level. The estimated units are final and not subject to adjustment. Prospective bidders are urged to examine this timber and to make their own estimates of quantity and quality.

### **BOND AND PAYMENT SCHEDULE:**

1. A bond in the amount of \$8,897.00 to insure faithful performance of the conditions of the contract will be deposited by the successful bidder within 21 days of the sale award.
2. Cutting in any sale or unit without the required advance payment would be considered a trespass.
3. Total payment must be paid in advance or according to the following schedule:
  - (a) Ten percent (10%) of the sale value must be paid within 21 days of the sale award.
  - (b) The 10% down payment will be credited towards the first unit cut.
  - (c) Payment for each of the following units must be made before cutting begins in that unit:

<u>PAYMENT UNIT NUMBER</u>	<u>PERCENT OF TOTAL SALE VALUE</u>
01	10.3%
02	60.5%
03	8.2%
04	1.5%
05	19.5%

4. If no cutting takes place, the 10% down payment will not be refunded.
5. Operations on the contract issued will terminate on 12/31/2028.

### **SALE STATISTICS**

Volumes were calculated in cubic feet using the Michigan taper model. Cubic foot volume includes all wood inside bark for the product indicated. For display purposes, cubic feet were converted to cords and MBF using a simple conversion factor, e.g. 79 cubic feet per cord and 185 cubic feet per MBF. The cubic foot volumes are precise; the cords and MBF volumes are not. Cubic foot volume cannot be directly converted to cords or boards with precision.

SALE VOLUMES

The total estimated sale volume may not equal the sum of the species/products due to the nature of statistical calculations associated with double sampling methodology.

VOLUME			STATISTICAL RANGE IN CORDS	
TOTAL CUBIC FEET	TOTAL CORDS	PERCENT ERROR	MINIMUM	MAXIMUM
404,602	5,122	13.81%	4,414	5,829

VDU VOLUMES

A VDU is a Volume Determination Unit. Volumes and their associated statistics are calculated at the VDU level and summarized to the sale level. There is often a one to one relationship between a VDU and a Payment Unit, but not always, depending on the cruise design. Refer to the VDU TO PAYMENT UNIT table.

	VOLUME			RANGE IN CORDS	
VDU	TOTAL CUBIC FEET	TOTAL CORDS	PERCENT ERROR	MINIMUM	MAXIMUM
15	25,018	317	38.75%	194	439
30	43,639	552	39.41%	335	770
39	52,383	663	27.59%	480	846
41	142,477	1,804	25.30%	1,347	2,260
49	133,375	1,688	27.81%	1,219	2,158
69	7,709	98	69.70%	30	166
TOTAL:	404,602	5,122		3,604	6,639

VDU TO PAYMENT UNIT

When a VDU is associated with more than one Payment Unit (PU), the VDU volumes are assigned to the PU based on acres of the VDU within the PU.

VDU	VDU ACRES	PU	PU ACRES
15	59.5	2	59.5
30	31.9	1	31.9
39	35.5	3	35.5
41	40.2	5	40.2
49	16.5	2	16.5
69	5.3	4	5.3
TOTAL:	188.9		188.9

**DESCRIPTION OF TIMBER BY PAYMENT UNIT (PU)**

PU	MARKET GROUP	PRODUCT	QUANTITY	UNIT	ACRES	ADVERTISE PRICE
1	Jack Pine	Sawtimber	46.2	MBF	31.9	\$9,199.15
	Red Oak		11.5	MBF		
	Red Pine		12.1	MBF		
	White Pine		6.5	MBF		
	Jack Pine	Pulpwood	208	Cords		
	<i>Jack Pine</i>		208	<i>Cords</i>		
	Mixed Hardwood		109	Cords		
	<i>Black Cherry</i>	<i>Sawtimber</i>	5.4	<i>MBF</i>		
	<i>Red Maple</i>		13.1	<i>MBF</i>		
	<i>Black Cherry</i>	<i>Pulpwood</i>	5	<i>Cords</i>		
	<i>Red Maple</i>		67	<i>Cords</i>		
	Mixed Oak		23	Cords		
	<i>/Red (Hybrid) Oak</i>		6	<i>Cords</i>		
	<i>Red Oak</i>		17	<i>Cords</i>		
	Red Pine		16	Cords		
	<i>Red Pine</i>		16	<i>Cords</i>		
	White Pine		12	Cords		
	<i>White Pine</i>		12	<i>Cords</i>		
2	Jack Pine	Pulpwood	129	Cords	76.0	\$48,568.40
	<i>Jack Pine</i>	<i>Sawtimber</i>	6.1	<i>MBF</i>		
	<i>Jack Pine</i>	<i>Pulpwood</i>	117	<i>Cords</i>		
	Mixed Aspen		10	Cords		
	<i>Quaking Aspen</i>	<i>Sawtimber</i>	1.3	<i>MBF</i>		
	<i>Quaking Aspen</i>	<i>Pulpwood</i>	7	<i>Cords</i>		
	Mixed Hardwood		113	Cords		
	<i>Black Cherry</i>	<i>Sawtimber</i>	16.5	<i>MBF</i>		
	<i>Black Cherry</i>	<i>Pulpwood</i>	78	<i>Cords</i>		
	<i>Red Maple</i>		2	<i>Cords</i>		
	Red Pine		1,326	Cords		
	<i>Red Pine</i>	<i>Sawtimber</i>	440.6	<i>MBF</i>		
	<i>Red Pine</i>	<i>Pulpwood</i>	445	<i>Cords</i>		
	White Pine		235	Cords		
	<i>White Pine</i>	<i>Sawtimber</i>	91.1	<i>MBF</i>		
	<i>White Pine</i>	<i>Pulpwood</i>	53	<i>Cords</i>		
3	Jack Pine	Sawtimber	48.8	MBF	35.5	\$7,252.80
	Jack Pine	Pulpwood	426	Cords		
	<i>Jack Pine</i>		426	<i>Cords</i>		
	Mixed Aspen		22	Cords		
	<i>Quaking Aspen</i>	<i>Sawtimber</i>	7.9	<i>MBF</i>		
	<i>Quaking Aspen</i>	<i>Pulpwood</i>	6	<i>Cords</i>		
	Mixed Hardwood		38	Cords		
	<i>Black Cherry</i>	<i>Sawtimber</i>	1.9	<i>MBF</i>		
	<i>Black Cherry</i>	<i>Pulpwood</i>	9	<i>Cords</i>		
	<i>Red Maple</i>		25	<i>Cords</i>		
4	Jack Pine	Sawtimber	19.2	MBF	5.3	\$1,331.00
	Jack Pine	Pulpwood	27	Cords		
	<i>Jack Pine</i>		27	<i>Cords</i>		
	Mixed Hardwood		25	Cords		
	<i>Red Maple</i>		25	<i>Cords</i>		
5	Red Pine	Sawtimber	94.0	MBF	40.2	\$17,352.90
	White Pine		0.4	MBF		
	Jack Pine	Pulpwood	6	Cords		
	<i>Jack Pine</i>		6	<i>Cords</i>		
	Mixed Hardwood		43	Cords		
	<i>Black Cherry</i>	<i>Sawtimber</i>	6.2	<i>MBF</i>		
	<i>Black Cherry</i>	<i>Pulpwood</i>	31	<i>Cords</i>		

DESCRIPTION OF TIMBER BY PAYMENT UNIT (PU), CON'T

PU	MARKET GROUP	PRODUCT	QUANTITY	UNIT	ACRES	ADVERTISE PRICE
5 con't	Norway Spruce	Pulpwood	4	Cords		
	Norway Spruce	Sawtimber	1.3	MBF		
	Norway Spruce	Pulpwood	1	Cords		
	Red Pine		312	Cords		
	Red Pine		312	Cords		
	Scotch Pine		2	Cords		
	Scotch Pine	Sawtimber	0.3	MBF		
	Scotch Pine	Pulpwood	1	Cords		
	White Pine		6	Cords		
	White Pine		6	Cords		
TOTAL:			238.7	MBF		
TOTAL:			3,092	Cords		



## **Sale Specific Conditions & Requirements**

**Sale Name: Back Side Pine**

**Sale Number: 63-024-24 Seq#: 2**

### **1 - Sale Area**

#### **1.2 - Boundaries**

##### **1.2.1 - Painted Boundaries (9/19)**

The sale boundary and Payment Unit boundaries are marked and identified by red and green paint. Exterior sale boundary lines against state are marked with red paint. Interior Payment Unit boundaries are marked with green paint. The painted boundary line trees are not Included Timber and are to be protected. Green painted trees designating an interior Payment Unit boundary are only to be cut when all surrounding Payment Units have been paid.

### **2 - Timber Specifications**

#### **2.1 - Included Timber**

##### **2.1.1 - Clearcut Unit(s) with Unmerchantable Trees (6/14)**

Within Payment Unit(s) 1-4, cut all trees that are two (2) inches or more at DBH. Within Payment Unit 4, do not cut red or white pine that are 13 inches or more at DBH.

##### **2.1.8 - Designated Plantation Row Unit(s) (12/08)**

Within Payment Unit(s) 5, all trees which meet minimum piece specifications in 2.2 Utilization, within designated plantation rows are designated for cutting. Designated plantation rows are every third row. Begin with the third row in from the outside of the plantation, then continue every third row. Because of the variability of row direction, it shall be the responsibility of the Purchaser to maintain the third-row sequence.

### **3 - Payments**

#### **3.3 - Pre-measured Sales**

##### **3.3.4 - Dividing Payment Units (7/14)**

Payment Unit(s) 1-5 may be divided at the request of the Purchaser and upon approval of the Unit Manager. Dividing Payment Units is a contract modification which requires a Timber Sale Contract Amendment.

### **4 - Transportation**

#### **4.1 - Construction**

##### **4.1.1 - Stream crossings, general (3/11)**

All stream crossing structures will be temporary and therefore, shall be provided by the Purchaser, and must be removed upon completion of the sale. All permits for stream crossings will be provided by the DNR.

##### **4.1.6 - Road Construction (4/24)**

Construction of new roads or improvements of existing roads shall be done in such a way as to minimize the environmental and visual impacts. Merchantable trees shall be cut and utilized unless otherwise directed. Non-merchantable trees shall be severed and laid flat on the ground. Slash shall be scattered, and not left in windrows and kept a minimum of 10 feet back from the road edge. Stumps shall be set upright, not left on edge, and be moved at least 10 feet away from the road edge.

##### **4.1.7 - Road Closure (10/11)**

All new roads built into the sale must be blocked to vehicle traffic within 30 days of completion of hauling. Overgrown roads that are reopened shall be considered new roads. In general, this will require constructing a six (6') foot high berm of stumps and logs covered with earth. Stumps and brush must be placed along the remainder of the trail. Berms may also be placed at intervals of not over 50 feet and at all junctions. These roads must be rendered impassable to cars and trucks. All stumps from road building and landing construction must be reserved to block any newly constructed roads upon completion of the sale. These stumps must be scattered along the road system to prohibit vehicular movement. Temporary berms may be required if no sale activity occurs for 30 or more consecutive days. Contact the Sale Administrator for specific details of design and placement.

##### **4.1.8 - Road Work (1) (8/07)**

The following road work is required: Fill and 12a stone (cap) within large blowout areas are required to access Payment Units 3 and 4.

#### 4.1.9 - Road Work (2) (12/08)

On the Payment Unit 3 and 4 access road, the Purchaser must ditch and crown a half (1/2) mile portion of this road as designated by the Sale Administrator, before any gravel is placed. A final grading on this portion of the road must be done when hauling is complete. The Purchaser is required to purchase and spread 20 cu. yards of pit run gravel with maximum stone size of 6 inches in diameter. The Purchaser is required to purchase and spread 10 cu. yards of 23A crushed gravel. Gravel placement will be as designated by the Sale Administrator.

#### 4.2 - Maintenance

##### 4.2.5 - Two Wheel Drive Condition (2/04)

All existing trail roads on and adjacent to the Sale Area must be passable by two-wheel drive traffic for the duration of the sale.

### 5 - Operations

#### 5.2 - Conduct of Operations

##### 5.2.1 - Slash

###### 5.2.1.8 - Slash Height (12/08)

No slash may exceed 24 inches in height.

##### 5.2.2 - Hazard Trees/Snags

###### 5.2.2.1 - Den Trees (10/16)

Obvious hollow and/or den trees shall be protected and left standing unless they are a safety hazard.

##### 5.2.3 - Operating Restrictions

###### 5.2.3.1 - Operating Restrictions (9/11)

Within Payment Unit(s) 1-5, unless changed by agreement with Unit Manager or their representative, cutting, skidding, and hauling are limited to frozen winter ground or dry summer. This restriction is wet ground conditions.

###### 5.2.3.3 - Bark Slippage Restriction (3/09)

Within Payment Unit(s) 5, unless changed by written agreement, cutting and skidding are not permitted during the period of April 15 to July 15. This restriction is because of bark slippage.

##### 5.2.4 - Dead and Down Creation

###### 5.2.4.5 - Dead and Down Creation, Reptiles and Amphibians (2/05)

To encourage reptiles and amphibians, within Payment Unit(s) 4, leave one, 14-inch DBH or more full-length tree on the ground, with the top still intact, for every 5 acres. These trees shall be evenly scattered throughout the Payment Unit(s) and identified by blue flagging.

##### 5.2.17 - Timber Mats and Interlocking Composite Mats (5/23)

Some roads or skid trails may require extra protection such as that afforded by timber mats, interlocking composite mats, or another approved system. Approximately 40 feet of road or trail will need extra protection at locations shown on the Timber Sale Map. If available, mats may be borrowed from the DNR. A Timber Sale Contract Amendment will be used to document the Purchaser's use of the DNR's mats. Contact the Sale Administrator regarding availability and pick-up. Timber mats are available from various field offices. Composite mats are only available from the Grayling field office and the Marquette ICC. The Purchaser is responsible for picking up and hauling the mats to and from the site. The composite mats will require DNR staff onsite for installation and removal. Contact the Sale Administrator to schedule at least 30 days before desired install/removal date. All mats must be cleaned prior to drop off. This may include, but is not limited to, power washing and brushing to remove mud and debris. A charge of \$700.00 per timber mat and \$2,000.00 per composite mat will be assessed for all damaged or non-returned mats. Damage for the crane/timber mats is defined as three or more broken cants. Damage for the composite mats is defined as cracked or broken mats.

##### 5.2.32 - Decking/Landing Restoration (9/13)

All decking and landing areas must have the surface area restored to a condition equal to or better than before. This is to

ensure the proper regeneration of the stand. Wood debris, chips and "cookies" from trimmings must be removed or scattered away from landing and loading areas and may not be windrowed on the edge.

#### 5.2.38 - No Decking Against Live Trees (2/04)

Cut products may not be decked against unmarked or designated leave trees.

#### 5.2.41 - Snowmobile Trail Protection (9/11)

A snowmobile trail and is shown on the Timber Sale Map. Do not cut or damage posts with orange trail markers or traffic control signs. If the trail is used, it must be maintained and restored to a condition equal to or better than before the sale. The road maintenance/restoration must be done prior to December 1. If the trail is used for hauling, it must be graded to the satisfaction of the Unit Manager or his/her representative prior to December 1. If the trail road is to be used for hauling during the snowmobile season, then a snow-covered base must be left on the trail. Maintain a 20-foot-wide slash, debris, and rut free zone daily using the snowmobile trail as the centerline. All stumps within 20 feet of the snowmobile trail must be cut at ground level.

### 5.4 - Soil Protection

#### 5.4.1 - Rutting Restriction, General (7/16)

Operations are to cease immediately if equipment and weather conditions result in rutting of roads and/or skid trails which is 12 inches or greater in depth and 50 feet in length. The Unit Manager or his/her representative may restrict hauling and/or skidding if ruts exceed the specified depth. With the Unit Manager or his/her representative's approval, the Purchaser may return to the area when the risk of rutting has decreased.

### 5.8 - Protection of Endangered Species

#### 5.8.5 - Protection of Raptor Nests (3/13)

All trees with raptor nests will be protected if found during harvesting operations. Notification will be made to the Unit Manager or his/her representative who will notify the Wildlife Biologist so an onsite evaluation and recommendation can be made, if necessary.

## 6 - Safety and Fire Prevention

### 6.2 - Signing

#### 6.2.1 - Road Posting (10/20)

The Purchaser is responsible for posting and maintaining caution signs on forest and county or state roads adjoining any Payment Unit prior to beginning operations. The road must be posted at appropriate distances from the Sale Area to warn of logging activity and truck traffic. Signs must be removed when harvest operations are suspended or completed. The Purchaser will provide these signs.

#### 6.2.2 - Snowmobile Trail Posting (10/20)

The Purchaser is responsible for posting and maintaining caution signs on the snowmobile trail prior to beginning operations during the snowmobile season (approximately December 1 to March 31). The trail must be posted at appropriate distances from the Sale Area to warn of logging activity and truck traffic. Signs must be removed when harvest operations are suspended or completed. The Purchaser will provide these signs.

## 7 - Other Conditions

### 7.2 - Extensions

#### 7.2.5 - Weather-Related Extension (1/13)

If weather conditions during the operating period of this contract prevent harvesting, this sale may qualify for a weather-related extension. If approved, the normal extension fee would be waived. To qualify, there must be a documented attempt each year to harvest in the difficult portion of the sale.



**TIMBER SALE MAP**

This information provided by authority of Part 525, 1994 PA 451, as amended.

Sale Number  
**63-024-24**

Date  
**09/13/2024**

Forest Management Unit Cadillac	County Missaukee	Mapped By: Krugh	Scale 1:20,000	Page 1	Of 1
		Cruised By: Manton FO			

Township 22N	Range 5W	Section(s) and Subdivision(s)
		1 NWNW,SWSW 2 NW,NE,NWSW,S1/2SW,SWSE 10 SENE,E1/2SE 11 NW,W1/2NE,W1/2SW 12 NWNW

**Cover Type**

A = Aspen	J = Jack Pine	O = Oak	U = Upland Brush
B = Paper Birch	K = Rock	P = Lowland Poplar	UM = Upland Mix Forest
C = Cedar	L = Lowland Brush	Q = Mixed Swamp Conifer	V = Bog or Marsh
D = Treed Bog	LM = Lowland Mix Forest	R = Red Pine	W = White Pine
E = Swamp Hardwoods	M = Maple, Beech, Birch	S = Black Spruce	X = Non Stocked
F = Spruce/Fir	MC = Mixed Conifer	T = Tamarack	Y = Sand
G = Grass	MD = Mixed Deciduous		Z = Water
H = Hemlock	N = Marsh		

**Density**

0 = Non Stocked	5 = Pole Timber Medium
1 = Seedling Sapling Poor	6 = Pole Timber Well
2 = Seedling Sapling Medium	7 = Saw Timber Poor
3 = Seedling Sapling Well	8 = Saw Timber Medium
4 = Pole Timber Poor	9 = Saw Timber Well

**Backside Pine**

**Acres 188.9**



**PU # Acres**

1	31.9
2	76
3	35.5
4	5.3
5	40.2

**Legend**

- Sale Boundary (Red)
- Stand
- Payment Unit (Green)
- Recreational Trail
- Paved Road
- Highway
- Field Grade Corner
- Survey Grade Corner

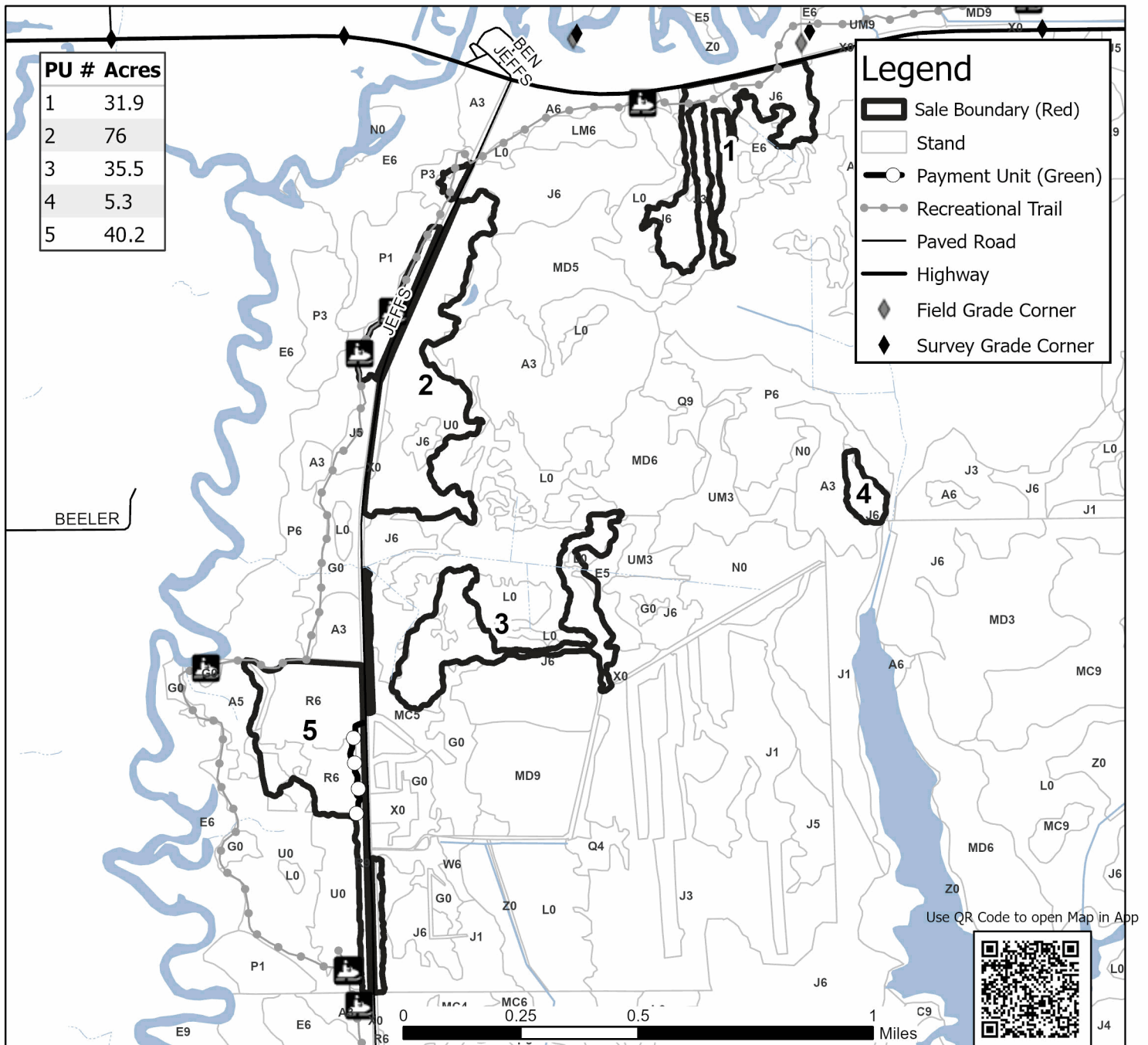

## TIMBER SALE INFORMATION

Tetris Mix (63-025-24)

T22N, R09W, SEC. 10; T22N, R09W, SEC. 11; T22N, R09W, SEC. 12; T22N, R09W, SEC. 2; T23N, R09W, SEC. 35.  
Wexford County (Advertised Price \$113,666.80)

**SALE NOTE:** A recreation site such as a trail, pathway, or campground is within the sale area or the vicinity. Certain restrictions/specifications may be applicable including time restrictions.

A timber sale contract for this lump sum, sealed bid timber sale will be awarded to the responsible bidder offering the highest sealed bid price. All units of volume listed below were estimated using the Inventory Manager computer program and the new Michigan taper model. Bids must be at or above the following advertised price for each product and species:

<u>PRODUCTS &amp; SPECIES</u>	<u>ESTIMATED UNITS*</u>		<u>ADVERTISED PRICE</u>
Sawtimber			
Black/Red (Hybrid) Oak	221.6	MBF	\$ 101.00 / MBF
Mixed Aspen	166.2	MBF	\$ 98.00 / MBF
Red Maple	28.4	MBF	\$ 110.00 / MBF
Red Oak	88.0	MBF	\$ 164.00 / MBF
White Pine	21.3	MBF	\$ 57.00 / MBF
Pulpwood			
Jack Pine	21	Cords	\$ 14.55 / Cord
Mixed Aspen	897	Cords	\$ 22.65 / Cord
Mixed Hardwood	214	Cords	\$ 17.00 / Cord
Mixed Oak	468	Cords	\$ 34.00 / Cord
Red Pine	19	Cords	\$ 42.45 / Cord
Scotch Pine	79	Cords	\$ 16.20 / Cord
White Pine	437	Cords	\$ 25.40 / Cord
White Spruce	255	Cords	\$ 11.25 / Cord

\* The total volume is statistically estimated within plus (+) or minus (-) 12.56 percent. There are an estimated 3,769 cords on this timber sale, plus or minus 474 cords at the 95% confidence level. The estimated units are final and not subject to adjustment. Prospective bidders are urged to examine this timber and to make their own estimates of quantity and quality.

### **BOND AND PAYMENT SCHEDULE:**

- A bond in the amount of \$11,367.00 to insure faithful performance of the conditions of the contract will be deposited by the successful bidder within 21 days of the sale award.
- Cutting in any sale or unit without the required advance payment would be considered a trespass.
- Total payment must be paid in advance or according to the following schedule :
  - Ten percent (10%) of the sale value must be paid within 21 days of the sale award.
  - The 10% down payment will be credited towards the first unit cut.
  - Payment for each of the following units must be made before cutting begins in that unit:
 

PAYMENT UNIT NUMBER	PERCENT OF TOTAL SALE VALUE
01	24.8%
02	9.1%
03	19.0%
04	4.1%
05	43.0%
- If no cutting takes place, the 10% down payment will not be refunded.
- Operations on the contract issued will terminate on 12/31/2028.

### **SALE STATISTICS**

Volumes were calculated in cubic feet using the Michigan taper model. Cubic foot volume includes all wood inside bark for the product indicated. For display purposes, cubic feet were converted to cords and MBF using a simple conversion factor, e.g. 79 cubic feet per cord and 185 cubic feet per MBF. The cubic foot volumes are precise; the cords and MBF volumes are not. Cubic foot volume cannot be directly converted to cords or boards with precision.

## SALE VOLUMES

The total estimated sale volume may not equal the sum of the species/products due to the nature of statistical calculations associated with double sampling methodology.

VOLUME			STATISTICAL RANGE IN CORDS	
TOTAL CUBIC FEET	TOTAL CORDS	PERCENT ERROR	MINIMUM	MAXIMUM
297,728	3,769	12.56%	3,295	4,242

## VDU VOLUMES

A VDU is a Volume Determination Unit. Volumes and their associated statistics are calculated at the VDU level and summarized to the sale level. There is often a one to one relationship between a VDU and a Payment Unit, but not always, depending on the cruise design. Refer to the VDU TO PAYMENT UNIT table.

	VOLUME			RANGE IN CORDS	
VDU	TOTAL CUBIC FEET	TOTAL CORDS	PERCENT ERROR	MINIMUM	MAXIMUM
26	48,119	609	30.08%	426	792
29	38,483	487	27.47%	353	621
31	4,713	60	69.41%	18	101
33	60,575	767	31.36%	526	1,007
52	21,172	268	55.47%	119	417
69	6,294	80	53.35%	37	122
71	115,441	1,461	21.38%	1,149	1,774
79	2,930	37	48.91%	19	55
<b>TOTAL:</b>	<b>297,728</b>	<b>3,769</b>		<b>2,648</b>	<b>4,889</b>

## VDU TO PAYMENT UNIT

When a VDU is associated with more than one Payment Unit (PU), the VDU volumes are assigned to the PU based on acres of the VDU within the PU.

VDU	VDU ACRES	PU	PU ACRES
26	21.1	1	21.1
29	20.2	2	20.2
31	6.9	1	6.9
33	21.6	3	21.6
52	11.3	4	11.3
69	3.0	5	3.0
71	56.3	5	56.3
79	2.1	4	2.1
<b>TOTAL:</b>	<b>142.5</b>		<b>142.5</b>

**DESCRIPTION OF TIMBER BY PAYMENT UNIT (PU)**

PU	MARKET GROUP	PRODUCT	QUANTITY	UNIT	ACRES	ADVERTISE PRICE
1	Black/Red (Hybrid	Sawtimber	70.7	MBF	28.0	\$28,228.25
	Mixed Aspen		12.0	MBF		
	<i>B. T. Aspen</i>		10.2	<i>MBF</i>		
	<i>Quaking Aspen</i>		1.8	<i>MBF</i>		
	Red Maple		5.2	MBF		
	Red Oak	Pulpwood	67.3	MBF		
	White Pine		2.2	MBF		
	Mixed Aspen		107	Cords		
	<i>B. T. Aspen</i>		57	<i>Cords</i>		
	<i>Quaking Aspen</i>		50	<i>Cords</i>		
	Mixed Hardwood		47	Cords		
	<i>Red Maple</i>		47	<i>Cords</i>		
	Mixed Oak		134	Cords		
	<i>/Red (Hybrid) Oak</i>		79	<i>Cords</i>		
	<i>Red Oak</i>		55	<i>Cords</i>		
	Red Pine		4	Cords		
	<i>Red Pine</i>		4	<i>Cords</i>		
	White Pine		9	Cords		
2	Black/Red (Hybrid	Sawtimber	26.0	MBF	20.2	\$10,329.35
	Mixed Aspen		8.3	MBF		
	<i>Quaking Aspen</i>		8.3	<i>MBF</i>		
	White Pine		0.8	MBF		
	Mixed Aspen	Pulpwood	81	Cords		
	<i>Quaking Aspen</i>		81	<i>Cords</i>		
	Mixed Hardwood		24	Cords		
	<i>Beech</i>	<i>Sawtimber</i>	0.9	<i>MBF</i>		
	<i>Beech</i>		17	<i>Cords</i>		
	<i>Red Maple</i>		5	<i>Cords</i>		
	Mixed Oak		102	Cords		
	<i>/Red (Hybrid) Oak</i>	<i>Pulpwood</i>	102	<i>Cords</i>		
	White Pine		3	Cords		
	White Spruce		94	Cords		
	<i>White Spruce</i>		94	<i>Cords</i>		
3	Black/Red (Hybrid	Sawtimber	2.3	MBF	21.6	\$21,602.90
	Mixed Aspen		89.4	MBF		
	<i>B. T. Aspen</i>		56.8	<i>MBF</i>		
	<i>Quaking Aspen</i>		32.6	<i>MBF</i>		
	Red Maple	Pulpwood	1.8	MBF		
	White Pine		5.0	MBF		
	Mixed Aspen		484	Cords		
	<i>B. T. Aspen</i>		303	<i>Cords</i>		
	<i>Quaking Aspen</i>		181	<i>Cords</i>		
	Mixed Hardwood		40	Cords		
	<i>Beech</i>		11	<i>Cords</i>		
	<i>Black Cherry</i>		5	<i>Cords</i>		
	<i>Paper Birch</i>		11	<i>Cords</i>		
	<i>Red Maple</i>		13	<i>Cords</i>		
	Mixed Oak		2	Cords		
	<i>/Red (Hybrid) Oak</i>		2	<i>Cords</i>		
	Red Pine		8	Cords		
	<i>Red Pine</i>	<i>Sawtimber</i>	3.3	<i>MBF</i>		
	<i>Red Pine</i>		1	<i>Cords</i>		
	White Pine		3	Cords		
4	Black/Red (Hybrid	Sawtimber	10.0	MBF	13.4	\$4,658.25
	Mixed Aspen		3.2	MBF		
	<i>Quaking Aspen</i>		3.2	<i>MBF</i>		

**DESCRIPTION OF TIMBER BY PAYMENT UNIT (PU), CON'T**

PU	MARKET GROUP	PRODUCT	QUANTITY	UNIT	ACRES	ADVERTISE PRICE	
4 con't	Mixed Aspen	Pulpwood	56	Cords			
	<i>Quaking Aspen</i>		56	<i>Cords</i>			
	Mixed Hardwood		3	Cords			
	<i>Red Maple</i>		3	<i>Cords</i>			
	Mixed Oak		6	Cords			
	<i>/Red (Hybrid) Oak</i>		5	<i>Cords</i>			
	<i>Red Oak</i>		1	<i>Cords</i>			
	White Spruce		161	Cords			
	<i>White Spruce</i>		<i>Sawtimber</i>	2.1			<i>MBF</i>
<i>White Spruce</i>	<i>Pulpwood</i>	157	<i>Cords</i>				
5	Black/Red (Hybrid	Sawtimber	112.6	MBF	59.3	\$48,848.05	
	Mixed Aspen	Pulpwood	53.3	MBF			
	<i>B. T. Aspen</i>		53.3	<i>MBF</i>			
	Red Maple		21.4	MBF			
	Red Oak		20.7	MBF			
	White Pine		13.3	MBF			
	Jack Pine		21	Cords			
	Mixed Aspen		169	Cords			
	<i>B. T. Aspen</i>		164	<i>Cords</i>			
	<i>Quaking Aspen</i>		5	<i>Cords</i>			
	Mixed Hardwood		100	Cords			
	<i>Black Cherry</i>		<i>Sawtimber</i>	2.0			<i>MBF</i>
	<i>Beech</i>		<i>Pulpwood</i>	5			<i>Cords</i>
	<i>Black Cherry</i>		Pulpwood	3			<i>Cords</i>
	<i>Red Maple</i>			88			<i>Cords</i>
	Mixed Oak			224			Cords
	<i>/Red (Hybrid) Oak</i>			158			<i>Cords</i>
	<i>Red Oak</i>			46			<i>Cords</i>
	<i>White Oak</i>			20			<i>Cords</i>
	Red Pine			7			Cords
	<i>Red Pine</i>		<i>Sawtimber</i>	2.8			<i>MBF</i>
	<i>Red Pine</i>		<i>Pulpwood</i>	1			<i>Cords</i>
	Scotch Pine		79	Cords			
	White Pine		422	Cords			
TOTAL:			525.5	MBF			
TOTAL:			2,390	Cords			



## **Sale Specific Conditions & Requirements**

**Sale Name: Tetris Mix**

**Sale Number: 63-025-24 Seq#: 1**

### **1 - Sale Area**

#### **1.2 - Boundaries**

##### **1.2.1 - Painted Boundaries (9/19)**

The sale boundary and Payment Unit boundaries are marked and identified by blue, red and yellow paint. Exterior sale boundary lines against private property are marked with blue paint. Exterior sale boundary lines against state are marked with red paint. Interior Payment Unit boundaries are marked with yellow paint. Retention patches are marked with red paint; no harvesting activities may occur within these areas. The painted boundary line trees are not Included Timber and are to be protected. Yellow painted trees designating an interior Payment Unit boundary are only to be cut when all surrounding Payment Units have been paid.

### **2 - Timber Specifications**

#### **2.1 - Included Timber**

##### **2.1.2 - Clearcut Unit(s) w/o Unmerchantable Trees (8/11)**

Within Payment Unit(s) 2 and 4, cut all trees which meet minimum piece specifications in 2.2 Utilization, except do not cut any white oak or elm. In addition, do not cut any oak that is 26 inches or more at DBH.

Within Payment Unit 3, cut all trees which meet minimum piece specifications in 2.2 Utilization, except do not cut any white oak. In addition, do not cut any oak that is 30 inches or more at DBH.

Within Payment Unit 5, cut all trees which meet minimum piece specifications in 2.2 Utilization, except do not cut any white oak that is 14 inches or more at DBH, any oak that is 30 inches or more at DBH, or any white pine that is 14 inches or more at DBH.

##### **2.1.7 - Leave Tree Marked Unit(s) (6/14)**

Within Payment Unit(s) 1, cut all trees that are two (2) inches or more at DBH, except do not cut any trees marked with green paint above and below stump height. In addition, do not cut any white oak that is 25 inches or more at DBH.

Special protection trees identified in accordance with condition 3.4.2, within clearcutting unit boundaries, are not Included Timber and are to be protected.

### **3 - Payments**

#### **3.3 - Pre-measured Sales**

##### **3.3.4 - Dividing Payment Units (7/14)**

Payment Unit(s) may be divided at the request of the Purchaser and upon approval of the Unit Manager. Dividing Payment Units is a contract modification which requires a Timber Sale Contract Amendment.

#### **3.4 - Damaged Timber**

##### **3.4.2 - Special Protection Trees (4/14)**

The Purchaser shall not cut live or dead special protection trees within cutting units or clearings. Special protection trees are marked with green paint. If the Purchaser's operations have cut or damaged special protection trees through carelessness, the Purchaser shall pay \$200 as fixed, agreed and liquidated damages for each special protection tree cut or damaged. Such payment does not constitute ownership of the undesignated timber.

### **4 - Transportation**

#### **4.1 - Construction**

##### **4.1.6 - Road Construction (4/24)**

Construction of new roads or improvements of existing roads shall be done in such a way as to minimize the environmental and visual impacts. Merchantable trees shall be cut and utilized unless otherwise directed. Non-merchantable trees shall be

severed and laid flat on the ground. Slash shall be scattered, and not left in windrows and kept a minimum of 10 feet back from the road edge. Stumps shall be set upright, not left on edge, and be moved at least 10 feet away from the road edge. Disturbed soil shall be feathered into the woods and not left in berms or windrows.

#### 4.1.7 - Road Closure (10/11)

All new roads built into the sale must be blocked to vehicle traffic upon completion of the sale. All new roads built into the sale must be blocked to vehicle traffic within 30 days of completion of hauling. Overgrown roads that are reopened shall be considered new roads. In general, this will require constructing a six (6') foot high berm of stumps and logs covered with earth. Stumps and brush must be placed along the remainder of the trail. These roads must be rendered impassable to orvs, cars and trucks. All stumps from road building and landing construction must be reserved to block any newly constructed roads upon completion of the sale. These stumps must be scattered along the road system to prohibit vehicular movement. Temporary berms may be required if no sale activity occurs for 30 or more consecutive days. Contact the Sale Administrator for specific details of design and placement.

### 4.2 - Maintenance

#### 4.2.5 - Two Wheel Drive Condition (2/04)

All existing trail roads on and adjacent to the Sale Area must be passable by two-wheel drive traffic for the duration of the sale.

## 5 - Operations

### 5.2 - Conduct of Operations

#### 5.2.1 - Slash

##### 5.2.1.8 - Slash Height (12/08)

No slash or tree tops may exceed 24 inches in height.

#### 5.2.2 - Hazard Trees/Snags

##### 5.2.2.1 - Den Trees (10/16)

Obvious hollow and/or den trees shall be protected and left standing unless they are a safety hazard.

#### 5.2.3 - Operating Restrictions

##### 5.2.3.5 - Oak Wilt Restriction (1/18)

Within Payment Units 1-5, unless changed by written agreement, cutting, skidding, hauling within the sale and brushing of access roads to the sale are not permitted during the period of April 15 to July 15. Operations may be allowed if specific steps are taken to prevent damaging uncut oak during the high-risk period. Those steps may include completing all road brushing before April 15 and clearing a tree-length buffer along uncut oak cover before April 15. This is necessary to reduce the spread of oak wilt. For more information, contact the Unit Manager or his/her representative.

##### 5.2.32 - Decking/Landing Restoration (9/13)

All decking and landing areas must have the surface area restored to a condition equal to or better than before. This is to ensure the proper regeneration of the stand. Wood debris, chips and "cookies" from trimmings must be removed or scattered away from landing and loading areas and may not be windrowed on the edge.

##### 5.2.38 - No Decking Against Live Trees (2/04)

Cut products may not be decked against unmarked or designated leave trees.

##### 5.2.39 - ORV Trail/Route Protection (4/18)

The an ORV trail or route and is shown on the Timber Sale Map. Do not cut trees or damage posts with yellow ORV markers. All stumps within 5 feet of the trail must be cut flush with the ground. Maintain a 20-foot-wide slash, debris, and rut free zone daily using the ORV trail or route as the centerline. Do not run equipment down the ORV trail or route. Skidding across the trail or route may only occur in locations approved by the Sale Administrator.

##### 5.2.40 - Pathway Protection (10/10)

A hiking and horse trail are shown on the Timber Sale Map. Do not cut trees or damage posts with blue pathway markers. Maintain a 20-foot-wide slash, debris, and rut free zone daily, using the pathway as the centerline. Do not run equipment down the pathway. Skidding across the trail may only occur in locations approved by the Sale Administrator.

## 5.4 - Soil Protection

### 5.4.1 - Rutting Restriction, General (7/16)

Operations are to cease immediately if equipment and weather conditions result in rutting of roads and/or skid trails which is 12 inches or greater in depth and 50 feet in length. The Unit Manager or his/her representative may restrict hauling and/or skidding if ruts exceed the specified depth. With the Unit Manager or his/her representative's approval, the Purchaser may return to the area when the risk of rutting has decreased.

## 5.8 - Protection of Endangered Species

### 5.8.5 - Protection of Raptor Nests (3/13)

All trees with raptor nests will be protected if found during harvesting operations. Notification will be made to the Unit Manager or his/her representative who will notify the Wildlife Biologist so an onsite evaluation and recommendation can be made, if necessary.

## 6 - Safety and Fire Prevention

### 6.2 - Signing

#### 6.2.1 - Road Posting (10/20)

The Purchaser is responsible for posting and maintaining caution signs on all county roads, adjacent to Payment Units, prior to beginning operations. The road must be posted at appropriate distances from the Sale Area to warn of logging activity and truck traffic. Signs must be removed when harvest operations are suspended or completed. The Purchaser will provide these signs.

#### 6.2.3 - Recreational Trail Posting (10/20)

The Purchaser is responsible for posting and maintaining caution signs on all recreational trails prior to beginning operations. The trail must be posted at appropriate distances from the Sale Area to warn of logging activity and truck traffic at both ends of the trail. Signs must be removed when harvest operations are suspended or completed. The Purchaser will provide these signs.



**TIMBER SALE MAP**

This information provided by authority of Part 525, 1994 PA 451, as amended.

Sale Number

**63-025-24**

Date

**09/27/2024**

Forest Management Unit

Cadillac

County

Wexford

Mapped By: Krugh

Cruised By: Manton FO

Scale

**1:20,000**

Page

**1**

Of

**1**

Township  
22N/23N

Range  
09W

Section(s) and Subdivision(s)  
Sec. 2 N1/2NE; Sec. 10 NE; Sec. 11 SWNW,E1/2SW; Sec. 12 NENW,S1/2NW,N1/2SW,SESW;  
Sec. 35 SWSE

**Cover Type**

A = Aspen	J = Jack Pine	O = Oak	U = Upland Brush
B = Paper Birch	K = Rock	P = Lowland Poplar	UM = Upland Mix Forest
C = Cedar	L = Lowland Brush	Q = Mixed Swamp Conifer	V = Bog or Marsh
D = Treed Bog	LM = Lowland Mix Forest	R = Red Pine	W = White Pine
E = Swamp Hardwoods	M = Maple, Beech, Birch	S = Black Spruce	X = Non Stocked
F = Spruce/Fir	MC = Mixed Conifer	T = Tamarack	Y = Sand
G = Grass	MD = Mixed Deciduous	Z = Water	
H = Hemlock	N = Marsh		

**Density**

0 = Non Stocked	5 = Pole Timber Medium
1 = Seedling Sapling Poor	6 = Pole Timber Well
2 = Seedling Sapling Medium	7 = Saw Timber Poor
3 = Seedling Sapling Well	8 = Saw Timber Medium
4 = Pole Timber Poor	9 = Saw Timber Well

**PU # Acres**

1	28
2	20.2
3	21.6
4	13.4
5	59.3

**Legend**

- Against State (Red)
- Stand
- Retention Areas
- Private Line (Blue)
- Recreational Trail
- Paved Road
- Gravel Road
- County Road - Seasonal
- Private Road
- Pipeline

**Tetris Mix**

**Acres 142.5**

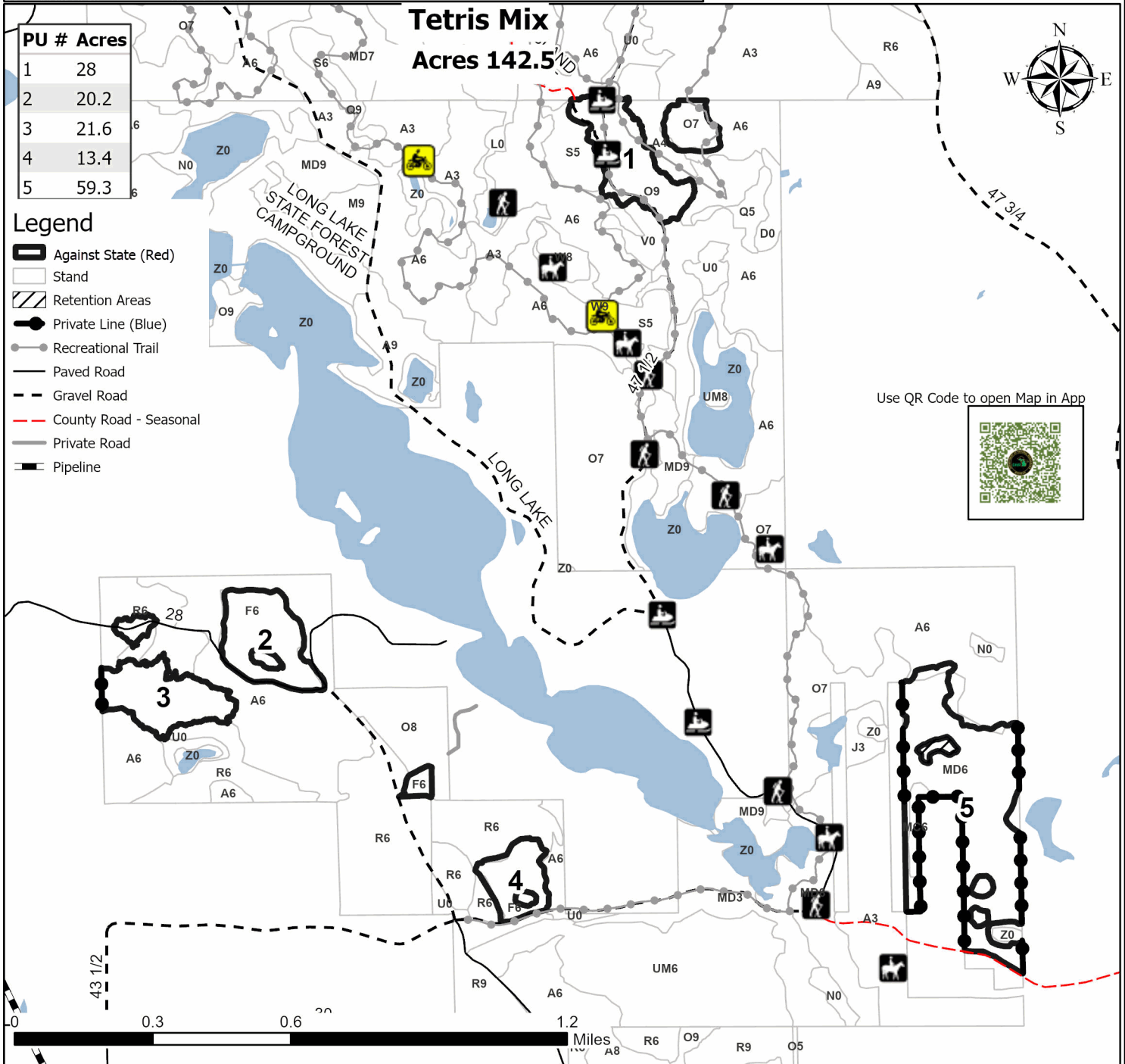

Tetris Mix (63-025-24)

T22N, R09W, SEC. 10; T22N, R09W, SEC. 11; T22N, R09W, SEC. 12; T22N,

In response to the notice of sale to be held 3:00 p.m. (local time) on July 23, 2025, I am hereby submitting my sealed bid ( firm offer) for the following forest products to be cut. Bids for individual species must be at or above the advertised price. All non-responsive bid forms may be rejected.

<u>PRODUCTS &amp; SPECIES</u>	<u>ESTIMATED VOLUME*</u>	<u>ADVERTISED PRICE</u>	<u>BID PRICE/UNIT</u>
<b>Sawtimber</b>			
Black/Red (Hybrid) Oak	221.6 MBF	\$ 101.00/MBF	\$ _____
Mixed Aspen	166.2 MBF	\$ 98.00/MBF	\$ _____
Red Maple	28.4 MBF	\$ 110.00/MBF	\$ _____
Red Oak	88.0 MBF	\$ 164.00/MBF	\$ _____
White Pine	21.3 MBF	\$ 57.00/MBF	\$ _____
<b>Pulpwood</b>			
Jack Pine	21 Cords	\$ 14.55/Cord	\$ _____
Mixed Aspen	897 Cords	\$ 22.65/Cord	\$ _____
Mixed Hardwood	214 Cords	\$ 17.00/Cord	\$ _____
Mixed Oak	468 Cords	\$ 34.00/Cord	\$ _____
Red Pine	19 Cords	\$ 42.45/Cord	\$ _____
Scotch Pine	79 Cords	\$ 16.20/Cord	\$ _____
White Pine	437 Cords	\$ 25.40/Cord	\$ _____
White Spruce	255 Cords	\$ 11.25/Cord	\$ _____

\*The volumes are statistically estimated within plus (+) or minus (-) 12.56 percent at 95% confidence level. These estimated volumes are final and not subject to adjustment. Prospective bidders are urged to examine this timber and to make their own estimates of quantity and quality.

I understand that any or all bids may be rejected. All bids must be signed and all bid items must be bid or the bid form may be rejected. I also understand that consideration and awarding a contract will be based upon my past performance and ability to complete the contract based upon equipment and staffing subject to my control .

FEDERAL ID: \_\_\_\_ - \_\_\_\_ - \_\_\_\_ or SOCIAL SECURITY NUMBER: \_\_\_\_ - \_\_\_\_ - \_\_\_\_

Company or individual bidding: \_\_\_\_\_

Company representative's name: \_\_\_\_\_

Address: \_\_\_\_\_

City: \_\_\_\_\_ State: \_\_\_\_\_ Zip: \_\_\_\_\_

IF AVAILABLE, PLEASE PLACE THE PERSONALIZED LABEL FROM YOUR PROSPECTUS IN THE ABOVE BOX.

Individual or company representative's signature: \_\_\_\_\_ Date: \_\_\_\_\_

Phone number : \_\_\_\_\_ Email (optional): \_\_\_\_\_

**THE WINNING BIDDER MUST COMPLETE THE VERIFICATION OF WORKER'S DISABILITY COMPENSATION ACT  
COMPLIANCE (ON REVERSE SIDE IF DOUBLE SIDED) WITHIN 21 DAYS OF SALE AWARD DATE**



## TIMBER SALE VERIFICATION OF WORKER'S DISABILITY COMPENSATION ACT COMPLIANCE

As required by Act 317, P.A. 1969 (Worker's Compensation) and  
Part 5 of Act 451 of 1994, as amended.

### FOR DEPARTMENT USE ONLY

Sale Number (XX - XXX - XX - XX)

Forest Management Unit:

### VERIFICATION OF WORKER'S DISABILITY COMPENSATION ACT COMPLIANCE

- This verification must be completed and submitted within 21 days of contract award and prior to the issuance of the timber sale contract.
- In addition, if boxes 2B or 2C are checked, then Notice of Exclusion or Certificate of Insurance must be submitted within twenty-one (21) days of the contract award and prior to the issuance of the timber sale contract.
- All information must be typed or printed except for written signatures.

Please Check Appropriate Categories:

1. My business is organized as (you **must** check one of the boxes below):
  - A. ☐ Sole Proprietorship (individual)
  - B. ☐ Partnership
  - C. ☐ Corporation
2. You **must** check one of the boxes below:
  - A. ☐ I certify my business is a sole proprietorship and it has no employees but the sole proprietor. I am not subject to the Worker's Compensation Laws.
  - B. ☐ I certify my business has satisfied its obligation to the Worker's Compensation Act through the use of an approved Notice of Exclusion (BWC-337, Rev. 5/96). I will provide a copy of the Notice of Exclusion within 21 days of the contract award. (For questions or a copy of the BWC-337, please call the Worker's Compensation Bureau at 517-322-1195).
  - C. ☐ I certify my business has a Worker's Compensation Policy. I will provide an original Certificate of Insurance within twenty-one (21) days of the contract award.
3. If you have checked item 2(A) or 2(B), you **must** indicate the number of **both** full-time and part-time employees, other than yourself, including family members and active partners (if none, you must enter "0").

\_\_\_\_\_ Full-time Employees

\_\_\_\_\_ Part-time Employees

Name of Business		Federal ID (or) Social Security No.
Address		Telephone (       )
City	State	ZIP

*I hereby certify that the above information is true and correct. I agree to notify the Michigan DNR of any changes that occur in factors affecting my coverage during any of my present and future operations.*

\_\_\_\_\_  
Signature of Owner or Authorized Representative

\_\_\_\_\_  
Title

\_\_\_\_\_  
Date

Please complete the "SEALED BID" information on the next page

Oaknado (63-001-25)

T18N, R13W, SEC. 1; T18N, R13W, SEC. 2; T19N, R13W, SEC. 35; T19N, R13W,

In response to the notice of sale to be held 3:00 p.m. (local time) on July 23, 2025, I am hereby submitting my sealed bid ( firm offer) for the following forest products to be cut. Bids for individual species must be at or above the advertised price. All non-responsive bid forms may be rejected.

<u>PRODUCTS &amp; SPECIES</u>	<u>ESTIMATED VOLUME*</u>	<u>ADVERTISED PRICE</u>	<u>BID PRICE/UNIT</u>
Sawtimber			
B. T. Aspen	8.9 MBF	\$ 98.00/MBF	\$ _____
Black/Red (Hybrid) Oak	98.4 MBF	\$ 101.00/MBF	\$ _____
Red Oak	16.4 MBF	\$ 164.00/MBF	\$ _____
White Oak	10.0 MBF	\$ 106.00/MBF	\$ _____
Pulpwood			
B. T. Aspen	7 Cords	\$ 22.65/Cord	\$ _____
Black/Red (Hybrid) Oak	305 Cords	\$ 34.00/Cord	\$ _____
Misc. Species 2	41 Cords	\$ 10.00/Cord	\$ _____
Red Maple	62 Cords	\$ 17.00/Cord	\$ _____
Red Oak	47 Cords	\$ 34.00/Cord	\$ _____
White Oak	68 Cords	\$ 34.00/Cord	\$ _____
White Pine	6 Cords	\$ 25.40/Cord	\$ _____

\*The volumes are statistically estimated within plus (+) or minus (-) 15.67 percent at 95% confidence level. These estimated volumes are final and not subject to adjustment. Prospective bidders are urged to examine this timber and to make their own estimates of quantity and quality.

I understand that any or all bids may be rejected. All bids must be signed and all bid items must be bid or the bid form may be rejected. I also understand that consideration and awarding a contract will be based upon my past performance and ability to complete the contract based upon equipment and staffing subject to my control .

FEDERAL ID: \_\_\_\_\_ or SOCIAL SECURITY NUMBER: \_\_\_\_\_

Company or individual bidding: \_\_\_\_\_

Company representative's name: \_\_\_\_\_

Address: \_\_\_\_\_

City: \_\_\_\_\_ State: \_\_\_\_\_ Zip: \_\_\_\_\_

IF AVAILABLE, PLEASE PLACE THE PERSONALIZED LABEL FROM YOUR PROSPECTUS IN THE ABOVE BOX.

Individual or company representative's signature: \_\_\_\_\_ Date: \_\_\_\_\_

Phone number : \_\_\_\_\_ Email (optional): \_\_\_\_\_

**THE WINNING BIDDER MUST COMPLETE THE VERIFICATION OF WORKER'S DISABILITY COMPENSATION ACT  
COMPLIANCE (ON REVERSE SIDE IF DOUBLE SIDED) WITHIN 21 DAYS OF SALE AWARD DATE**



## TIMBER SALE VERIFICATION OF WORKER'S DISABILITY COMPENSATION ACT COMPLIANCE

As required by Act 317, P.A. 1969 (Worker's Compensation) and  
Part 5 of Act 451 of 1994, as amended.

### FOR DEPARTMENT USE ONLY

Sale Number (XX - XXX - XX - XX)

Forest Management Unit:

### VERIFICATION OF WORKER'S DISABILITY COMPENSATION ACT COMPLIANCE

- This verification must be completed and submitted within 21 days of contract award and prior to the issuance of the timber sale contract.
- In addition, if boxes 2B or 2C are checked, then Notice of Exclusion or Certificate of Insurance must be submitted within twenty-one (21) days of the contract award and prior to the issuance of the timber sale contract.
- All information must be typed or printed except for written signatures.

Please Check Appropriate Categories:

1. My business is organized as (you **must** check one of the boxes below):
  - A. ☐ Sole Proprietorship (individual)
  - B. ☐ Partnership
  - C. ☐ Corporation
2. You **must** check one of the boxes below:
  - A. ☐ I certify my business is a sole proprietorship and it has no employees but the sole proprietor. I am not subject to the Worker's Compensation Laws.
  - B. ☐ I certify my business has satisfied its obligation to the Worker's Compensation Act through the use of an approved Notice of Exclusion (BWC-337, Rev. 5/96). I will provide a copy of the Notice of Exclusion within 21 days of the contract award. (For questions or a copy of the BWC-337, please call the Worker's Compensation Bureau at 517-322-1195).
  - C. ☐ I certify my business has a Worker's Compensation Policy. I will provide an original Certificate of Insurance within twenty-one (21) days of the contract award.
3. If you have checked item 2(A) or 2(B), you **must** indicate the number of **both** full-time and part-time employees, other than yourself, including family members and active partners (if none, you must enter "0").

\_\_\_\_\_ Full-time Employees

\_\_\_\_\_ Part-time Employees

Name of Business		Federal ID (or) Social Security No.
Address		Telephone (       )
City	State	ZIP

*I hereby certify that the above information is true and correct. I agree to notify the Michigan DNR of any changes that occur in factors affecting my coverage during any of my present and future operations.*

\_\_\_\_\_  
Signature of Owner or Authorized Representative

\_\_\_\_\_  
Title

\_\_\_\_\_  
Date

Please complete the "SEALED BID" information on the next page



Back Side Pine (63-024-24)

T22N, R05W, SEC. 1; T22N, R05W, SEC. 10; T22N, R05W, SEC. 11; T22N, R05W,

In response to the notice of sale to be held 3:00 p.m. (local time) on July 23, 2025, I am hereby submitting my sealed bid ( firm offer) for the following forest products to be cut. Bids for individual species must be at or above the advertised price. All non-responsive bid forms may be rejected.

<u>PRODUCTS &amp; SPECIES</u>	<u>ESTIMATED VOLUME*</u>	<u>ADVERTISED PRICE</u>	<u>BID PRICE/UNIT</u>
<b>Sawtimber</b>			
Jack Pine	114.2 MBF	\$ 38.00/MBF	\$ _____
Red Oak	11.5 MBF	\$ 121.00/MBF	\$ _____
Red Pine	544.0 MBF	\$ 73.00/MBF	\$ _____
White Pine	85.6 MBF	\$ 44.00/MBF	\$ _____
<b>Pulpwood</b>			
Jack Pine	796 Cords	\$ 10.70/Cord	\$ _____
Mixed Aspen	32 Cords	\$ 16.60/Cord	\$ _____
Mixed Hardwood	328 Cords	\$ 12.50/Cord	\$ _____
Mixed Oak	23 Cords	\$ 24.95/Cord	\$ _____
Norway Spruce	4 Cords	\$ 8.25/Cord	\$ _____
Red Pine	778 Cords	\$ 31.10/Cord	\$ _____
Scotch Pine	2 Cords	\$ 11.90/Cord	\$ _____
White Pine	96 Cords	\$ 18.60/Cord	\$ _____

\*The volumes are statistically estimated within plus (+) or minus (-) 13.81 percent at 95% confidence level. These estimated volumes are final and not subject to adjustment. Prospective bidders are urged to examine this timber and to make their own estimates of quantity and quality.

I understand that any or all bids may be rejected. All bids must be signed and all bid items must be bid or the bid form may be rejected. I also understand that consideration and awarding a contract will be based upon my past performance and ability to complete the contract based upon equipment and staffing subject to my control.

FEDERAL ID: \_\_\_\_ - \_\_\_\_ - \_\_\_\_ or SOCIAL SECURITY NUMBER: \_\_\_\_ - \_\_\_\_ - \_\_\_\_

Company or individual bidding: \_\_\_\_\_

Company representative's name: \_\_\_\_\_

Address: \_\_\_\_\_

City: \_\_\_\_\_ State: \_\_\_\_\_ Zip: \_\_\_\_\_

IF AVAILABLE, PLEASE PLACE THE PERSONALIZED LABEL FROM YOUR PROSPECTUS IN THE ABOVE BOX.

Individual or company representative's signature: \_\_\_\_\_ Date: \_\_\_\_\_

Phone number : \_\_\_\_\_ Email (optional): \_\_\_\_\_

**THE WINNING BIDDER MUST COMPLETE THE VERIFICATION OF WORKER'S DISABILITY COMPENSATION ACT  
COMPLIANCE (ON REVERSE SIDE IF DOUBLE SIDED) WITHIN 21 DAYS OF SALE AWARD DATE**



**TIMBER SALE**  
**VERIFICATION OF WORKER'S DISABILITY**  
**COMPENSATION ACT COMPLIANCE**

*As required by Act 317, P.A. 1969 (Worker's Compensation) and  
Part 5 of Act 451 of 1994, as amended.*

**FOR DEPARTMENT USE ONLY**

Sale Number (XX – XXX – XX – XX)

Forest Management Unit:

**VERIFICATION OF WORKER'S DISABILITY COMPENSATION ACT COMPLIANCE**

- This verification must be completed and submitted within 21 days of contract award and prior to the issuance of the timber sale contract.
- In addition, if boxes 2B or 2C are checked, then Notice of Exclusion or Certificate of Insurance must be submitted within twenty-one (21) days of the contract award and prior to the issuance of the timber sale contract.
- All Information must be typed or printed except for written signatures.

Please Check Appropriate Categories:

1. My business is organized as (you **must** check one of the boxes below):
  - A. ☐ Sole Proprietorship (individual)
  - B. ☐ Partnership
  - C. ☐ Corporation
2. You **must** check one of the boxes below:
  - A. ☐ I certify my business is a sole proprietorship and it has no employees but the sole proprietor. I am not subject to the Worker's Compensation Laws.
  - B. ☐ I certify my business has satisfied its obligation to the Worker's Compensation Act through the use of an approved Notice of Exclusion (BWC-337, Rev. 5/96). I will provide a copy of the Notice of Exclusion within 21 days of the contract award. (For questions or a copy of the BWC-337, please call the Worker's Compensation Bureau at 517-322-1195).
  - C. ☐ I certify my business has a Worker's Compensation Policy. I will provide an original Certificate of Insurance within twenty-one (21) days of the contract award.
3. If you have checked item 2(A) or 2(B), you **must** indicate the number of **both** full-time and part-time employees, other than yourself, including family members and active partners (if none, you must enter "0").

\_\_\_\_\_ Full-time Employees

\_\_\_\_\_ Part-time Employees

Name of Business		Federal ID (or) Social Security No.
Address		Telephone (       )
City	State	ZIP

*I hereby certify that the above information is true and correct. I agree to notify the Michigan DNR of any changes that occur in factors affecting my coverage during any of my present and future operations.*

\_\_\_\_\_  
Signature of Owner or Authorized Representative

\_\_\_\_\_  
Title

\_\_\_\_\_  
Date

**Please complete the "SEALED BID" information on the next page**