



**DEPARTMENT OF NATURAL RESOURCES
STATE OF MICHIGAN
TIMBER SALE PROSPECTUS #7744**

SCHEDULED SALE DATE AND TIME: 3:00 p.m. (local time) on January 7, 2026.

LOCATION: ESCANABA MGMT UNIT, 6833 US-2, 41 & M-35, GLADSTONE, MI 49837.

PROSPECTUS NOTE: The bidder is advised to inspect the sale area and review the location, estimated volumes, operating costs and contract terms of proposed sales. Please be aware that some landowners may request 60 days or more notice for access across their land.

Notice is hereby given that bids will be received by the Unit Manager, CRYSTAL FALLS MANAGEMENT UNIT, for certain timber on the following described lands:

South Pond Shores (12-009-25) / T41N, R29W, SEC. 17, W1/2NW,NWSW.

T41N, R29W, SEC. 18, SENE,N1/2SE.

T41N, R29W, SEC. 5 , E1/2NE,N1/2SE.

T41N, R29W, SEC. 8 , N1/2NW,SENW.

Dickinson County, Advertised Price \$29,504.05, 70.3 Acres, Aspen, Hardwood.

SALE NOTE: This sale has Historical Sites (5.7.1), operation restriction (5.2.3.1), and bark slippage restriction spec (5.2.3.3). See spec (5.2.41 and 6.2.2) for details on snowmobile trail requirements. Unit 2 has operating restriction (5.2.3.1).

A recreation site such as a trail, pathway, or campground is within the sale area or the vicinity. Certain restrictions/specifications may be applicable including time restrictions.

Drone Catcher (33-026-25) / T36N, R28W, SEC. 1 , NWNW.

T37N, R28W, SEC. 35, E1/2SE.

T37N, R28W, SEC. 36, NWSW,S1/2SW.

Menominee County, Advertised Price \$50,866.75, 140.1 Acres, Hardwood, Aspen.

SALE NOTE: Payment Units 1, 5, 6, and 7 are restricted for three months due to bark slippage and oak wilt concerns. Payment Unit 8 is restricted to winter cut only, unless there is an extended dry period during the summer months.

Miscauna Hardwood (33-032-25) / T36N, R28W, SEC. 2 , NWNW.

T36N, R28W, SEC. 3 , N1/2NE.

T37N, R28W, SEC. 34, NESE,S1/2SE.

T37N, R28W, SEC. 35, SW.

Menominee County, Advertised Price \$20,268.95, 122.4 Acres, Hardwood, Red Oak.

SALE NOTE: Oak Wilt is present within the sale, so no cutting is permitted from April 15th to July 15th. All Payment Units are upland and can be harvested any time outside the restricted dates.

BID INSTRUCTIONS (VER. 10/10/2022):

1. Scheduled Bid Location, Date, and Time (2/11)

Bids must be received by the Unit Manager, ESCANABA OFFICE, 6833 US-2, 41 & M-35, Gladstone, MI 49837, no later than 3:00 p.m. (local time) on January 7, 2026. For further information concerning this sale, contact Dan Racine at 906-789-8231.

2. Bidder's Qualifications (10/22)

If all or part of a timber sale was prepared by a private contractor, the contractor and that contractor's company are not permitted to bid on the timber sale. A person must be 18 years of age or older to purchase timber. Permanent employees of the Department of Natural Resources or members of their immediate household may not bid. Former employees, in the permanent or seasonal class, may not bid until 3 months after the last day of active duty. Bids will not be accepted from individuals or companies appearing on the DNR/FRD No-Bid List. This list contains the names of purchasers who previously failed to execute a contract within 21-days or who have a history of poor performance.

3. Preparation of Sealed Bids (5/16)

Bid Forms may be completed online thru Michigan DNR Timber Sale Online Bidding (OLB) at www.michigan.gov/timberbidding or by completing the hardcopy Bid Form found in the Timber Sale Prospectus. Hardcopy Bid Forms shall be manually signed in ink. Registration in OLB is considered your 'signature' for all bids submitted thru that system. Bid prices must be entered for each species and product in the Bid Price column for all material subject to bidding and all fill-in blanks must be completed. If erasures or other changes appear on the hardcopy Bid Form, each erasure or change must be initialed by the person signing the bid.

4. Submission of Sealed Bids (5/16)

Bid forms may be obtained from the Unit Manager or thru OLB. Bids may be submitted hardcopy or thru OLB. All hardcopy bids must be submitted on the bid form and in an envelope clearly identified as described in this section. NOTE: Only one bid form per bid envelope. Sealed bids must be submitted to the Unit office designated in the prospectus and must be submitted at or prior to the time established in the prospectus. The envelope should show on the outside (a) the sale name or number and (b) the date and time of bid opening, as shown in the prospectus. Bids received after the time specified in the sale prospectus are late bids and will be rejected.

It is possible for a bidder to submit multiple bids on a single sale. For example, a bid may be submitted hardcopy and a bid may be submitted thru OLB. Or, two bidders from the same company could both submit bids on the same sale. If this were to happen, the State would accept all bids received and award the contract accordingly. All bidding and contractual requirements would apply to all bids received.

5. Public Opening of Sealed Bids (7/16)

If conditions permit, the sealed bids will be publicly opened and posted at the time and place set in the prospectus.

If a bidder, present at a bid opening, has submitted bids on more than one sale, that bidder may withdraw their unopened bid envelopes or announce the withdrawal of their online bid after being declared the successful bidder on one sale.

6. Award of Contract (1/11)

Award of the contract will be made to the Bidder whose bid, conforming to the prospectus, is most advantageous to the State of Michigan on the basis of total value at rates bid for the estimated quantities. The State reserves the right to reject any bid or waive any minor irregularity in bids received. A written award mailed (or otherwise furnished) to the successful Bidder shall be deemed to result in a binding contract without further action by either party.

7. Down Payment (1/11)

The Bidder to whom award is made must make a down payment within 21 days of the sale award. The amount of the down payment will be calculated as shown in the Bond and Payment Schedule of this prospectus. Only cash may be used to meet this requirement.

8. Performance Security (1/11)

As guarantee of faithful performance, a cash bond, certificate of deposit, surety bond or irrevocable letter of credit (LOC) is required within 21 days of the sale award. The amount of the performance security is shown in the Bond and

Payment Schedule of this prospectus. If an LOC or surety is used, the coverage must extend for at least 6 months beyond the contract expiration.

9. Worker's Compensation (10/22)

Purchaser shall obtain worker's compensation insurance to cover claims under Michigan's Worker's Disability Compensation Act of 1969 or similar employee benefit act of any other state applicable to an employee. Verification of Worker's Disability Compensation Act Compliance must be completed and submitted within 21 days of contract award and prior to the issuance of the timber sale contract. In addition, if applicable, Notice of Exclusion or Certificate of Insurance must also be submitted.

10. Timber Sale Contract (10/22)

Additional conditions and requirements common to all timber sales are listed on the timber sale contract (R4031) and are available on line at www.michigan.gov/timber. Contact the Unit Manager for additional information or a sample contract. Within 21 days of the date of the award letter, the bidder must sign the contract and provide the required down payment, performance security, and verification of worker's disability compensation. The down payment and performance security shall be in accordance with the provisions of the timber sale contract, in the sums stated in this prospectus. If these actions are not taken, then the Bidder, the Bidder's corporation, and the corporation's principals may not be permitted to bid on State timber sales for a period of 3 months after the first offense, 6 months after the second offense, and 1 year after the third offense. An offense will only be counted against the Bidder for 5 years. In addition, the Bidder certifies that if awarded this contract, the Bidder will complete the timber sale contract in accordance with its terms and any modifications thereof including requirements to purchase, cut, and remove the included timber by the expiration date.

Payment Unit values in the State Forest Timber Sale Contract are calculated based on the advertised value of the Payment Unit as a percentage of the total advertised value of the contract. The advertised value of each Payment Unit is given in the Description of Timber by Payment Unit table on the Timber Sale Information page. For example, if the value of Payment Unit 1 is advertised as \$1,500 and the total Timber Sale value is advertised as \$10,000, the contract price for Payment Unit 1 will be 15% of the total bid price ($\$1,500/\$10,000 * 100$).

11. Disclaimer of Estimates and Bidder's Warranty of Inspection (10/22)

Before submitting this bid, the Bidder is advised and cautioned to inspect the sale area, review the requirements of the sale contract, and take other steps as may be reasonably necessary to ascertain the location, estimated volumes, construction estimates, and operating costs of the proposed sale. Failure to do so will not relieve the Bidder from responsibility for completing the contract.

The Bidder warrants that this bid is submitted solely on the basis of the Bidder's examination and inspection of the quality and quantity of the timber offered for sale and the Bidder's opinion of the value thereof and the costs of recovery. No reliance should be placed on the State of Michigan's estimates of timber quality, quantity or costs of recovery. Bidder further acknowledges that the State of Michigan: (i) expressly disclaims any warranty of fitness of timber for any purpose; (ii) offers this timber as is without any warranty of quality (merchantability) or quantity and (iii) expressly disclaims any warranty as to the quantity or quality of timber sold.

12. Certification and Chain-of-Custody (10/22)

Unless otherwise indicated in the contract under section 7 – Other Conditions of the Sale Specific Conditions & Requirements, the area encompassed by this timber sale is certified to the standards of the Forest Stewardship Council (FSC) - Certificate #SCS-FM/COC-00090N and the Sustainable Forestry Initiative (SFI) - Certificate #NSF-SFIS-5Y031-SF5. Forest products from this sale may be delivered to the mill as "FSC 100% and / or SFI certified" as long as the contractor hauling the forest products is chain-of-custody (COC) certified or covered under a COC certificate from the destination mill. The purchaser is responsible for maintaining COC after leaving the sale area.

13. Good Neighbor Authority (GNA) Requirements (10/22)

If the name of this timber sales contains the acronym GNA, it is authorized by the Good Neighbor Authority (GNA) and covered by various agreements between the U.S. Forest Service and the State. The timber sale occurs on federal land and the following conditions apply:

GNA contracts on US Forest Service land will not be awarded to purchasers on the Federal list of excluded parties. The System for Award Management (SAM) will be checked for active excluded parties prior to award of contract. In

addition, the Bidder to whom award is made must complete an Assurance Regarding Felony Conviction or Tax Delinquent Status for Corporate Applicants (AD-3031).

14. Good Neighbor Authority (GNA) Requirements, con't (10/22)

Bidder certifies, by signing this bid form, that to the best of Bidder's knowledge that the following representations are accurate and complete.

- a. That the Bidder and its principals are not presently debarred, suspended, proposed for debarment, declared ineligible, or voluntary excluded from timber sales (covered transactions) by any Federal department or agency.
- b. That the Bidder and its principals have not within a 3-year period preceding this bid been convicted of or had a civil judgment rendered against them for commission of fraud or a criminal offense in connection with obtaining , attempting to obtain, or performing a public (Federal, State, or local) transaction or contract under a public transaction; violation of Federal or State antitrust statutes or commission of embezzlement, theft, forgery, bribery, falsification or destruction of records, making false statements, or receiving stolen property.
- c. That the Bidder and its principals are not presently indicted for or otherwise criminally or civilly charged by a governmental entity (Federal, State, or local) with commission of any of the offenses enumerated in paragraph b of this certification.
- d. That the Bidder and its principals have not within a 3-year period preceding this bid had one or more public transactions (Federal, State, or local) terminated for breach or default of a timber or forest product contract.

Bidders that cannot certify this requirement, in whole or in part, shall submit an explanation with their bid.

Scott Bowen
Director

TIMBER SALE INFORMATION

South Pond Shores (12-009-25)

T41N, R29W, SEC. 17; T41N, R29W, SEC. 18; T41N, R29W, SEC. 5; T41N, R29W, SEC. 8.
Dickinson County (Advertised Price \$29,504.05)

SALE NOTE: This sale has Historical Sites (5.7.1), operation restriction (5.2.3.1), and bark slippage restriction spec (5.2.3.3). See spec (5.2.41 and 6.2.2) for details on snowmobile trail requirements. Unit 2 has operating restriction (5.2.3.1).

A recreation site such as a trail, pathway, or campground is within the sale area or the vicinity. Certain restrictions/specifications may be applicable including time restrictions.

A timber sale contract for this lump sum, sealed bid timber sale will be awarded to the responsible bidder offering the highest sealed bid price. All units of volume listed below were estimated using the Inventory Manager computer program and the new Michigan taper model. Bids must be at or above the following advertised price for each product and species:

<u>PRODUCTS & SPECIES</u>	<u>ESTIMATED UNITS*</u>	<u>ADVERTISED PRICE</u>
Sawtimber		
Paper Birch	3.1 MBF	\$ 83.00 / MBF
Red Maple	4.6 MBF	\$ 177.00 / MBF
Red Pine	12.2 MBF	\$ 109.00 / MBF
Sugar Maple	5.0 MBF	\$ 311.00 / MBF
White Pine	14.7 MBF	\$ 55.00 / MBF
Pulpwood		
Balsam Fir	22 Cords	\$ 5.25 / Cord
Balsam Poplar	5 Cords	\$ 18.70 / Cord
Mixed Aspen	914 Cords	\$ 18.70 / Cord
Mixed Hardwood	386 Cords	\$ 12.95 / Cord
Red Pine	22 Cords	\$ 75.05 / Cord
White Pine	31 Cords	\$ 14.65 / Cord
White Spruce	30 Cords	\$ 11.15 / Cord

* The total volume is statistically estimated within plus (+) or minus (-) 21.61 percent. There are an estimated 1,502 cords on this timber sale, plus or minus 325 cords at the 95% confidence level. The estimated units are final and not subject to adjustment. Prospective bidders are urged to examine this timber and to make their own estimates of quantity and quality.

BOND AND PAYMENT SCHEDULE:

1. A bond in the amount of \$1,475.00 to insure faithful performance of the conditions of the contract will be deposited by the successful bidder within 21 days of the sale award.
2. Cutting in any sale or unit without the required advance payment would be considered a trespass.
3. Total payment must be paid in advance or according to the following schedule:
 - (a) Ten percent (10%) of the sale value must be paid within 21 days of the sale award.
 - (b) The 10% down payment will be credited towards the first unit cut.
 - (c) Payment for each of the following units must be made before cutting begins in that unit:

<u>PAYMENT UNIT NUMBER</u>	<u>PERCENT OF TOTAL SALE VALUE</u>
01	24.2%
02	16.1%
03	7.8%
04	20.7%
05	31.2%

4. If no cutting takes place, the 10% down payment will not be refunded.
5. Operations on the contract issued will terminate on 12/31/2028.

SALE STATISTICS

Volumes were calculated in cubic feet using the Michigan taper model. Cubic foot volume includes all wood inside bark for the product indicated. For display purposes, cubic feet were converted to cords and MBF using a simple conversion factor, e.g. 79 cubic feet per cord and 185 cubic feet per MBF. The cubic foot volumes are precise; the cords and MBF volumes are not. Cubic foot volume cannot be directly converted to cords or boards with precision.

SALE VOLUMES

The total estimated sale volume may not equal the sum of the species/products due to the nature of statistical calculations associated with double sampling methodology.

VOLUME			STATISTICAL RANGE IN CORDS	
TOTAL CUBIC FEET	TOTAL CORDS	PERCENT ERROR	MINIMUM	MAXIMUM
118,665	1,502	21.61%	1,177	1,827

VDU VOLUMES

A VDU is a Volume Determination Unit. Volumes and their associated statistics are calculated at the VDU level and summarized to the sale level. There is often a one to one relationship between a VDU and a Payment Unit, but not always, depending on the cruise design. Refer to the VDU TO PAYMENT UNIT table.

	VOLUME			RANGE IN CORDS	
VDU	TOTAL CUBIC FEET	TOTAL CORDS	PERCENT ERROR	MINIMUM	MAXIMUM
2	6,816	86	50.60%	43	130
83	32,432	411	48.93%	210	611
90	16,006	203	60.12%	81	324
97	19,961	253	37.83%	157	348
105	43,451	550	39.16%	335	765
TOTAL:	118,665	1,502		825	2,179

VDU TO PAYMENT UNIT

When a VDU is associated with more than one Payment Unit (PU), the VDU volumes are assigned to the PU based on acres of the VDU within the PU.

VDU	VDU ACRES	PU	PU ACRES
TOTAL:			

DESCRIPTION OF TIMBER BY PAYMENT UNIT (PU)

PU	MARKET GROUP	PRODUCT	QUANTITY	UNIT	ACRES	ADVERTISE PRICE
1	Balsam Fir Mixed Aspen <i>B. T. Aspen</i> <i>Quaking Aspen</i> Mixed Hardwood <i>Sugar Maple</i> White Spruce	Pulpwood	11 334 130 204 60 60 6	Cords Cords <i>Cords</i> <i>Cords</i> Cords <i>Cords</i> Cords	8.9	\$7,147.45
2	Sugar Maple Balsam Poplar Mixed Aspen <i>B. T. Aspen</i> <i>Quaking Aspen</i> Mixed Hardwood <i>Paper Birch</i> <i>Red Maple</i> <i>Sugar Maple</i> White Spruce	Sawtimber Pulpwood	5.0 5 122 99 23 52 5 6 41 13	MBF Cords Cords <i>Cords</i> <i>Cords</i> Cords <i>Cords</i> <i>Cords</i> <i>Cords</i> Cords	10.3	\$4,748.25
3	Paper Birch Red Maple Red Pine Balsam Fir Mixed Aspen <i>B. T. Aspen</i> Mixed Hardwood <i>Black Cherry</i> <i>Paper Birch</i> <i>Red Maple</i> Red Pine	Sawtimber Pulpwood	3.1 4.6 1.4 3 33 33 28 2 4 22 1	MBF MBF MBF Cords Cords <i>Cords</i> Cords <i>Cords</i> <i>Cords</i> <i>Cords</i> Cords	4.9	\$2,294.60
4	Red Pine White Pine Balsam Fir Mixed Aspen <i>Quaking Aspen</i> Mixed Hardwood <i>Paper Birch</i> <i>Red Maple</i> <i>Sugar Maple</i> Red Pine White Pine White Spruce	Sawtimber Pulpwood	10.8 14.7 8 61 61 66 9 38 19 21 31 6	MBF MBF Cords Cords <i>Cords</i> Cords <i>Cords</i> <i>Cords</i> <i>Cords</i> Cords Cords Cords	22.2	\$6,120.20
5	Mixed Aspen <i>B. T. Aspen</i> <i>Quaking Aspen</i> Mixed Hardwood <i>Paper Birch</i> <i>Red Maple</i> White Spruce	Pulpwood	364 132 232 180 30 150 5	Cords <i>Cords</i> <i>Cords</i> Cords <i>Cords</i> <i>Cords</i> Cords	24.0	\$9,193.55
TOTAL:			39.6	MBF		
TOTAL:			1,410	Cords		

Sale Specific Conditions & Requirements

Sale Name: South Pond Shores

Sale Number: 12-009-25 Seq#: 1

1 - Sale Area

1.2 - Boundaries

1.2.1 - Painted Boundaries (9/19)

The sale boundary and Payment Unit boundaries are marked and identified by blue, red and yellow paint. Exterior sale boundary lines against private property are marked with blue paint. Exterior sale boundary lines against state are marked with red paint. Interior Payment Unit boundaries are marked with yellow paint. Retention patches are marked with red paint; no harvesting activities may occur within these areas. The painted boundary line trees are not Included Timber and are to be protected unless marked with orange paint. Yellow painted trees designating an interior Payment Unit boundary are only to be cut when all surrounding Payment Units have been paid.

2 - Timber Specifications

2.1 - Included Timber

2.1.1 - Clearcut Unit(s) with Unmerchantable Trees (6/14)

Within Payment Unit(s) 1, 2, 3, and 5, cut all trees that are two (2) inches or more at DBH, with the following exceptions:

- Within Payment Unit 1, do not cut any conifers. Also, do not cut green ringed trees.
- Within Payment Unit 2, do not cut red pine, white pine, oak, cedar, and hemlock.
- Within Payment Unit 3, do not cut white pine, oak, cedar, and hemlock.
- Within Payment Unit 5, do not cut red pine, white pine, oak, cedar, and hemlock. Also, do not cut sub merchantable spruce and fir.

2.1.3 - Cut Tree Marked Unit(s) (12/08)

Within Payment Unit(s) 4, , all trees are designated for cutting when marked with orange paint above and below stump height, regardless of merchantability.

3 - Payments

3.3 - Pre-measured Sales

3.3.4 - Dividing Payment Units (7/14)

Payment Unit(s) \$18,000 in value or greater may be divided at the request of the Purchaser and upon approval of the Unit Manager. Dividing Payment Units is a contract modification which requires a Timber Sale Contract Amendment. There will be only one division per Payment Unit.

3.4 - Damaged Timber

3.4.1 - Damaged Timber (12/24)

General Condition and Requirement 3.4 Damaged Timber, defines liquidated damages for undesignated live merchantable trees which are cut or injured. In Unit 5, if more than 25% of the tree seedlings or saplings are damaged, this is assessed at a rate of \$100 per acre.

4 - Transportation

4.1 - Construction

4.1.3 - Slash and Earthen Piles (8/04)

Piles or windrows of earth along roads and landings that have been widened or constructed shall be leveled. Slash from road maintenance or construction, including stumps, shall be dispersed throughout the sale.

4.1.6 - Road Construction (4/24)

All new roads or improvements of existing roads shall be done in such a way as to minimize the environmental and visual impacts. Merchantable trees shall be cut and utilized unless otherwise directed. Non-merchantable trees shall be severed and laid flat on the ground. Slash shall be scattered, not left in windrows, and kept a minimum of 10 feet back from the road edge. Stumps shall be set upright, not left on edge, and be moved at least 10 feet away from the road or snowmobile trail

edge. Disturbed soil shall be feathered into the woods and not left in berms or windrows.

4.1.7 - Road Closure (10/11)

All new roads built into the sale must be blocked to vehicle traffic upon completion of the sale. Overgrown roads that are reopened shall be considered new roads. In general, this will require constructing a four (4') foot high berm of stumps and logs covered with earth. These roads must be rendered impassable to cars and trucks. Contact the Sale Administrator for specific details of design and placement.

4.2 - Maintenance

4.2.1 - Hauling Restriction (12/08)

Hauling may be restricted on forest roads by the Unit Manager or his/her representative. The restriction may occur during spring breakup or during wet weather conditions.

4.2.2 - Fill Material (4/07)

To maintain roads, fill material may be needed in areas where "holes" exist or may be expected to develop. This fill material should be placed before trucking begins. Contact the Sale Administrator regarding the availability of onsite sand or gravel from adjacent State-owned lands.

4.2.4 - Grading (10/16)

For completion of the sale, state forest roads must be graded. In general, this will require a road grader or bulldozer to shape up the roads after forest products have been hauled off site. This includes cleaning of drainage areas, grading, crowning and filling with gravel, if necessary. The grading equipment to be used must be approved by the Unit Manager or his/her representative.

4.2.5 - Two Wheel Drive Condition (2/04)

All existing trail roads on and adjacent to the Sale Area must be passable by two-wheel drive traffic for the duration of the sale.

5 - Operations

5.1 - Notification

5.1.1 - Pre-sale Conference (10/25)

A pre-sale conference on site between the Purchaser and Sale Administrator is required prior to beginning any operations a Payment Unit to determine landing and road locations. The Unit Manager or his/her representative must be contacted at least 10 days in advance to schedule the conference.

5.1.6 - Utility R.O.W. (1/25)

It is the responsibility of the Purchaser to obtain permission from the utility company to utilize the power line right-of-way (R.O.W.) for operations.

5.2 - Conduct of Operations

5.2.3 - Operating Restrictions

5.2.3.1 - Operating Restrictions (9/11)

Within Payment Unit(s) 2, unless changed by written agreement, cutting, skidding, and hauling are not permitted during the period of March 1 to May 15. This restriction is to avoid resource damage during spring break up conditions.

5.2.3.3 - Bark Slippage Restriction (3/09)

Within Payment Unit(s) 4, unless changed by written agreement, cutting and skidding are not permitted during the period of April 15 to July 15. This restriction is because of bark slippage.

5.2.32 - Decking/Landing Restoration (9/13)

All decking and landing areas must have the surface area restored to a condition equal to or better than before. This is to ensure the proper regeneration of the stand. Wood debris, chips and "cookies" from trimmings must be removed or scattered away from landing and loading areas and may not be windrowed on the edge.

5.2.37 - No Decking Areas (12/08)

No decking is allowed along Snowmobile Trail Number 5 or in boat launch area identified on sale map.

5.2.38 - No Decking Against Live Trees (2/04)

Cut products may not be decked against unmarked or designated leave trees.

5.2.41 - Snowmobile Trail Protection (9/11)

Snowmobile Trail Number 5 is shown on the Timber Sale Map. Do not cut or damage posts with orange trail markers or traffic control signs. If the trail is used, it must be maintained and restored to a condition equal to or better than before the sale. The road maintenance/restoration must be done prior to December 1. If the trail is used for hauling, it must be graded to the satisfaction of the Unit Manager or his/her representative prior to December 1. If the trail road is to be used for hauling during the snowmobile season, then a snow-covered base must be left on the trail. Maintain a 20-foot-wide slash, debris, and rut free zone daily using the snowmobile trail as the centerline. No decking of forest products will be permitted along the snowmobile trail.

5.3 - Stream Protection

5.3.2 - Parking Equipment Near Water (10/23)

Within Payment Unit(s) the parking of or storage of equipment is prohibited within 100 feet of water bodies or ground water supplies. All equipment, when not in use for harvest operations, must be parked a minimum of 100 feet away from water sources (streams, rivers, lakes, ponds, vernal pools, ground water sources) and 50 feet away from slopes leading to water sources and/or riparian areas. This restriction is for preventing unforeseen oil and/or fluid leaks from contaminating water bodies and/or ground water supplies.

5.4 - Soil Protection

5.4.1 - Rutting Restriction, General (7/16)

The Unit Manager or his/her representative may restrict hauling and/or skidding if ruts exceed the specified depth. With the Unit Manager or his/her representative's approval, the Purchaser may return to the area when the risk of rutting has decreased.

5.7 - Protection of Historical Sites

5.7.1 - Historical Sites (7/12)

The Purchaser shall not cut live or dead trees or operate equipment within historical sites. Historical sites are marked with red slashes. The Purchaser shall protect historical sites from damage by the Purchaser's operations. If Purchaser's operations have cut or damaged historical sites through carelessness, the Purchaser shall pay \$1,500 as fixed, agreed and liquidated damages for each acre or part thereof cut or damaged.

6 - Safety and Fire Prevention

6.2 - Signing

6.2.1 - Road Posting (10/20)

The Purchaser is responsible for posting and maintaining caution signs on Groveland Mine Rd, Snowmobile trail Number 5, and Merriman East Rd prior to beginning operations. The road must be posted at appropriate distances from the Sale Area to warn of logging activity and truck traffic. Signs must be removed when harvest operations are suspended or completed. The Purchaser will provide these signs.

6.2.2 - Snowmobile Trail Posting (10/20)

The Purchaser is responsible for posting and maintaining caution signs on Snowmobile Trail Number 5 prior to beginning operations during the snowmobile season (approximately December 1 to March 31). The trail must be posted at appropriate distances from the Sale Area to warn of logging activity and truck traffic. Signs must be removed when harvest operations are suspended or completed. The Purchaser will provide these signs.

**TIMBER SALE MAP**

This information provided by authority of Part 525, 1994 PA 451, as amended.

Sale Number

12-009-25

Date

09/16/2025

Forest Management Unit

County

Mapped By: Baker

Scale

Page

Of

Crystal Falls Mgt Unit

Dickinson

Cruised By: Baker

1:11,000**1****1**Township
41NRange
29W

Section(s) and

Subdivision(s) Sec. 17 W1/2NW,NWSW; Sec. 18 SENE,N1/2SE; Sec. 5 E1/2NE,N1/2SE; Sec. 8 N1/2NW,SENW;

Cover Type

A = Aspen	J = Jack Pine	O = Oak	U = Upland Brush
B = Paper Birch	K = Rock	P = Lowland Poplar	UM = Upland Mix Forest
C = Cedar	L = Lowland Brush	Q = Mixed Swamp Conifer	V = Bog or Marsh
D = Treed Bog	LM = Lowland Mix Forest	R = Red Pine	W = White Pine
E = Swamp Hardwoods	M = Maple, Beech, Birch	S = Black Spruce	X = Non Stocked
F = Spruce/Fir	MC = Mixed Conifer	T = Tamarack	Y = Sand
G = Grass	MD = Mixed Deciduous		Z = Water
H = Hemlock	N = Marsh		

Density

0 = Non Stocked	5 = Pole Timber Medium
1 = Seedling Sapling Poor	6 = Pole Timber Well
2 = Seedling Sapling Medium	7 = Saw Timber Poor
3 = Seedling Sapling Well	8 = Saw Timber Medium
4 = Pole Timber Poor	9 = Saw Timber Well

South Pond Shores

Dickinson County, Compartment 113 and 71

Unit	1	2	3	4	5	Totals
Acres	8.9	10.3	4.9	22.2	24.5	70.8

Pulpwood CORDS

Balsam Fir	11	0	3	8	0	22
Mixed Aspen	334	122	33	61	364	914
Mixed Hardwood	60	57	28	66	180	391
Red Pine	0	0	1	21	0	22
White Pine	0	0	0	31	0	31
White Spruce	6	13	0	6	5	30
Total	411	192	65	193	549	1410

Sawlog MBF

Paper Birch	0	0	3.1	0	0	3.1
Red Maple	0	0	4.6	0	0	4.6
Red Pine	0	0	1.4	10.8	0	12.2
Sugar Maple	0	5	0	0	0	5
White Pine	0	0	0	14.7	0	14.7
Total	0	5	9.1	25.5	0	39.6

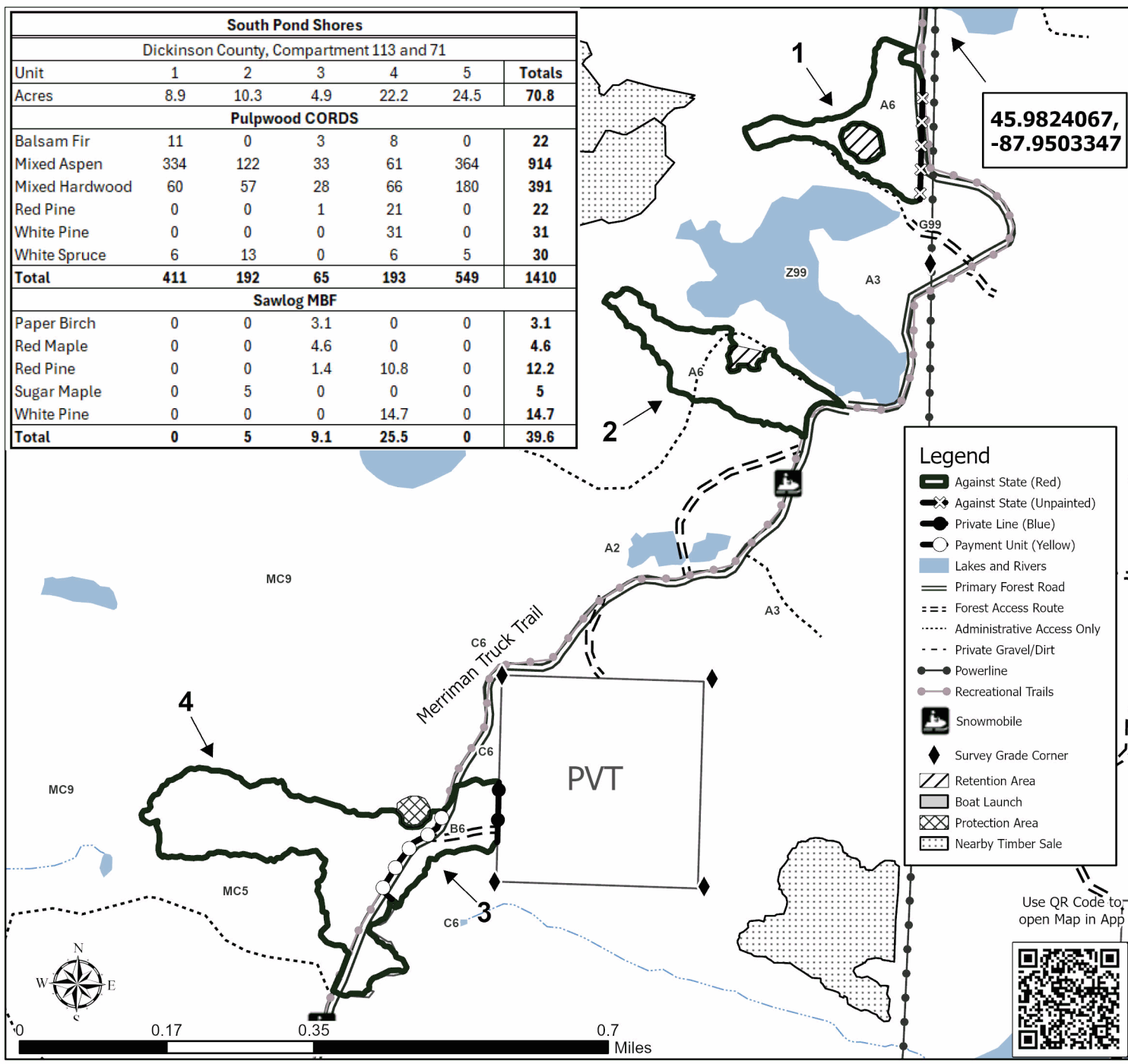

**TIMBER SALE MAP**

This information provided by authority of Part 525, 1994 PA 451, as amended.

Sale Number

12-009-25

Date

09/16/2025

Forest Management Unit	County	Mapped By: Baker	Scale	Page	Of
Crystal Falls Mgt Unit	Dickinson	Cruised By: Baker	1:10,000	1	2

Township	Range	Section(s) and Subdivision(s)
41N	29W	Sec. 17 W1/2NW,NWSW; Sec. 18 SENE,N1/2SE; Sec. 5 E1/2NE,N1/2SE; Sec. 8 N1/2NW,SENW;

Cover Type

A = Aspen	J = Jack Pine	O = Oak	U = Upland Brush
B = Paper Birch	K = Rock	P = Lowland Poplar	UM = Upland Mix Forest
C = Cedar	L = Lowland Brush	Q = Mixed Swamp Conifer	V = Bog or Marsh
D = Treed Bog	LM = Lowland Mix Forest	R = Red Pine	W = White Pine
E = Swamp Hardwoods	M = Maple, Beech, Birch	S = Black Spruce	X = Non Stocked
F = Spruce/Fir	MC = Mixed Conifer	T = Tamarack	Y = Sand
G = Grass	MD = Mixed Deciduous	Z = Water	
H = Hemlock	N = Marsh		

Density

0 = Non Stocked	5 = Pole Timber Medium
1 = Seedling Sapling Poor	6 = Pole Timber Well
2 = Seedling Sapling Medium	7 = Saw Timber Poor
3 = Seedling Sapling Well	8 = Saw Timber Medium
4 = Pole Timber Poor	9 = Saw Timber Well

South Pond Shores						
Dickinson County, Compartment 113 and 71						
Unit	1	2	3	4	5	Totals
Acres	8.9	10.3	4.9	22.2	24.5	70.8
Pulpwood CORDS						
Balsam Fir	11	0	3	8	0	22
Mixed Aspen	334	122	33	61	364	914
Mixed Hardwood	60	57	28	66	180	391
Red Pine	0	0	1	21	0	22
White Pine	0	0	0	31	0	31
White Spruce	6	13	0	6	5	30
Total	411	192	65	193	549	1410
Sawlog MBF						
Paper Birch	0	0	3.1	0	0	3.1
Red Maple	0	0	4.6	0	0	4.6
Red Pine	0	0	1.4	10.8	0	12.2
Sugar Maple	0	5	0	0	0	5
White Pine	0	0	0	14.7	0	14.7
Total	0	5	9.1	25.5	0	39.6

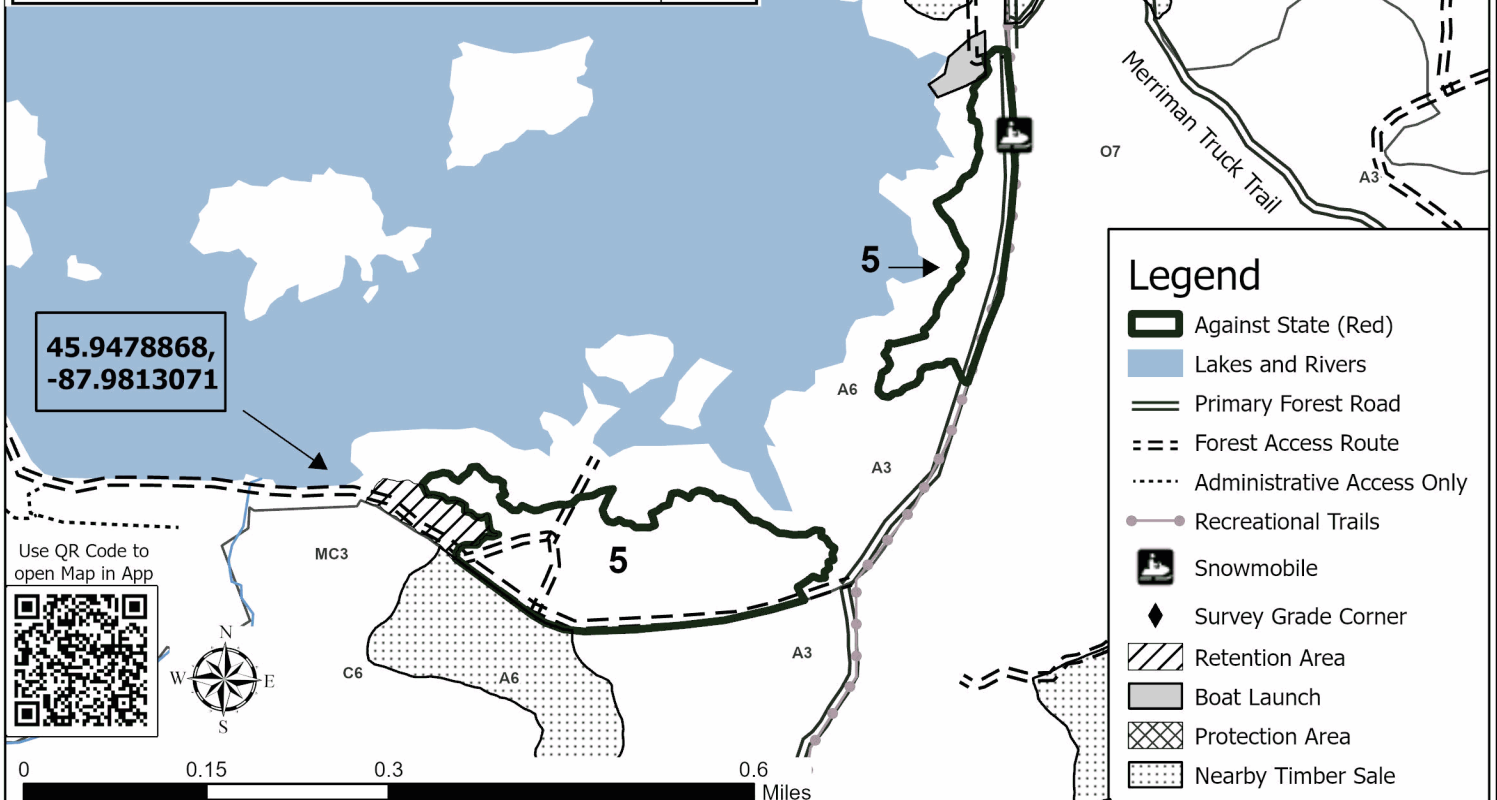

BID INSTRUCTIONS (VER. 10/10/2022):

1. Scheduled Bid Location, Date, and Time (2/11)

Bids must be received by the Unit Manager, ESCANABA OFFICE, 6833 US-2, 41 & M-35, Gladstone, MI 49837, no later than 3:00 p.m. (local time) on January 7, 2026. For further information concerning this sale, contact Dan Racine at 906-789-8231.

2. Bidder's Qualifications (10/22)

If all or part of a timber sale was prepared by a private contractor, the contractor and that contractor's company are not permitted to bid on the timber sale. A person must be 18 years of age or older to purchase timber. Permanent employees of the Department of Natural Resources or members of their immediate household may not bid. Former employees, in the permanent or seasonal class, may not bid until 3 months after the last day of active duty. Bids will not be accepted from individuals or companies appearing on the DNR/FRD No-Bid List. This list contains the names of purchasers who previously failed to execute a contract within 21-days or who have a history of poor performance.

3. Preparation of Sealed Bids (5/16)

Bid Forms may be completed online thru Michigan DNR Timber Sale Online Bidding (OLB) at www.michigan.gov/timberbidding or by completing the hardcopy Bid Form found in the Timber Sale Prospectus. Hardcopy Bid Forms shall be manually signed in ink. Registration in OLB is considered your 'signature' for all bids submitted thru that system. Bid prices must be entered for each species and product in the Bid Price column for all material subject to bidding and all fill-in blanks must be completed. If erasures or other changes appear on the hardcopy Bid Form, each erasure or change must be initialed by the person signing the bid.

4. Submission of Sealed Bids (5/16)

Bid forms may be obtained from the Unit Manager or thru OLB. Bids may be submitted hardcopy or thru OLB. All hardcopy bids must be submitted on the bid form and in an envelope clearly identified as described in this section. NOTE: Only one bid form per bid envelope. Sealed bids must be submitted to the Unit office designated in the prospectus and must be submitted at or prior to the time established in the prospectus. The envelope should show on the outside (a) the sale name or number and (b) the date and time of bid opening, as shown in the prospectus. Bids received after the time specified in the sale prospectus are late bids and will be rejected.

It is possible for a bidder to submit multiple bids on a single sale. For example, a bid may be submitted hardcopy and a bid may be submitted thru OLB. Or, two bidders from the same company could both submit bids on the same sale. If this were to happen, the State would accept all bids received and award the contract accordingly. All bidding and contractual requirements would apply to all bids received.

5. Public Opening of Sealed Bids (7/16)

If conditions permit, the sealed bids will be publicly opened and posted at the time and place set in the prospectus.

If a bidder, present at a bid opening, has submitted bids on more than one sale, that bidder may withdraw their unopened bid envelopes or announce the withdrawal of their online bid after being declared the successful bidder on one sale.

6. Award of Contract (1/11)

Award of the contract will be made to the Bidder whose bid, conforming to the prospectus, is most advantageous to the State of Michigan on the basis of total value at rates bid for the estimated quantities. The State reserves the right to reject any bid or waive any minor irregularity in bids received. A written award mailed (or otherwise furnished) to the successful Bidder shall be deemed to result in a binding contract without further action by either party.

7. Down Payment (1/11)

The Bidder to whom award is made must make a down payment within 21 days of the sale award. The amount of the down payment will be calculated as shown in the Bond and Payment Schedule of this prospectus. Only cash may be used to meet this requirement.

8. Performance Security (1/11)

As guarantee of faithful performance, a cash bond, certificate of deposit, surety bond or irrevocable letter of credit (LOC) is required within 21 days of the sale award. The amount of the performance security is shown in the Bond and

Payment Schedule of this prospectus. If an LOC or surety is used, the coverage must extend for at least 6 months beyond the contract expiration.

9. Worker's Compensation (10/22)

Purchaser shall obtain worker's compensation insurance to cover claims under Michigan's Worker's Disability Compensation Act of 1969 or similar employee benefit act of any other state applicable to an employee. Verification of Worker's Disability Compensation Act Compliance must be completed and submitted within 21 days of contract award and prior to the issuance of the timber sale contract. In addition, if applicable, Notice of Exclusion or Certificate of Insurance must also be submitted.

10. Timber Sale Contract (10/22)

Additional conditions and requirements common to all timber sales are listed on the timber sale contract (R4031) and are available on line at www.michigan.gov/timber. Contact the Unit Manager for additional information or a sample contract. Within 21 days of the date of the award letter, the bidder must sign the contract and provide the required down payment, performance security, and verification of worker's disability compensation. The down payment and performance security shall be in accordance with the provisions of the timber sale contract, in the sums stated in this prospectus. If these actions are not taken, then the Bidder, the Bidder's corporation, and the corporation's principals may not be permitted to bid on State timber sales for a period of 3 months after the first offense, 6 months after the second offense, and 1 year after the third offense. An offense will only be counted against the Bidder for 5 years. In addition, the Bidder certifies that if awarded this contract, the Bidder will complete the timber sale contract in accordance with its terms and any modifications thereof including requirements to purchase, cut, and remove the included timber by the expiration date.

Payment Unit values in the State Forest Timber Sale Contract are calculated based on the advertised value of the Payment Unit as a percentage of the total advertised value of the contract. The advertised value of each Payment Unit is given in the Description of Timber by Payment Unit table on the Timber Sale Information page. For example, if the value of Payment Unit 1 is advertised as \$1,500 and the total Timber Sale value is advertised as \$10,000, the contract price for Payment Unit 1 will be 15% of the total bid price ($\$1,500/\$10,000 * 100$).

11. Disclaimer of Estimates and Bidder's Warranty of Inspection (10/22)

Before submitting this bid, the Bidder is advised and cautioned to inspect the sale area, review the requirements of the sale contract, and take other steps as may be reasonably necessary to ascertain the location, estimated volumes, construction estimates, and operating costs of the proposed sale. Failure to do so will not relieve the Bidder from responsibility for completing the contract.

The Bidder warrants that this bid is submitted solely on the basis of the Bidder's examination and inspection of the quality and quantity of the timber offered for sale and the Bidder's opinion of the value thereof and the costs of recovery. No reliance should be placed on the State of Michigan's estimates of timber quality, quantity or costs of recovery. Bidder further acknowledges that the State of Michigan: (i) expressly disclaims any warranty of fitness of timber for any purpose; (ii) offers this timber as is without any warranty of quality (merchantability) or quantity and (iii) expressly disclaims any warranty as to the quantity or quality of timber sold.

12. Certification and Chain-of-Custody (10/22)

Unless otherwise indicated in the contract under section 7 – Other Conditions of the Sale Specific Conditions & Requirements, the area encompassed by this timber sale is certified to the standards of the Forest Stewardship Council (FSC) - Certificate #SCS-FM/COC-00090N and the Sustainable Forestry Initiative (SFI) - Certificate #NSF-SFIS-5Y031-SF5. Forest products from this sale may be delivered to the mill as "FSC 100% and / or SFI certified" as long as the contractor hauling the forest products is chain-of-custody (COC) certified or covered under a COC certificate from the destination mill. The purchaser is responsible for maintaining COC after leaving the sale area.

13. Good Neighbor Authority (GNA) Requirements (10/22)

If the name of this timber sales contains the acronym GNA, it is authorized by the Good Neighbor Authority (GNA) and covered by various agreements between the U.S. Forest Service and the State. The timber sale occurs on federal land and the following conditions apply:

GNA contracts on US Forest Service land will not be awarded to purchasers on the Federal list of excluded parties. The System for Award Management (SAM) will be checked for active excluded parties prior to award of contract. In

addition, the Bidder to whom award is made must complete an Assurance Regarding Felony Conviction or Tax Delinquent Status for Corporate Applicants (AD-3031).

14. Good Neighbor Authority (GNA) Requirements, con't (10/22)

Bidder certifies, by signing this bid form, that to the best of Bidder's knowledge that the following representations are accurate and complete.

- a. That the Bidder and its principals are not presently debarred, suspended, proposed for debarment, declared ineligible, or voluntary excluded from timber sales (covered transactions) by any Federal department or agency.
- b. That the Bidder and its principals have not within a 3-year period preceding this bid been convicted of or had a civil judgment rendered against them for commission of fraud or a criminal offense in connection with obtaining , attempting to obtain, or performing a public (Federal, State, or local) transaction or contract under a public transaction; violation of Federal or State antitrust statutes or commission of embezzlement, theft, forgery, bribery, falsification or destruction of records, making false statements, or receiving stolen property.
- c. That the Bidder and its principals are not presently indicted for or otherwise criminally or civilly charged by a governmental entity (Federal, State, or local) with commission of any of the offenses enumerated in paragraph b of this certification.
- d. That the Bidder and its principals have not within a 3-year period preceding this bid had one or more public transactions (Federal, State, or local) terminated for breach or default of a timber or forest product contract.

Bidders that cannot certify this requirement, in whole or in part, shall submit an explanation with their bid.

Scott Bowen
Director

TIMBER SALE INFORMATION

Drone Catcher (33-026-25)

T36N, R28W, SEC. 1; T37N, R28W, SEC. 35; T37N, R28W, SEC. 36.

Menominee County (Advertised Price \$50,866.75)

SALE NOTE: Payment Units 1, 5, 6, and 7 are restricted for three months due to bark slippage and oak wilt concerns. Payment Unit 8 is restricted to winter cut only, unless there is an extended dry period during the summer months.

A timber sale contract for this lump sum, sealed bid timber sale will be awarded to the responsible bidder offering the highest sealed bid price. All units of volume listed below were estimated using the Inventory Manager computer program and the new Michigan taper model. Bids must be at or above the following advertised price for each product and species:

<u>PRODUCTS & SPECIES</u>	<u>ESTIMATED UNITS*</u>	<u>ADVERTISED PRICE</u>
Sawtimber		
Basswood	39.8 MBF	\$ 51.00 / MBF
Paper Birch	0.8 MBF	\$ 68.00 / MBF
Red Maple	8.1 MBF	\$ 103.00 / MBF
Red Oak	54.7 MBF	\$ 155.00 / MBF
Sugar Maple	15.1 MBF	\$ 212.00 / MBF
Pulpwood		
Balsam Fir	140 Cords	\$ 8.70 / Cord
Mixed Aspen	502 Cords	\$ 24.95 / Cord
Mixed Hardwood	598 Cords	\$ 16.50 / Cord
Mixed Spruce	47 Cords	\$ 11.95 / Cord
N. White Cedar	19 Cords	\$ 6.95 / Cord
Red Oak	82 Cords	\$ 15.85 / Cord
Red Pine	79 Cords	\$ 54.15 / Cord
Tamarack	56 Cords	\$ 10.10 / Cord
White Pine	313 Cords	\$ 18.60 / Cord

* The total volume is statistically estimated within plus (+) or minus (-) 11.67 percent. There are an estimated 2,111 cords on this timber sale, plus or minus 247 cords at the 95% confidence level. The estimated units are final and not subject to adjustment. Prospective bidders are urged to examine this timber and to make their own estimates of quantity and quality.

BOND AND PAYMENT SCHEDULE:

1. A bond in the amount of \$2,543.00 to insure faithful performance of the conditions of the contract will be deposited by the successful bidder within 21 days of the sale award.
2. Cutting in any sale or unit without the required advance payment would be considered a trespass.
3. Total payment must be paid in advance or according to the following schedule :
 - (a) Ten percent (10%) of the sale value must be paid within 21 days of the sale award.
 - (b) The 10% down payment will be credited towards the first unit cut.
 - (c) Payment for each of the following units must be made before cutting begins in that unit:

<u>PAYMENT UNIT NUMBER</u>	<u>PERCENT OF TOTAL SALE VALUE</u>
01	6.5%
02	13.5%
03	20.8%
04	18.6%
05	14.0%
06	8.5%
07	9.3%
08	8.8%

4. If no cutting takes place, the 10% down payment will not be refunded.
5. Operations on the contract issued will terminate on 09/30/2028.

SALE STATISTICS

Volumes were calculated in cubic feet using the Michigan taper model. Cubic foot volume includes all wood inside bark for the product indicated. For display purposes, cubic feet were converted to cords and MBF using a simple conversion factor, e.g. 79 cubic feet per cord and 185 cubic feet per MBF. The cubic foot volumes are precise; the cords and MBF volumes are not. Cubic foot volume cannot be directly converted to cords or boards with precision.

SALE VOLUMES

The total estimated sale volume may not equal the sum of the species/products due to the nature of statistical calculations associated with double sampling methodology.

VOLUME			STATISTICAL RANGE IN CORDS	
TOTAL CUBIC FEET	TOTAL CORDS	PERCENT ERROR	MINIMUM	MAXIMUM
166,763	2,111	11.67%	1,864	2,357

VDU VOLUMES

A VDU is a Volume Determination Unit. Volumes and their associated statistics are calculated at the VDU level and summarized to the sale level. There is often a one to one relationship between a VDU and a Payment Unit, but not always, depending on the cruise design. Refer to the VDU TO PAYMENT UNIT table.

	VOLUME			RANGE IN CORDS	
VDU	TOTAL CUBIC FEET	TOTAL CORDS	PERCENT ERROR	MINIMUM	MAXIMUM
51	8,136	103	42.30%	59	147
52	87,262	1,105	19.16%	893	1,316
53	20,369	258	26.29%	190	326
55	29,339	371	18.98%	301	442
56	21,656	274	28.70%	195	353
TOTAL:	166,763	2,111		1,639	2,583

VDU TO PAYMENT UNIT

When a VDU is associated with more than one Payment Unit (PU), the VDU volumes are assigned to the PU based on acres of the VDU within the PU.

VDU	VDU ACRES	PU	PU ACRES
TOTAL:			

DESCRIPTION OF TIMBER BY PAYMENT UNIT (PU)

PU	MARKET GROUP	PRODUCT	QUANTITY	UNIT	ACRES	ADVERTISE PRICE
1	Basswood	Sawtimber	4.3	MBF	13.6	\$3,314.65
	Red Oak		9.9	MBF		
	Sugar Maple		2.1	MBF		
	Mixed Aspen	Pulpwood	4	Cords		
	<i>Quaking Aspen</i>		4	<i>Cords</i>		
	Mixed Hardwood		51	Cords		
	<i>Basswood</i>		8	<i>Cords</i>		
	<i>Ironwood</i>		1	<i>Cords</i>		
	<i>Sugar Maple</i>		17	<i>Cords</i>		
	<i>White Ash</i>		25	<i>Cords</i>		
	Red Oak		11	Cords		
2	Basswood	Sawtimber	1.7	MBF	10.8	\$6,871.40
	Paper Birch		0.2	MBF		
	Red Maple		1.4	MBF		
	Red Oak		6.2	MBF		
	Sugar Maple		1.0	MBF		
	Balsam Fir	Pulpwood	28	Cords		
	Mixed Aspen		118	Cords		
	<i>B. T. Aspen</i>		5	<i>Cords</i>		
	<i>Quaking Aspen</i>		113	<i>Cords</i>		
	Mixed Hardwood		45	Cords		
	<i>Balsam Poplar</i>		1	<i>Cords</i>		
	<i>Basswood</i>		6	<i>Cords</i>		
	<i>Black Ash</i>		1	<i>Cords</i>		
	<i>Paper Birch</i>		3	<i>Cords</i>		
	<i>Red Maple</i>		15	<i>Cords</i>		
	<i>Sugar Maple</i>		14	<i>Cords</i>		
	<i>White Ash</i>		5	<i>Cords</i>		
	Mixed Spruce		1	Cords		
	<i>White Spruce</i>		1	<i>Cords</i>		
	N. White Cedar		4	Cords		
	Red Oak		9	Cords		
	Red Pine		10	Cords		
	White Pine		43	Cords		
3	Basswood	Sawtimber	2.6	MBF	16.7	\$10,597.85
	Paper Birch		0.3	MBF		
	Red Maple		2.2	MBF		
	Red Oak		9.5	MBF		
	Sugar Maple		1.6	MBF		
	Balsam Fir	Pulpwood	43	Cords		
	Mixed Aspen		182	Cords		
	<i>B. T. Aspen</i>		7	<i>Cords</i>		
	<i>Quaking Aspen</i>		175	<i>Cords</i>		
	Mixed Hardwood		68	Cords		
	<i>Balsam Poplar</i>		1	<i>Cords</i>		
	<i>Basswood</i>		9	<i>Cords</i>		
	<i>Black Ash</i>		1	<i>Cords</i>		
	<i>Paper Birch</i>		5	<i>Cords</i>		
	<i>Red Maple</i>		23	<i>Cords</i>		
	<i>Sugar Maple</i>		22	<i>Cords</i>		
	<i>White Ash</i>		7	<i>Cords</i>		
	Mixed Spruce		1	Cords		
	<i>White Spruce</i>		1	<i>Cords</i>		
	N. White Cedar		6	Cords		
	Red Oak		14	Cords		
	Red Pine		16	Cords		

DESCRIPTION OF TIMBER BY PAYMENT UNIT (PU), CON'T

PU	MARKET GROUP	PRODUCT	QUANTITY	UNIT	ACRES	ADVERTISE PRICE
3 con't	White Pine	Pulpwood	66	Cords		
4	Basswood	Sawtimber	2.3	MBF	15.0	\$9,480.65
	Paper Birch		0.3	MBF		
	Red Maple		2.0	MBF		
	Red Oak		8.6	MBF		
	Sugar Maple		1.4	MBF		
	Balsam Fir	Pulpwood	39	Cords		
	Mixed Aspen		163	Cords		
	<i>B. T. Aspen</i>		6	Cords		
	<i>Quaking Aspen</i>		157	Cords		
	Mixed Hardwood		60	Cords		
	<i>Balsam Poplar</i>		1	Cords		
	<i>Basswood</i>		8	Cords		
	<i>Black Ash</i>		1	Cords		
	<i>Paper Birch</i>		5	Cords		
	<i>Red Maple</i>		20	Cords		
	<i>Sugar Maple</i>		19	Cords		
	<i>White Ash</i>		6	Cords		
	Mixed Spruce		1	Cords		
	<i>White Spruce</i>		1	Cords		
	N. White Cedar		5	Cords		
	Red Oak		12	Cords		
	Red Pine		14	Cords		
	White Pine		60	Cords		
5	Red Maple	Sawtimber	2.5	MBF	19.2	\$7,116.70
	Red Oak		6.7	MBF		
	Sugar Maple		2.3	MBF		
	Balsam Fir	Pulpwood	3	Cords		
	Mixed Hardwood		47	Cords		
	<i>Basswood</i>		3	Cords		
	<i>Red Maple</i>		21	Cords		
	<i>Sugar Maple</i>		23	Cords		
	Mixed Spruce		2	Cords		
	<i>White Spruce</i>		2	Cords		
	N. White Cedar		4	Cords		
	Red Oak		20	Cords		
	Red Pine		36	Cords		
	White Pine		119	Cords		
6	Basswood	Sawtimber	13.9	MBF	18.6	\$4,299.70
	Red Oak		5.5	MBF		
	Sugar Maple		3.2	MBF		
	Balsam Fir	Pulpwood	3	Cords		
	Mixed Aspen		3	Cords		
	<i>Quaking Aspen</i>		3	Cords		
	Mixed Hardwood		112	Cords		
	<i>Basswood</i>		30	Cords		
	<i>Beech</i>		1	Cords		
	<i>Ironwood</i>		1	Cords		
	<i>Paper Birch</i>		1	Cords		
	<i>Red Maple</i>		4	Cords		
	<i>Sugar Maple</i>		26	Cords		
	<i>White Ash</i>		49	Cords		
	Red Oak		7	Cords		
7	Basswood	Sawtimber	15.0	MBF	20.3	\$4,721.20
	Red Oak		6.1	MBF		
	Sugar Maple		3.5	MBF		

DESCRIPTION OF TIMBER BY PAYMENT UNIT (PU), CON'T

PU	MARKET GROUP	PRODUCT	QUANTITY	UNIT	ACRES	ADVERTISE PRICE
7 con't	Balsam Fir	Pulpwood	4	Cords		
	Mixed Aspen		3	Cords		
	<i>Quaking Aspen</i>		3	Cords		
	Mixed Hardwood		123	Cords		
	<i>Basswood</i>		32	Cords		
	<i>Beech</i>		1	Cords		
	<i>Ironwood</i>		1	Cords		
	<i>Paper Birch</i>		2	Cords		
	<i>Red Maple</i>		5	Cords		
	<i>Sugar Maple</i>		29	Cords		
	<i>White Ash</i>		53	Cords		
	Red Oak		7	Cords		
	White Pine		1	Cords		
8	Red Oak	Sawtimber	2.2	MBF	25.9	\$4,464.60
	Balsam Fir	Pulpwood	20	Cords		
	Mixed Aspen		29	Cords		
	<i>Quaking Aspen</i>		29	Cords		
	Mixed Hardwood		92	Cords		
	<i>Balsam Poplar</i>		25	Cords		
	<i>Black Ash</i>		3	Cords		
	<i>Paper Birch</i>		6	Cords		
	<i>Red Maple</i>		25	Cords		
	<i>Sugar Maple</i>		19	Cords		
	<i>White Ash</i>		14	Cords		
	Mixed Spruce		42	Cords		
	<i>Black Spruce</i>		16	Cords		
	<i>White Spruce</i>		26	Cords		
	Red Oak		2	Cords		
	Red Pine		3	Cords		
	Tamarack		56	Cords		
	White Pine		24	Cords		
	TOTAL:			118.5		
TOTAL:			1,836	Cords		

Sale Specific Conditions & Requirements

Sale Name: Drone Catcher

Sale Number: 33-026-25 Seq#: 1

1 - Sale Area

1.2 - Boundaries

1.2.1 - Painted Boundaries (9/19)

The sale boundary and Payment Unit boundaries are marked and identified by blue, red and yellow paint. Exterior sale boundary lines against private property are marked with blue paint. Exterior sale boundary lines against state are marked with red paint. Interior Payment Unit boundaries are marked with yellow paint. Retention patches are marked with red paint; no harvesting activities may occur within these areas. The painted boundary line trees are not Included Timber and are to be protected unless marked with orange paint. Yellow painted trees designating an interior Payment Unit boundary are only to be cut when all surrounding Payment Units have been paid for.

2 - Timber Specifications

2.1 - Included Timber

2.1.1 - Clearcut Unit(s) with Unmerchantable Trees (6/14)

Within Payment Unit(s) 2-5 and 8, cut all trees that are three (3) inches or more at DBH, except do not cut trees marked with green paint at DBH. In addition, the following exceptions apply:

- Within Payment Unit 5, do not cut pine less than five (5) inches at DBH or any hemlock.

- Within Payment Unit 8, do not cut cedar.

2.1.3 - Cut Tree Marked Unit(s) (12/08)

Within Payment Unit(s) 1, 6 and 7, all trees are designated for cutting when marked with orange paint above and below stump height, regardless of merchantability. In addition, within Payment Units 6 and 7, cut all ironwood greater than three (3) inches at DBH.

2.1.9 - Harvest Exception (12/24)

Do not cut any cedar trees within Payment Unit 8, other than those that are necessary to remove in order to operate within the Sale Area. Every effort must be made to preserve the existing cedar and to leave an intact stand upon sale completion. All cut cedar shall be piled separately by product and scaled in the woods, unless other scaling arrangements are agreed to by the Unit Manager or his/her representative. Stumpage price for cedar shall be \$35.00 per cord.

2.2 - Utilization

2.2.4 - Skidding Length (12/24)

Skidding of unlimbed tops or lengths over 17 feet is not permissible within Payment Units 1 and 5-7.

3 - Payments

3.3 - Pre-measured Sales

3.3.4 - Dividing Payment Units (7/14)

Payment Unit(s) \$18,000 in value or greater may be divided at the request of the Purchaser and upon approval of the Unit Manager. Dividing Payment Units is a contract modification which requires a Timber Sale Contract Amendment. There will be only one division per Payment Unit.

4 - Transportation

4.2 - Maintenance

4.2.1 - Hauling Restriction (12/08)

Hauling may be restricted on forest roads by the Unit Manager or his/her representative. The restriction may occur during spring breakup or during other wet weather conditions.

4.2.4 - Grading (10/16)

For completion of the sale, state forest roads must be graded. In general, this will require a road grader or bulldozer to shape up the roads after forest products have been hauled off site. This includes cleaning of drainage areas, grading, crowning and filling with gravel, if necessary. The grading equipment to be used must be approved by the Unit Manager or his/her representative.

5 - Operations

5.2 - Conduct of Operations

5.2.3 - Operating Restrictions

5.2.3.1 - Operating Restrictions (9/11)

Within Payment Unit(s) 8, cutting and skidding are limited to the period of December 1 to March 31, unless there is an extended dry or frozen period and the Sale Administrator allows harvesting during that period of time. This restriction is because of low wet ground throughout most of the Payment Unit.

5.2.3.3 - Bark Slippage Restriction (3/09)

Within Payment Unit(s) 1 and 5-7, cutting and skidding are not permitted during the period of April 15 to July 15. This restriction is because of bark slippage and to prevent the spread of oak wilt.

6 - Safety and Fire Prevention

6.2 - Signing

6.2.1 - Road Posting (10/20)

The Purchaser is responsible for posting and maintaining caution signs on Carlson Lane prior to beginning operations. The road must be posted at appropriate distances from the Sale Area to warn of logging activity and truck traffic. Signs must be removed when harvest operations are suspended or completed. The Purchaser will provide these signs.

7 - Other Conditions

7.3 - Contract Modifications

7.3.2 - Modification for Oak Wilt (2/05)

Within the Sale Area, there may be patches of oak wilt. If oak wilt is identified within the Sale Area, this contract may be modified. The following modifications could occur: time of cutting, species to cut, volume to harvest, or various others dealing with the treatment of oak wilt. If a species is not specified in this contract, it shall be paid for at the average price received for that species and product.

7.5 - Loss

7.5.1 - Deteriorating Timber (7/09)

The Sale Area has received damage from emerald ash borer. The Purchaser should harvest the wood as soon as possible. The Department of Natural Resources is held free of responsibility of any further damage or deterioration due to delay in harvesting.



TIMBER SALE MAP

This information provided by authority of Part 525, 1994 PA 451, as amended.

Sale Number

33-026-25

Date

06/23/2025

Forest Management Unit

Escanaba Mgt Unit

County

Menominee

Mapped By: Beaudou

Cruised By: Salter, Beaudou

Scale

1:15,840

Page

1

Of

1

Township
36N / 37N

Range
28W

Section(s) and

Subdivision(s) Sec. 1 NWNW; Sec. 35 E1/2SE; Sec. 36 NWSW,S1/2SW;

Cover Type

A = Aspen	J = Jack Pine	O = Oak	U = Upland Brush
B = Paper Birch	K = Rock	P = Lowland Poplar	UM = Upland Mix Forest
C = Cedar	L = Lowland Brush	Q = Mixed Swamp Conifer	V = Bog or Marsh
D = Treed Bog	LM = Lowland Mix Forest	R = Red Pine	W = White Pine
E = Swamp Hardwoods	M = Maple, Beech, Birch	S = Black Spruce	X = Non Stocked
F = Spruce/Fir	MC = Mixed Conifer	T = Tamarack	Y = Sand
G = Grass	MD = Mixed Deciduous	Z = Water	
H = Hemlock	N = Marsh		

Density

0 = Non Stocked	5 = Pole Timber Medium
1 = Seedling Sapling Poor	6 = Pole Timber Well
2 = Seedling Sapling Medium	7 = Saw Timber Poor
3 = Seedling Sapling Well	8 = Saw Timber Medium
4 = Pole Timber Poor	9 = Saw Timber Well

Payment Unit Number	Acres	Payment Unit Number	Acres
1	13.6	5	19.2
2	10.8	6	18.6
3	16.7	7	20.3
4	15	8	25.9

**Drone
Catcher**
140.1 Acres
Compartment 11



Use QR Code to
open Map in App

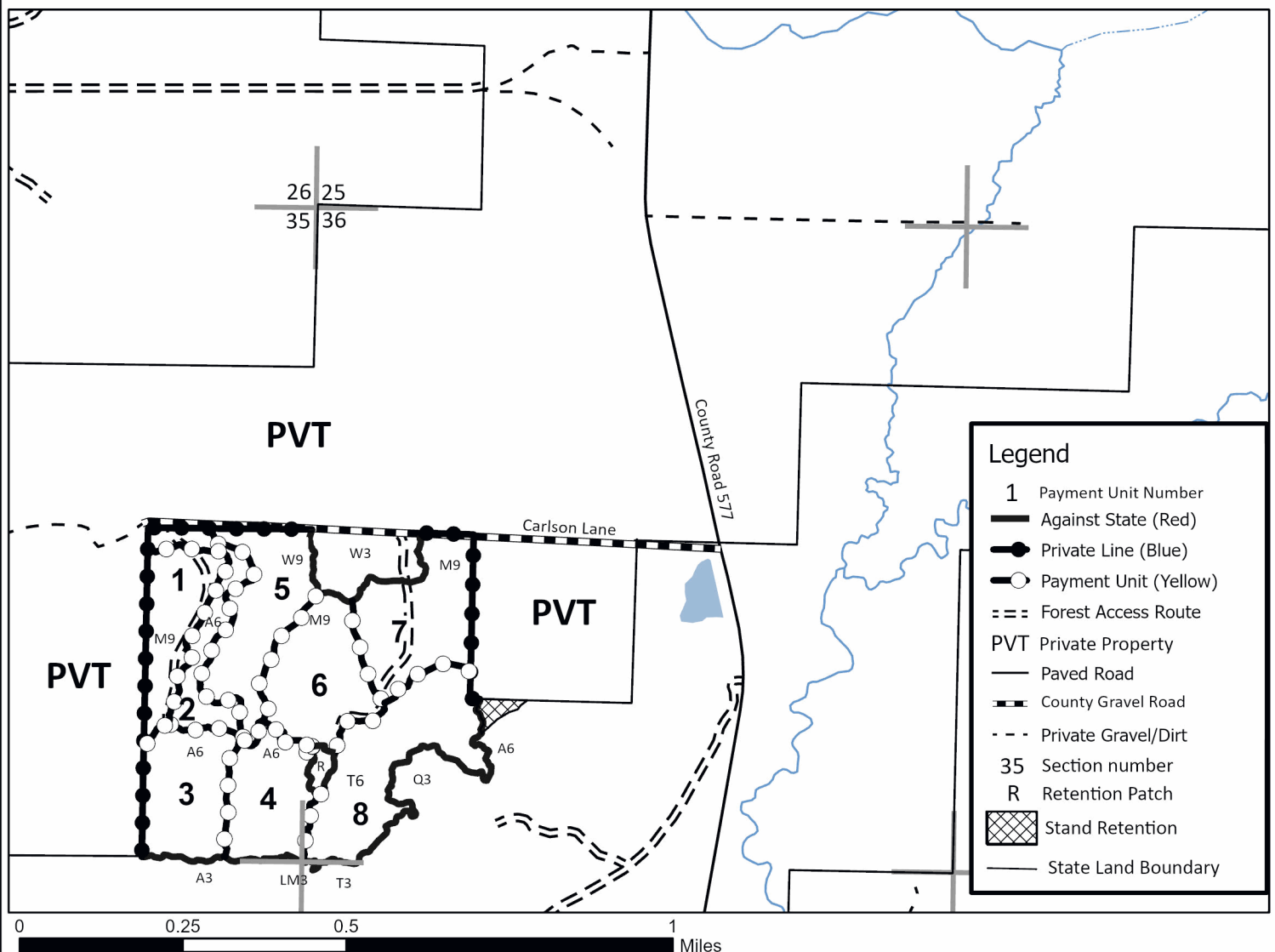

TIMBER SALE INFORMATION

Miscauna Hardwood (33-032-25)

T36N, R28W, SEC. 2; T36N, R28W, SEC. 3; T37N, R28W, SEC. 34; T37N, R28W, SEC. 35.
Menominee County (Advertised Price \$20,268.95)

SALE NOTE: Oak Wilt is present within the sale, so no cutting is permitted from April 15th to July 15th. All Payment Units are upland and can be harvested any time outside the restricted dates.

A timber sale contract for this lump sum, sealed bid timber sale will be awarded to the responsible bidder offering the highest sealed bid price. All units of volume listed below were estimated using the Inventory Manager computer program and the new Michigan taper model. Bids must be at or above the following advertised price for each product and species:

<u>PRODUCTS & SPECIES</u>	<u>ESTIMATED UNITS*</u>	<u>ADVERTISED PRICE</u>
Sawtimber		
Red Maple	6.6 MBF	\$ 103.00 / MBF
Red Oak	68.2 MBF	\$ 155.00 / MBF
Sugar Maple	4.6 MBF	\$ 212.00 / MBF
Pulpwood		
Balsam Fir	7 Cords	\$ 8.70 / Cord
Mixed Hardwood	323 Cords	\$ 16.50 / Cord
Red Oak	135 Cords	\$ 15.85 / Cord
White Pine	25 Cords	\$ 18.60 / Cord
White Spruce	4 Cords	\$ 11.95 / Cord

* The total volume is statistically estimated within plus (+) or minus (-) 20.23 percent. There are an estimated 679 cords on this timber sale, plus or minus 137 cords at the 95% confidence level. The estimated units are final and not subject to adjustment. Prospective bidders are urged to examine this timber and to make their own estimates of quantity and quality.

BOND AND PAYMENT SCHEDULE:

- A bond in the amount of \$1,013.00 to insure faithful performance of the conditions of the contract will be deposited by the successful bidder within 21 days of the sale award.
- Cutting in any sale or unit without the required advance payment would be considered a trespass.
- Total payment must be paid in advance or according to the following schedule :
 - Ten percent (10%) of the sale value must be paid within 21 days of the sale award.
 - The 10% down payment will be credited towards the first unit cut.
 - Payment for each of the following units must be made before cutting begins in that unit:

PAYMENT UNIT NUMBER	PERCENT OF TOTAL SALE VALUE
01	13.7%
02	12.3%
03	15.3%
04	11.7%
05	8.8%
06	16.5%
07	21.7%
- If no cutting takes place, the 10% down payment will not be refunded.
- Operations on the contract issued will terminate on 09/30/2028.

SALE STATISTICS

Volumes were calculated in cubic feet using the Michigan taper model. Cubic foot volume includes all wood inside bark for the product indicated. For display purposes, cubic feet were converted to cords and MBF using a simple conversion factor, e.g. 79 cubic feet per cord and 185 cubic feet per MBF. The cubic foot volumes are precise; the cords and MBF volumes are not. Cubic foot volume cannot be directly converted to cords or boards with precision.

SALE VOLUMES

The total estimated sale volume may not equal the sum of the species/products due to the nature of statistical calculations associated with double sampling methodology.

VOLUME			STATISTICAL RANGE IN CORDS	
TOTAL CUBIC FEET	TOTAL CORDS	PERCENT ERROR	MINIMUM	MAXIMUM
53,654	679	20.23%	542	817

VDU VOLUMES

A VDU is a Volume Determination Unit. Volumes and their associated statistics are calculated at the VDU level and summarized to the sale level. There is often a one to one relationship between a VDU and a Payment Unit, but not always, depending on the cruise design. Refer to the VDU TO PAYMENT UNIT table.

	VOLUME			RANGE IN CORDS	
VDU	TOTAL CUBIC FEET	TOTAL CORDS	PERCENT ERROR	MINIMUM	MAXIMUM
30	53,654	679	20.23%	542	817
TOTAL:	53,654	679		542	817

VDU TO PAYMENT UNIT

When a VDU is associated with more than one Payment Unit (PU), the VDU volumes are assigned to the PU based on acres of the VDU within the PU.

VDU	VDU ACRES	PU	PU ACRES
TOTAL:			

DESCRIPTION OF TIMBER BY PAYMENT UNIT (PU)

PU	MARKET GROUP	PRODUCT	QUANTITY	UNIT	ACRES	ADVERTISE PRICE
1	Red Maple	Sawtimber	0.9	MBF	16.9	\$2,780.50
	Red Oak		9.4	MBF		
	Sugar Maple		0.6	MBF		
	Balsam Fir	Pulpwood	1	Cords		
	Mixed Hardwood		44	Cords		
	<i>Ironwood</i>		2	<i>Cords</i>		
	<i>Red Maple</i>		27	<i>Cords</i>		
	<i>Sugar Maple</i>		14	<i>Cords</i>		
	<i>White Ash</i>		1	<i>Cords</i>		
	Red Oak		19	Cords		
	White Pine		3	Cords		
	White Spruce		1	Cords		
2	Red Maple	Sawtimber	0.8	MBF	15.0	\$2,489.05
	Red Oak		8.4	MBF		
	Sugar Maple		0.6	MBF		
	Balsam Fir	Pulpwood	1	Cords		
	Mixed Hardwood		39	Cords		
	<i>Ironwood</i>		2	<i>Cords</i>		
	<i>Red Maple</i>		24	<i>Cords</i>		
	<i>Sugar Maple</i>		13	<i>Cords</i>		
	Red Oak		17	Cords		
	White Pine		3	Cords		
3	Red Maple	Sawtimber	1.0	MBF	18.6	\$3,099.80
	Red Oak		10.4	MBF		
	Sugar Maple		0.7	MBF		
	Balsam Fir	Pulpwood	1	Cords		
	Mixed Hardwood		49	Cords		
	<i>Ironwood</i>		3	<i>Cords</i>		
	<i>Red Maple</i>		29	<i>Cords</i>		
	<i>Sugar Maple</i>		16	<i>Cords</i>		
	<i>White Ash</i>		1	<i>Cords</i>		
	Red Oak		21	Cords		
	White Pine		4	Cords		
	White Spruce		1	Cords		
4	Red Maple	Sawtimber	0.8	MBF	14.5	\$2,372.50
	Red Oak		8.1	MBF		
	Sugar Maple		0.5	MBF		
	Balsam Fir	Pulpwood	1	Cords		
	Mixed Hardwood		37	Cords		
	<i>Ironwood</i>		2	<i>Cords</i>		
	<i>Red Maple</i>		23	<i>Cords</i>		
	<i>Sugar Maple</i>		12	<i>Cords</i>		
	Red Oak		16	Cords		
	White Pine		3	Cords		
5	Red Maple	Sawtimber	0.6	MBF	11.0	\$1,790.20
	Red Oak		6.1	MBF		
	Sugar Maple		0.4	MBF		
	Balsam Fir	Pulpwood	1	Cords		
	Mixed Hardwood		28	Cords		
	<i>Ironwood</i>		2	<i>Cords</i>		
	<i>Red Maple</i>		17	<i>Cords</i>		
	<i>Sugar Maple</i>		9	<i>Cords</i>		
	Red Oak		12	Cords		
	White Pine		2	Cords		
6	Red Maple	Sawtimber	1.1	MBF	20.1	\$3,337.15
	Red Oak		11.2	MBF		

DESCRIPTION OF TIMBER BY PAYMENT UNIT (PU), CON'T

PU	MARKET GROUP	PRODUCT	QUANTITY	UNIT	ACRES	ADVERTISE PRICE
6 con't	Sugar Maple	Sawtimber	0.8	MBF		
	Balsam Fir	Pulpwood	1	Cords		
	Mixed Hardwood		53	Cords		
	Ironwood		3	Cords		
	Red Maple		32	Cords		
	Sugar Maple		17	Cords		
	White Ash		1	Cords		
	Red Oak		22	Cords		
	White Pine		4	Cords		
	White Spruce		1	Cords		
7	Red Maple	Sawtimber	1.4	MBF	26.3	\$4,399.75
	Red Oak		14.6	MBF		
	Sugar Maple		1.0	MBF		
	Balsam Fir	Pulpwood	1	Cords		
	Mixed Hardwood		73	Cords		
	Basswood		3	Cords		
	Beech		3	Cords		
	Ironwood		4	Cords		
	Red Maple		40	Cords		
	Sugar Maple		22	Cords		
	White Ash		1	Cords		
	Red Oak		28	Cords		
	White Pine		6	Cords		
	White Spruce		1	Cords		
	TOTAL:			79.4		
TOTAL:			494	Cords		

Sale Specific Conditions & Requirements

Sale Name: Miscauna Hardwood

Sale Number: 33-032-25 Seq#: 1

1 - Sale Area

1.2 - Boundaries

1.2.1 - Painted Boundaries (9/19)

The sale boundary and Payment Unit boundaries are marked and identified by blue, red and yellow paint. Exterior sale boundary lines against private property are marked with blue paint. Exterior sale boundary lines against state are marked with red paint. Interior Payment Unit boundaries are marked with yellow paint. Retention patches are marked with red paint; no harvesting activities may occur within these areas. The painted boundary line trees are not Included Timber and are to be protected unless marked with orange paint. Yellow painted trees designating an interior Payment Unit boundary are only to be cut when all surrounding Payment Units have been paid for.

2 - Timber Specifications

2.1 - Included Timber

2.1.3 - Cut Tree Marked Unit(s) (12/08)

Within Payment Unit(s) 1 - 7, all trees are designated for cutting when marked with orange paint above and below stump height, regardless of merchantability.

In addition, cut all aspen, balsam, ironwood, and spruce/fir greater than three (3) inches at DBH.

2.2 - Utilization

2.2.4 - Skidding Length (12/24)

Skidding of unlimbed tops or lengths over 17 feet is not permissible within the sale area.

3 - Payments

3.3 - Pre-measured Sales

3.3.4 - Dividing Payment Units (7/14)

Payment Unit(s) \$18,000 in value or greater may be divided at the request of the Purchaser and upon approval of the Unit Manager. Dividing Payment Units is a contract modification which requires a Timber Sale Contract Amendment. There will be only one division per Payment Unit.

4 - Transportation

4.2 - Maintenance

4.2.1 - Hauling Restriction (12/08)

Hauling may be restricted on forest roads by the Unit Manager or his/her representative. The restriction may occur during spring breakup or during other wet weather conditions.

4.2.4 - Grading (10/16)

For completion of the sale, state forest roads must be graded. In general, this will require a road grader or bulldozer to shape up the roads after forest products have been hauled off site. This includes cleaning of drainage areas, grading, crowning and filling with gravel, if necessary. The grading equipment to be used must be approved by the Unit Manager or his/her representative.

5 - Operations

5.2 - Conduct of Operations

5.2.3 - Operating Restrictions

5.2.3.3 - Bark Slippage Restriction (3/09)

Within Payment Unit(s) 1 - 7, cutting and skidding are not permitted during the period of April 15 to July 30. This

restriction is because of bark slippage and to reduce the spread of oak wilt.

5.2.3.4 - Oak Wilt Restriction, No Exceptions (1/18)

Within Payment Unit(s) 1-7, cutting, skidding, hauling within the sale and brushing of access roads to the sale are not permitted during the period of April 15 to July 15. No exceptions will be granted. This is necessary to reduce the spread of oak wilt.

6 - Safety and Fire Prevention

6.2 - Signing

6.2.1 - Road Posting (10/20)

The Purchaser is responsible for posting and maintaining caution signs on the Miscauna Creek Road prior to beginning operations. The road must be posted at appropriate distances from the Sale Area to warn of logging activity and truck traffic. Signs must be removed when harvest operations are suspended or completed. The Purchaser will provide these signs.

7 - Other Conditions

7.5 - Loss

7.5.1 - Deteriorating Timber (7/09)

The Sale Area has received damage from oak wilt. The Purchaser should harvest the wood as soon as possible. The Department of Natural Resources is held free of responsibility of any further damage or deterioration due to delay in harvesting.



TIMBER SALE MAP

This information provided by authority of Part 525, 1994 PA 451, as amended.

Sale Number

33-032-25

Date

09/19/2025

Forest Management Unit

Escanaba Mgt Unit

County

Menominee

Mapped By: Beaudou

Cruised By: Salter, Beaudou

Scale

1:14,000

Page

1

Of

1

Township
36N / 37N

Range
28W

Section(s) and

Subdivision(s) Sec. 2 NWNW; Sec. 3 N1/2NE; Sec. 34 NESE,S1/2SE; Sec. 35 SW;

Cover Type

A = Aspen	J = Jack Pine	O = Oak	U = Upland Brush
B = Paper Birch	K = Rock	P = Lowland Poplar	UM = Upland Mix Forest
C = Cedar	L = Lowland Brush	Q = Mixed Swamp Conifer	V = Bog or Marsh
D = Treed Bog	LM = Lowland Mix Forest	R = Red Pine	W = White Pine
E = Swamp Hardwoods	M = Maple, Beech, Birch	S = Black Spruce	X = Non Stocked
F = Spruce/Fir	MC = Mixed Conifer	T = Tamarack	Y = Sand
G = Grass	MD = Mixed Deciduous	Z = Water	
H = Hemlock	N = Marsh		

Density

0 = Non Stocked	5 = Pole Timber Medium
1 = Seedling Sapling Poor	6 = Pole Timber Well
2 = Seedling Sapling Medium	7 = Saw Timber Poor
3 = Seedling Sapling Well	8 = Saw Timber Medium
4 = Pole Timber Poor	9 = Saw Timber Well

Payment Unit Number	Acres	Payment Unit Number	Acres
1	16.9	5	11
2	15	6	20.1
3	18.6	7	26.3
4	14.5		

**Miscauna
Hardwood**

**Compartment 11
122.4 Acres**

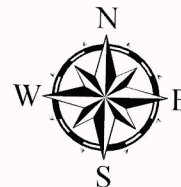

QR Code to
open Map
and Cruise Data

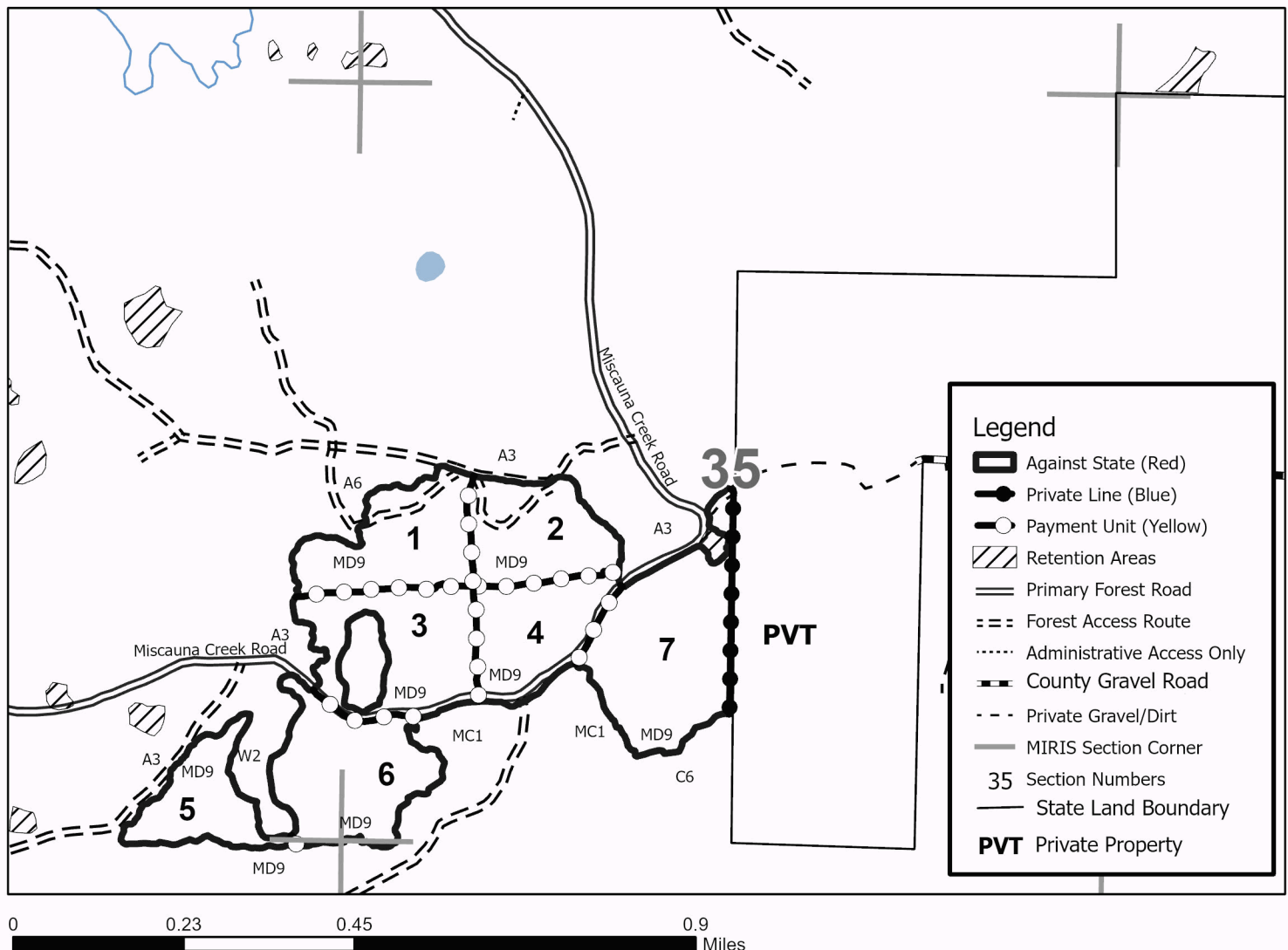

South Pond Shores (12-009-25)

T41N, R29W, SEC. 17; T41N, R29W, SEC. 18; T41N, R29W, SEC. 5; T41N, R29W,

In response to the notice of sale to be held 3:00 p.m. (local time) on January 7, 2026, I am hereby submitting my sealed bid (firm offer) for the following forest products to be cut. Bids for individual species must be at or above the advertised price. All non-responsive bid forms may be rejected.

<u>PRODUCTS & SPECIES</u>	<u>ESTIMATED VOLUME*</u>	<u>ADVERTISED PRICE</u>	<u>BID PRICE/UNIT</u>
Sawtimber			
Paper Birch	3.1 MBF	\$ 83.00/MBF	\$ _____
Red Maple	4.6 MBF	\$ 177.00/MBF	\$ _____
Red Pine	12.2 MBF	\$ 109.00/MBF	\$ _____
Sugar Maple	5.0 MBF	\$ 311.00/MBF	\$ _____
White Pine	14.7 MBF	\$ 55.00/MBF	\$ _____
Pulpwood			
Balsam Fir	22 Cords	\$ 5.25/Cord	\$ _____
Balsam Poplar	5 Cords	\$ 18.70/Cord	\$ _____
Mixed Aspen	914 Cords	\$ 18.70/Cord	\$ _____
Mixed Hardwood	386 Cords	\$ 12.95/Cord	\$ _____
Red Pine	22 Cords	\$ 75.05/Cord	\$ _____
White Pine	31 Cords	\$ 14.65/Cord	\$ _____
White Spruce	30 Cords	\$ 11.15/Cord	\$ _____

*The volumes are statistically estimated within plus (+) or minus (-) 21.61 percent at 95% confidence level. These estimated volumes are final and not subject to adjustment. Prospective bidders are urged to examine this timber and to make their own estimates of quantity and quality.

I understand that any or all bids may be rejected. All bids must be signed and all bid items must be bid or the bid form may be rejected. I also understand that consideration and awarding a contract will be based upon my past performance and ability to complete the contract based upon equipment and staffing subject to my control.

FEDERAL ID: ____ - ____ - ____ or SOCIAL SECURITY NUMBER: ____ - ____ - ____

Company or individual bidding: _____

Company representative's name: _____

Address: _____

City: _____ State: _____ Zip: _____

IF AVAILABLE, PLEASE PLACE THE PERSONALIZED LABEL FROM YOUR PROSPECTUS IN THE ABOVE BOX.

Individual or company representative's signature: _____ Date: _____

Phone number : _____ Email (optional): _____

THE WINNING BIDDER MUST COMPLETE THE VERIFICATION OF WORKER'S DISABILITY COMPENSATION ACT COMPLIANCE (ON REVERSE SIDE IF DOUBLE SIDED) WITHIN 21 DAYS OF SALE AWARD DATE



TIMBER SALE VERIFICATION OF WORKER'S DISABILITY COMPENSATION ACT COMPLIANCE

As required by Act 317, P.A. 1969 (Worker's Compensation) and
Part 5 of Act 451 of 1994, as amended.

FOR DEPARTMENT USE ONLY

Sale Number (XX - XXX - XX - XX)

Forest Management Unit:

VERIFICATION OF WORKER'S DISABILITY COMPENSATION ACT COMPLIANCE

- This verification must be completed and submitted within 21 days of contract award and prior to the issuance of the timber sale contract.
- In addition, if boxes 2B or 2C are checked, then Notice of Exclusion or Certificate of Insurance must be submitted within twenty-one (21) days of the contract award and prior to the issuance of the timber sale contract.
- All information must be typed or printed except for written signatures.

Please Check Appropriate Categories:

1. My business is organized as (you **must** check one of the boxes below):
 - A. ☐ Sole Proprietorship (individual)
 - B. ☐ Partnership
 - C. ☐ Corporation
2. You **must** check one of the boxes below:
 - A. ☐ I certify my business is a sole proprietorship and it has no employees but the sole proprietor. I am not subject to the Worker's Compensation Laws.
 - B. ☐ I certify my business has satisfied its obligation to the Worker's Compensation Act through the use of an approved Notice of Exclusion (BWC-337, Rev. 5/96). I will provide a copy of the Notice of Exclusion within 21 days of the contract award. (For questions or a copy of the BWC-337, please call the Worker's Compensation Bureau at 517-322-1195).
 - C. ☐ I certify my business has a Worker's Compensation Policy. I will provide an original Certificate of Insurance within twenty-one (21) days of the contract award.
3. If you have checked item 2(A) or 2(B), you **must** indicate the number of **both** full-time and part-time employees, other than yourself, including family members and active partners (if none, you must enter "0").

_____ Full-time Employees

_____ Part-time Employees

Name of Business		Federal ID (or) Social Security No.
Address		Telephone ()
City	State	ZIP

I hereby certify that the above information is true and correct. I agree to notify the Michigan DNR of any changes that occur in factors affecting my coverage during any of my present and future operations.

Signature of Owner or Authorized Representative

Title

Date

Please complete the "SEALED BID" information on the next page

Drone Catcher (33-026-25)

T36N, R28W, SEC. 1; T37N, R28W, SEC. 35; T37N, R28W, SEC. 36; Menominee

In response to the notice of sale to be held 3:00 p.m. (local time) on January 7, 2026, I am hereby submitting my sealed bid (firm offer) for the following forest products to be cut. Bids for individual species must be at or above the advertised price. All non-responsive bid forms may be rejected.

<u>PRODUCTS & SPECIES</u>	<u>ESTIMATED VOLUME*</u>	<u>ADVERTISED PRICE</u>	<u>BID PRICE/UNIT</u>
Sawtimber			
Basswood	39.8 MBF	\$ 51.00/MBF	\$ _____
Paper Birch	0.8 MBF	\$ 68.00/MBF	\$ _____
Red Maple	8.1 MBF	\$ 103.00/MBF	\$ _____
Red Oak	54.7 MBF	\$ 155.00/MBF	\$ _____
Sugar Maple	15.1 MBF	\$ 212.00/MBF	\$ _____
Pulpwood			
Balsam Fir	140 Cords	\$ 8.70/Cord	\$ _____
Mixed Aspen	502 Cords	\$ 24.95/Cord	\$ _____
Mixed Hardwood	598 Cords	\$ 16.50/Cord	\$ _____
Mixed Spruce	47 Cords	\$ 11.95/Cord	\$ _____
N. White Cedar	19 Cords	\$ 6.95/Cord	\$ _____
Red Oak	82 Cords	\$ 15.85/Cord	\$ _____
Red Pine	79 Cords	\$ 54.15/Cord	\$ _____
Tamarack	56 Cords	\$ 10.10/Cord	\$ _____
White Pine	313 Cords	\$ 18.60/Cord	\$ _____

*The volumes are statistically estimated within plus (+) or minus (-) 11.67 percent at 95% confidence level. These estimated volumes are final and not subject to adjustment. Prospective bidders are urged to examine this timber and to make their own estimates of quantity and quality.

I understand that any or all bids may be rejected. All bids must be signed and all bid items must be bid or the bid form may be rejected. I also understand that consideration and awarding a contract will be based upon my past performance and ability to complete the contract based upon equipment and staffing subject to my control .

FEDERAL ID: ____ - ____ - ____ or SOCIAL SECURITY NUMBER: ____ - ____ - ____

Company or individual bidding: _____

Company representative's name: _____

Address: _____

City: _____ State: _____ Zip: _____

IF AVAILABLE, PLEASE PLACE THE PERSONALIZED LABEL FROM YOUR PROSPECTUS IN THE ABOVE BOX.

Individual or company representative's signature: _____ Date: _____

Phone number : _____ Email (optional): _____

**THE WINNING BIDDER MUST COMPLETE THE VERIFICATION OF WORKER'S DISABILITY COMPENSATION ACT
COMPLIANCE (ON REVERSE SIDE IF DOUBLE SIDED) WITHIN 21 DAYS OF SALE AWARD DATE**



TIMBER SALE VERIFICATION OF WORKER'S DISABILITY COMPENSATION ACT COMPLIANCE

As required by Act 317, P.A. 1969 (Worker's Compensation) and
Part 5 of Act 451 of 1994, as amended.

FOR DEPARTMENT USE ONLY

Sale Number (XX - XXX - XX - XX)

Forest Management Unit:

VERIFICATION OF WORKER'S DISABILITY COMPENSATION ACT COMPLIANCE

- This verification must be completed and submitted within 21 days of contract award and prior to the issuance of the timber sale contract.
- In addition, if boxes 2B or 2C are checked, then Notice of Exclusion or Certificate of Insurance must be submitted within twenty-one (21) days of the contract award and prior to the issuance of the timber sale contract.
- All Information must be typed or printed except for written signatures.

Please Check Appropriate Categories:

1. My business is organized as (you **must** check one of the boxes below):
 - A. ☐ Sole Proprietorship (individual)
 - B. ☐ Partnership
 - C. ☐ Corporation
2. You **must** check one of the boxes below:
 - A. ☐ I certify my business is a sole proprietorship and it has no employees but the sole proprietor. I am not subject to the Worker's Compensation Laws.
 - B. ☐ I certify my business has satisfied its obligation to the Worker's Compensation Act through the use of an approved Notice of Exclusion (BWC-337, Rev. 5/96). I will provide a copy of the Notice of Exclusion within 21 days of the contract award. (For questions or a copy of the BWC-337, please call the Worker's Compensation Bureau at 517-322-1195).
 - C. ☐ I certify my business has a Worker's Compensation Policy. I will provide an original Certificate of Insurance within twenty-one (21) days of the contract award.
3. If you have checked item 2(A) or 2(B), you **must** indicate the number of **both** full-time and part-time employees, other than yourself, including family members and active partners (if none, you must enter "0").

_____ Full-time Employees

_____ Part-time Employees

Name of Business		Federal ID (or) Social Security No.
Address		Telephone ()
City	State	ZIP

I hereby certify that the above information is true and correct. I agree to notify the Michigan DNR of any changes that occur in factors affecting my coverage during any of my present and future operations.

Signature of Owner or Authorized Representative

Title

Date

Please complete the "SEALED BID" information on the next page

Miscauna Hardwood (33-032-25)

T36N, R28W, SEC. 2; T36N, R28W, SEC. 3; T37N, R28W, SEC. 34; T37N, R28W,

In response to the notice of sale to be held 3:00 p.m. (local time) on January 7, 2026, I am hereby submitting my sealed bid (firm offer) for the following forest products to be cut. Bids for individual species must be at or above the advertised price. All non-responsive bid forms may be rejected.

<u>PRODUCTS & SPECIES</u>	<u>ESTIMATED VOLUME*</u>	<u>ADVERTISED PRICE</u>	<u>BID PRICE/UNIT</u>
Sawtimber			
Red Maple	6.6 MBF	\$ 103.00/MBF	\$ _____
Red Oak	68.2 MBF	\$ 155.00/MBF	\$ _____
Sugar Maple	4.6 MBF	\$ 212.00/MBF	\$ _____
Pulpwood			
Balsam Fir	7 Cords	\$ 8.70/Cord	\$ _____
Mixed Hardwood	323 Cords	\$ 16.50/Cord	\$ _____
Red Oak	135 Cords	\$ 15.85/Cord	\$ _____
White Pine	25 Cords	\$ 18.60/Cord	\$ _____
White Spruce	4 Cords	\$ 11.95/Cord	\$ _____

*The volumes are statistically estimated within plus (+) or minus (-) 20.23 percent at 95% confidence level. These estimated volumes are final and not subject to adjustment. Prospective bidders are urged to examine this timber and to make their own estimates of quantity and quality.

I understand that any or all bids may be rejected. All bids must be signed and all bid items must be bid or the bid form may be rejected. I also understand that consideration and awarding a contract will be based upon my past performance and ability to complete the contract based upon equipment and staffing subject to my control .

FEDERAL ID: ____ - ____ - ____ or SOCIAL SECURITY NUMBER: ____ - ____ - ____

Company or individual bidding: _____

Company representative's name: _____

Address: _____

City: _____ State: _____ Zip: _____

IF AVAILABLE, PLEASE PLACE THE PERSONALIZED LABEL FROM YOUR PROSPECTUS IN THE ABOVE BOX.

Individual or company representative's signature: _____ Date: _____

Phone number : _____ Email (optional): _____

**THE WINNING BIDDER MUST COMPLETE THE VERIFICATION OF WORKER'S DISABILITY COMPENSATION ACT
COMPLIANCE (ON REVERSE SIDE IF DOUBLE SIDED) WITHIN 21 DAYS OF SALE AWARD DATE**



TIMBER SALE VERIFICATION OF WORKER'S DISABILITY COMPENSATION ACT COMPLIANCE

As required by Act 317, P.A. 1969 (Worker's Compensation) and
Part 5 of Act 451 of 1994, as amended.

FOR DEPARTMENT USE ONLY

Sale Number (XX - XXX - XX - XX)

Forest Management Unit:

VERIFICATION OF WORKER'S DISABILITY COMPENSATION ACT COMPLIANCE

- This verification must be completed and submitted within 21 days of contract award and prior to the issuance of the timber sale contract.
- In addition, if boxes 2B or 2C are checked, then Notice of Exclusion or Certificate of Insurance must be submitted within twenty-one (21) days of the contract award and prior to the issuance of the timber sale contract.
- All Information must be typed or printed except for written signatures.

Please Check Appropriate Categories:

1. My business is organized as (you **must** check one of the boxes below):
 - A. ☐ Sole Proprietorship (individual)
 - B. ☐ Partnership
 - C. ☐ Corporation
2. You **must** check one of the boxes below:
 - A. ☐ I certify my business is a sole proprietorship and it has no employees but the sole proprietor. I am not subject to the Worker's Compensation Laws.
 - B. ☐ I certify my business has satisfied its obligation to the Worker's Compensation Act through the use of an approved Notice of Exclusion (BWC-337, Rev. 5/96). I will provide a copy of the Notice of Exclusion within 21 days of the contract award. (For questions or a copy of the BWC-337, please call the Worker's Compensation Bureau at 517-322-1195).
 - C. ☐ I certify my business has a Worker's Compensation Policy. I will provide an original Certificate of Insurance within twenty-one (21) days of the contract award.
3. If you have checked item 2(A) or 2(B), you **must** indicate the number of **both** full-time and part-time employees, other than yourself, including family members and active partners (if none, you must enter "0").

_____ Full-time Employees

_____ Part-time Employees

Name of Business		Federal ID (or) Social Security No.
Address		Telephone ()
City	State	ZIP

I hereby certify that the above information is true and correct. I agree to notify the Michigan DNR of any changes that occur in factors affecting my coverage during any of my present and future operations.

Signature of Owner or Authorized Representative

Title

Date

Please complete the "SEALED BID" information on the next page