

Township 1° 23' N., Range N° 14 West Mer. (Mich.)

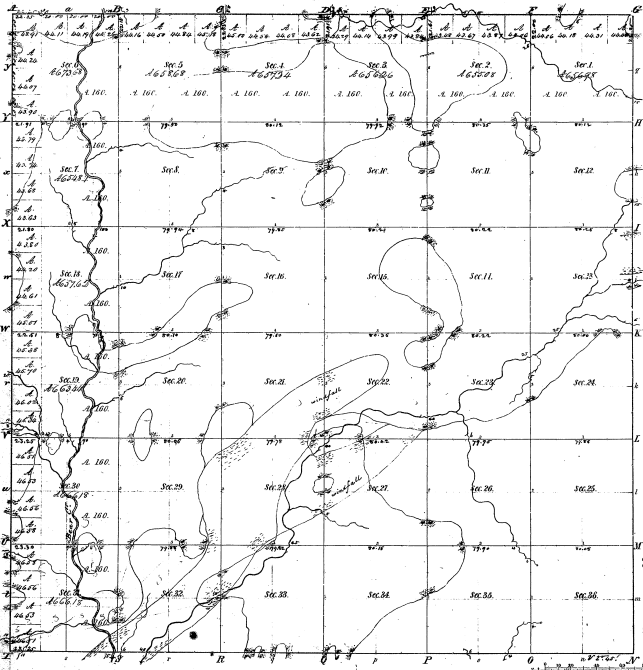

Boundaries of  
 Town 1° 23' N. Range 14 West Mer. (Mich.)

17-26

17-26

Total number of Acres 23,266.92

Survey designated	By whom surveyed	Date of Contain	Amount of survey	When surveyed	How surveyed
Township lines	John F. Nichols	Nov. 6th 1836	36 Secs. 36	4 <sup>th</sup> of 1837	2 <sup>d</sup> of 1838
Subdivisions	John F. Nichols	Nov. 22 <sup>d</sup> 1837	62 Secs. 37	4 <sup>th</sup> of 1837	4 <sup>th</sup> of 1837

The above copy of Township 1° 23' North of Range 14 West of this Principal Meridian Mich. was by me duly compared to the field notes of the survey thereon on file in this Office which have been examined and approved.

Surveyor General of the State of Michigan  
 Gustavus Franklin Smith

*G. F. Smith*