

Township N.º 47 N. Range N.º 32 W. Mer. Mich.

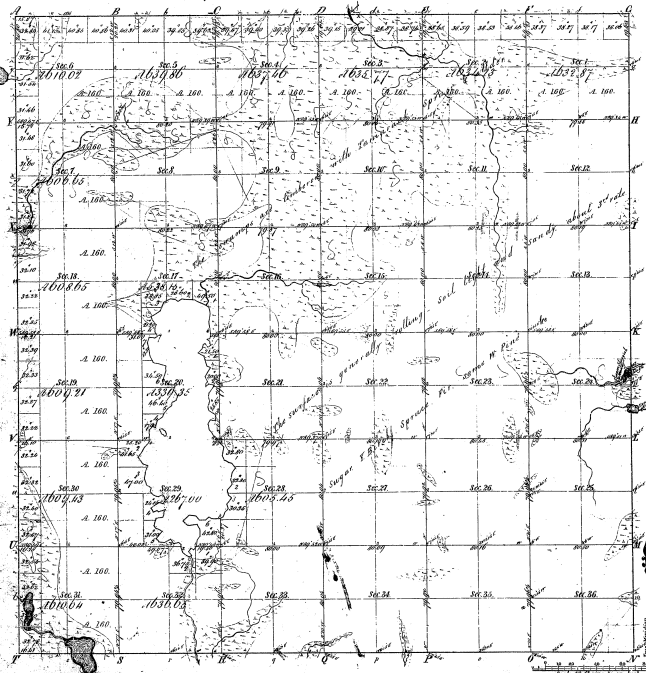

Number of
Pole Courses 18117, 18118, 18119, 18120, 18121, 18122, 18123, 18124, 18125, 18126, 18127, 18128, 18129, 18130, 18131, 18132, 18133, 18134, 18135, 18136, 18137, 18138, 18139, 18140, 18141, 18142, 18143, 18144, 18145, 18146, 18147, 18148, 18149, 18150, 18151, 18152, 18153, 18154, 18155, 18156, 18157, 18158, 18159, 18160, 18161, 18162, 18163, 18164, 18165, 18166, 18167, 18168, 18169, 18170, 18171, 18172, 18173, 18174, 18175, 18176, 18177, 18178, 18179, 18180, 18181, 18182, 18183, 18184, 18185, 18186, 18187, 18188, 18189, 18190, 18191, 18192, 18193, 18194, 18195, 18196, 18197, 18198, 18199, 18200

Total Number
Poles between opposite

45-16

Total number of Acres 22021.39

Survey designated	By whom surveyed	Date of Contract	Amount of Survey	When Surveyed	When first sold, and at what price per acre
Township lines	M. A. & C. W. White, and Capt. A. 1816	21. 22. 23.	21. 22. 23.	1816	1816
Subdivisions	Wm. W. White, and J. W. 1822	15. 17. 21.	15. 17. 21.	1822	1822

The above Report Township N.º 47 N. of Range N.º 32 W. of the Meridian, Michigan, is hereby returned to the field notes of the survey thereof on file in this Office, which have been examined and approved.

Surveyor General's Office
Lansing, Mich. Dec. 22, 1862

Charles H. H. H.
Supt. Genl.