

Re Survey
Township N^o 18 N. Range N^o 5 W. Mer. Mich

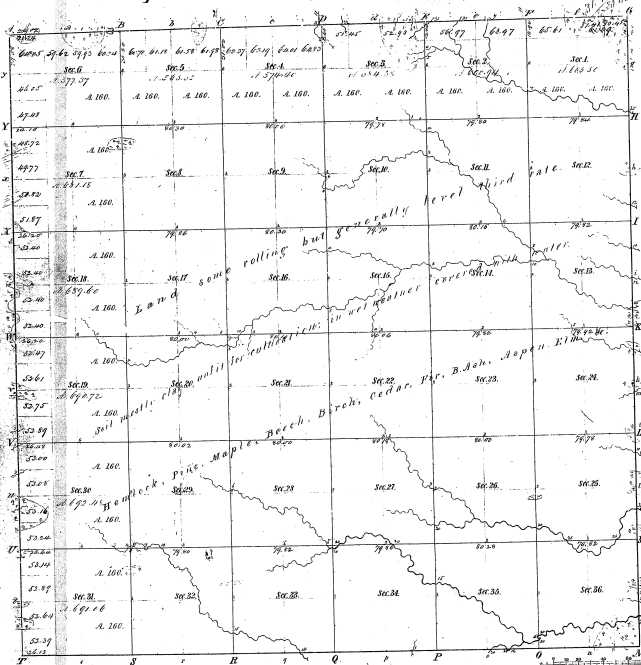

Monitors of
 Public Courses *WCLL* Public Courses *WCLL* Public Courses *WCLL*

23-10
 23-10

Total number of acres: 22063.15

Survey designated	By whom surveyed	Date of contract	Amount of Survey	When Surveyed	Mon't for Sec and 1/4 of the Sec
N ^o 271 Township Base	Levi's children	July 16 th 1837	36 7/8	1837	\$27.125
Subdivision	John Walker	July 16 th 1838	29 25 8/10	1838	\$22.141
N ^o 30 Boundary	W. B. Bond	June 17 th 1858	6 0 18	1858	\$4.511

The above map of Township N^o 18 N. Sec. of Range N^o 5 West of the Principal Meridian Michigan is a truly correct and in the field notes of the survey thereon on file in this office, which you have examined and approved.
 Surveyor General's Office
 Lucius Lyon
 Detroit, August 16th 1868

Register's Certificate