

Township 1° 33' N. Range 1° 1' W. Mer. Mich.

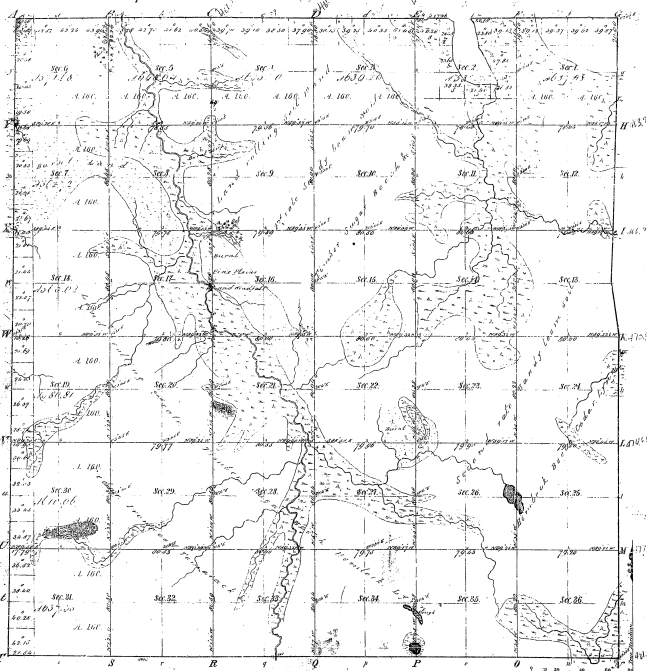

Abstracts of
 Public Courses 1841, Public Courses 1864, Public Courses 1868

18-20		
-------	--	--

18-20

Total number of Acres 716,22.51

Survey designated	By Whom Surveyed	Date of Conduct	Amount of Survey	When Surveyed	When Made and at the Service of
Section C	John W. Woodman	June 15 1855	11 567.124	1855	1855
Section D	John W. Woodman	June 15 1855	11 567.124	1855	1855
Section E	John W. Woodman	June 15 1855	11 567.124	1855	1855

The above Map of Township 1° 33' North, of Range 1° 1' West of the Principal Meridian Michigan is a strictly conformable to the field notes of the survey thereof on file in this Office, which have been examined and approved.

Deputy General Office
 Detroit Mich. Jan. 20 1856
 Charles A. Allen Secy Genl