

Township 45 N. Range 5 W. Mer. Mich.

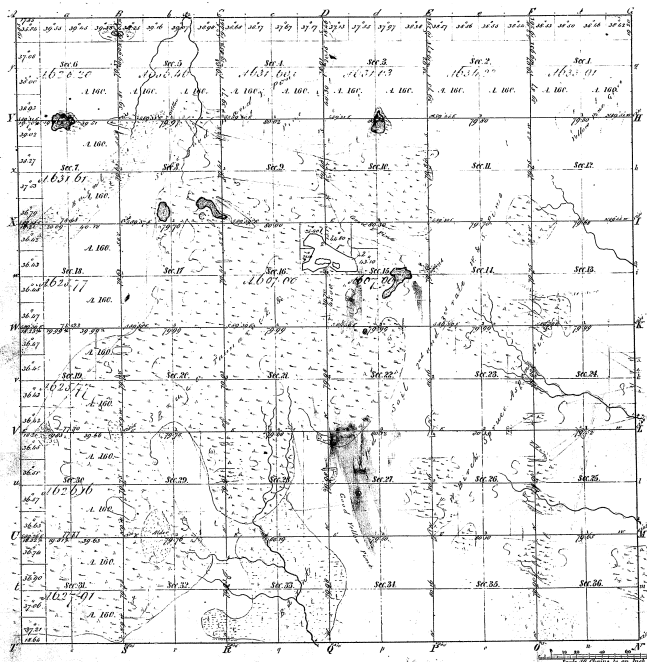

34-23

Monitors of	Prad. Courses	1854	1855	1856	1857	1858	1859	1860

11. 11. 11. 11. 11. 11. 11. 11. 11.

34-23

Total number of Acres 22,867.03

Survey designated	By whom surveyed	Date of Execution	Amount of Acres	When Surveyed	Approved by whom
Township lines	H. S. Beal	Jan. 16 1850	11 54. 36	1850	1850
Subdivisions	Harvey Motlan	June 29 1859	11 77. 52	1859	1859
			61 19. 49	1850	1850

The above copy of Township 45 N. & Range 5 W. Mer. Mich. is a true and correct copy of the original survey made by H. S. Beal in 1850, and is approved by the Surveyor General of the State of Michigan.

Surveyor General's Office  
 Charles S. Tilton  
 Superintendent

