

Township N^o 46 N. Range N^o 2 W. Mer. Mich.

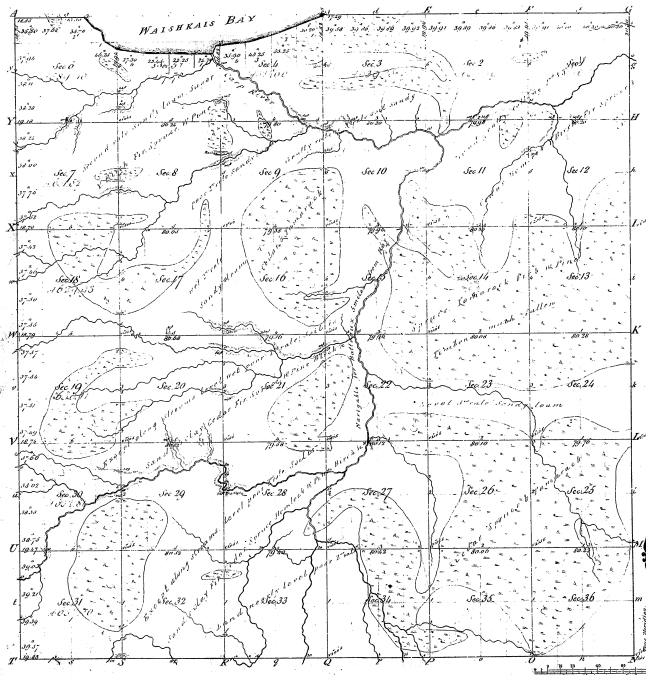

Boundaries of
Township N^o 46 N. Range N^o 2 W. Mer. Mich.

34-15

34-15

Mand. E. L. 7/72

Total number of Acres 2167.82

Survey designated.	By Whom Surveyed	Date of Center	Amount of Survey Ac. 100' 100'	When Surveyed	How Charged to the Landholder's use
Township lines.	W. G. Brown & others	Jan. 11. 1856	12. 50. 33	1 st June 1856	
Subdivisions.	N. W. & M. L. Jones	June 29. 1856	61. 71. 49	3 rd June 1856	

The above Map of Township N^o 46 North of Range 1st 2 West of the 1st Meridian & 2nd West of the 1st Meridian is a correct copy of the survey shown on file in this Office, which have been examined and approved.

Surveyor General's Office Charles A. Allen
Detroit, Jan. 16. 1856

Sur. Gen. 2

TOWNSHIP 46 NORTH, RANGE 2 WEST, OF THE MICHIGAN MERIDIAN, MICHIGAN

DEPENDENT RESURVEY AND SURVEY



True
Meridian
Declination
5 1/2' N

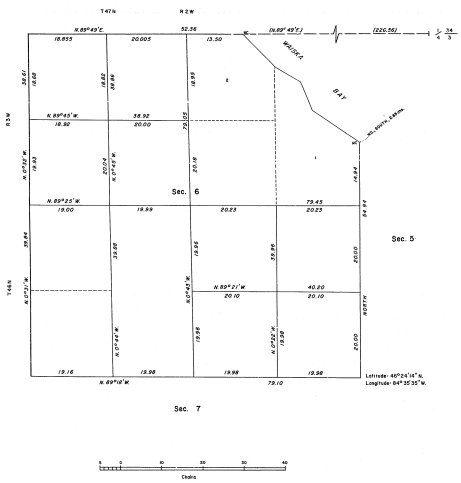

A history of surveys is contained in the field notes.
 This plat represents a dependent resurvey of a portion of the north and west townships, a portion of the additional lines, designed to restore the corners to their true original positions according to the best available evidence and the subdivision of section 6 of T. 46 N., R. 2 W., Michigan Meridian, Michigan, for the purpose of segregation of Indian Lands.
 This survey was executed by Stephen C. Knapp, Cadastral Surveyor, beginning June 17, 1975 and completed August 20, 1975, pursuant to Special Instructions for Group 74, Michigan, dated June 5, 1975.

UNITED STATES DEPARTMENT OF THE INTERIOR
 BUREAU OF LAND MANAGEMENT
 Denver, Colorado September 4, 1975

This plat is strictly conformable to the approved field notes, and the survey, having been correctly executed in accordance with the requirements of law and the regulations of this Bureau, is hereby accepted.

For the Director
J. D. Vanhook
 Chief, Cadastral Survey
 Examination & Approval Staff