

Township No 12 N. Range No 15 West Mer. (Mich.)

10-34

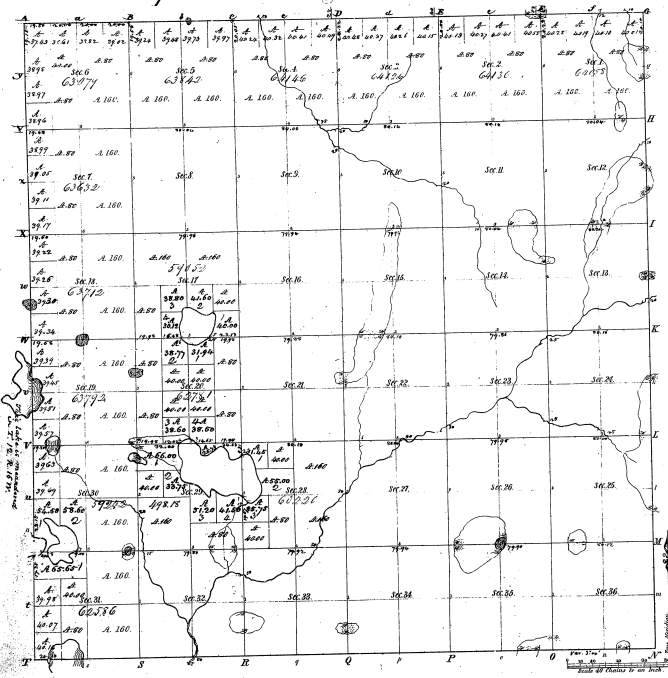

Mileage of Stages			
Post Course	1851	Post Course	1852
1	100.00	100.00	100.00
2	100.00	100.00	100.00
3	100.00	100.00	100.00
4	100.00	100.00	100.00
5	100.00	100.00	100.00
6	100.00	100.00	100.00
7	100.00	100.00	100.00
8	100.00	100.00	100.00
9	100.00	100.00	100.00
10	100.00	100.00	100.00
11	100.00	100.00	100.00
12	100.00	100.00	100.00
13	100.00	100.00	100.00
14	100.00	100.00	100.00
15	100.00	100.00	100.00
16	100.00	100.00	100.00
17	100.00	100.00	100.00
18	100.00	100.00	100.00
19	100.00	100.00	100.00
20	100.00	100.00	100.00
21	100.00	100.00	100.00
22	100.00	100.00	100.00
23	100.00	100.00	100.00
24	100.00	100.00	100.00
25	100.00	100.00	100.00
26	100.00	100.00	100.00
27	100.00	100.00	100.00
28	100.00	100.00	100.00
29	100.00	100.00	100.00
30	100.00	100.00	100.00
31	100.00	100.00	100.00
32	100.00	100.00	100.00
33	100.00	100.00	100.00
34	100.00	100.00	100.00
35	100.00	100.00	100.00
36	100.00	100.00	100.00

10-34

Total number of Acres 30720.00

Survey designated	By whom Surveyed	Date of Completion	Amount of Survey	When Surveyed	Where and with the Section No.
Township	W. H. H. H. H. H.	17 Aug 1852	25 36 36	6	1852
Subdivisions	W. H. H. H. H.	25	6 5 36 19 3	1852	1852

The above Map of Township No 12 N. of Range No 15 West Principal Meridian, Michigan, is a copy of the original of the survey thereof on file in this office, which has been examined and approved. Surveyor General's Office, Ann Arbor, Mich. 22^d 1852

W. H. H. H. H.