

MUSKEGON STATE PARK

MUSKEGON STATE PARK
CONSTRUCTION PLANS FOR
NORTH CAMPGROUND AND SNUG
HARBOR DAY-USE BIT. SURFACING
PROJECT No. 24-2643

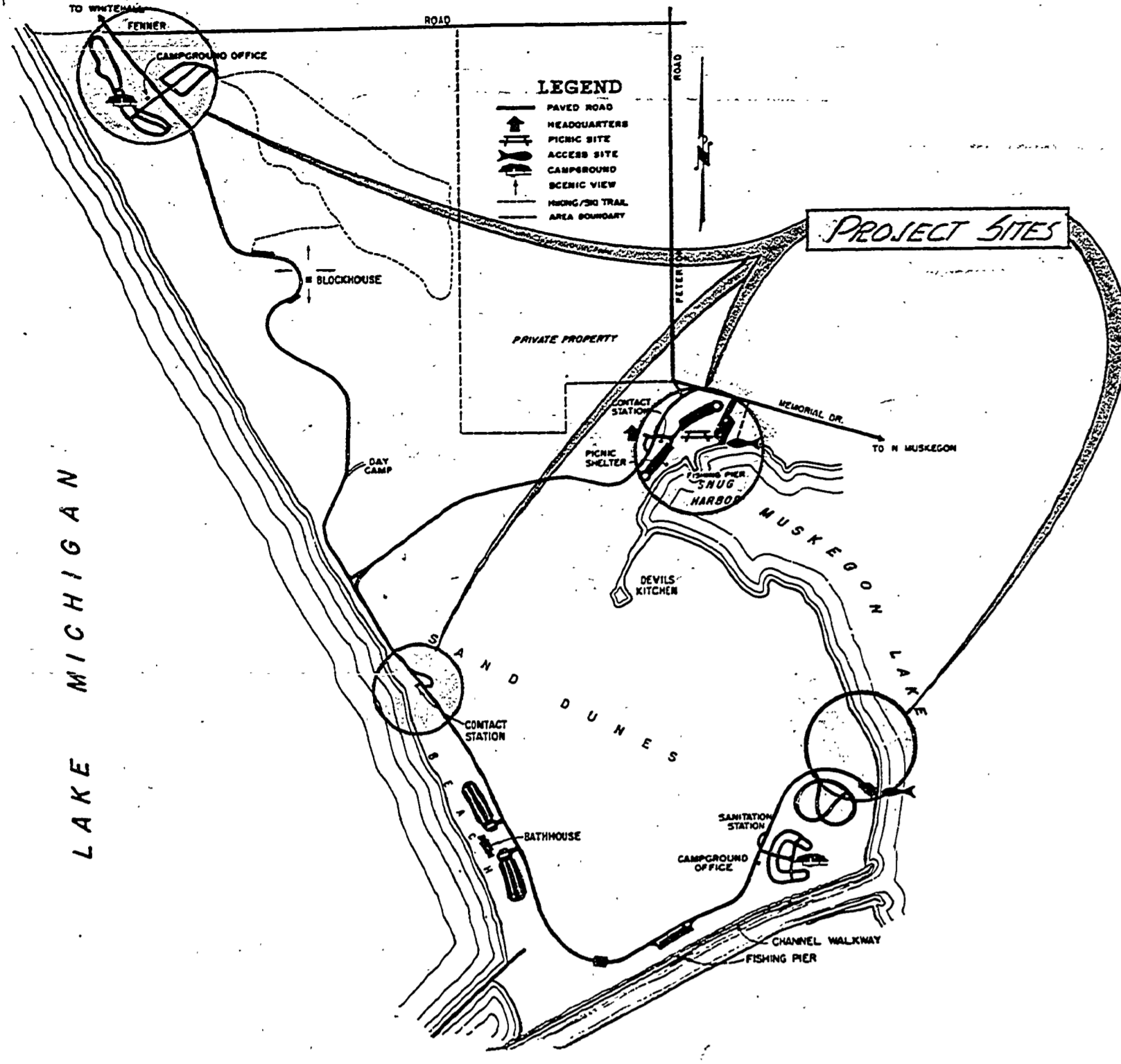

LOCATION MAP

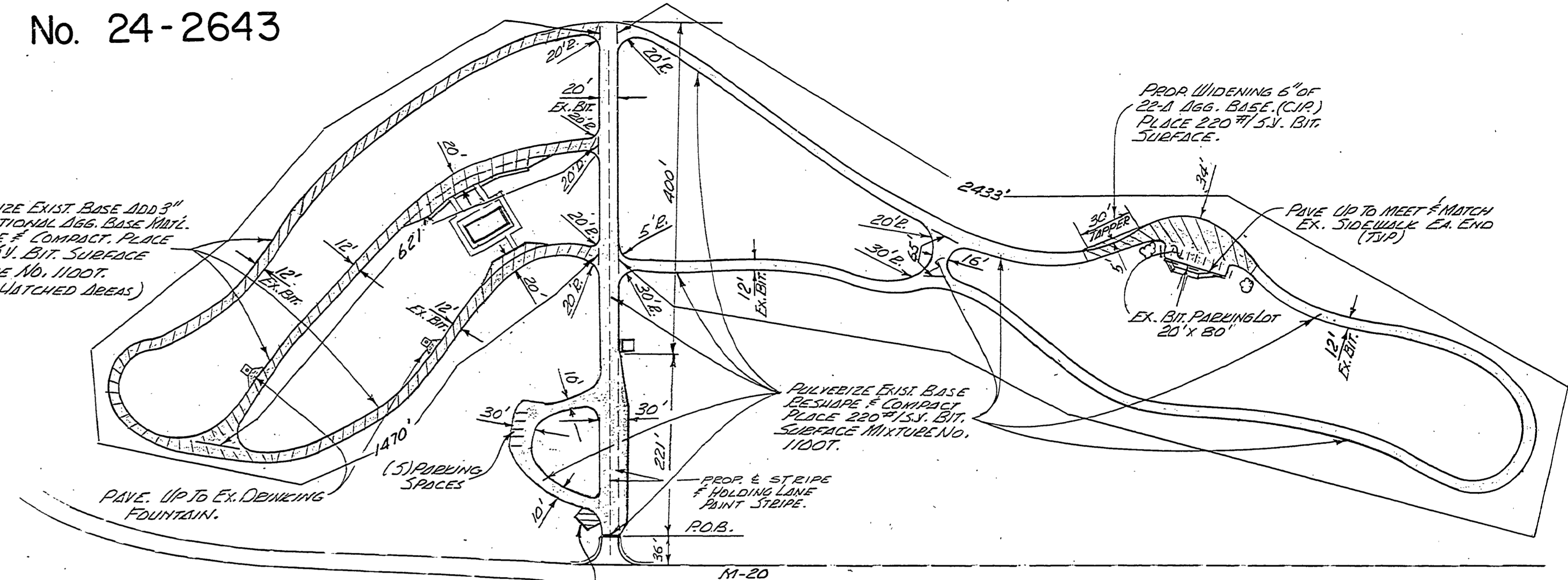
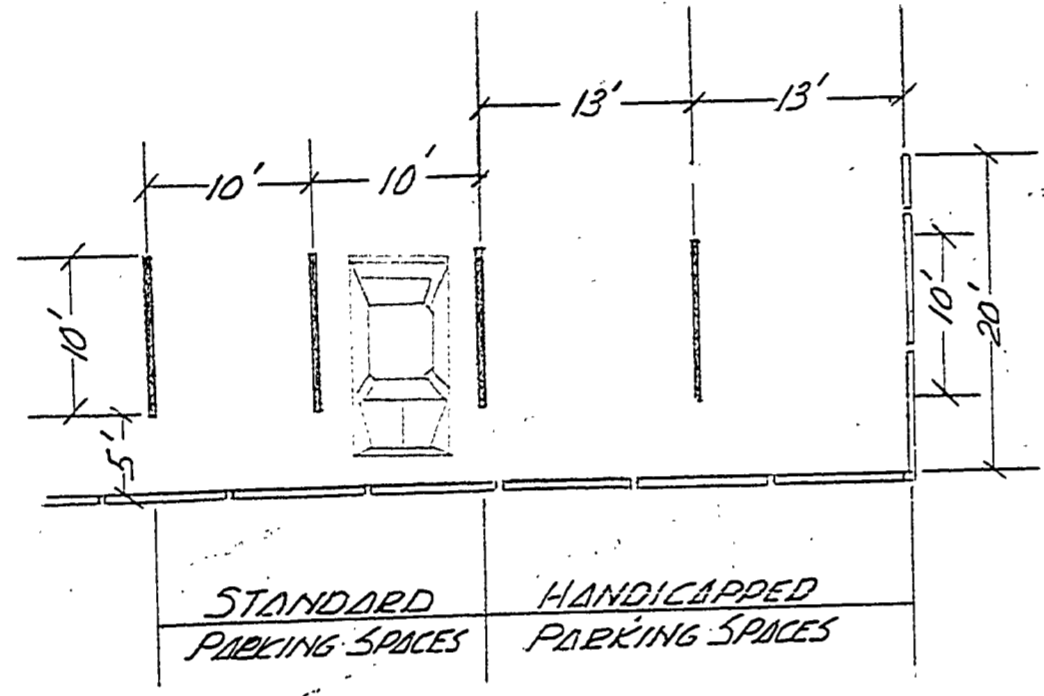

PLAN
NORTH CAMPGROUND

- Ex. BIT. SURFACE
= PULVERIZE, RESHAPE, (CIP) PLACE BIT. SURF.
- Ex. BIT. SURFACE
= PULVERIZE, ADD 3" AGG. BASE, RESHAPE, (CIP) PLACE BIT. SURF.
- Ex. GRAVEL SURFACE
= GRADE, RESHAPE, (CIP) PLACE BIT. SURF.
- Ex. GRAVEL SURFACE
= ADD 3" AGG. BASE, GRADE, RESHAPE, (CIP) PLACE BIT. SURF.
- NEW CONSTRUCTION
= EXCAVATE, PLACE 6" AGG. GRADE, SHAPE, (CIP) PLACE BIT. SURF.

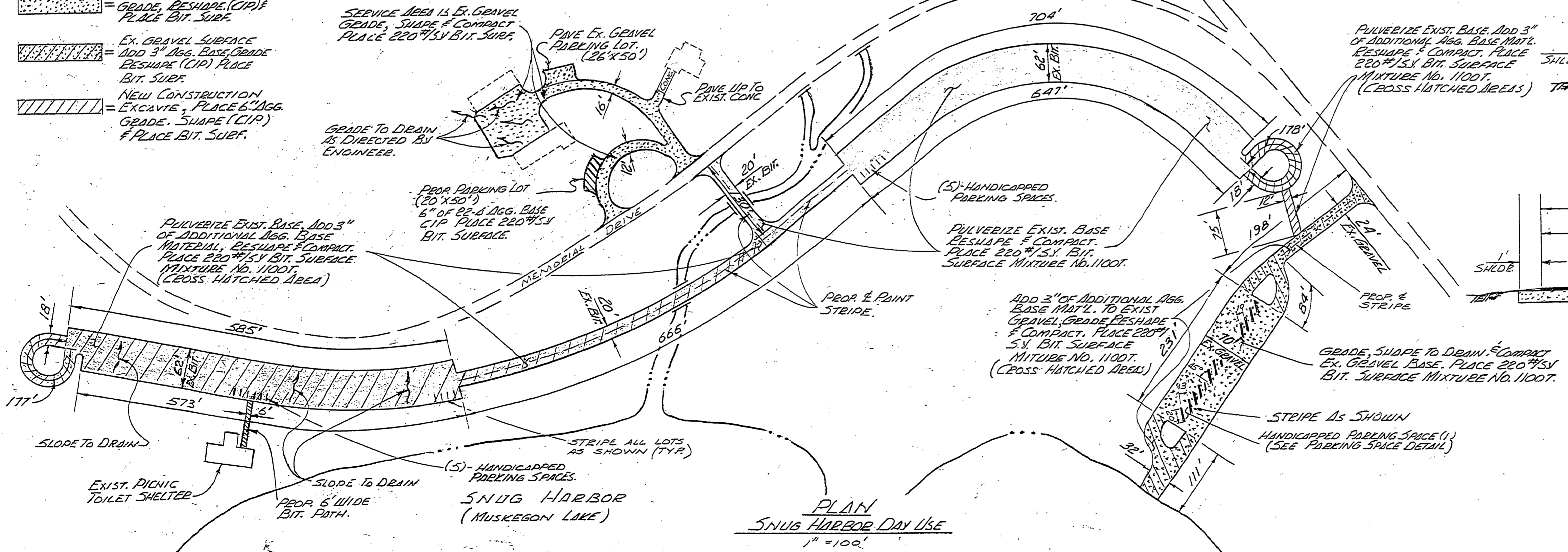

PLAN
SNUG HARBOR DAY USE
1" = 100'

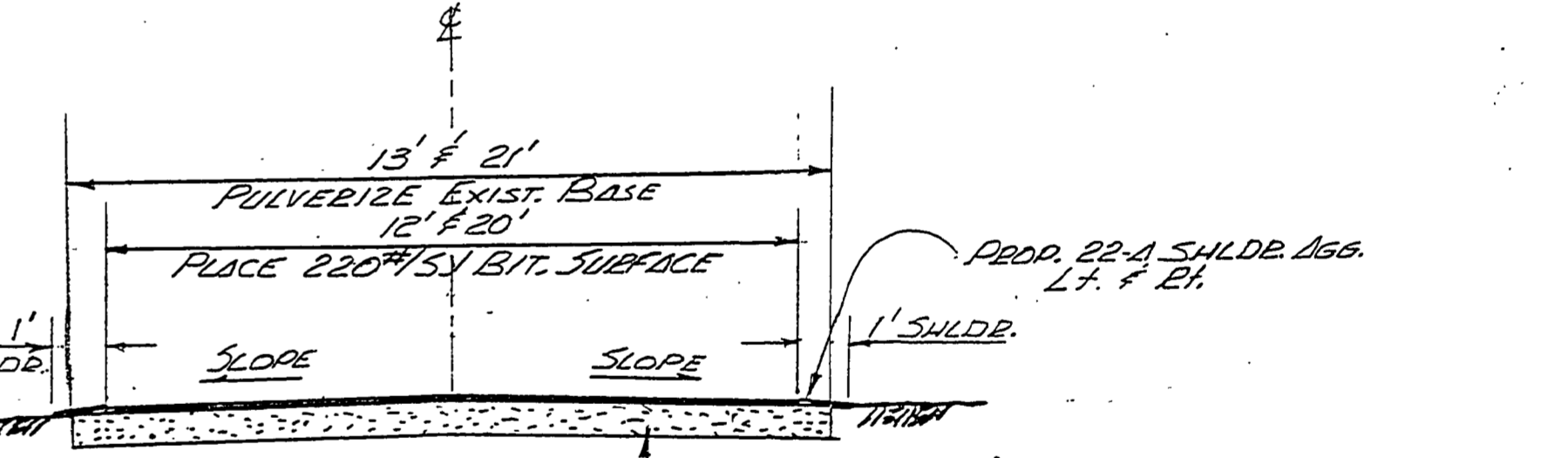

TYPICAL SECTION
TWO-WAY & ONE-WAY ROADS

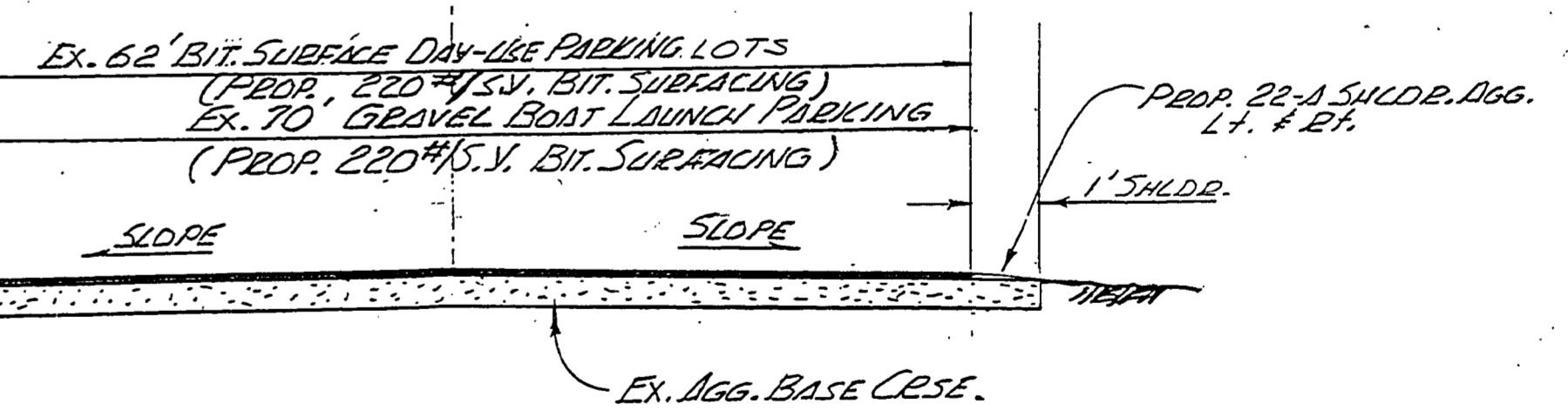

TYPICAL SECTION
DAY-USE PARKING & BOAT LAUNCH AREA

BUILDING COMMITTEE APPROVAL	
BY: _____	DATE: _____
RECOMMENDED FOR APPROVAL: _____ 2-22-89 ENGINEERING OR ARCHITECTURAL SUPERVISOR DATE	
RECOMMENDED FOR APPROVAL: _____ PROGRAM AND PLAN COORDINATOR DATE	
DIVISION / REGION APPROVAL	
BY: _____ 2/16/89	DATE: _____
DIVISION CHIEF / REGIONAL MANAGER	
ENGINEERING DIVISION	
APPROVED: _____ 2-22-89	DATE: _____
CHIEF ENGINEER	

SURVEYED BY	DRAWN BY J. LEMMON	7-86	NO. DATE BY	REVISIONS	NO. DATE BY	REVISIONS	MICHIGAN DEPARTMENT OF NATURAL RESOURCES	PLANS & SECTIONS	MUSKEGON STATE PARK AREA OR PARK	PROJECT NO. 24-2643	SHEET 1 OF 2	PLAN NO. E-124
DESIGNED BY H. MERRILL	CHECKED BY	DATE	1.		3.				BIT. SURFACING			
			2.		4.							