

TYPICAL DRAIN FIELD SECTION
NO SCALE

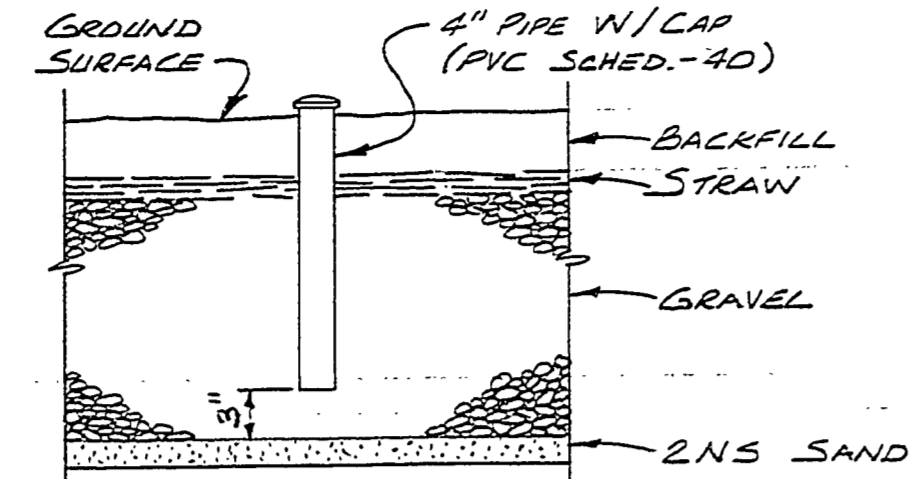

INSPECTION PORT DETAIL
NO SCALE

MP 123

SOIL BORING
(TWO BACKHOE CUTS IN PROPOSED TILE FIELD AREA)
0.0'-0.3' TOPSOIL
0.3'-5.0' MED. GRAY SAND
5.0'-6.0'+ BROWN DUNE SAND
NO GROUND WATER TABLE

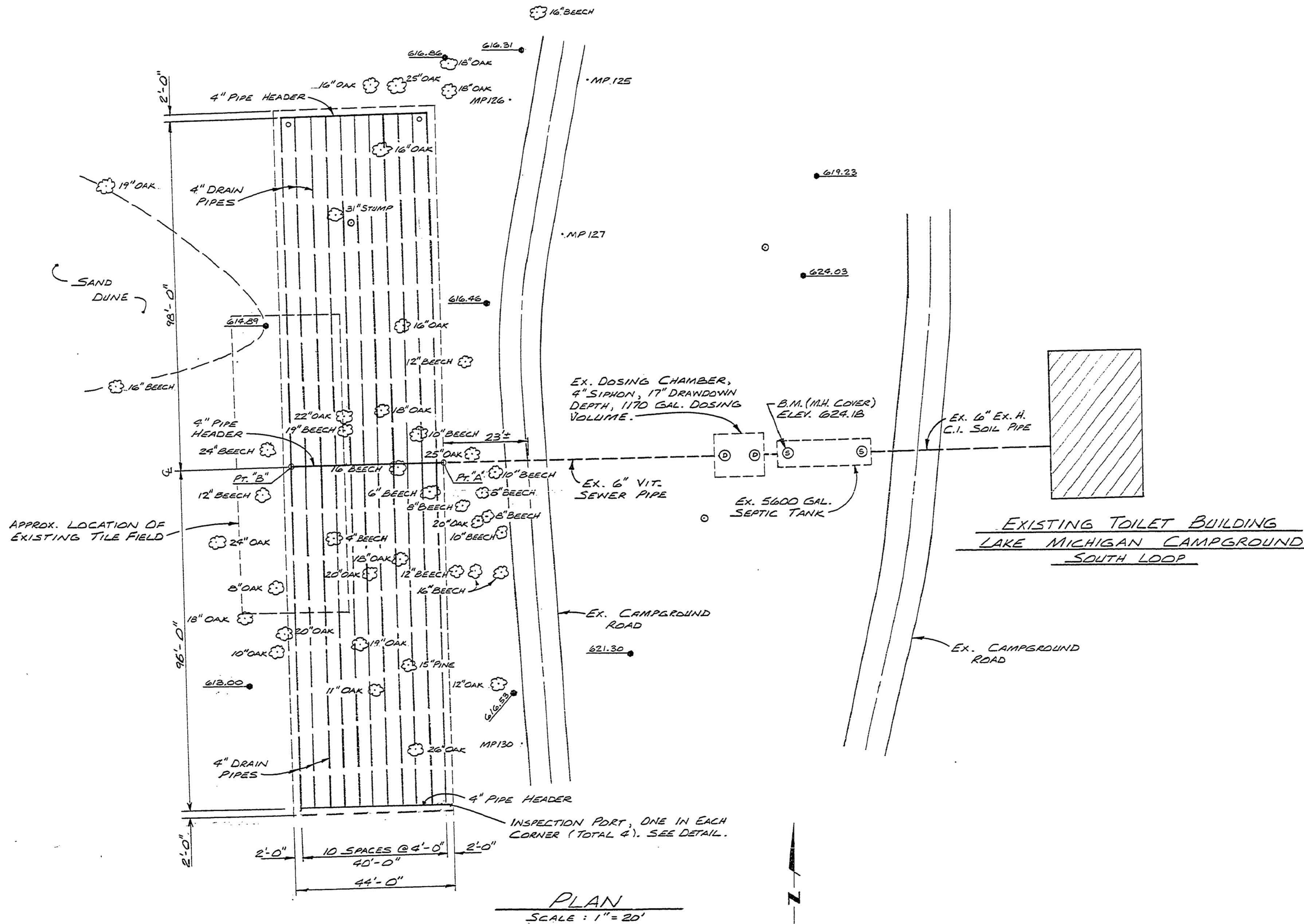

PLAN
SCALE: 1" = 20'

CONSTRUCTION NOTES

1. PROVIDE 4" DIA. PIPE HEADERS (WITH NO PERFORATIONS) WITH TIGHT JOINTS IN THE CENTER AND AT BOTH ENDS. (PVC SCHEDULE 40 PIPE)
2. DRAINFIELD TO HAVE 22 LINES OF 4" DIA. PERFORATED PLASTIC PIPE (MDPH APPROVED) 98 FEET LONG AT 4'-0" CENTERS. PROVIDE 1 INCH FALL IN TOTAL LENGTH OF DRAIN PIPE.
3. INSTALL THE CENTER PIPE HEADER AT THE SAME INVERT ELEV. AS THAT OF EXISTING 6" DIA. VIT. SEWER PIPE AT POINT "A". JUST BEFORE POINT "A" USE A VIT. PIPE - PVC PIPE ADAPTER AND 6" x 4" PVC PIPE REDUCER (ECCENTRIC TYPE) CENTER PIPE HEADER SHOULD HAVE SAME INVERT ELEV. AT Pt. "A" AND Pt. "B".
4. REMOVE PORTIONS OF EXISTING DISTRIBUTION BOX AND EXISTING TILE FIELD LYING IN THE AREA OF THE PROPOSED DRAIN FIELD.
5. RELOCATE EXISTING POLE WITHIN THE AREA OF THE PROPOSED DRAIN FIELD.
6. PROVIDE MINIMUM OF 12" COVER ON TOP OF DRAIN PIPES. THE TOP OF DRAIN FIELD AREA COULD BE REGRADED TO ACHIEVE THIS.
7. GET EXISTING DOSING CHAMBER INTO SERVICE AGAIN.
8. STRIP TOPSOIL AND REPLACE AFTER COMPLETION.
9. IN CONSTRUCTION OF THE DRAIN FIELD ATTENTION SHALL BE GIVEN TO THE PROTECTION OF NATURAL ABSORPTION PROPERTIES OF THE SOIL AND CARE MUST BE TAKEN TO PREVENT SEALING OF THE SURFACE ON THE BOTTOM AND SIDES OF THE FIELD. THE TOP OF THE CONSTRUCTED FIELD SHALL BE HAND TAMPED ONLY. NO HEAVY EQUIPMENT SHALL BE ALLOWED ON THE DRAIN FIELD AFTER CONSTRUCTION.
10. REMOVE TREES AS NEEDED.
11. SEPTIC TANK AND DOSING CHAMBER TO BE PUMPED OUT AT LEAST ONE WEEK BEFORE START OF CONSTRUCTION.
12. WHILE REMOVING EXISTING TILE FIELD MATERIAL WITHIN THE AREA OF THE PROPOSED DRAINFIELD, REMOVE THE GRAY SAND LAYER WHICH EXTENDS UP TO THE BROWN DUNE SAND. BACKFILL WITH SAND.

LEGEND
 ○ UTILITY POLE
 MP LOT MARKER POST
 --- ROAD CENTER LINE
 ● SPOT ELEVATION
 ○ TREE

BUILDING COMMITTEE APPROVAL	
BY: _____	DATE: _____
RECOMMENDED FOR APPROVAL: <i>[Signature]</i> 9-29-78	
RECOMMENDED FOR APPROVAL: _____	
DIVISION/REGION APPROVAL	
BY: <i>[Signature]</i> 10-3-78	DATE: _____
APPROVED: <i>[Signature]</i> 10-6-78	

SURVEYED BY H. SELLECK	9-78	DRAWN BY D. PADGETT	9-78	NO. DATE BY REVISIONS	NO. DATE BY REVISIONS	MICHIGAN DEPARTMENT OF NATURAL RESOURCES	SITE PLAN & DETAILS	MUSKOGON STATE PARK AREA OR PARK	PROJECT TILE FIELD REPAIR	PROJECT NO. 24-2014	SHEET 1 OF 1	PLAN NO. E-121
DESIGNED BY A. QURAIHI	9-78	CHECKED BY		1. 10-78 A.G. ADDED INSP. PORT DETAIL & NOTES	3.							
				2. 03-82 W.H. CORRECTED DRAIN FIELD LENGTH	4.							