

LOCATION MAP

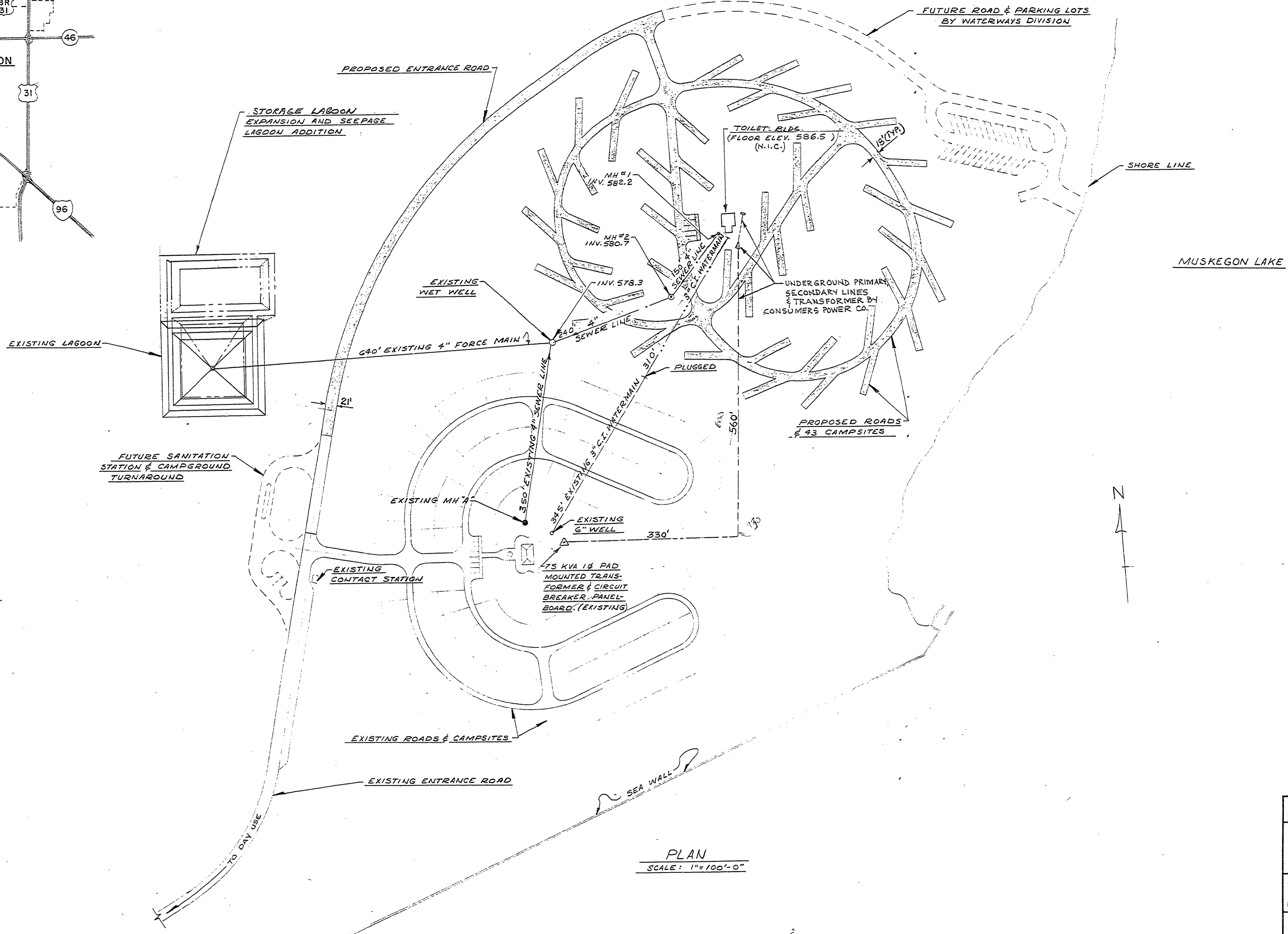

PLAN
SCALE: 1"=100'-0"

— LEGEND —

| | |
|--|--|
| | EXISTING ROADS & CAMPSITES |
| | PROPOSED ROADS & CAMPSITES |
| | FUTURE CONSTRUCTION |
| | ADDITION LINE (ELECT.) |
| | EXISTING 4" SEWER LINE |
| | EXISTING 3" C.I. WATERMAIN |
| | 75 KVA EXISTING TRANSFORMER & CIRCUIT BREAKER PANEL BOARD (EXISTING) |
| | PROPOSED 4" SEWER LINE |
| | PROPOSED WATERMAIN |

| | | | | | | | | | | | |
|----------------------------|-------|-------------------|------|-----|------|----|-----------|-----|------|----|-----------|
| SURVEYED BY L. THOMPSON | 10-73 | DRAWN BY MITCH K. | 3-74 | NO. | DATE | BY | REVISIONS | NO. | DATE | BY | REVISIONS |
| DESIGNED BY A. PETRAVICIUS | 3-74 | CHECKED BY | | 1. | | | | 3. | | | |
| | DATE | | DATE | 2. | | | | 4. | | | |

MICHIGAN
DEPARTMENT OF NATURAL RESOURCES

COVER SHEET
SHEET TITLE

MUSKEGON STATE PARK
AREA OR PARK
CAMPGROUND DEVELOPMENT

| | |
|---------------------------------|---|
| BUILDING COMMITTEE APPROVAL | |
| BY: _____ | CHAIRMAN |
| DATE: _____ | |
| RECOMMENDED FOR APPROVAL: _____ | ENGINEERING OR ARCHITECTURAL SUPERVISOR |
| DATE: _____ | |
| RECOMMENDED FOR APPROVAL: _____ | PROGRAM AND PLAN COORDINATOR |
| DATE: _____ | |
| DIVISION/REGION APPROVAL | |
| BY: _____ | DIVISION CHIEF/REGIONAL MANAGER |
| DATE: _____ | |
| ENGINEERING DIVISION | |
| APPROVED: _____ | CHIEF ENGINEER |
| DATE: _____ | |

| | | |
|---------------------|--------------|----------------|
| PROJECT NO. 24-1456 | SHEET 1 OF 1 | PLAN NO. E-119 |
|---------------------|--------------|----------------|

