

SECTION - INLET/OVERFLOW CONCEPT  
(NO SCALE)

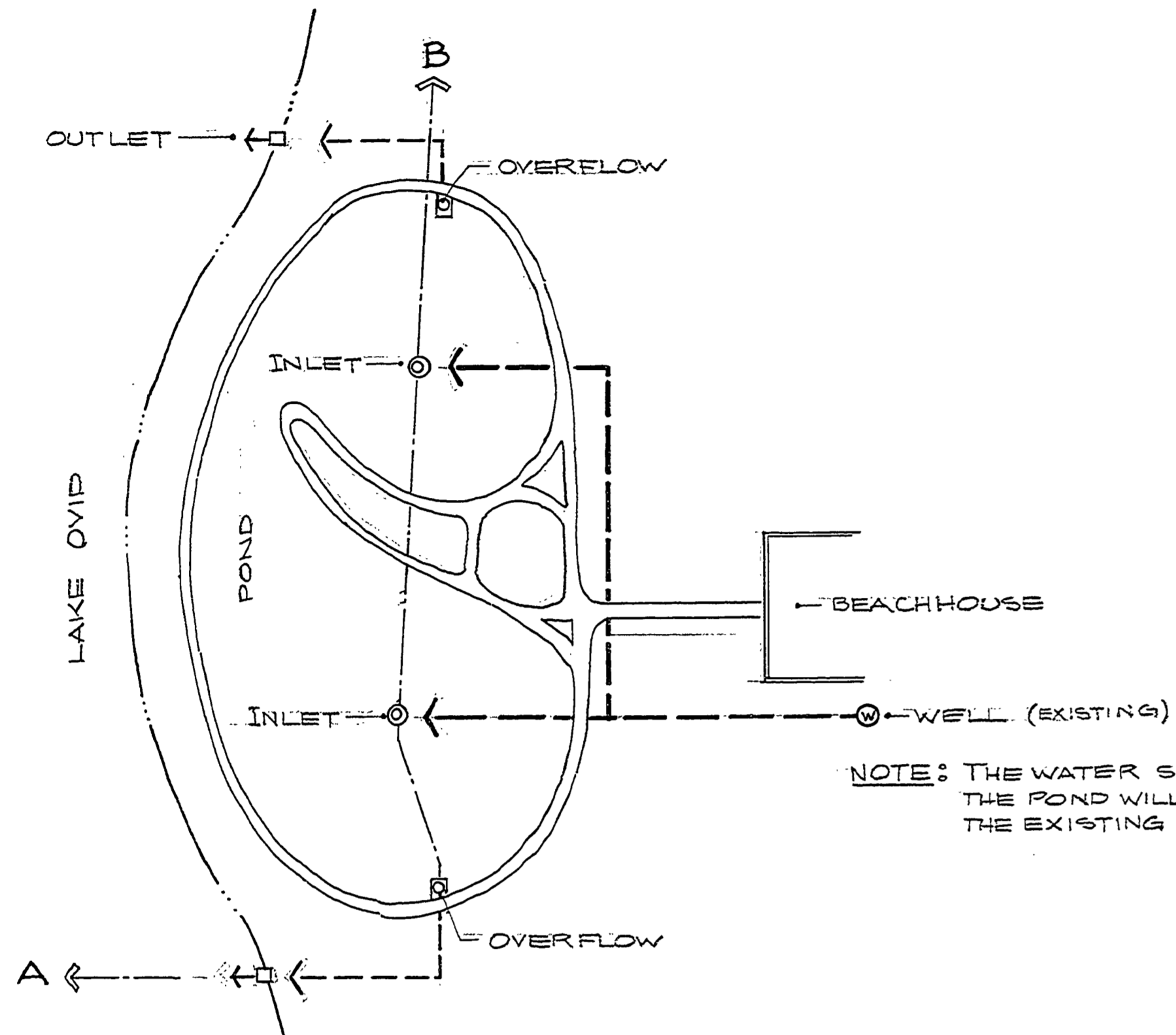

PLAN - INLET/OVERFLOW CONCEPT  
(NO SCALE)

NOTE: THE WATER SOURCE FOR THE POND WILL BE FROM THE EXISTING 6" WELL.

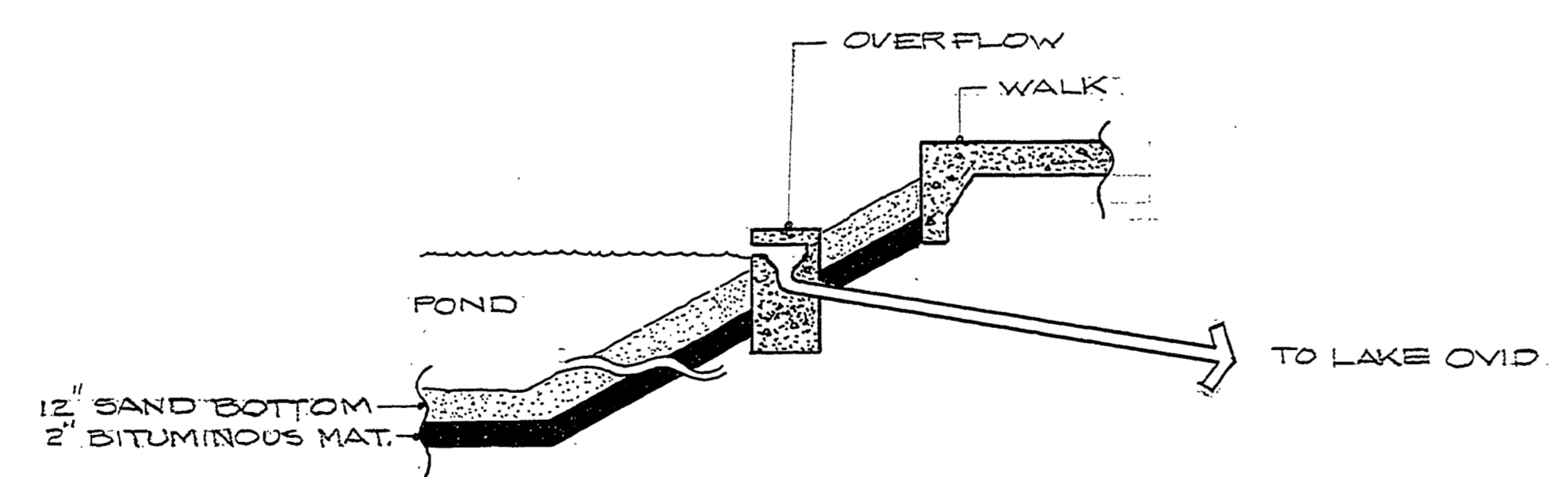
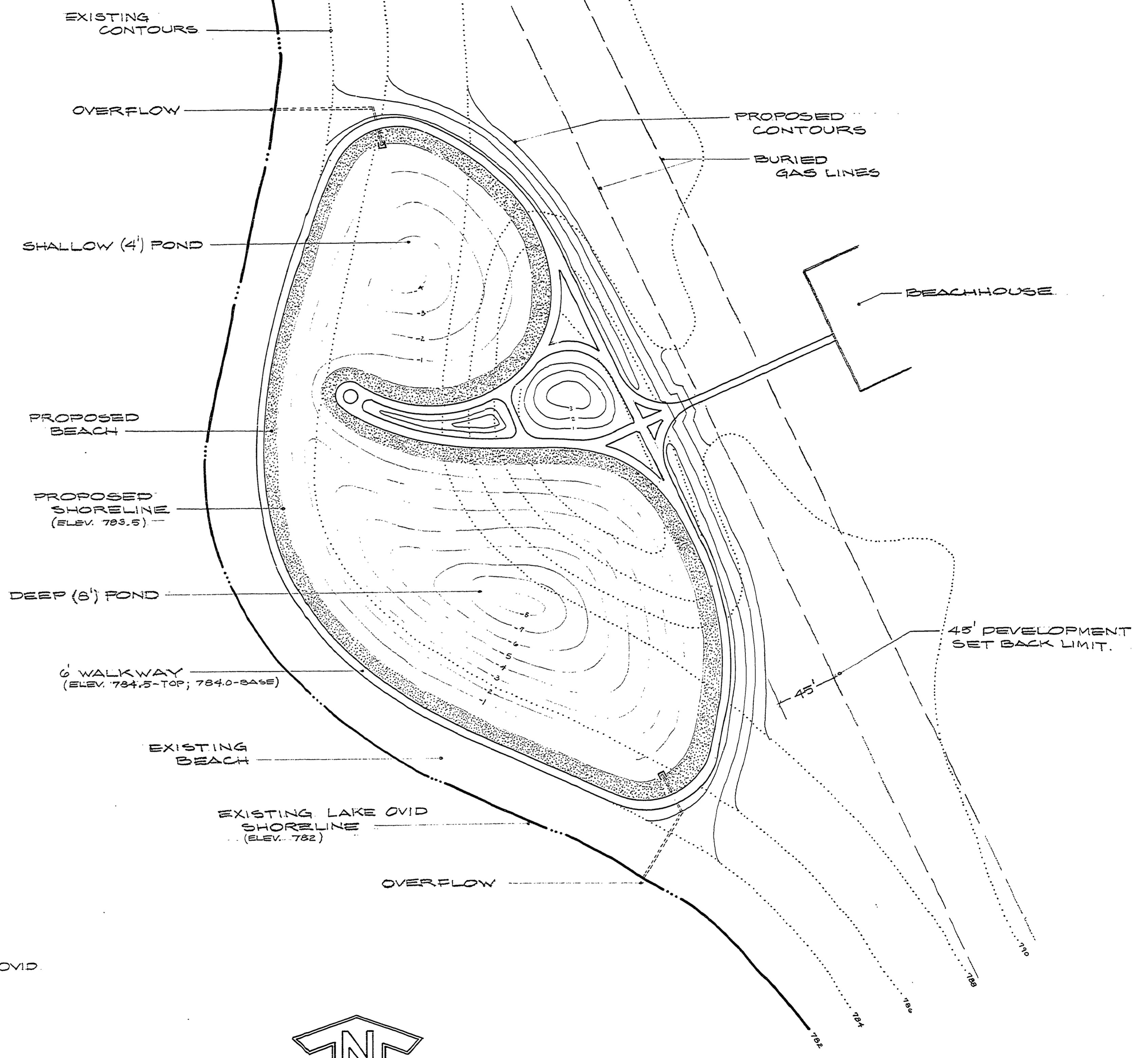

SECTION - POND BOTTOM CONCEPT  
(NO SCALE)

GENERAL NOTE:  
THE EXISTING GAS LINES MUST BE PROTECTED DURING CONSTRUCTION. THIS INCLUDES PROTECTION FROM EXCAVATION AS WELL AS HEAVY VEHICLES DRIVING ACROSS THE GAS LINES. THE PROCEDURE OF PROVIDING CONCRETE PADS (6' X 6' X WIDTH OF ROAD) OVER THE GAS LINES AT ALL CONSTRUCTION ROAD CROSSINGS AND FENCING PLACED ALONG GAS LINES TO ENSURE THAT VEHICLES CROSS LINES ONLY AT DESIGNATED SPOTS MUST BE FOLLOWED.

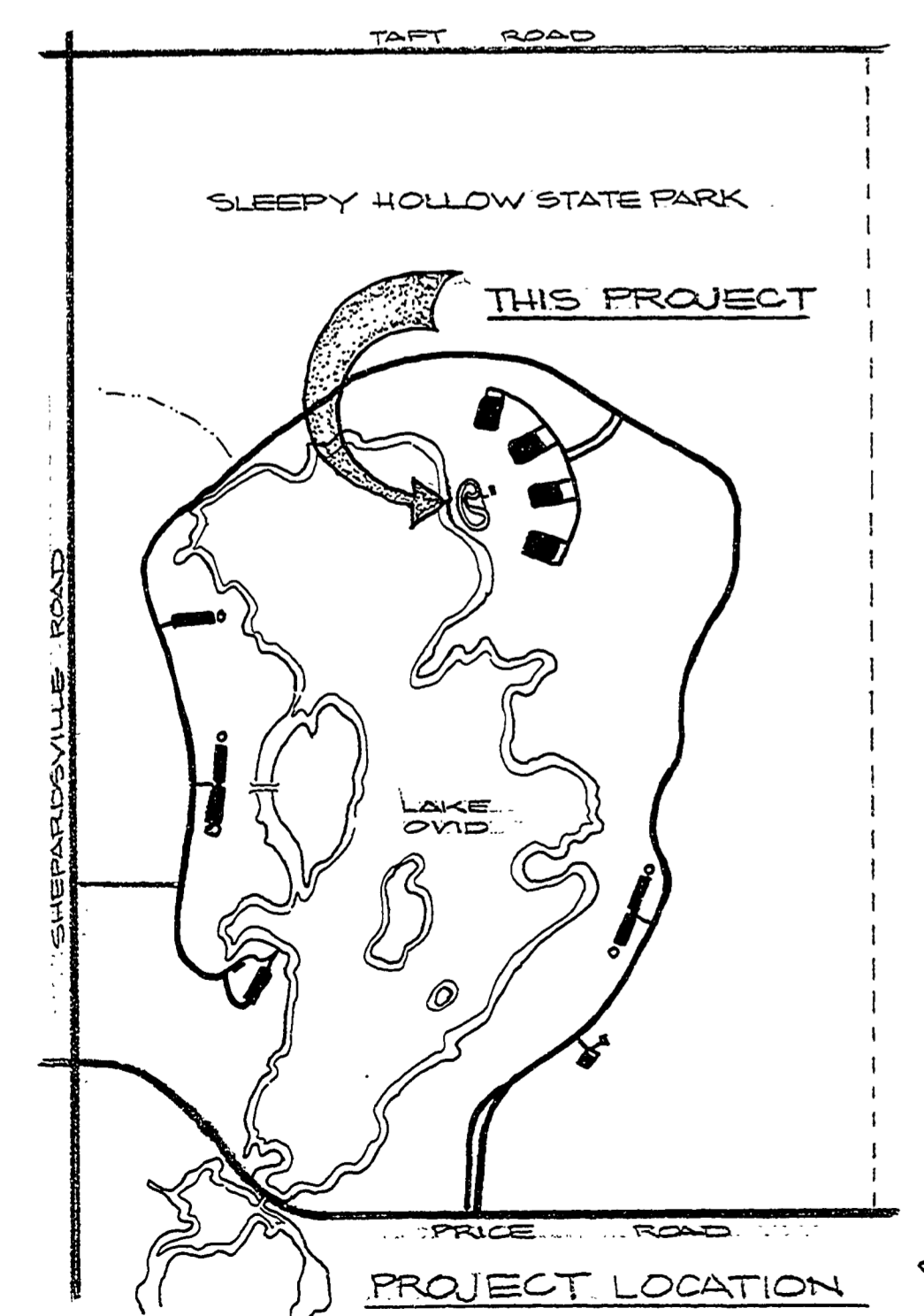
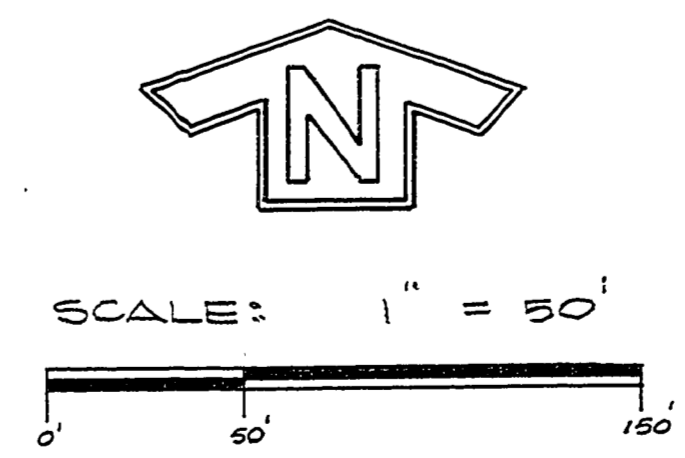

REVIEWED BY: Henry H. van Burg 3/29/85  
IN CHARGE, PROGRAM PLANNING DATE

APPROVED BY: Jack B. Binterfull 3-29-85  
CHIEF, PARKS DIVISION DATE

SURVEYED BY	DRAWN BY L.C. MILLER	1/85	NO.	DATE	BY	REVISIONS	NO.	DATE	BY	REVISIONS	MICHIGAN DEPARTMENT OF NATURAL RESOURCES	PLAN - RECREATION POND	SLEEPY HOLLOW STATE PARK	PROJECT NO.
DESIGNED BY L.C. MILLER	CHECKED BY	DATE	1.				3.					SHEET TITLE	PROJECT	SHEET 2 OF 2
			2.				4.							PLAN NO. L-121