

# SLEEPY HOLLOW STATE PARK

## CONSTRUCTION PLANS FOR BITUMINOUS SURFACING & CURBING

PROJECT NUMBER  
**21-9679**

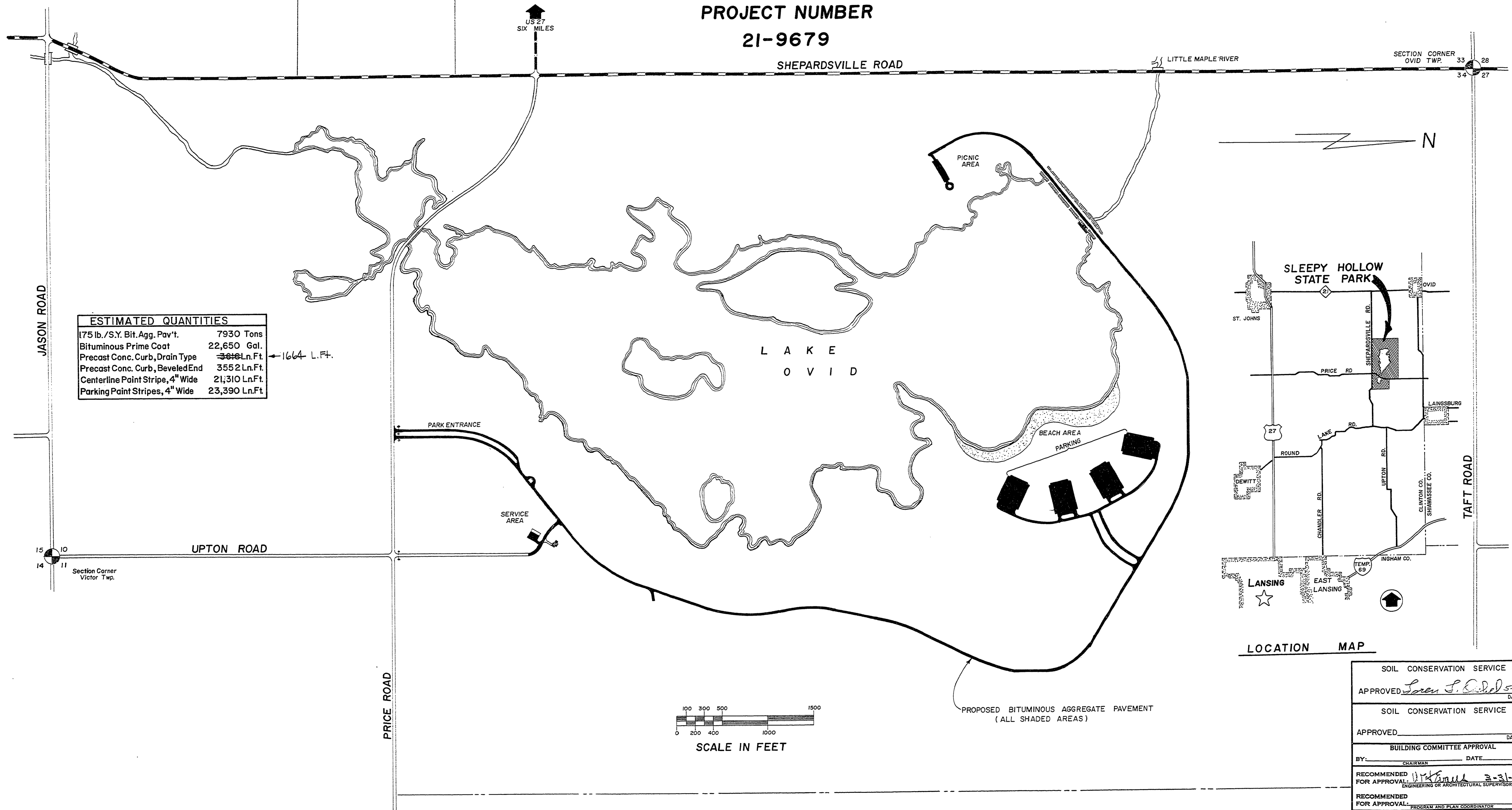

ESTIMATED QUANTITIES	
175 lb./S.Y. Bit. Agg. Pav't.	7930 Tons
Bituminous Prime Coat	22,650 Gal.
Precast Conc. Curb, Drain Type	3816 Ln.Ft.
Precast Conc. Curb, Beveled End	3552 Ln.Ft.
Centerline Paint Stripe, 4" Wide	21,310 Ln.Ft.
Parking Paint Stripes, 4" Wide	23,390 Ln.Ft.

← 1664 L.Ft.

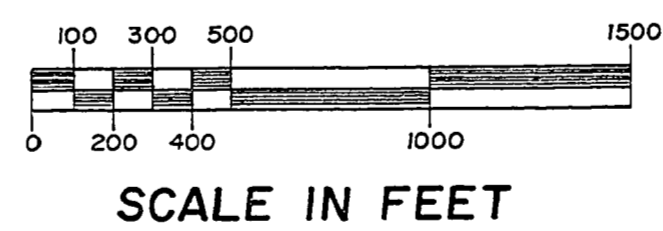
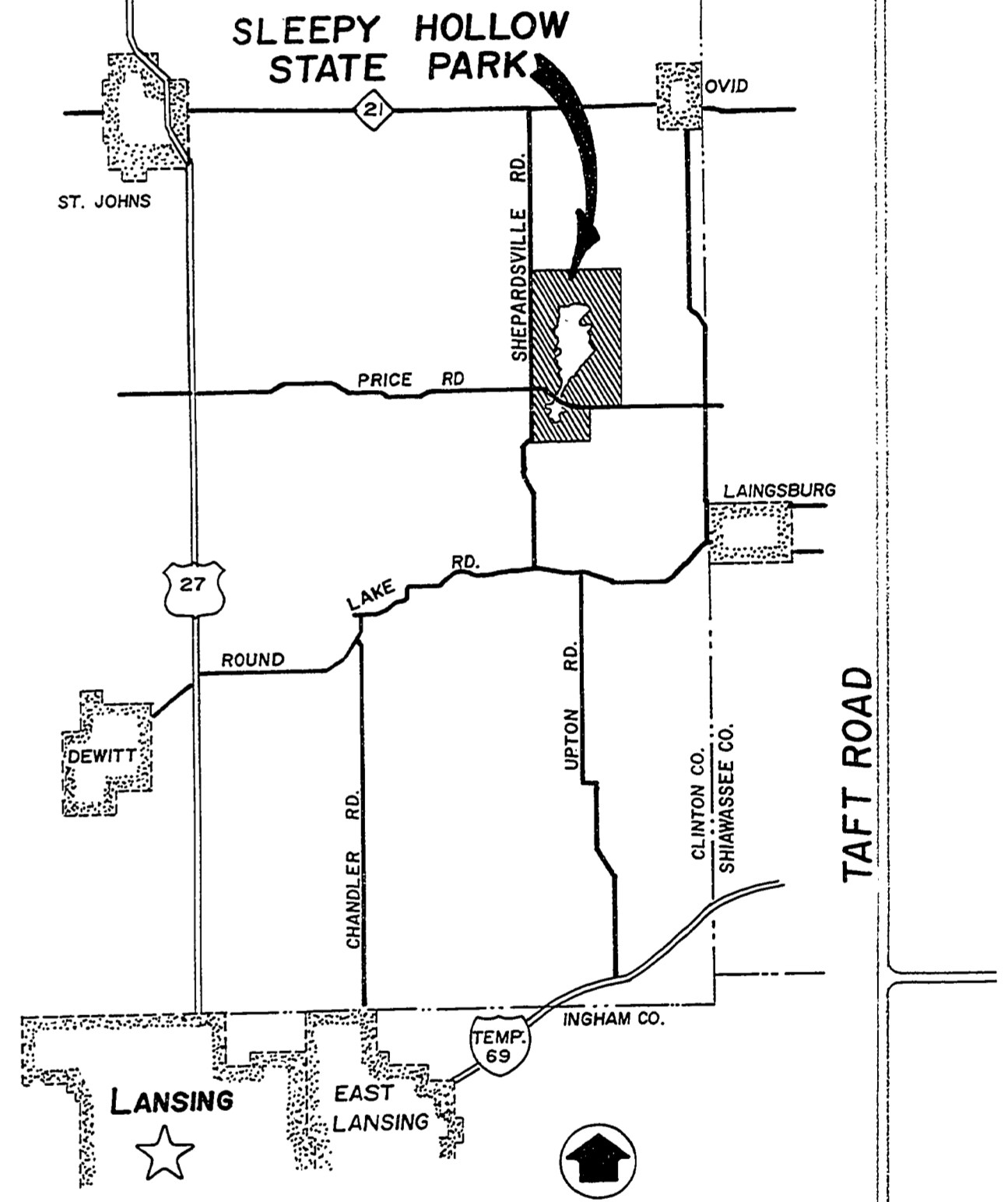

SOIL CONSERVATION SERVICE	
APPROVED: <i>Soren S. Ovid</i>	DATE: 5-19-77
SOIL CONSERVATION SERVICE	
APPROVED: _____	DATE: _____
BUILDING COMMITTEE APPROVAL	
BY: _____	DATE: _____
RECOMMENDED FOR APPROVAL: <i>J. S. Smith</i> 3-31-77	
ENGINEERING OR ARCHITECTURAL SUPERVISOR DATE	
RECOMMENDED FOR APPROVAL: _____	
PROGRAM AND PLAN COORDINATOR DATE	
DIVISION/REGION APPROVAL	
BY: <i>Jack R. Smith</i>	DATE: 4-11-77
DIVISION CHIEF/REGIONAL MANAGER ENGINEERING DIVISION	
APPROVED: <i>W. L. Ovid</i>	DATE: 4-5-77
CHIEF ENGINEER DATE	

SURVEYED BY <b>L. Smith</b>	2-77	DRAWN BY <b>L.S.</b>	2-77	NO.	DATE	BY	REVISIONS	NO.	DATE	BY	REVISIONS	MICHIGAN DEPARTMENT OF NATURAL RESOURCES	COVER SHEET SHEET TITLE	SLEEPY HOLLOW S. P. AREA OR PARK BITUMINOUS SURFACING & CURBING PROJECT	PROJECT NO. <b>21-9679</b>	SHEET <b>1</b> OF <b>5</b>	PLAN NO. <b>E-110</b>
DESIGNED BY <b>L.S.</b>	2-77	CHECKED BY	DATE	1.	8-22-77	LEM	Revise curb Quant.	3.									