

# SLEEPY HOLLOW STATE PARK

## CONSTRUCTION PLANS FOR

### WATER SYSTEM AT PARK HEADQUARTERS

PROJECT NO. 24-1559

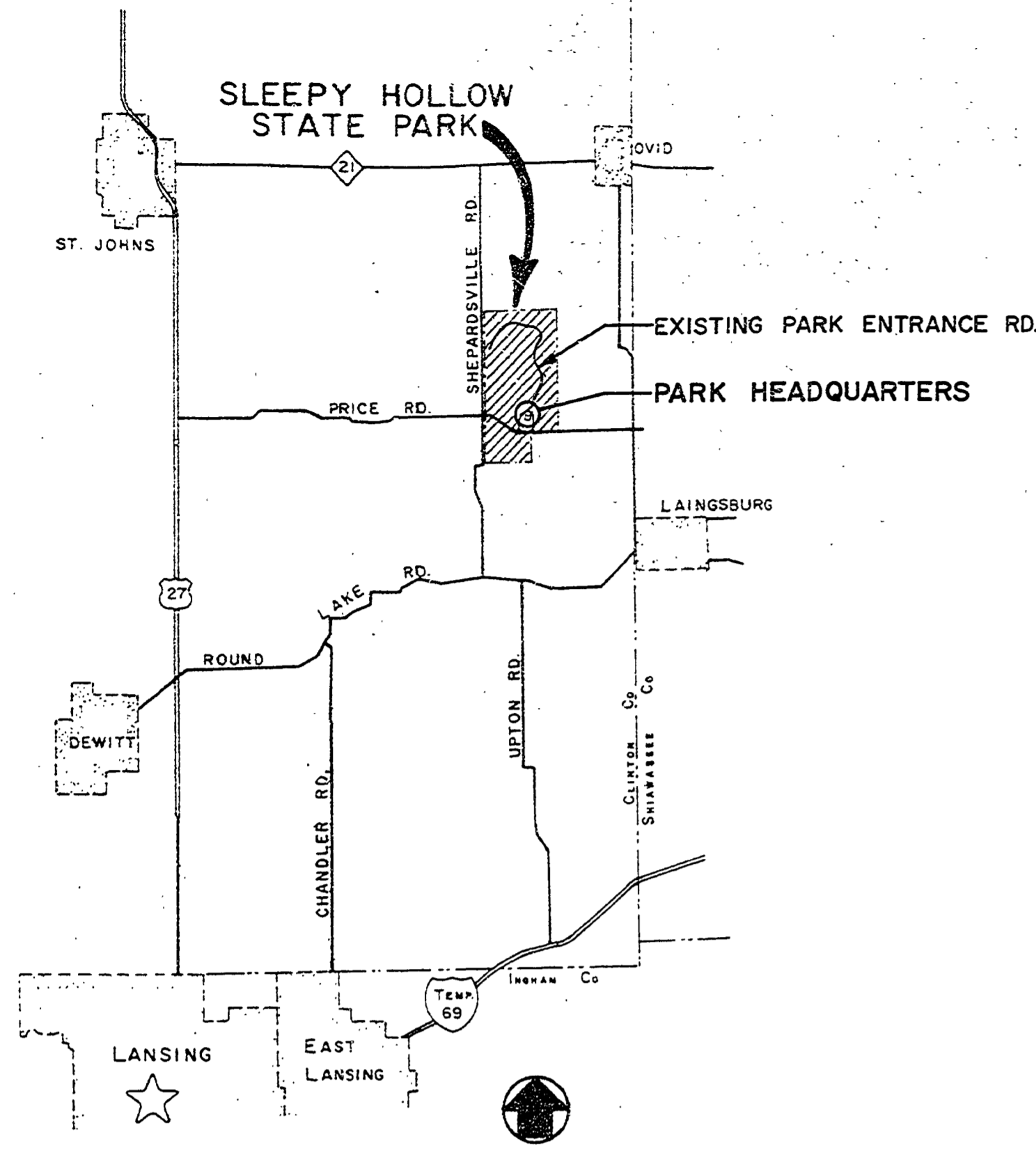

LOCATION MAP

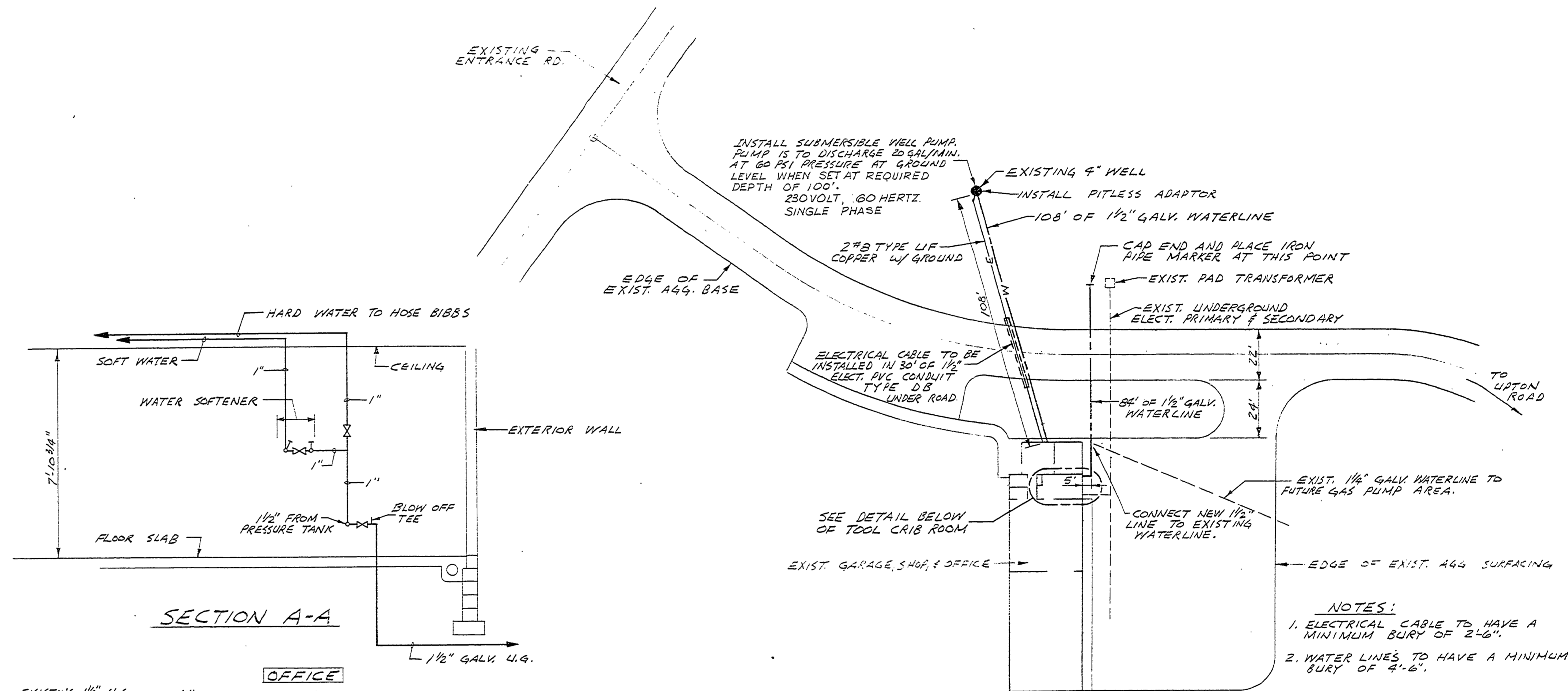

SECTION A-A

SERVICE AREA PLAN

- NOTES:**
1. ELECTRICAL CABLE TO HAVE A MINIMUM BURY OF 2'-6".
  2. WATER LINES TO HAVE A MINIMUM BURY OF 4'-6".

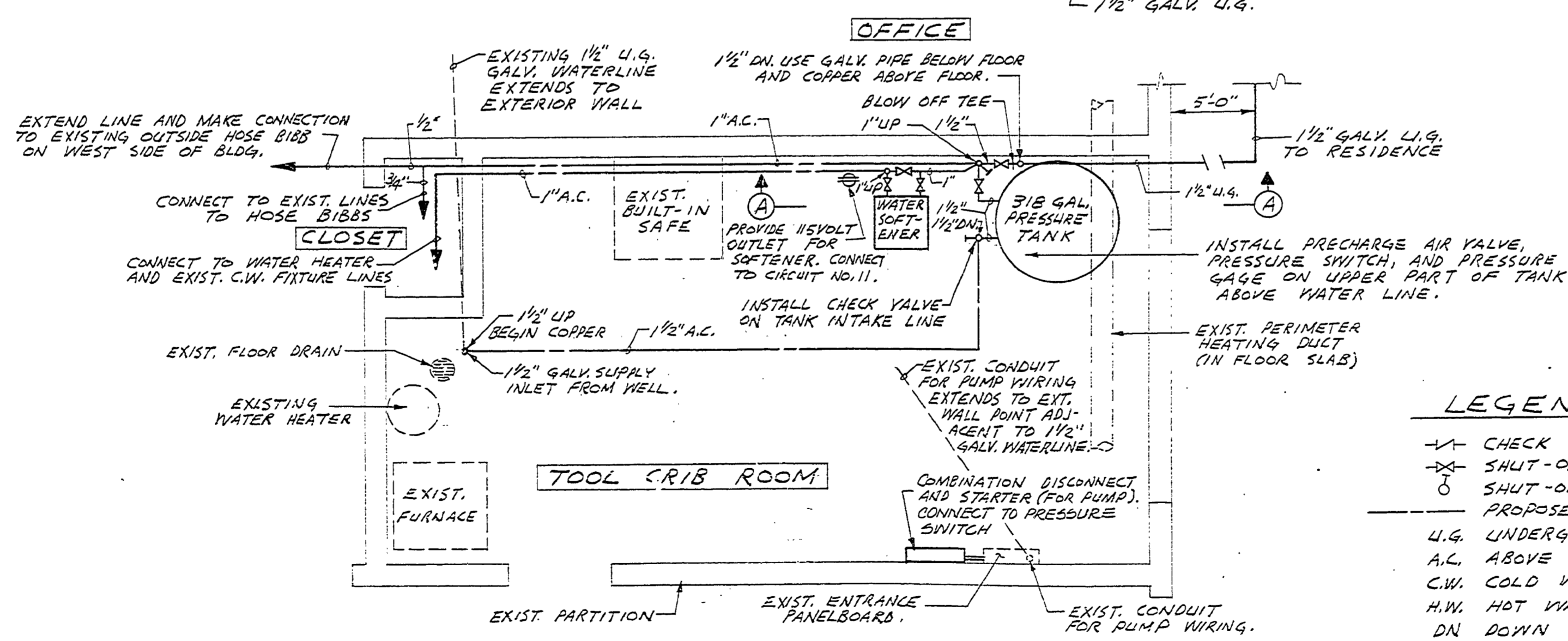

DETAIL OF TOOL CRIB ROOM

- LEGEND**
- V- CHECK VALVE
  - X- SHUT-OFF VALVE
  - o SHUT-OFF VALVE
  - PROPOSED WATERLINE
  - U.G. UNDERGROUND
  - A.C. ABOVE CEILING
  - C.W. COLD WATER
  - H.W. HOT WATER
  - DN DOWN
  - PROPOSED EQUIPMENT
  - EXISTING EQUIPMENT

BUILDING COMMITTEE APPROVAL	
BY: _____	DATE: _____
RECOMMENDED FOR APPROVAL: <i>W. J. ...</i> 1-27-76	
ENGINEERING OR ARCHITECTURAL SUPERVISOR DATE	
RECOMMENDED FOR APPROVAL: _____	
PROGRAM AND PLAN COORDINATOR DATE	
DIVISION/REGION APPROVAL	
BY: <i>O. S. ...</i> 11-27-76	DATE: _____
DIVISION CHIEF/REGIONAL MANAGER	
ENGINEERING DIVISION	
APPROVED: <i>William C. ...</i> 1-27-76	DATE: _____
CHIEF ENGINEER	

SURVEYED BY	DRAWN BY B. Boyce	1-76	NO. DATE BY	REVISIONS	NO. DATE BY	REVISIONS	MICHIGAN DEPARTMENT OF NATURAL RESOURCES	PLAN SHEET SHEET TITLE	SLEEPY HOLLOW STATE PARK AREA OR PARK	PROJECT NO. 24-1559
DESIGNED BY R. Hoeusler	1-76	CHECKED BY	1.		3.				WATER SYSTEM AT PARK HEADQUARTERS PROJECT	SHEET 1 OF 1 PLAN NO. E-105