

SLEEPY HOLLOW STATE PARK

CONSTRUCTION PLANS FOR

BITUMINOUS SURFACING OF EXISTING CAMPGROUND

PROJECT No. 24-2897

Scale: 1" = 500'

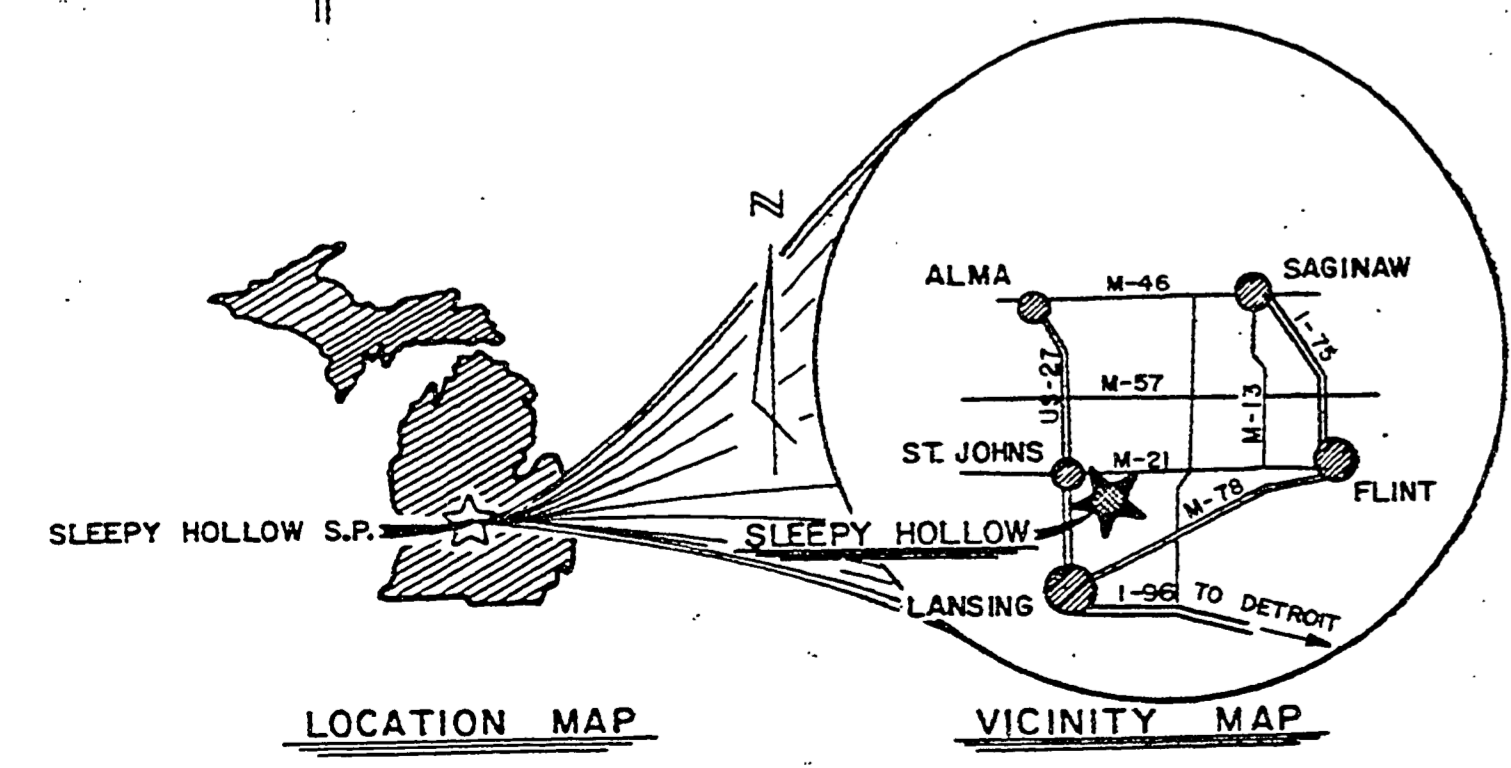
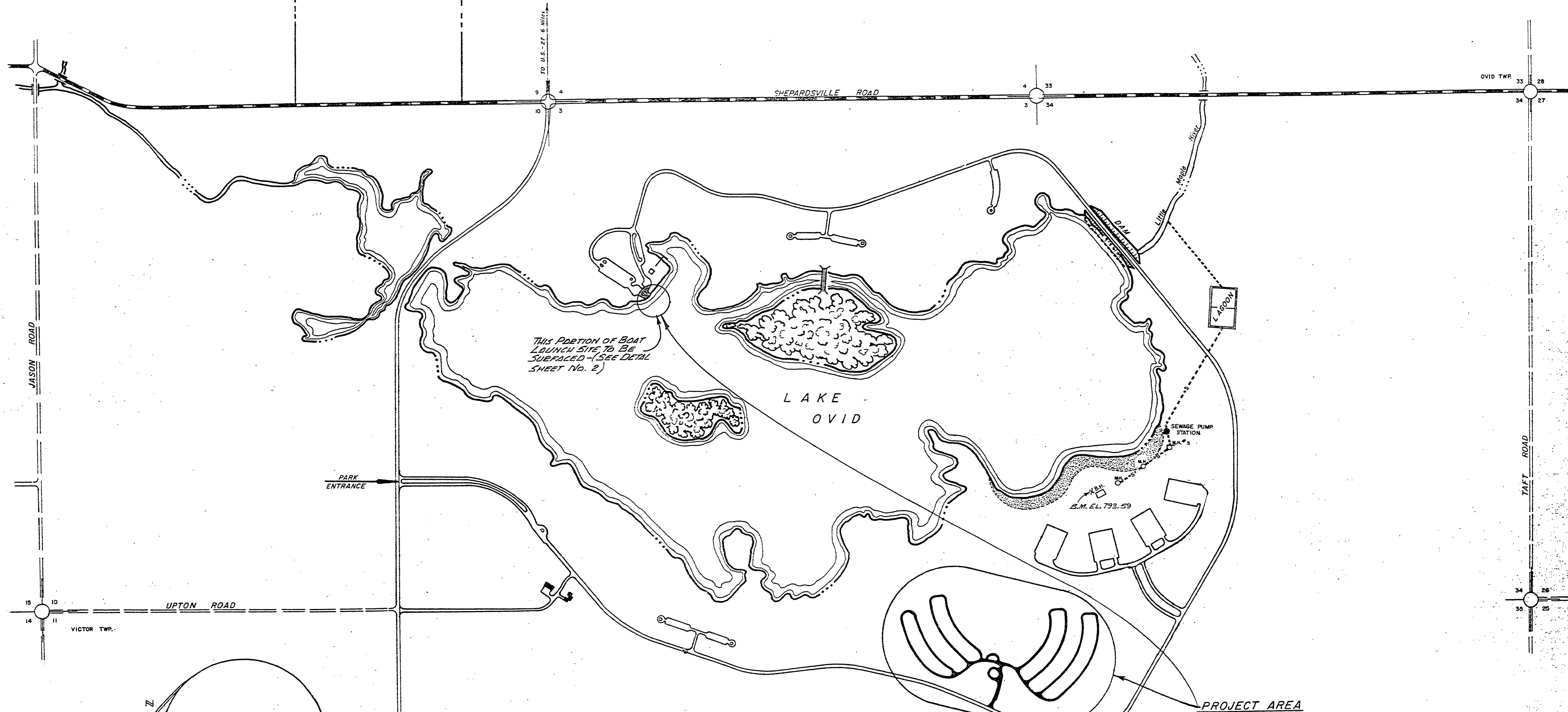

BUILDING COMMITTEE APPROVAL	
BY: _____	DATE: _____
RECOMMENDED FOR APPROVAL	
BY: <i>John Nelson</i> 4-8-88	
RECOMMENDED FOR APPROVAL	
BY: <i>Jack Butterfield</i> 4-8-88	
APPROVED FOR: <i>John Nelson</i> 4-8-88	

SURVEYED BY	DRAWN BY	NO.	DATE	BY	REVISIONS	NO.	DATE	BY	REVISIONS	MICHIGAN DEPARTMENT OF NATURAL RESOURCES	COVER SHEET SHEET TITLE	SLEEPY HOLLOW S.P. AREA OR PARK BITUMINOUS SURFACING PROJECT OF EXISTING CAMPGROUND	PROJECT NO. 24-2897
DESIGNED BY A. EGRES	36	1.	10-7-81	JL	As BUILT	3.							SHEET 1 OF 2 PLAN NO. E-116
DATE	DATE	2.				4.							