

CURVE DATA #1

Δ = 9° 01' 59" Lt.
 D = 10° 17' 10"
 R = 557.02'
 T = 44'
 L = 27.82'
 E = 1.74'
 P.C. = 14+53.24
 P.T. = 15+02.24
 P.T. = 15+46.06

CURVE DATA #3

Δ = 53° 27' 26"
 D = 38° 11' 50"
 R = 150'
 T = 75.54'
 L = 139.95'
 E = 17.95'
 P.C. = 108+49.69
 P.T. = 109+25.23
 P.T. = 109+89.64 = 120. P.T. #1 = 427+22'

CURVE DATA #2

Δ = 38° Lt.
 D = 52° 05' 14"
 R = 110'
 T = 57.88'
 L = 72.95'
 E = 6.34'
 P.C. = 105+32.95
 P.T. = 105+70.23
 P.T. = 106+08.30 BK = 106+08.11 AHD.

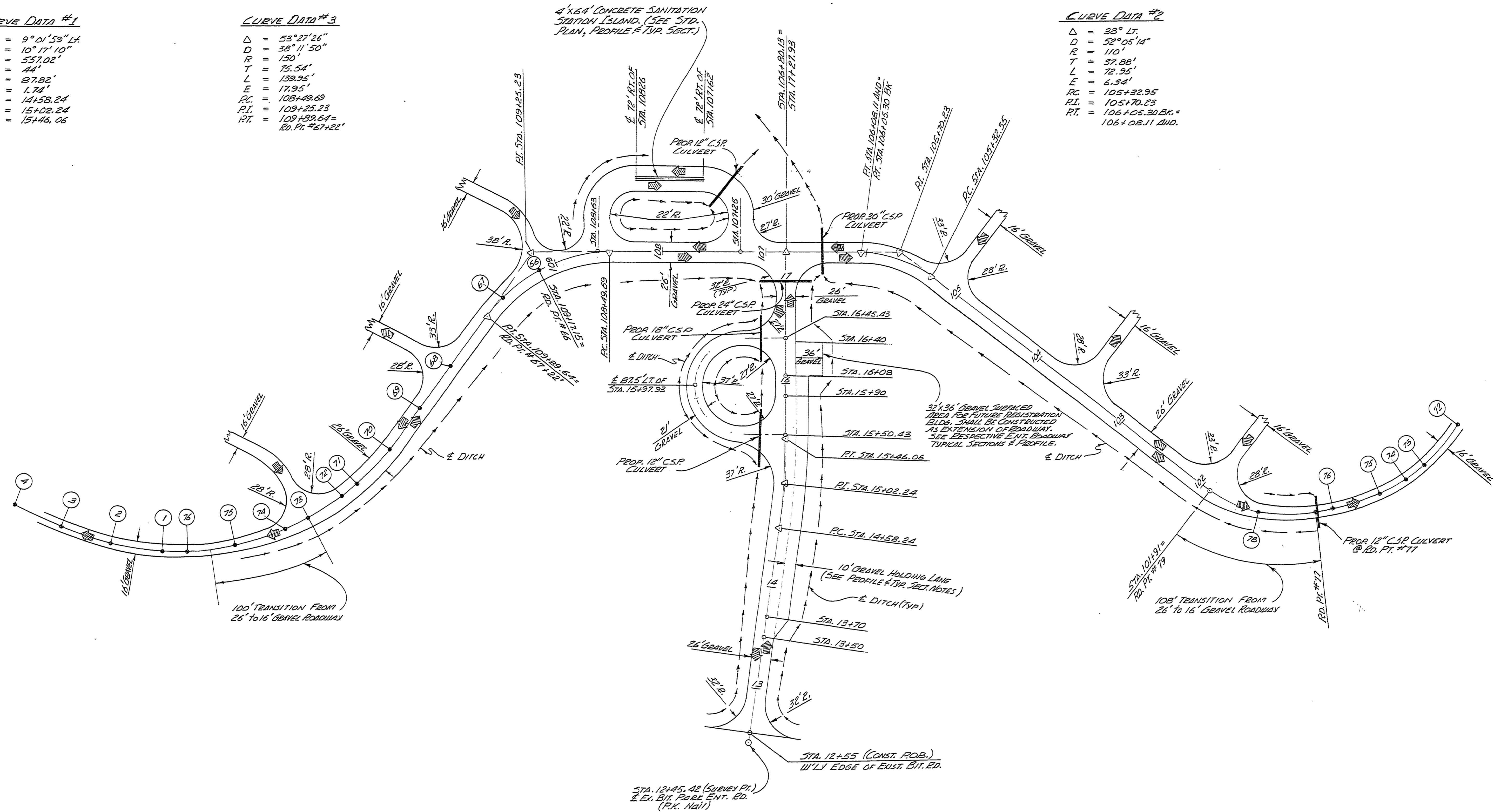

NOTE:
 SEE THE FOLLOWING SHEETS FOR ADDITIONAL INFORMATION:
 TYPICAL SECTIONS, EX. CONTOURS & GENERAL LAYOUT, PROFILES,
 & CAMPSOUND ROADWAY & POINT LOCATIONS.

Scale: 1"=50'

SURVEYED BY		DRAWN BY <i>LEMMON</i>		NO. DATE BY		REVISIONS		NO. DATE BY		REVISIONS		MICHIGAN DEPARTMENT OF NATURAL RESOURCES		ALIGNMENT-ENTRANCE ROADWAY & ROADWAY TO CAMPSOUNDS		SLEEPY HOLLOW S.P. AREA OR PARK		PROJECT NO. 2A-2587	
DESIGNED BY <i>A. EGRES</i>		11-86 CHECKED BY		1.				3.				SHEET 6 OF 13		PLAN NO. E-115		PROJECT CAMPSOUND DEVELOPMENT			
DATE		DATE		2.				4.											