

**CURVE TA**  
 Δ = 26°12'30"  
 D = 11°30'  
 R = 498.22'  
 T = 115.96'  
 L = 227.90'  
 E = 13.32'  
 PC = 105+29.02  
 PI = 106+45.00  
 PT = 107+56.92  
 LC = 225.92'

B.M. #21 ELEV. 802.77  
 PK. NUT. TAG S.W. COR.  
 24" OAK, 113' ET. OF STA. 109+28

B.M. #22 ELEV. 795.20  
 PK. NUT. TAG N.E. COR. OF  
 20" OAK, 50' ET. OF STA. 119+65

**CURVE TB**  
 Δ = 37°37'30"  
 D = 11°30'  
 R = 498.22'  
 T = 169.73'  
 L = 327.17'  
 E = 28.12'  
 PC = 117+63.72  
 PI = 119+33.45  
 PT = 120+90.89

PI # 7B IRON PIPE  
 N75°W, 45.49', 20" OAK PK. NUT. TAG (B.M. 22)  
 S64°E, 148.60', 18" CHEROKEE SPIKE

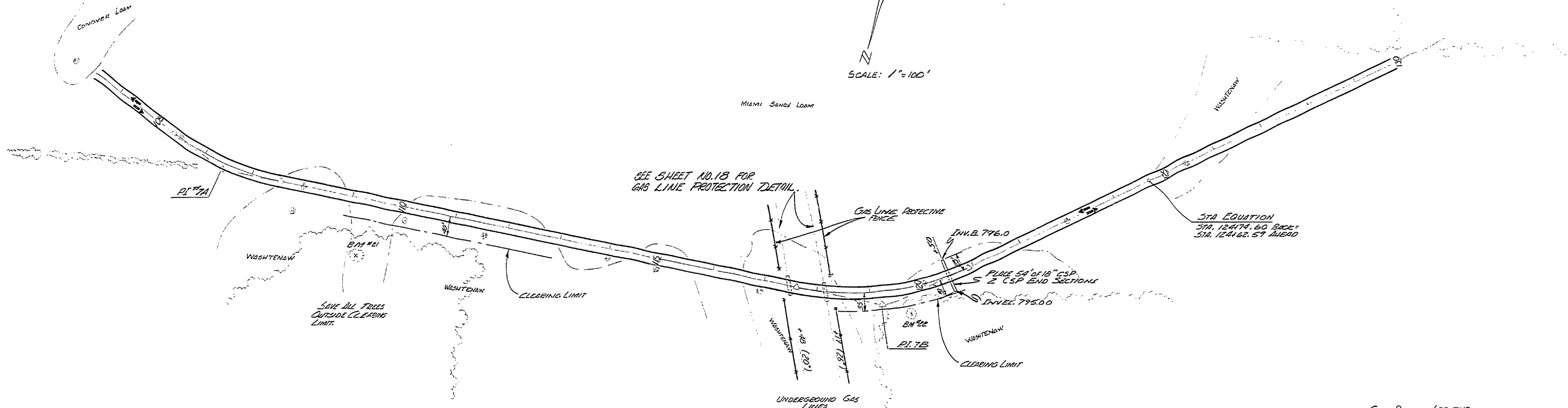
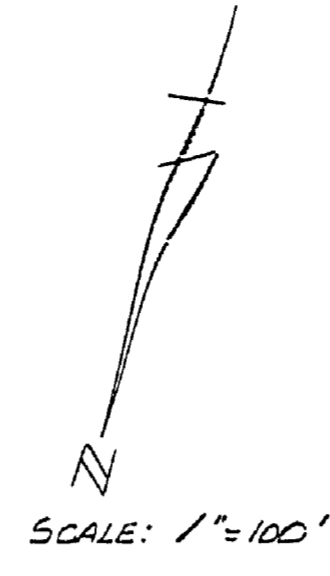

**SOIL BORING LEGEND**  
 (00+00) STATION LOCATION OF BORING  
 (0-0) DEPTH OF SOIL  
 ● = TEST BORING

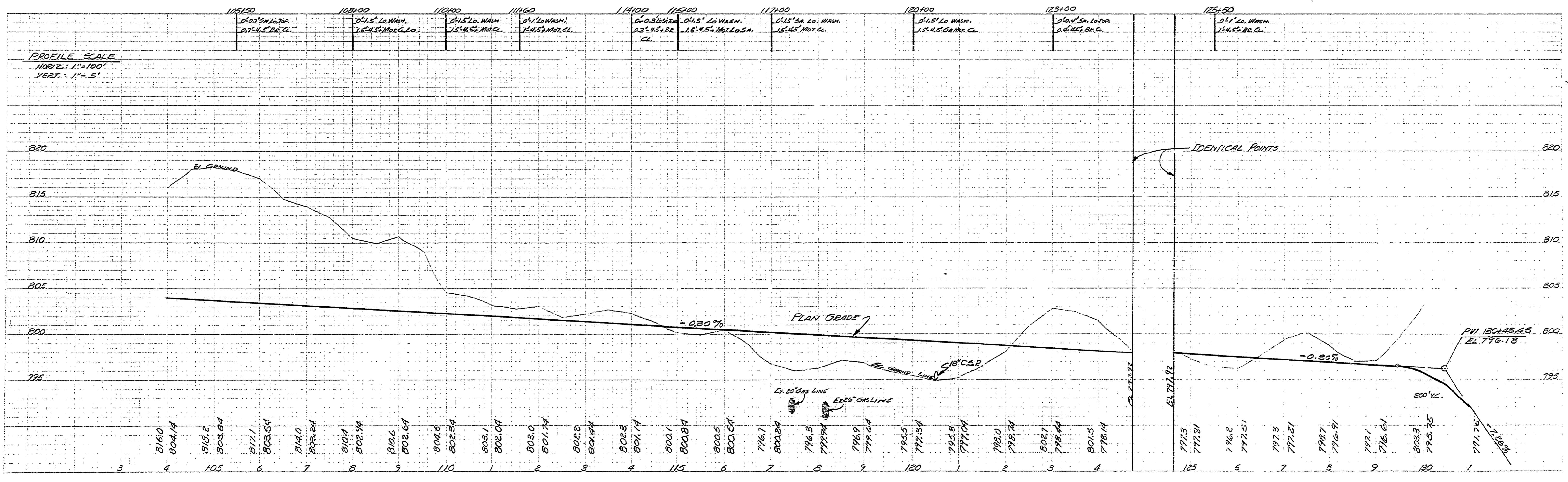

SURVEYED BY <i>D. BESELL</i>	DRAWN BY <i>LEMMON</i>	12-73	NO.	DATE	BY	REVISIONS	NO.	DATE	BY	REVISIONS	MICHIGAN DEPARTMENT OF NATURAL RESOURCES	ENTRANCE ROAD PLAN & PROFILE	SHEET NO. <u>7</u> OF <u>25</u> FOR PROJECT NO. <u>21-945-40</u>	SLEEPY HOLLOW STATE PARK SHEET <u>7</u> OF <u>25</u> PLAN NO. <u>E-101</u>
DESIGNED BY <i>E. HAEUSLER</i>	CHECKED BY	DATE	1.				3.							
			2.				4.							