

NOTES:

CAMPGROUND TO BE PLANTED WITH WHITE PINE SEEDLINGS. ALL TREES TO BE HANDSOME PLANTED 8'-10' ON CENTERS. DO NOT PLANT IN ROWS. PLANT TO ACHIEVE AREAS AND SHAPES AS INDICATED ON PLAN. (1600 TREES)
GRAVEL ROAD TO FOLLOW THE EXISTING TRAIL FROM OLD FARM. 4'-6" COMPACTED, 15' WIDE.
CAMPGROUND TO BE LOCATED ON THE OLD BURNING FARM.

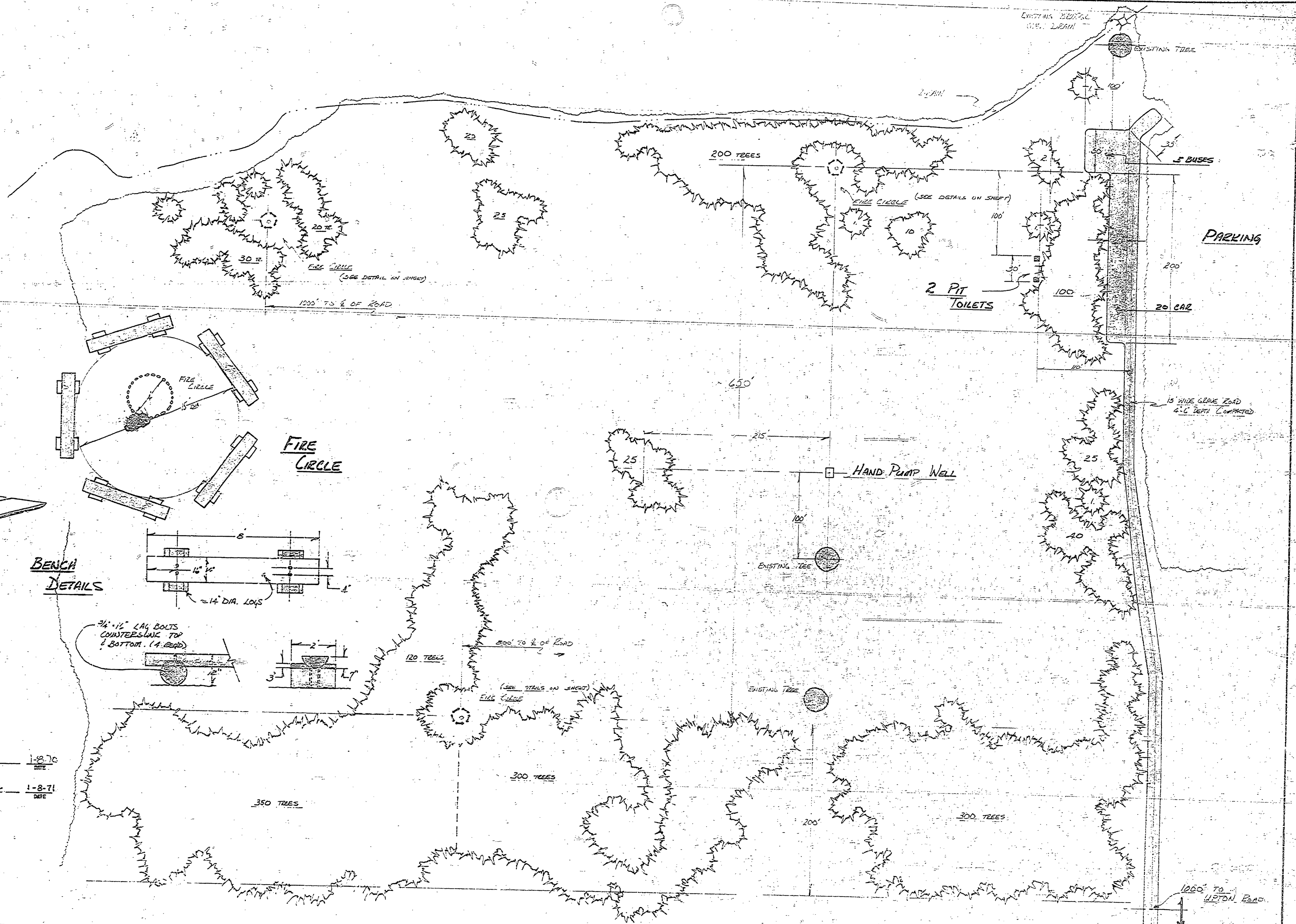

REVIEWED BY: *Jim Mace* 1-8-70
 APPROVED BY: *Paul R. Proulx* 1-8-71
ACTING CHIEF, PARK DIVISION

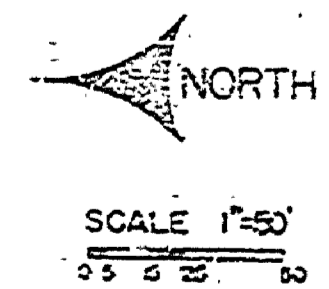

SURVEYED BY	DESIGNED BY R. C. WHITENER	12-70	NO.	DATE	BY	REVISIONS	NO.	DATE	BY	REVISIONS	MICHIGAN DEPARTMENT OF NATURAL RESOURCES	SLEEPY HOLLOW STATE PARK	AREA OR PARK	ORGANIZATION	CAMPGROUND
	12-70	CHECKED BY R. G. H. & L. C. M.	12-15-70	1.			3.					SHEET TITLE	PROJECT	SHEET 1 OF 1	PLAN NO. L-102