

CONCEPTUAL PLANTING PLAN FOR SWIMMING BEACH COMPLEX

General Notes:
 Detailed planting plans shall be required when final plans for beachhouse are completed. The cost for curbing around parking lot planting islands are not included in landscaping budget.
 All plant material shall be staked or exact locations approved by landscape architect. No changes in plant material species will be made unless approved by landscape architect.

REVIEWED BY: James Hone 5/22/74 DATE
 IN CHARGE - PLANNING AND DESIGN

APPROVED BY: _____ DATE
 CHIEF - PARKS DIVISION

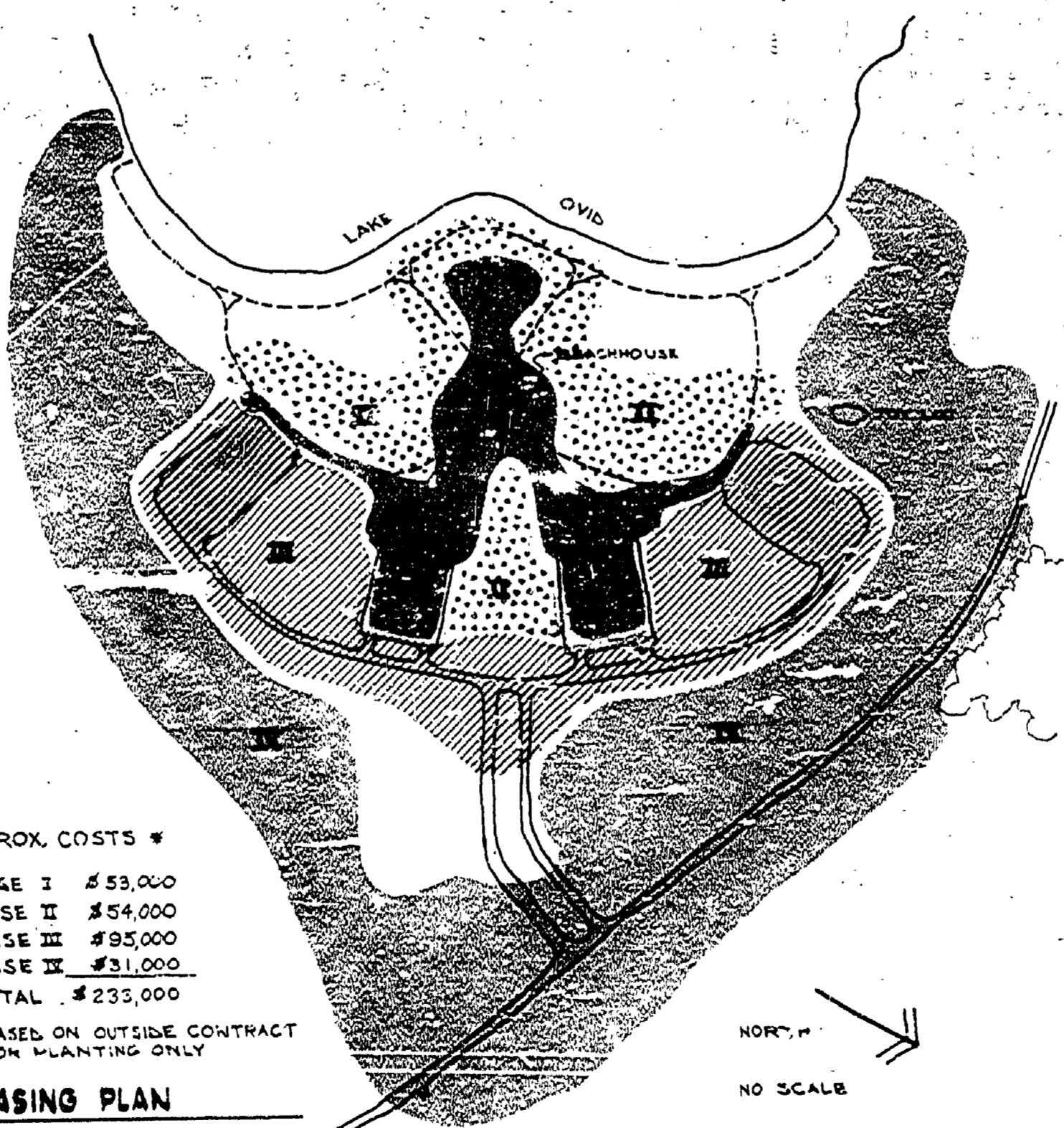
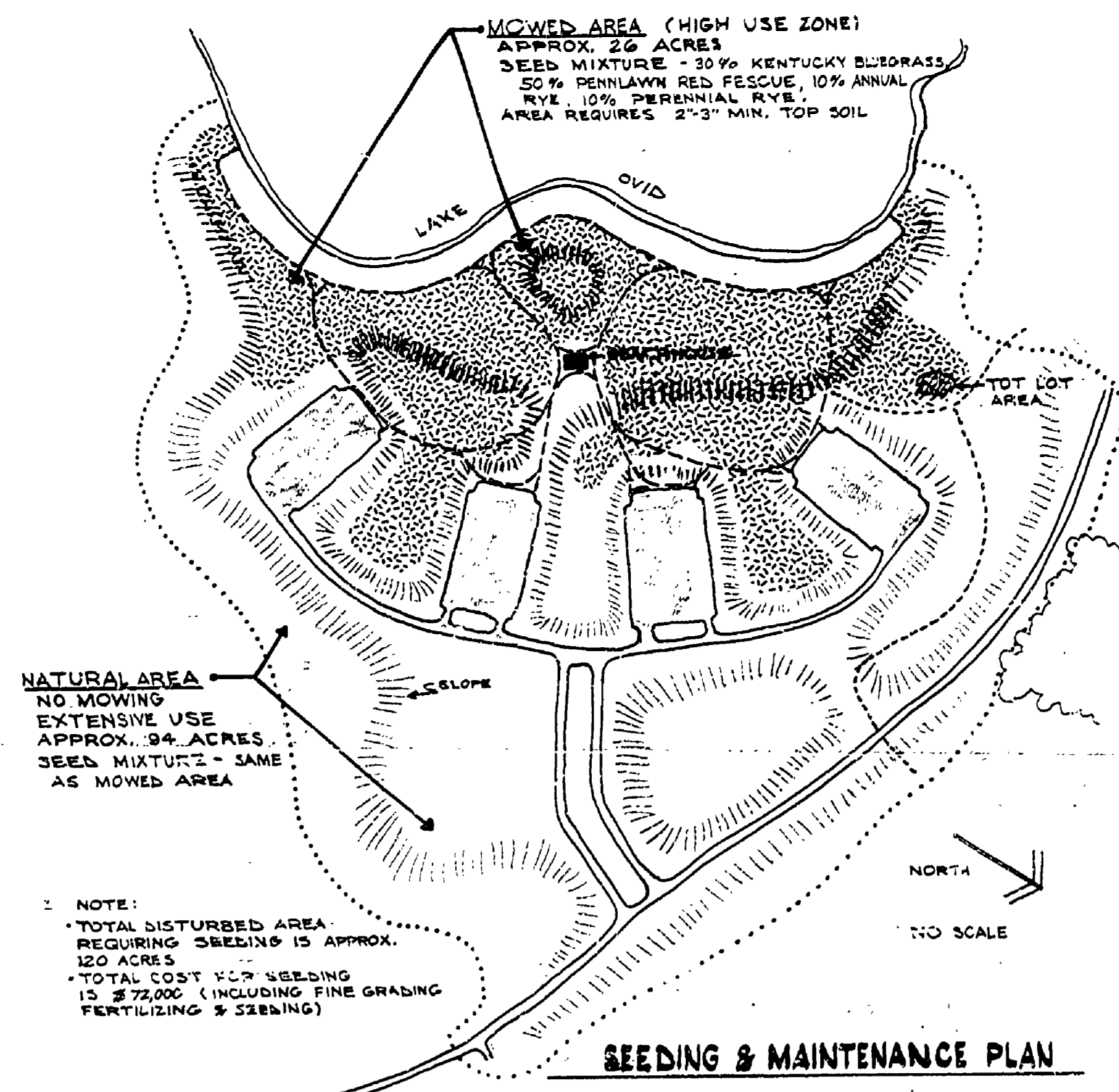

PLANT LIST FOR TOTAL PROJECT

QUANTITY	BOTANICAL NAME	COMMON NAME	SIZE	ROOT	REMARKS
Evergreen Trees					
135	<i>Picea abies</i>	Norway Spruce	4'-6' ht*	B + B	
36	<i>Picea glauca</i>	White Spruce	5'-7' ht*	B + B	
263	<i>Pinus strobus</i>	White Pine	5'-7' ht*	B + B	
Deciduous Trees					
126	<i>Acer rubrum</i>	Red Maple	2"-4" cal*	B + B	
190	<i>A. saccharum</i>	Sugar Maple	2"-4" cal*	B + B	42 shall be 3"-3 1/2" cal. for end parking lot isl.
310	<i>A. saccharum</i>	Sugar Maple	seedlings	B.R.	50' o.c. w/white Poplar
300	<i>Carya ovata</i>	Shagbark Hickory	seedlings	B.R.	50' o.c. w/white Poplar
177	<i>Fraxinus pennsylvanica lanceolata</i>	Green Ash	2"-4" cal*	B + B	
100	<i>F. americana</i>	White Ash	2 1/2"-3" cal	B + B	
62	<i>F. americana</i>	White Ash	3 1/2"-4" cal	B + B	specimen - for parking lot islands
150	<i>F. americana</i>	White Ash	seedlings	B.R.	50' o.c. w/white Poplar
7	<i>Gleditsia triacanthos moraine</i>	Moraine Honeylocust	3 1/2"-4" cal	B + B	
11,300	<i>Populus alba</i>	White Poplar	seedlings	B.R.	Approx. 45 acres 13' o.c.
60	<i>Quercus alba</i>	White Oak	2"-4" cal*	B + B	
138	<i>Q. rubra</i>	Red Oak	2"-4" cal*	B + B	
8	<i>Tilia cordata</i>	Little Leaf Linden	3 1/2"-4" cal	B + B	
Deciduous Shrubs					
371	<i>Calyanthos floridus</i>	Sweetbush	4'-5' ht.	B.R.	
10,400	<i>Rhus aromatica</i>	Fragrant Sumac	seedlings	B.R.	5' o.c. approx. 6 acres
2,400	<i>R. aromatica</i>	Fragrant Sumac	18"-24" ht.	B.R.	3' o.c. polygamodioecious
83	<i>Viburnum dentatum</i>	Arrowwood	4'-5' ht.	B.R.	
19,000	<i>V. opulus 'Nanna'</i>	Dwarf European Cranberry	12"-15" ht.	B.R.	
Ground Cover					
	<i>Coronilla varia</i>	Crownvetch	seed		Approx. 5700 s.y.

* 1/3 of total plants shall be within 1 foot (when height is given) or 1 inch (when caliper is given) of the largest size.

LEGEND

EXISTING TREES		PROPOSED DECIDUOUS SHRUBS	
PROPOSED DECIDUOUS TREES (30'-50' O.C.)		SWEETBUSH (8' O.C.)	
MIX DECIDUOUS (20% GREEN & WHITE ASH - 40% OAK & SUGAR MAPLE - 20% RED & WHITE)		ARROWWOOD (10' O.C.)	
WHITE ASH		DWARF EUROPEAN CRANBERRY BUSH (2' O.C.)	
MORAIN HONEY LOCUST		FRAGRANT SUMAC (3' O.C.)	
LITTLE LEAF LINDEN		GROUND COVER (CROWNVETCH SEED)	
PROPOSED EVERGREEN TREES (18"-20' O.C.)		WHITE POPLAR SEEDLING & HARDWOOD SEEDLING AREA (20% WHITE ASH - 40% SUGAR MAPLE - 20% SHAGBARK HICKORY)	 APPROX. 45 ACRES
WHITE PINE		FRAGRANT SUMAC SEEDLING AREA	 APPROX. 6 ACRES
NORWAY SPRUCE		SHEET MATCH CORNERS	 3/6 4/7
WHITE SPRUCE			

SURVEYED BY		DRAWN BY O.L. MITTON		MAY 18, 74		NO. DATE BY REVISIONS		NO. DATE BY REVISIONS		MICHIGAN DEPARTMENT OF NATURAL RESOURCES		PLANTING PLAN SHEET TITLE		AREA OR PARK SLEEPY HOLLOW STATE PARK		PROJECT NO.	
DESIGNED BY O.L. MITTON		CHECKED BY		MAY 15, 74		1. DATE		3. DATE		PROJECT SWIMMING BEACH DEVELOPMENT		SHEET 1 OF 7		PLAN NO. L-110			