

REVISIONS  
 NO. DATE BY  
 1 10/17/49 D.A.M. CHECKED BY SUBSTITUTED FOR G.M. 4  
 2 11/1/49 J.H.C. 5  
 3 11/1/49 J.H.C. 6  
 APPROVED BY DATE  
 L.E.L. 11/1/49  
 ASSISTANT CHIEF IN CHARGE  
 REVIEWED BY SECTIONS DATE  
 ARCHITECTURAL 11/1/49  
 ENGINEERING 11/1/49  
 LANDSCAPE 11/1/49  
 DRAWN BY L.E.L. 11/1/49  
 TRACED BY L.E.L. 11/1/49  
 CHECKED BY J.H.C. 11/1/49  
 DATE Nov. 2, 1949

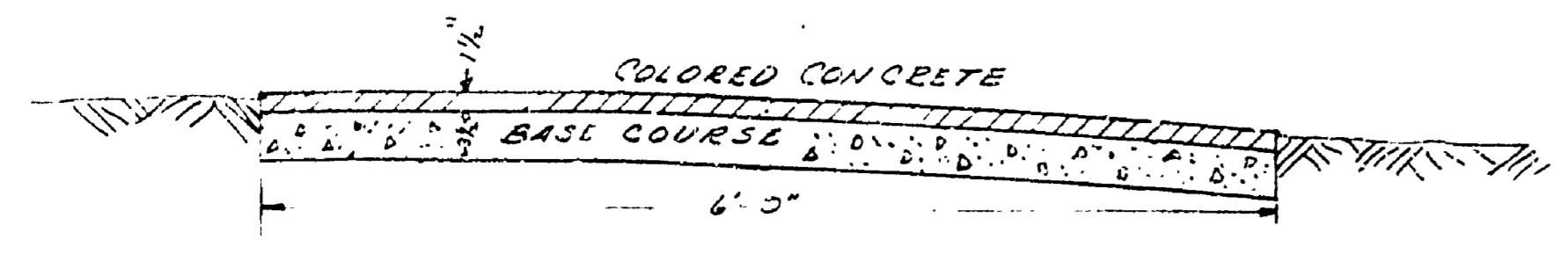

TILTED SECTION  
 USE 3/4" SCREEN AS CONSTRUCTED  
 FOR CROWN SECTION.

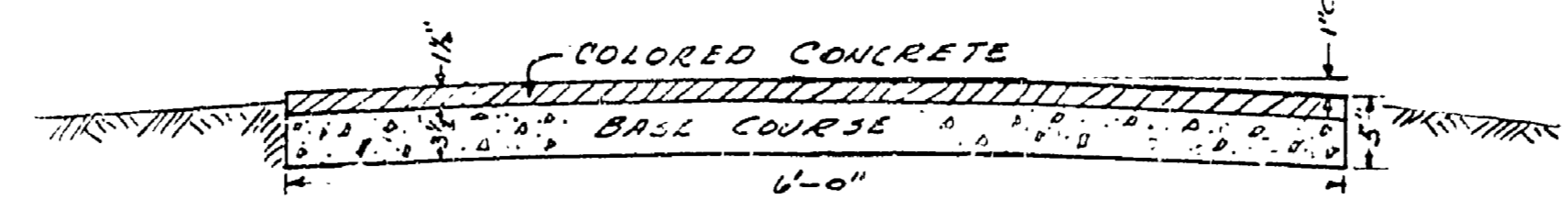

CROWN SECTION

NORTH WALK			SOUTH WALK		
STA.	HUB	CUT or FILL	STA.	HUB	CUT or FILL
0+25	L-12	C-0.25 0.15	0+00	R-10'	C-0.65
0+50	R-5'	C-1.3	0+25	R-10'	C-1.10
0+75	R-8'	C-0.7 0.8'	0+50	L-14'	F-0.9
1+00	R-10'	C-1.1 1.6'	0+75	L-8'	F-0.5
1+25	R-10'	C-0.3	1+00	L-9'	GRADE F.O. 2'
1+50	R-12'	C-0.3 0.2'	1+25	L-10'	C-0.6 0.5'
1+75	R-12'	C-0.2	1+51	L-5'	C-0.7 0.4'
2+00	R-12'	C-0.3	1+75	L-11'	C-0.4 GRADE
2+25	R-12'	GRADE F.O. 2'	1+90	L-12'	C-0.4 0.2'
2+50	R-12'	C-0.1	2+00	L-13'	GRADE F.O. 1'
2+75	R-15'	C-0.1	2+10	L-14'	C-1.3 1.1'
3+00	R-11'	C-0.1	2+20	L-10'	F-0.8 0.4'
3+25	R-8'	GRADE	2+30	L-8'	F-0.8 0.6'
3+50	R-10'	GRADE			
3+75	R-10'	MULTI GRADE			

NOTE: ABOVE CUTS OR FILLS REFER TO CENTER  
 LINE GRADES OF WALK ABOVE OR BELOW  
 HUB STAKES. FORMS ON CROWN SECTION  
 ARE TO BE SET 0.1 FOOT BELOW THE  
 @ GRADE. FORMS ON THE TILTED SECTIONS  
 SHOULD BE SET 0.1' BELOW ON THE  
 LOW SIDE AND 0.1' ABOVE ON THE  
 HIGH SIDE

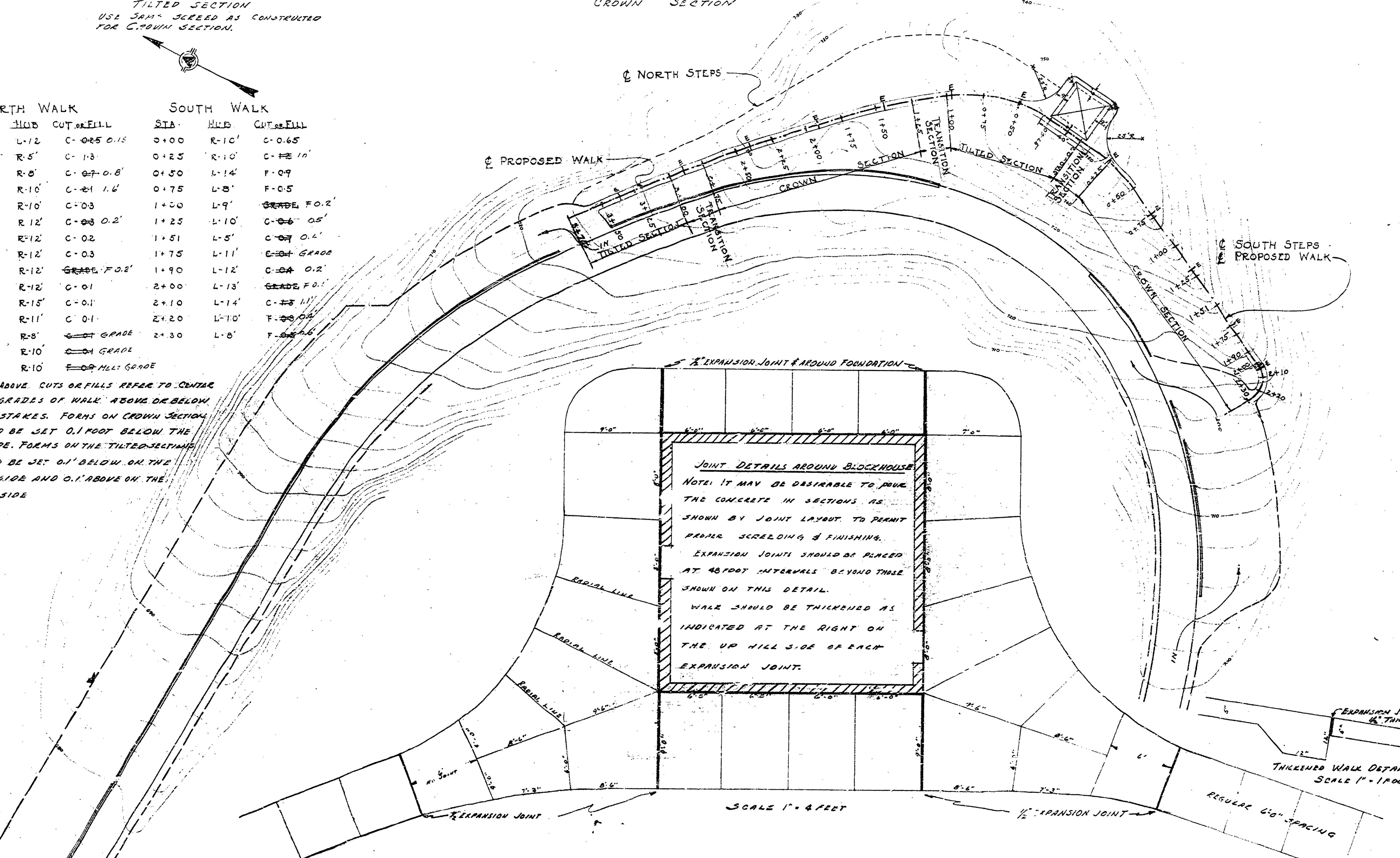

JOINT DETAILS AROUND BLOCKHOUSE  
 NOTE: IT MAY BE DESIRABLE TO PAVE  
 THE CONCRETE IN SECTIONS AS  
 SHOWN BY JOINT LAYOUT TO PERMIT  
 PROPER SCREENING & FINISHING.  
 EXPANSION JOINTS SHOULD BE PLACED  
 AT 48 FOOT INTERVALS BEYOND THOSE  
 SHOWN ON THIS DETAIL.  
 WALK SHOULD BE THICKENED AS  
 INDICATED AT THE RIGHT ON  
 THE UP HILL SIDE OF EACH  
 EXPANSION JOINT.

