

DRAWN BY: R. HARRY & J. YANNA 12-67	REVIEWED BY SECTIONS		DATE	APPROVED BY	NO. DATE	BY
	ARCHITECTURAL	ENGINEERING	LANDSCAPE	ASSISTANT CHIEF IN CHARGE	1	
CHECKED BY				OF DESIGN	2	
DATE				DATE	3	

BENCH MARK DATA

B.M.#11 ELEV. 585.04
 T10N, R17W, Sec. 28, N. Side Channel On Back Edge Of
 Esplanade, Corps. Of Engrs. Sta 21, Rt. Of E. Rd. Sta 74+37
 At Joint, A Chiseled □.

B.M.#12 ELEV. 585.11
 T10N, R17W, Sec. 28, From P.O.B. Campground Baseline, N 88°W,
 44.3', 6" Jack Pine, W. Side, P.K. Nail, N. of, f. B.M. Tag.

WITNESSES TO ROB. BASELINE 3/4" IR
 S43°W, 49.10', 13" Jack Pine, Blaze f Spike
 N 76°W, 4.45', 10" Jack Pine, Blaze f Spike
 S 80°E, 58.25', 13" Jack Pine, Blaze f Spike
 N 80°W, 44.3', 6" Jack Pine, (B.M.#12)

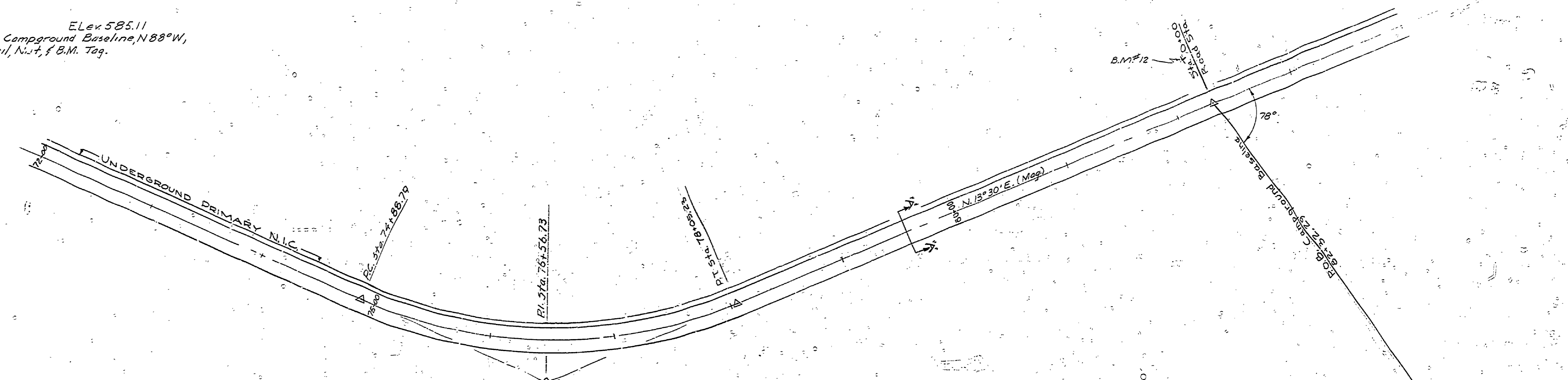

CURVE DATA
 Δ = 47° 28' 1"
 D = 154'
 Z = 381.97'
 T = 167.94'
 L = 315.44'
 P.I. = 55.23'
 P.T. = 76+56.73
 P.C. = 74+88.79
 P.T. = 78+05.23
 Rate of Superelevation is 0.04 Per Ft.

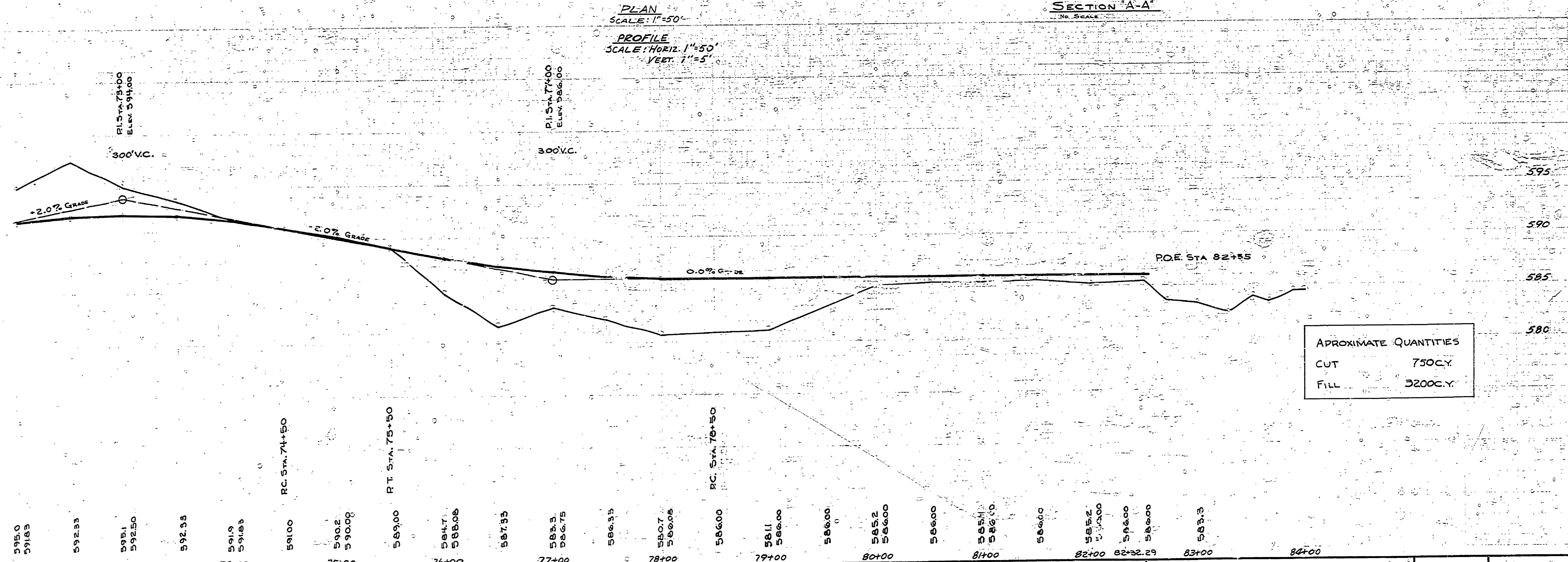
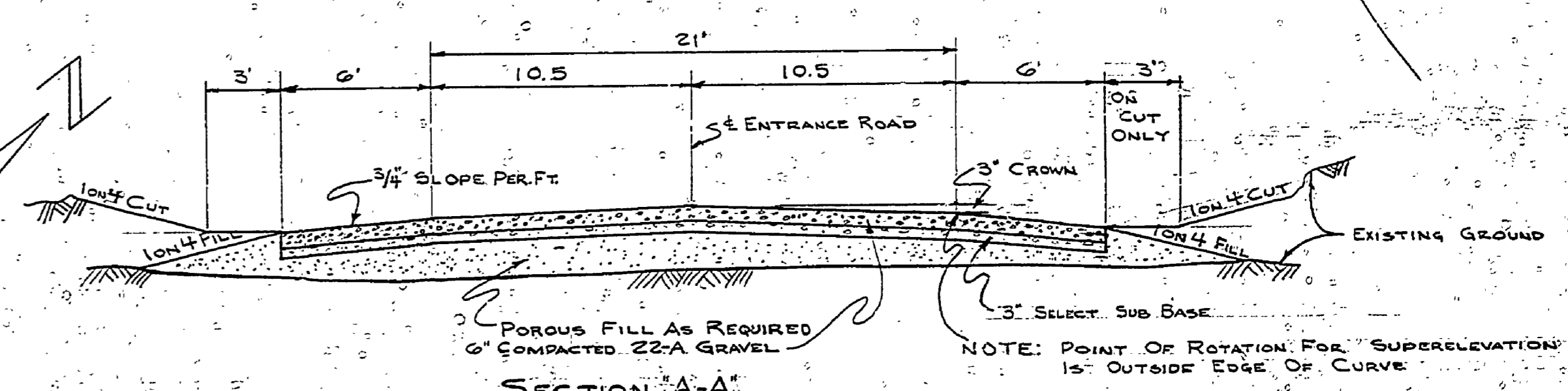

APPROXIMATE QUANTITIES	
CUT	750CY
FILL	3200CY