

NOTE:
 ITEMS MARKED (RIC) ARE NOT INCLUDED IN CONTRACT FOR DEVELOPMENT, I.E. EARTH FORMS, RETAINING WALLS AND DIRT.
 THESE ITEMS CAN BE BUILT AND CONSTRUCTED BY PARK STAFF AS TIME AND MONEY ALLOW DURING OFF SEASON PERIODS.
 RETAINING WALL CAN BE EITHER RAIL-ROAD TIES OR 2 x 10" ATTACHED TO STAKES. MATRIS NEXT TO BUILDING SHOULD BE PLANTED WITH GRASS COVER MATERIAL SO THAT EROSION WILL NOT BE REQUIRED.
 IF ASSISTANCE IS REQUIRED CONTACT DEVELOPMENT PLANNING SECTION, DIVISION OFFICE, LANSING.

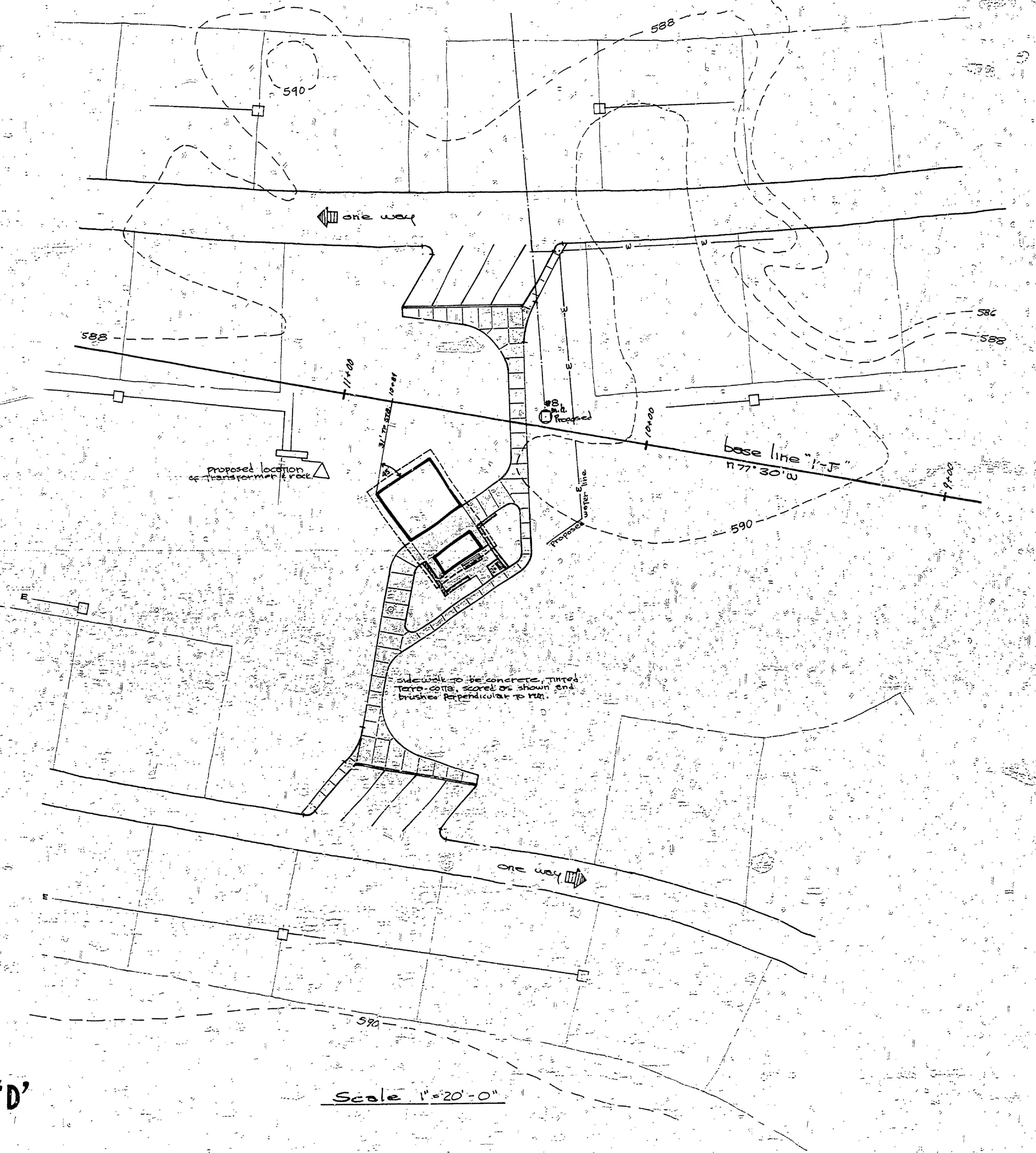

TOILET & SHOWER BUILDING 'D'

Scale 1"=10'-0"



Scale 1"=20'-0"

SURVEYED BY		DRAWN BY <i>D. Daniel Brown</i>		2-25-70	NO.	DATE	BY	REVISIONS		NO.		DATE	BY	REVISIONS		MICHIGAN DEPARTMENT OF NATURAL RESOURCES	HOFFMASTER S. P.	AREA OR PARK WEST UNIT	PROJECT NO.
DESIGNED BY <i>D. Daniel Brown</i>		2-5-70	CHECKED BY <i>Z.G.H.</i>	2-26-70	1.					3.						DEPARTMENT OF NATURAL RESOURCES	HOFFMASTER S. P.	Taylor & shower building "d"	SHEET 3 OF 3
DATE		DATE	DATE	DATE	DATE	DATE	DATE	DATE	DATE	DATE	DATE	DATE	DATE	DATE	DATE	DEPARTMENT OF NATURAL RESOURCES	HOFFMASTER S. P.	Taylor & shower building "d"	PLAN NO. L-105