

DATE BY	
REVISIONS	
NO. DATE BY	
1	
2	
3	
4	
5	
6	
APPROVED BY	
DATE	
REVIEWED BY SECTIONS	
ARCHITECTURAL	
ENGINEERING	
LANDSCAPE	
DRAWN BY	
TRACED BY	
CHECKED BY	
DATE	

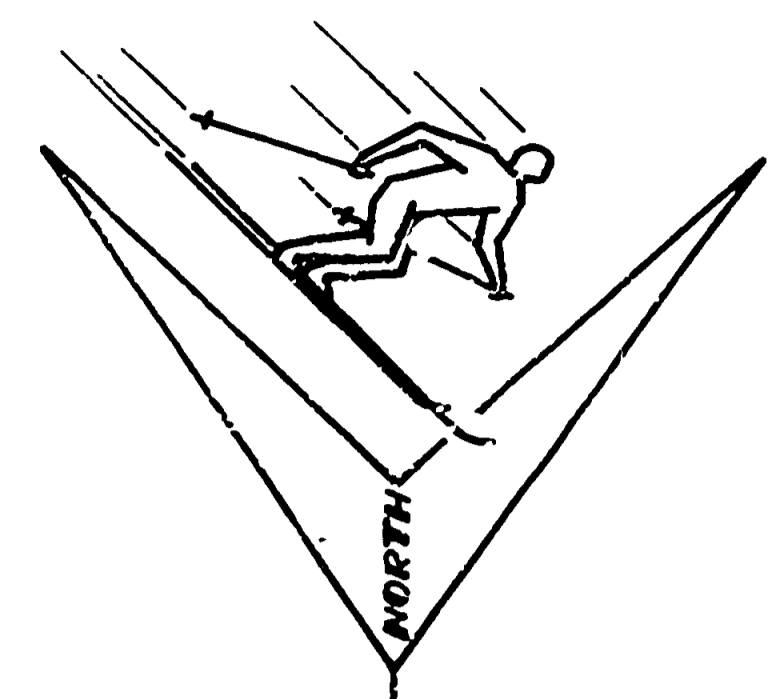

BUILDING KEY

1. SKI SHELTER BLDG.
2. ENTRANCE CONTROL BLDG.
3. T-BAR TOW POWER BLDG.
4. T-BAR TOW CONTROL BLDG.
5. T-BAR TOW TERMINAL BLDG.
6. ROPE TOW POWER BLDG.
7. WATER STORAGE TANK
8. SEPTIC TANKS AND DISPOSAL FIELD

LEGEND

- DOUBLE T-BAR SKI LIFT
- ROPE TOW SKI LIFT
- SKI TRAILS
- LOGGING ROADS
- WATER LINE
- POWER LINE
- BUILDINGS
- SPRINGS

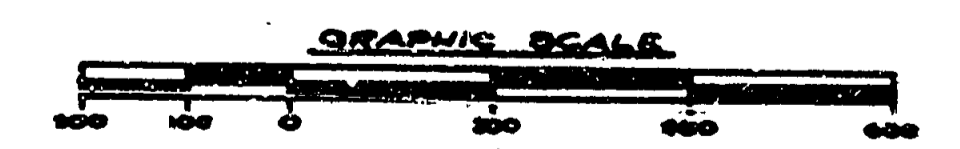
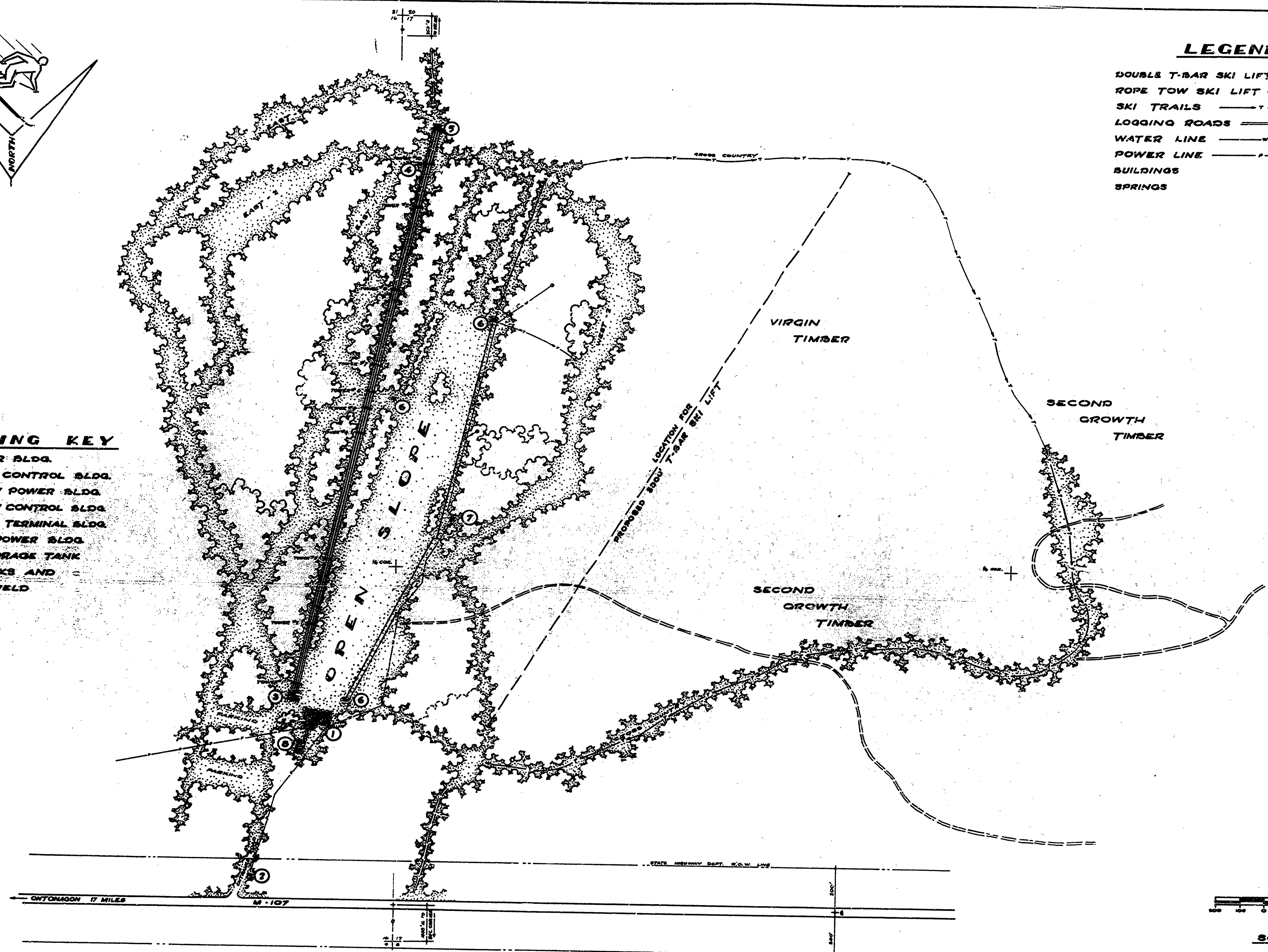

SCALE 1" = 200'

FIELD SURVEY AND ORIGINAL DRAWING BY J. CALABRO

MICHIGAN DEPARTMENT OF CONSERVATION PARKS AND RECREATION DIVISION

PORCUPINE MTS. STATE PARK SKI AREA DEVELOPEMENT

SHEET NO. 2 OF 2 PLAN NO. L-105A