

REVISIONS	NO.	DATE	BY
	4		
	5		
	6		

REVIEWED BY SECTIONS	DATE	APPROVED BY
ARCHITECTURAL	J.R.R. 7-27-51	J.R.P.
ENGINEERING	J.R.R. 7-27-51	
LANDSCAPE	J.R.R. 7-27-51	

DESIGNED BY	DATE	OF DESIGN
J.R.P.	7-27-51	

TRACED BY	DATE
J.W.F.	

CHECKED BY	DATE
J.R.P.	

APPROVED BY	DATE	IN CHARGE
J.R.P.	7-27-51	

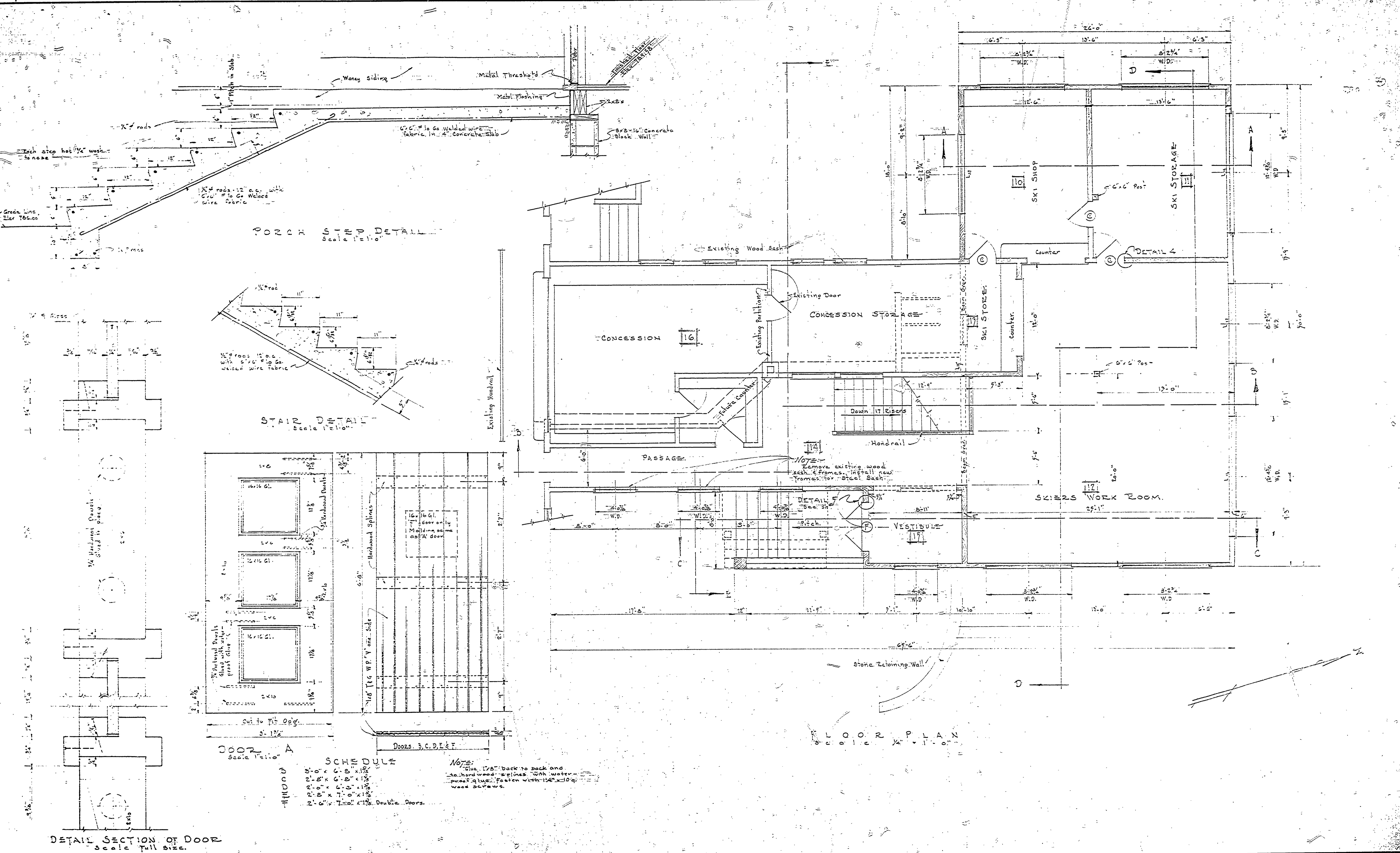

MICHIGAN
DEPARTMENT OF CONSERVATION
PARKS AND RECREATION DIVISION

PORCUPINE MOUNTAINS STATE PARK
WARMING HOUSE
TOILET & SKI SHOP ADDITION

SHEET NO. 2 OF
PLAN NO. A106b