

REVISIONS	NO.	DATE	BY
1	1		
2	2		
3	3		
4	4		
5	5		
6	6		

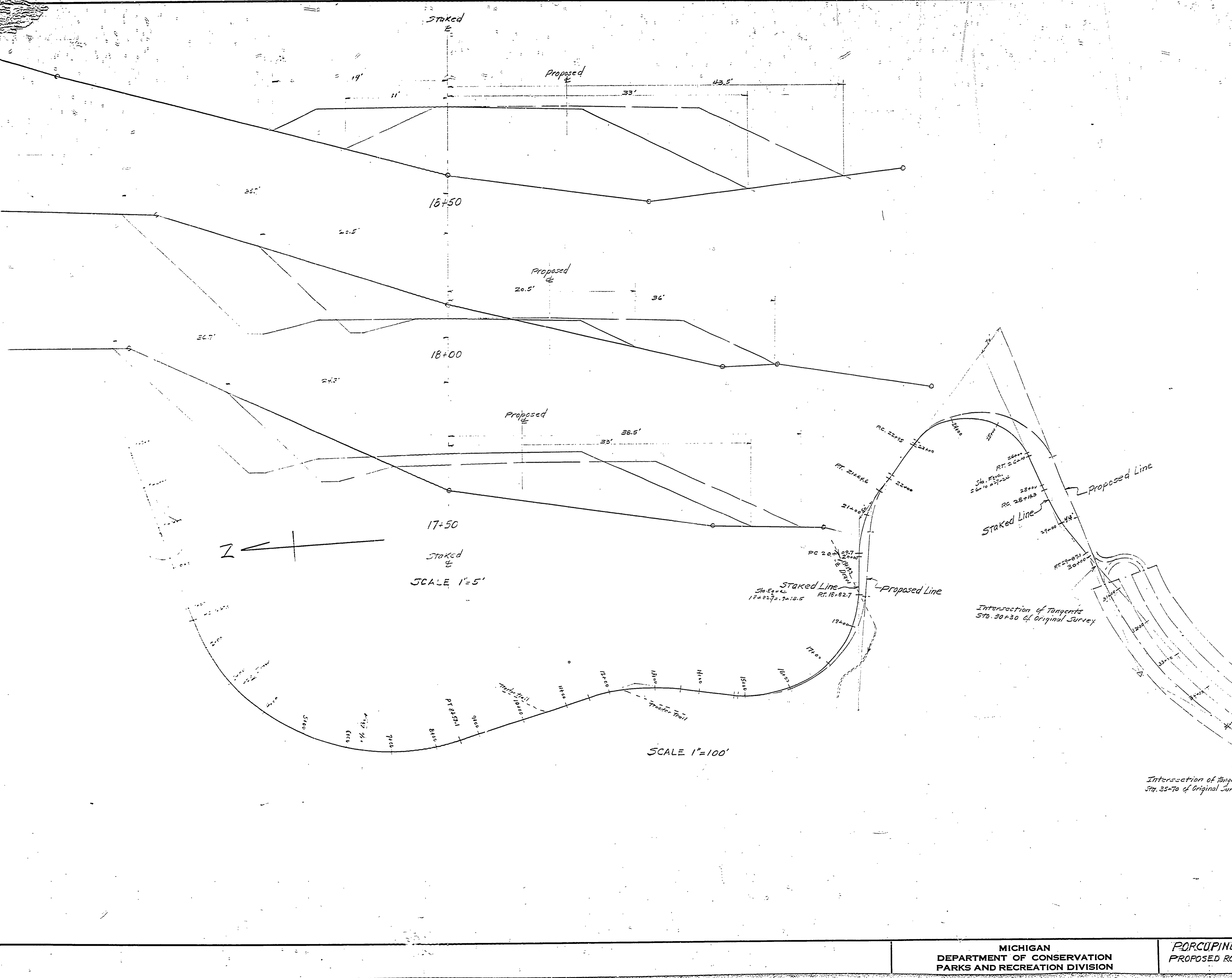

Station on Proposed Line	Station on Staked Line	Cut	Fill
0+00		F0.8	
0+27		F5.2	
0+50		F5.2	
1+00		C1.6	
2+00		C2.0	
3+00		F8.6	
3+28		F9.7	
4+00		C0.6	
5+00		F0.6	
6+00		F3.5	
6+40		F6.8	
7+00		C1.6	
8+00		F2.1	
9+00		C2.1	
10+00		C0.5	
11+00		F1.6	
12+00		F2.2	
13+00		F3.7	
14+00		F2.2	
15+00		C0.6	
16+00	3'R	C0.9	C1.0
17+00	7'R	F2.5	F2.0
17+50	2'R	F3.9	F4.0
18+00	11'R	C1.7	F1.0
18+50	13'R	F3.0	F12.0
19+50	13'R	F14.0	F13.0
20+00	20'R	F6.0	F5.0'
20+30	20'R	C1.0	C2.5
21+00	14'R	C2.5	C2.5
21+65	3'R	F2.5	F2.0
22+00		F7.0	F6.0
23+00		F8.0	F9.0
24+00	16'L	F6.0	F3.0
25+00	35'L	F2.0	C0.0
26+00	37'L	C1.5	C2.0
28+00	42'L	C1.0	C2.0
29+00	37'L	F1.5	F1.5
30+00	11'R	C0.0	C0.0
31+00	21'R	C1.0	C1.0
32+00	24'R	C1.5	F1.0
33+00	44'R	F2.5	F2.5
34+00	27'R	F3.0	F3.0
35+00	20'R	C0.0	F0.5
36+00	15'L	C0.5	C0.0
End of Parking			
36+00			

MICHIGAN  
DEPARTMENT OF CONSERVATION  
PARKS AND RECREATION DIVISION

PORCUPINE MTS. STATE PARK  
PROPOSED ROAD TO ESCARPMENT LOOKOUT  
SCALE - AS SHOWN

SHEET  
NO. 1  
OF 5

PLAN NO.  
E-106