

NO.	DATE	BY	REVISIONS	
			NO.	DATE
1			4	
2			5	
3			6	

P.I. Sta. 89+55.3 - 1/2" Iron Pipe  
 S 80°W - 29.5' - 6" Hemlock  
 S 20°W - 33.5' - 8" Hemlock  
 Δ: 45°-26' R  
 D: 11°-00'  
 R: 521.67'  
 E: 43.9'  
 L: 413.0'  
 T: 218.4'  
 PC: 87+36.1  
 PI: 89+55.3  
 PT: 91+49.9  
 Superlevate 0.035' Per Ft.  
 Rotate 10° L. Of C.

P.I. Sta. 97+48.1 - Boat Spike  
 N 41°W - 60.7' - 11" Basswood  
 N 11°W - 61.2' - 8" Hemlock  
 N 61°E - 41.0' - 5" Hemlock  
 Δ: 12°-02' L  
 D: 2°-00'  
 R: 2864.93'  
 E: 15.9'  
 L: 601.7'  
 T: 302.0'  
 PC: 94+46.1  
 PI: 97+48.1  
 PT: 100+47.8  
 Superlevate 0.035' Per Ft.  
 Rotate 10° R. Of C.

P.I. Sta. 109+73.9 - 1/2" Stake  
 S 23°E - 56.8' - 6" Maple  
 S 5°W - 48.4' - 5" Hemlock  
 S 69°W - 46.7' - 12" Maple  
 Δ: 15°-43'-30" R  
 D: 6°-00'  
 R: 955.37'  
 E: 9.1'  
 L: 262.1'  
 T: 131.9'  
 PC: 108+42.0  
 PI: 109+73.9  
 PT: 111+04.1  
 Superlevate 0.035' Per Ft.  
 Rotate 10° L. Of C.

P.I. Sta. 115+85.5 - Boat Spike  
 N 21°W - 79.8' - 8" Maple  
 N 25°E - 49.0' - 6" Maple  
 N 74°E - 24.6' - 12" Stump  
 Δ: 20°-20' L  
 D: 6°-00'  
 R: 955.37'  
 E: 15.2'  
 L: 338.9'  
 T: 171.3'  
 PC: 114+14.2  
 PI: 115+85.5  
 PT: 117+53.1  
 Superlevate 0.035' Per Ft.  
 Rotate 10° R. Of C.

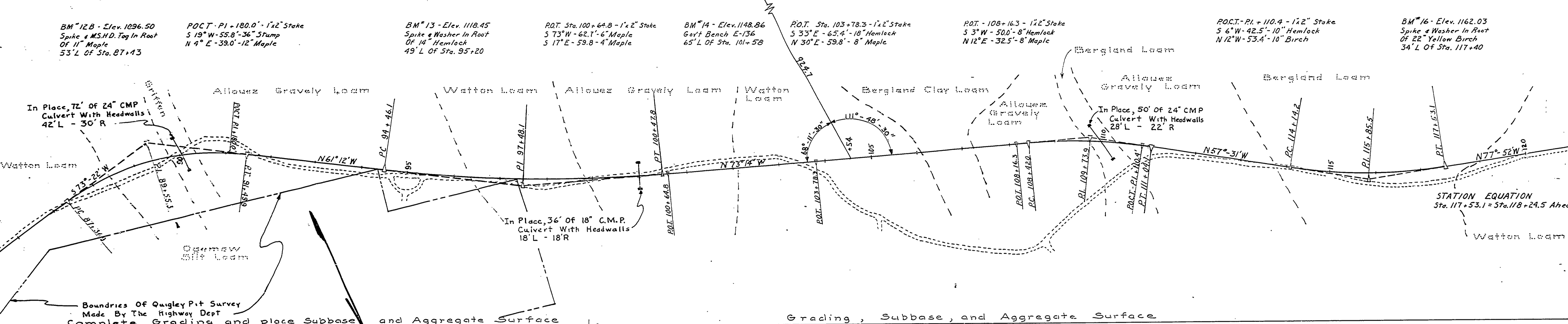

Fill Section 1 on 3 Slopes 15' B.B. Ditch 15' Below Shoulder  
 Fill Section 1 on 4 Slopes 15' B.B. Ditch 15' Below Shoulder  
 Fill Section 1 on 4 Slopes 15' B.B. Ditch 15' Below Shoulder  
 Fill Section 1 on 2 Slopes 15' B.B. Ditch 15' Below Shoulder  
 Fill Section 1 on 4 Slopes 15' B.B. Ditch 15' Below Shoulder

