

BM#90, Elev. 1071.23
 PC Nail & Tag in NE
 Root of 12" Maple
 67' Lt. of Sta 730+52

Curve Data
 Δ: 23°00'30" Rt.
 D: 3°00'
 P: 1143.23'
 T: 254.22'
 L: 500.17'
 E: 278.1'
 PC Sta. 723+36.0
 PI Sta. 730+90.2
 PT Sta. 733+36.2
 Superelevate 0.03'/ft.

BM#91, Elev. 1021.74
 PC Nail & Tag in N.E.
 Root of 13" Hemlock
 68' Lt. of Sta 737+55

Curve Data
 Δ: 9°08'00" Rt.
 D: 2°00'
 P: 2864.93'
 T: 228.8'
 L: 456.7'
 E: 91.1'
 PC Sta. 737+47.45
 PI Sta. 739+76.25
 PT Sta. 742+04.1
 Superelevate 0.02'/ft.

BM#92, Elev. 1012.07
 PC Nail & Tag in E.
 Root of 10" Hemlock
 68' Lt. of Sta 743+61

POT Sta. 752+50.2
 1" Pipe
 N 32° E 105.80' 10" Hemlock
 N 85° E 65.88' 3" Maple
 S 03° W 91.00' 14" Hemlock
 BM#93, Elev. 984.64
 PC Nail & Tag in SE
 Root of 14" Hemlock
 60' Lt. of Sta 751+81
 BM#94, Elev. 965.04
 PC Nail & Tag in W
 Root of 10" Hemlock
 64' Lt. of Sta 758+66

Curve Data
 Δ: 22°57'0" Lt.
 D: 3°00'
 P: 1146.23'
 T: 338.0'
 L: 628.0'
 E: 190.7'
 PC Sta. 758+84.2
 PI Sta. 759+23.2
 PT Sta. 762+43.2

Const. Curve Data
 Δ: 23°00'30" Rt.
 D: 3°00'
 P: 1143.23'
 T: 254.22'
 L: 500.17'
 E: 278.1'
 PC Sta. 723+36.0
 PI Sta. 730+90.2
 PT Sta. 733+36.2
 Superelevate 0.03'/ft.

S.P. NO.	STATE	PROJ. NO.	FISCAL YEAR	SHEET NO.	TOTAL SHEETS
4	MICH.	51040(6)			
ROUTE	STATE	COUNTY	TOWNSHIP	SHEET NO.	TOTAL SHEETS
FF5	66-55	Ontonagon	Carleton Place	6	

Geogebic County
 Wakefield Twp.
 T.50N., R.45W.

Not Part of this Contract.
 Grade & Surface Approach
 104 cyds. Emb.
 52 tons C.I. Pipe
 36' of 18" C.I. Culv. (CMP)
 10 cyds. Plain Rip Rap

48' of 24" C.I. Culv. (CMP)
 14 cyds. Plain Rip Rap
 Dig Inlet Ditch, 10 cyds. Exc.
 Not Part of this Contract.

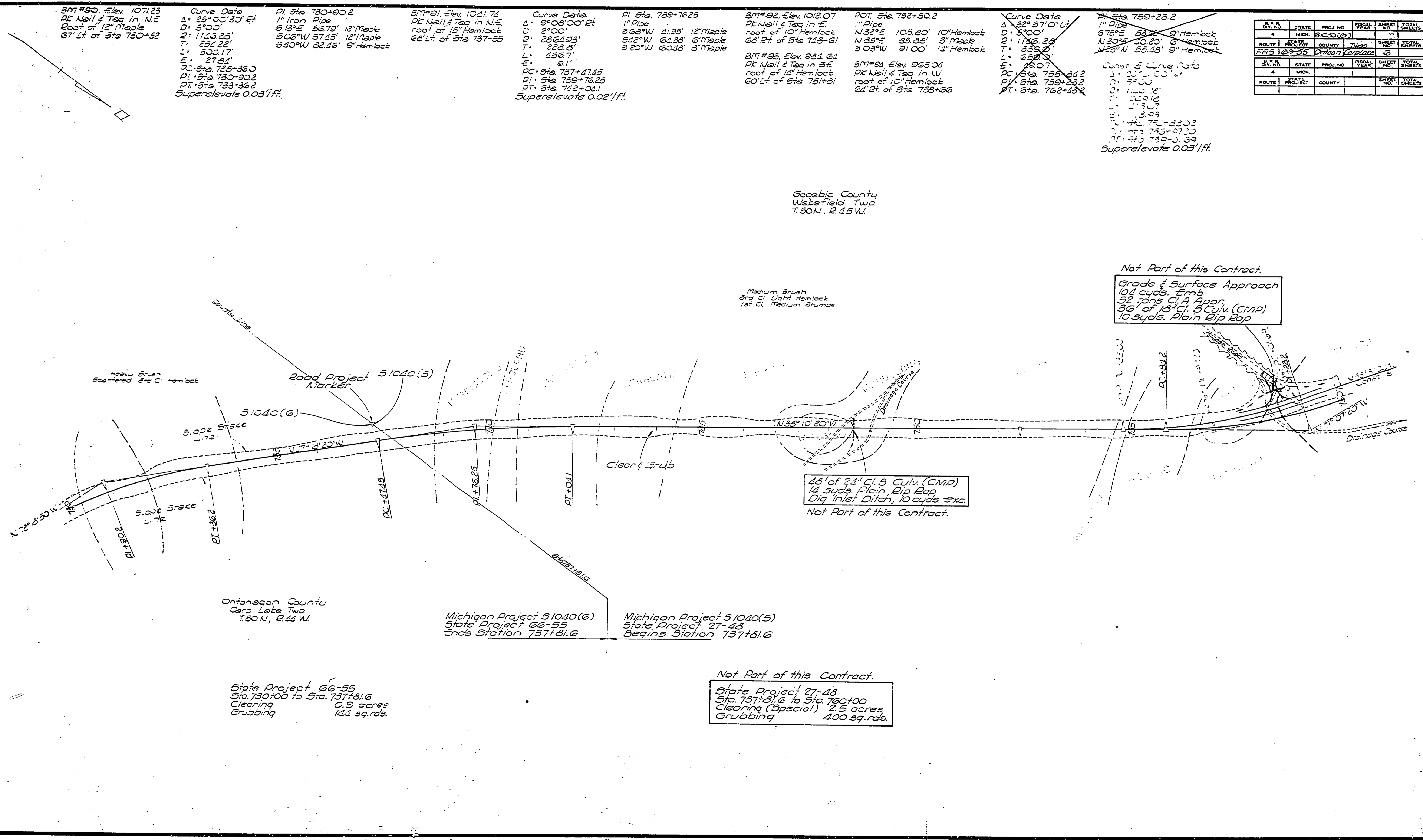

Ontonagon County
 Carp Lake Twp.
 T.50N., R.44W.

Michigan Project 51040(6)
 State Project 66-55
 Ends Station 737+81.6

Michigan Project 51040(5)
 State Project 27-48
 Begins Station 737+81.6

State Project 66-55
 Sta. 730+00 to Sta. 737+81.6
 Clearing 0.9 acres
 Grubbing 143 sq. rds.

Not Part of this Contract.
 State Project 27-48
 Sta. 737+81.6 to Sta. 760+00
 Clearing (Special) 2.5 acres
 Grubbing 400 sq. rds.