

| DATE | REVIEWED | DATE | APPROVED | DATE | NO. | DATE | BY | REVISIONS |
|---------|---------------|---------|-------------|------|-----|------|----|-----------|
| June 62 | ARCHITECTURAL | June 62 | [Signature] | 1 | 1 | 1 | | 1 |
| June 62 | ENGINEERING | June 62 | [Signature] | 2 | 2 | 2 | | 2 |
| | LANDSCAPE | | | 3 | 3 | 3 | | 3 |

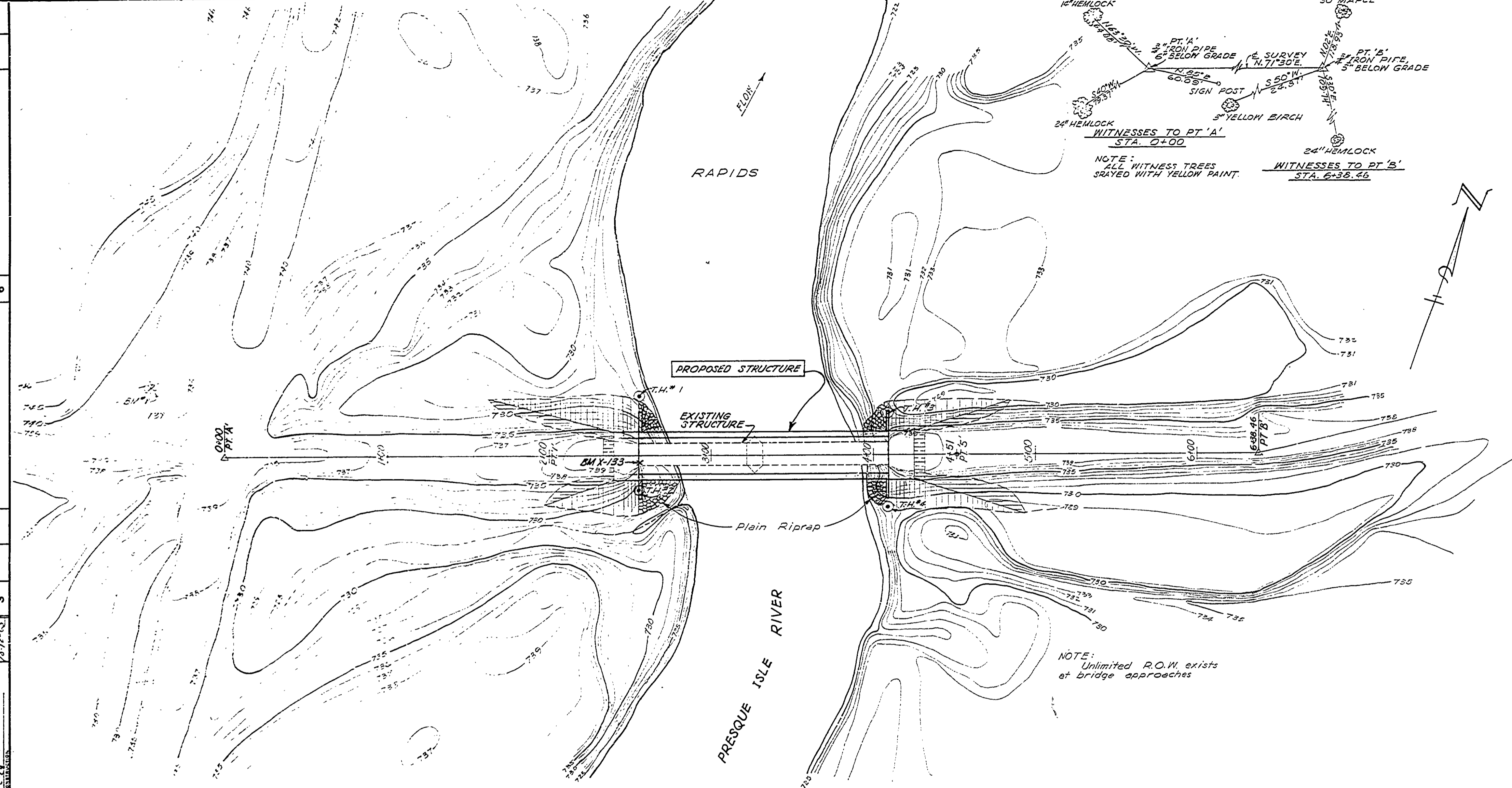

LOG OF BORINGS

| T.H.# | DEPTH (ft) | SOIL TYPE |
|--------|------------|----------------------------------|
| T.H.#1 | 726.3 | TOPSOIL |
| | 726.1 | FINE SAND WITH CLAY, LOOSE ROCKS |
| | 722.3 | SOLID ROCK |
| T.H.#2 | 728.5 | TOPSOIL |
| | 728.3 | FINE SAND WITH CLAY, LOOSE ROCKS |
| | 724.8 | SOLID ROCK |
| T.H.#3 | 730.2 | TOPSOIL |
| | 730.0 | FINE SAND WITH CLAY, LOOSE ROCKS |
| | 726.7 | SOLID ROCK |
| T.H.#4 | 728.2 | TOPSOIL |
| | 728.0 | FINE SAND WITH CLAY, LOOSE ROCKS |
| | 726.6 | SOLID ROCK |

BENCH MARKS

| | |
|---|---------------|
| B.M. X133(USC#GS) | Elev. 739.264 |
| Gogebic Co. Stamped X-133 1943. Set in top of the S. end of the N. abutment of the existing bridge over the Presque Isle river. | |
| B.M.#1 | Elev. 740.70 |
| R.R. spike in 14" Hemlock, SW side, 3 ft. above ground, on shank of spike. N. 63°30'W. 64.88' from Pt. A. | |
| B.M.#2 | Elev. 728.41 |
| N. Birch, W. bank river, about 300 ft. S. of bridge. | |

MISCELLANEOUS QUANTITIES

| ITEM | UNIT | AMT |
|---|----------|-----|
| Removal of Portions of Existing Structure | L.S. | |
| Plain Riprap | Sq. Yds. | 215 |
| Class B Sodding | Sq. Yds. | 110 |

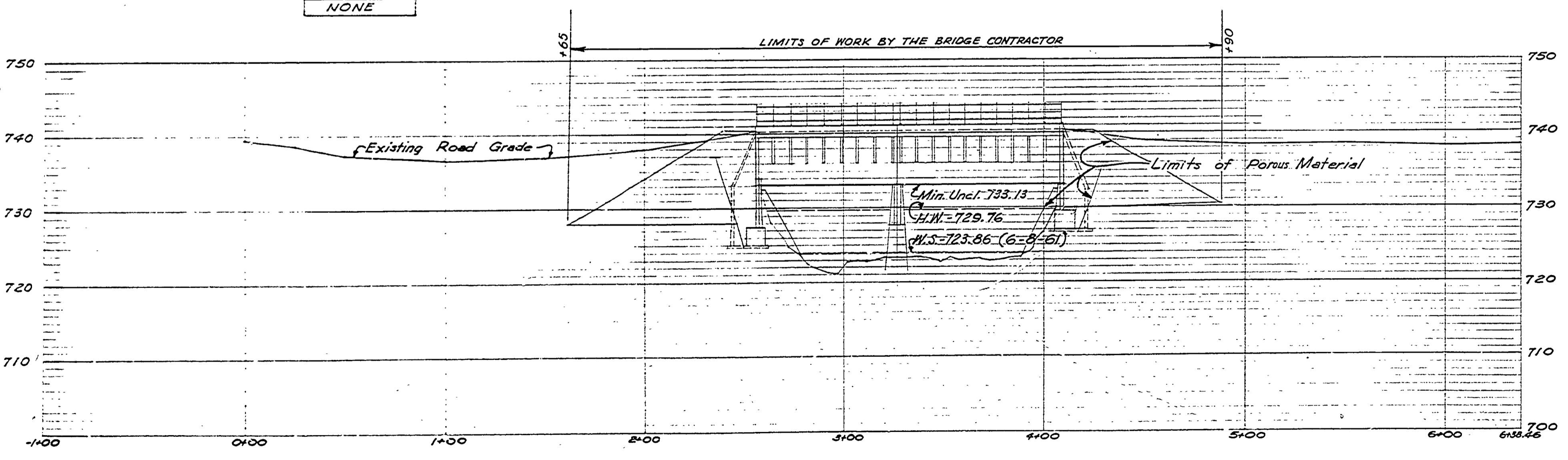
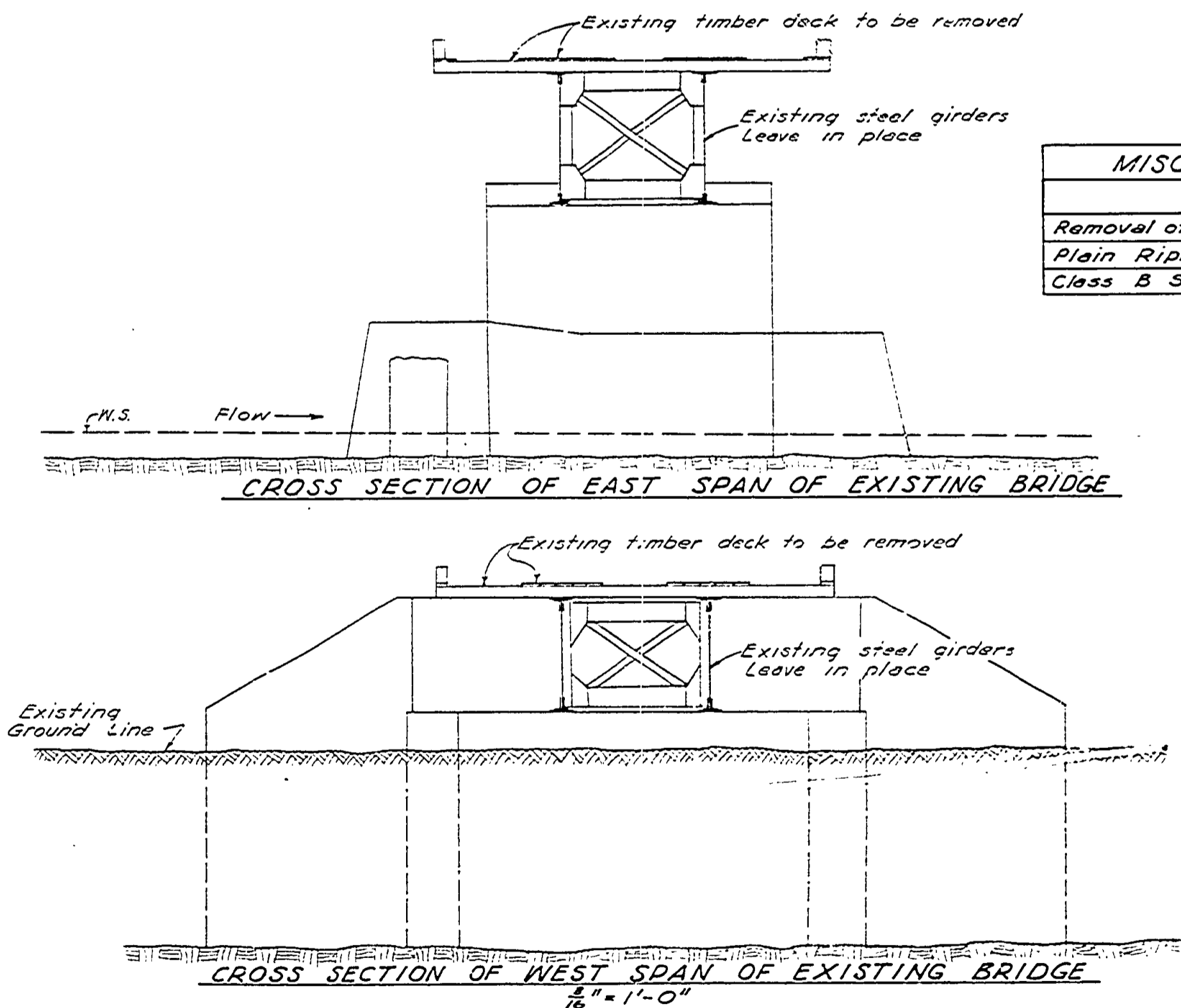

NOTES
The work covered by these plans includes removal of the existing bridge deck, removal of concrete at existing pier, cleaning and painting of the existing steel work, earth excavation, construction of the proposed bridge and placing porous material ground abutments to limits shown.