

BORROW REQUIREMENTS				
WHERE REQUIRED STA. TO STA.	AMOUNT REQUIRED	AMOUNT AVAILABLE	SOILS SERIES	UNIT LOCATION

**ONTONAGON COUNTY ROAD COMMISSION**  
 IN CO-OPERATION WITH  
**MICHIGAN DEPARTMENT OF STATE HIGHWAYS**  
 AND  
**BUREAU OF PUBLIC ROADS**  
 PLAN AND PROFILE OF PROPOSED

THE IMPROVEMENTS COVERED BY THESE PLANS SHALL BE DONE IN ACCORDANCE WITH THE MICHIGAN DEPARTMENT OF STATE HIGHWAYS CURRENT STANDARD SPECIFICATIONS AND SUPPLEMENTAL SPECIFICATIONS.

B.P.R. DIV. NO.	STATE PROJECT NO.	FEDERAL PROJECT NO.	FISCAL YEAR	SHEET NO.	TOTAL SHEETS
4	MICH. S 1040 (9)				
ROUTE	STATE PROJECT	COUNTY	TWP.	SHEET NO.	TOTAL SHEETS
1040	CS 66-55	ONTONAGON	CARP. COVE		

ADT - 75  
V-50

NOTE: PROVISIONS WILL BE MADE FOR CONTROL OF EROSION ON SHOULDERS AND SLOPES BY MEANS OF SEEDING, SODDING, OR OTHER ACCEPTABLE METHODS, EITHER AS A PART OF THIS CONTRACT, OR TO BE DONE BY THE COUNTY UPON COMPLETION OF THE CONTRACT WORK.

**FEDERAL AID SECONDARY PROJECT No. MICHIGAN S 1040 (10)**

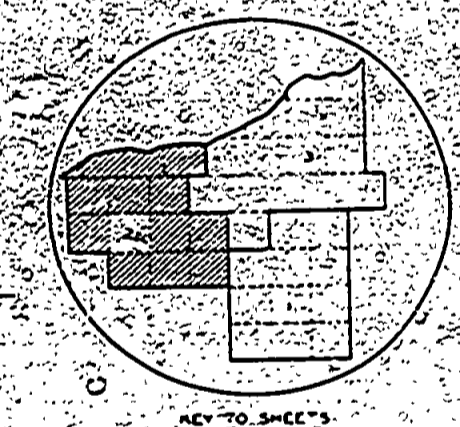
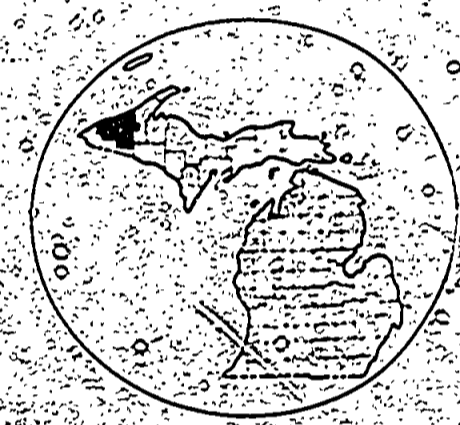
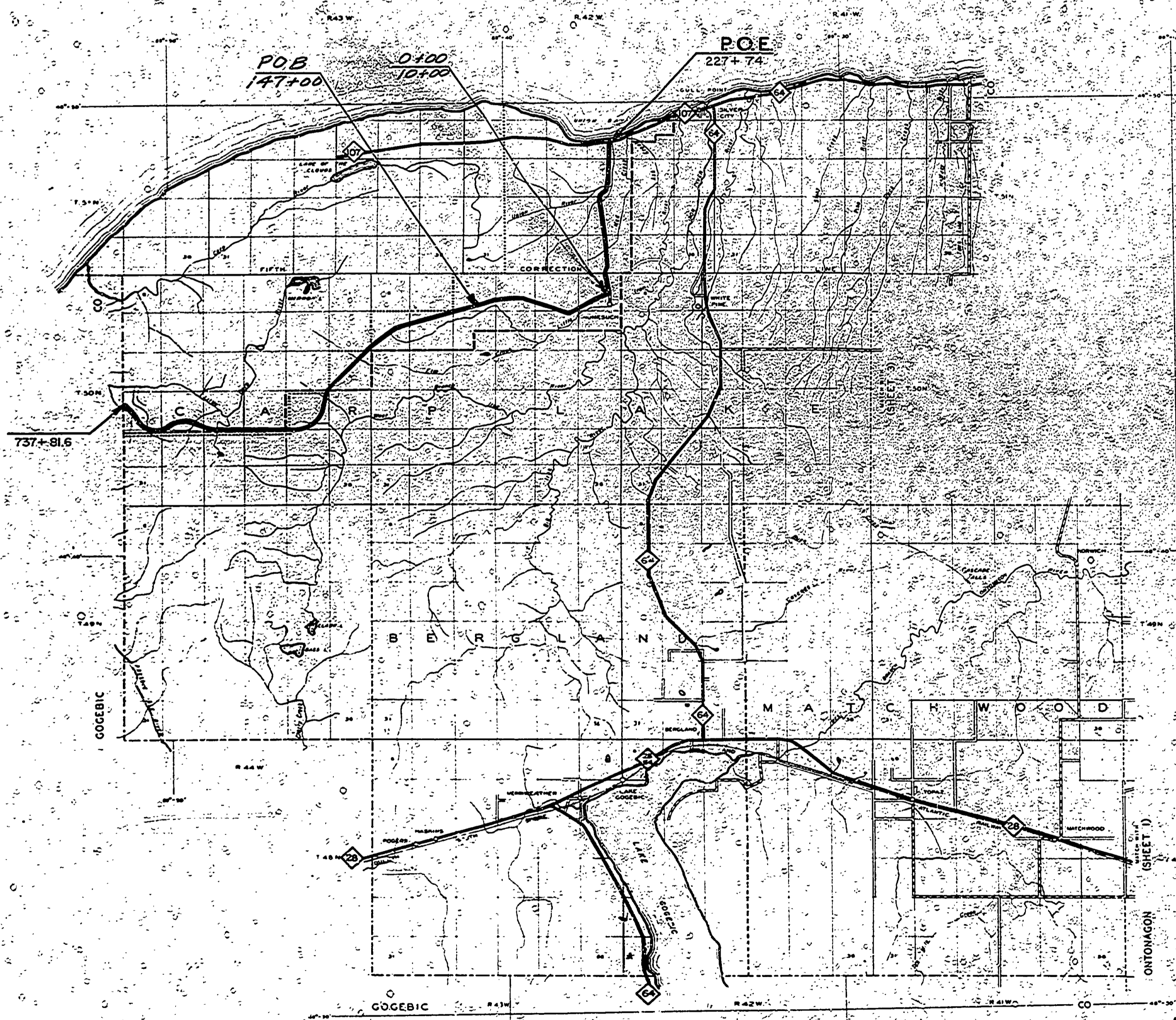

RECOMMENDATION FOR APPROVAL  
 Local Government Division  
 Plans Checked By: *CL* Date: *7-8-68*  
 RECOMMENDED FOR APPROVAL  
 By: *Case E. Dames* 7-8-68  
 ASST. P.A.S. Engineer

CONTRACT FOR 20" BIT. AGGR. SURF. CRS. 4.09

**COUNTY APPROVAL**  
 BOARD OF COUNTY ROAD COMMISSIONERS

BY: *[Signature]* CHAIRMAN DATE: *[Date]*  
 BY: *[Signature]* MEMBER DATE: *[Date]*  
 BY: *[Signature]* MEMBER DATE: *[Date]*  
 BY: *[Signature]* COUNTY ENGINEER DATE: *[Date]*

**DEPARTMENT OF STATE HIGHWAYS APPROVAL**  
 APPROVED: *[Signature]* COMMISSIONER  
 BY: *[Signature]* DEPUTY DIRECTOR DATE: *[Date]*

CONTRACT FOR

**COUNTY APPROVAL**  
 BOARD OF COUNTY ROAD COMMISSIONERS

BY: \_\_\_\_\_ CHAIRMAN DATE: \_\_\_\_\_  
 BY: \_\_\_\_\_ MEMBER DATE: \_\_\_\_\_  
 BY: \_\_\_\_\_ MEMBER DATE: \_\_\_\_\_  
 BY: \_\_\_\_\_ COUNTY ENGINEER DATE: \_\_\_\_\_

**BRIDGE DIVISION APPROVAL**

RECOMMENDED FOR APPROVAL: \_\_\_\_\_ ENGINEER OF BRIDGE DESIGN DATE: \_\_\_\_\_  
 APPROVED: \_\_\_\_\_ BRIDGE ENGINEER DATE: \_\_\_\_\_

**DEPARTMENT OF STATE HIGHWAYS APPROVAL**  
 APPROVED: \_\_\_\_\_ COMMISSIONER  
 BY: \_\_\_\_\_ DEPUTY DIRECTOR OF ENGINEERING DATE: \_\_\_\_\_

LEGISLATIVE BOUNDARY  
 PARK BOUNDARY

PORCUPINE MOUNTAINS SOUTH BOUNDARY ROAD  
 BITUMINOUS SURFACE

E-1096

STATE PROJECT	FEDERAL PROJECT	SHEET NO.	TOTAL SHEETS

Ontonagon Co. CS 66-55 (10) Sheet 4386 7-5-68 25