

| | |
|--------------|------|
| FINAL SURVEY | DATE |
| SURVEY | |
| PLATED | |
| NOTE BOOK | |
| NO. | |

| | | |
|-----------------|----|------|
| ORIGINAL SURVEY | BY | DATE |
| SURVEY | | |
| PLATED | | |
| NOTE BOOK | | |
| NO. | | |

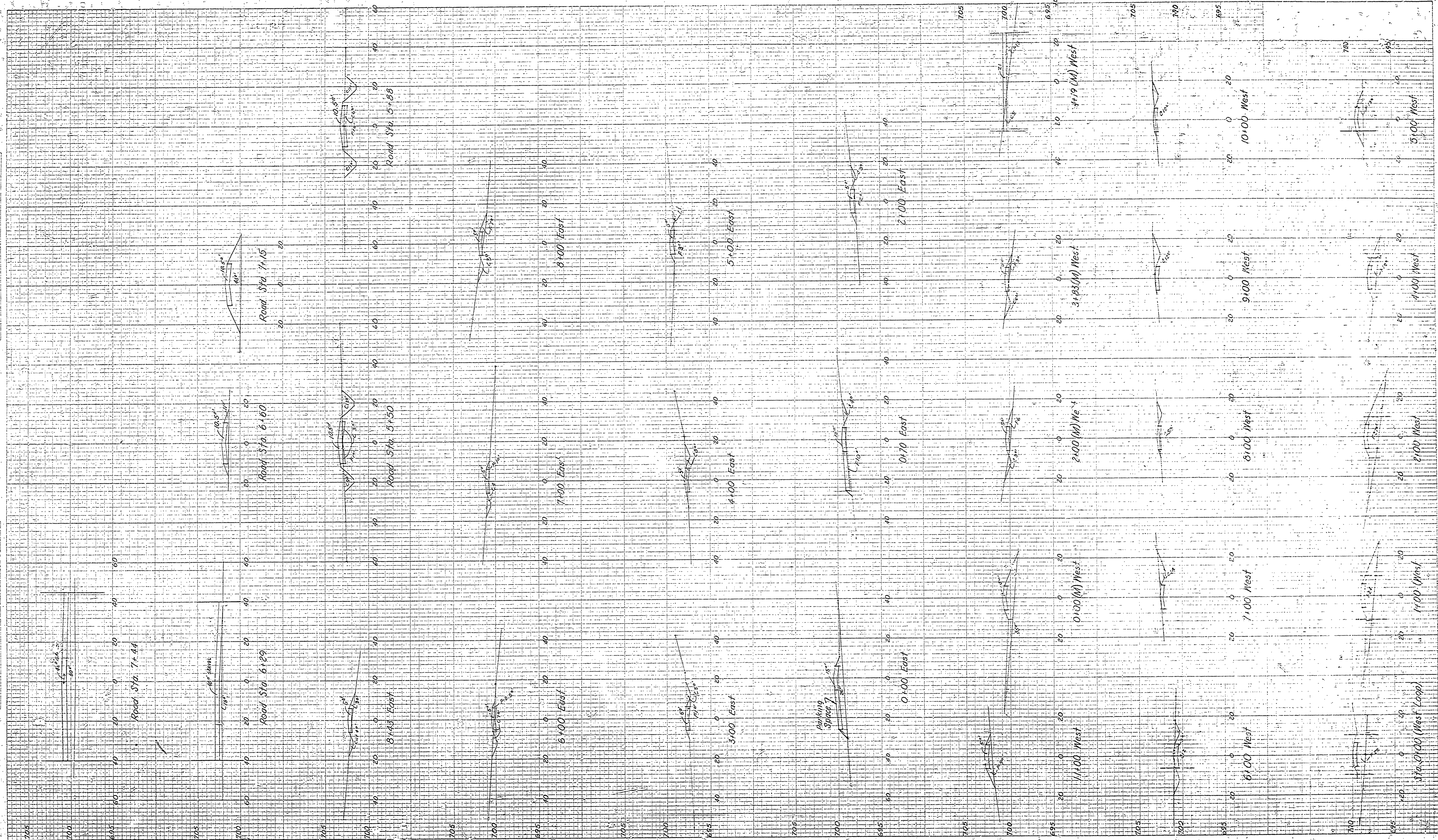

PLATE 5, CROSS SECTION
 48 7056 - ALBANY, N.Y. - 1942
 MADE IN U.S.A.

PORCUPINE MTS - S. P. - DRESSING ISLE SECTION - CAMPGROUND

E-121