

DRAWN BY F. J. W.	TRACED BY ARCHITECTURAL	CHECKED BY ENGINEERING	DATE FEBRUARY 14, 1967	REVIEWED BY SECTIONS	APPROVED BY	DATE	REVISIONS
				LANDSCAPE L. M. C.	ASSISTANT CHIEF IN CHARGE	2-67	NO. DATE BY
							1 1-11-67 GBH ADD CHAIR LIFT & TWO SLOPES
							4 5 6

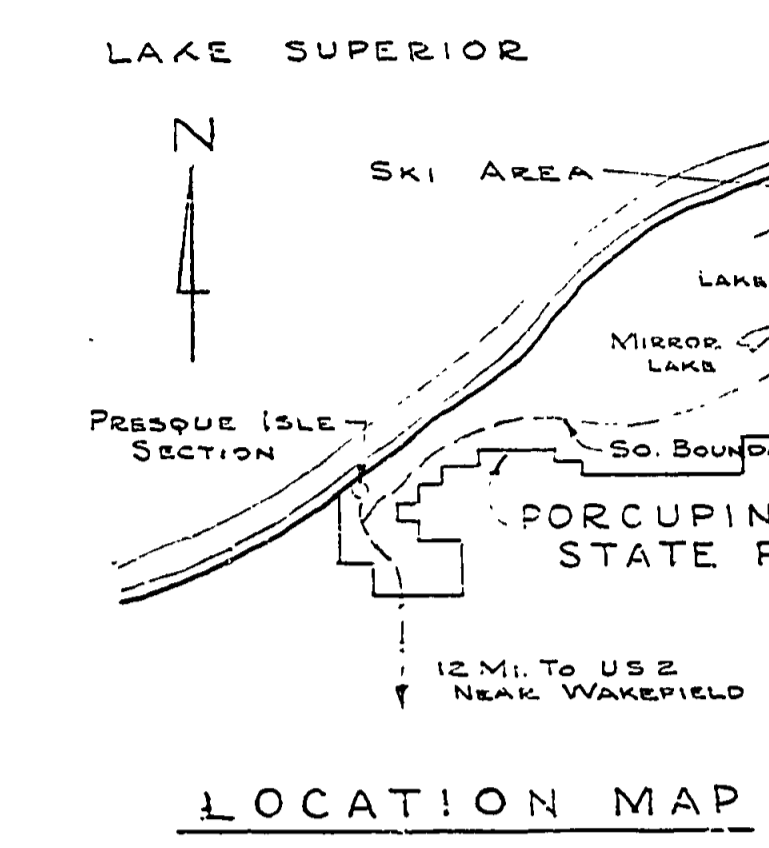

CONSTRUCTION PLANS
FOR
DOUBLE CHAIR SKI LIFT
PORCUPINE MOUNTAINS STATE PARK
ONTONAGON, MICH.
PROJECT NO. Pa108-5124-300-020-C0

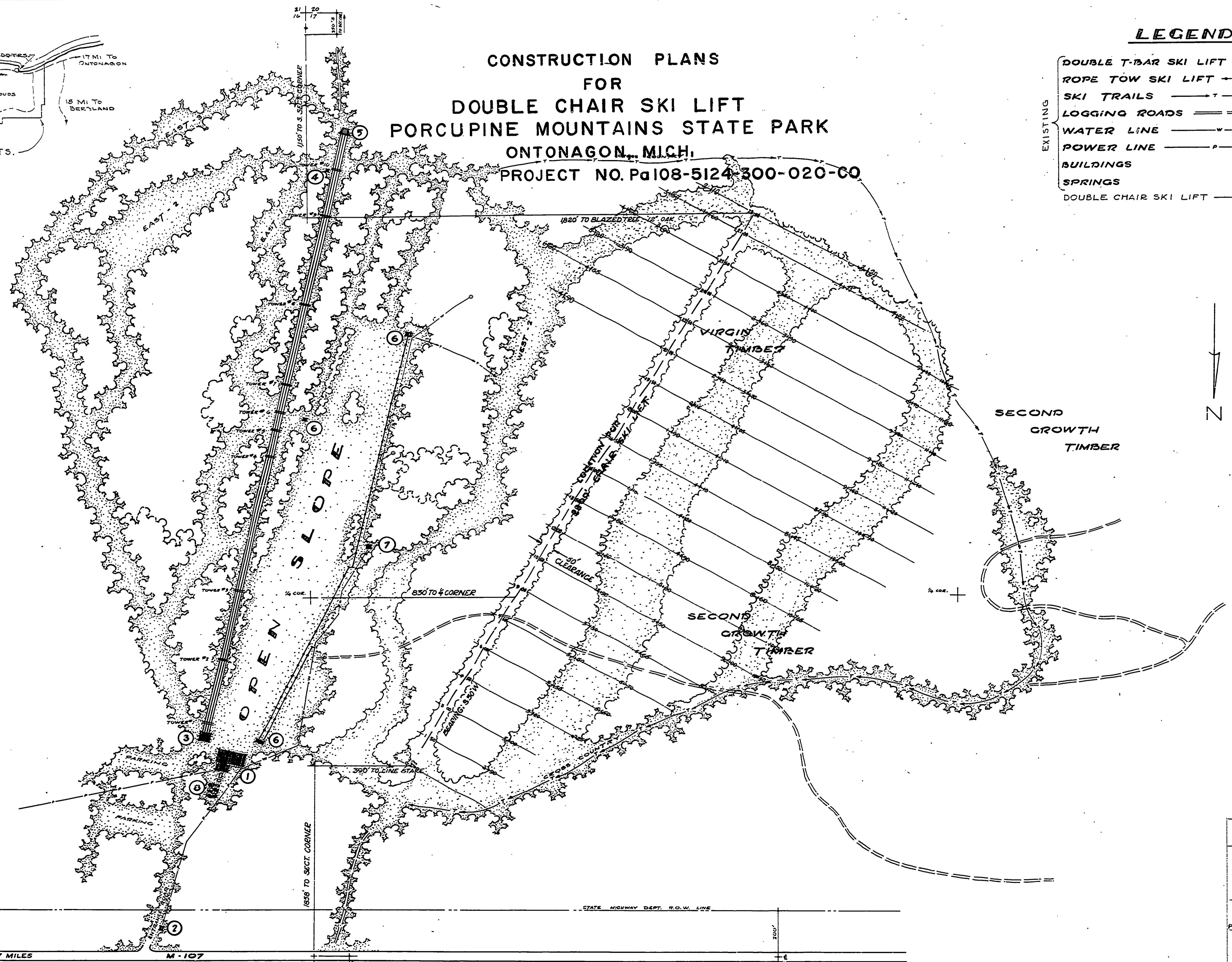
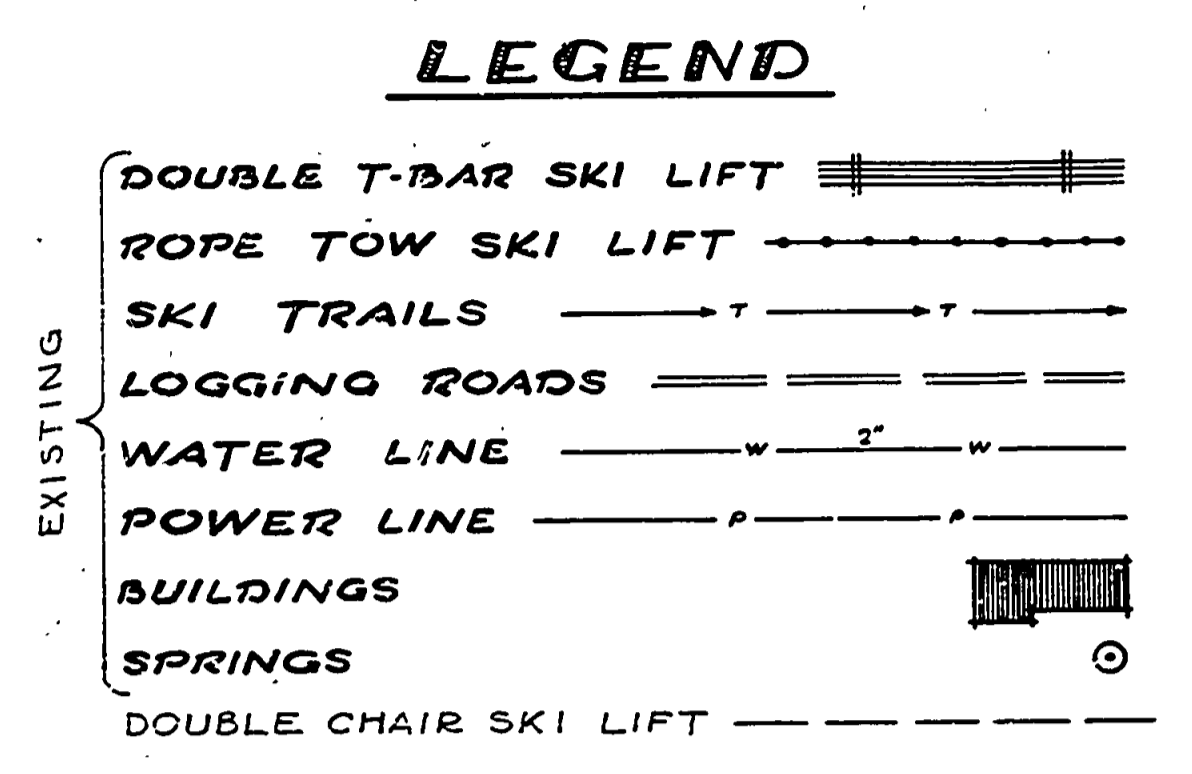

APPROVED:
Paul O. Deaneck
CHIEF OF PARKS DIVISION
MICHIGAN DEPARTMENT OF CONSERVATION
DATE: 1-12-67

FIELD SURVEY AND ORIGINAL DRAWING BY J. CALABRO

CONSERVATION COMMISSION APPROVAL		
BY:	DESIGN	DATE:
RECOMMENDED FOR APPROVAL:	<i>H. J. Hansen</i>	9-10-67
RECOMMENDED FOR APPROVAL:	<i>P. O. Deaneck</i>	4-12-67
BY:	DIVISION APPROVAL	DATE:
<i>Paul O. Deaneck</i>		4-11-67
MICHIGAN DEPARTMENT OF CONSERVATION		
APPROVED:	CHIEF ENGINEER	DATE:
<i>H. C. ...</i>		4-11-67
PLAN NO.	PROJECT NUMBER	SHEET OF