

DRAWN BY J. YMA		REVIEWED BY SECTIONS		APPROVED BY		NO. DATE BY		REVISIONS		DATE BY	
TRACED BY		ARCHITECTURAL		ASSISTANT CHIEF IN CHARGE		1		4			
CHECKED BY		ENGINEERING		OF DESIGN		2		5			
DATE FEB. 1967		LANDSCAPE		DATE		3		6			

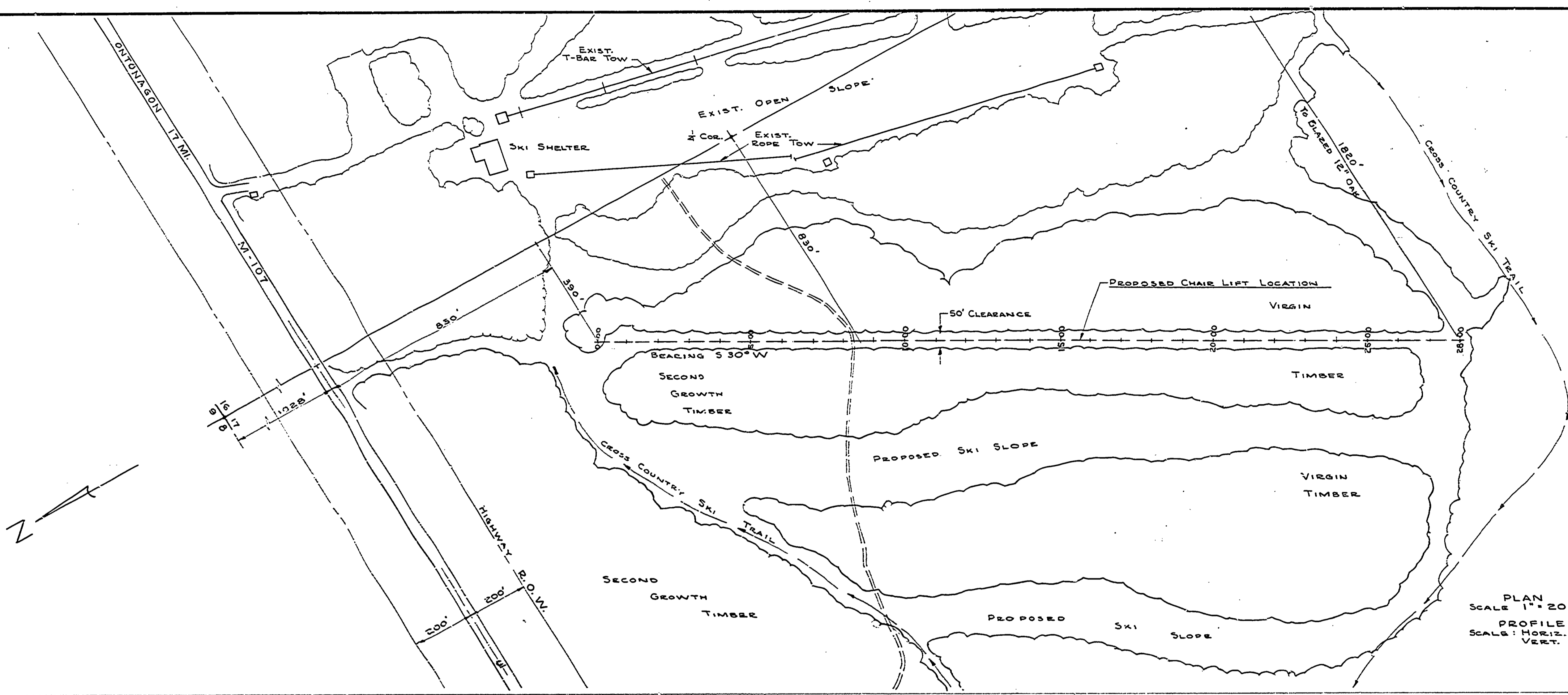

PLAN SCALE 1" = 200'
 PROFILE SCALE: HORIZ. 1" = 100',
 VERT. 1" = 100'

NOTE
 ALL CLEARING AND GRUBBING
 TO BE DONE BY OWNER.

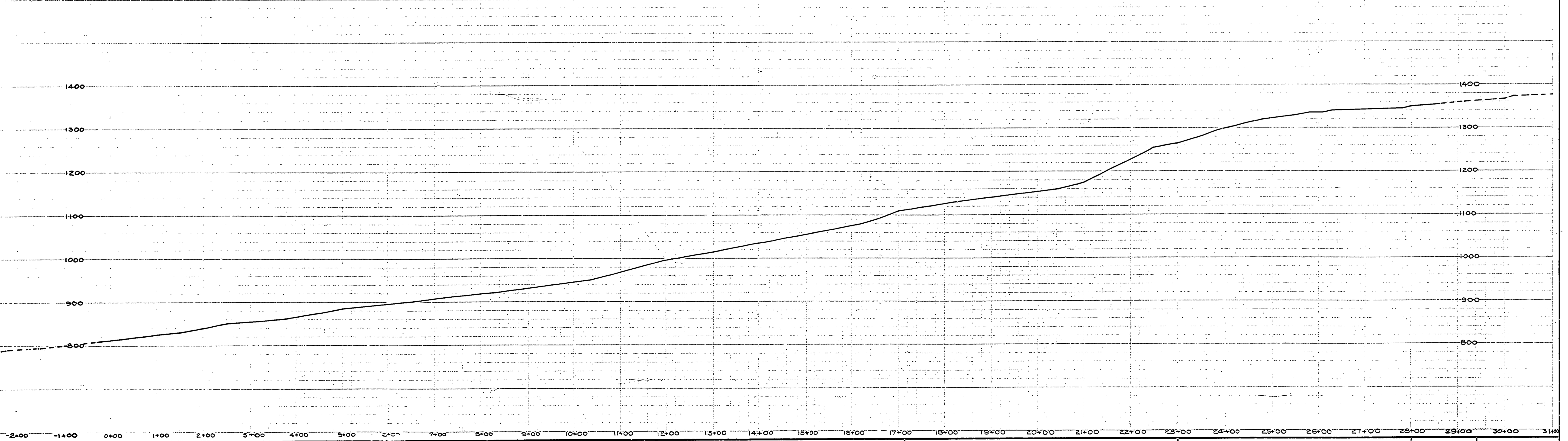

PROFILE AT PROPOSED CHAIR LIFT

MICHIGAN
 DEPARTMENT OF CONSERVATION
 PARKS AND RECREATION DIVISION

PORCUPINE MTS. STATE PARK
 DOUBLE CHAIR SKI LIFT

SHEET NO. 2
 OF

PLAN NO. E-122