

DESIGNED BY	DATE	REVIEWED	DATE	APPROVED	DATE	NO.	DATE	BY	REVISIONS	DATE	BY
B.H.G.	8-4-62	ARCHITECTURAL	6-28-62		1	1			4		
J. YERGA	8-10-62	ENGINEERING	8-22-62		2	2			5		
B.H.G.	4-11-62	LANDSCAPE	7-5-62		3	3			6		

VAN RIPER STATE PARK

CENTRAL SEWAGE DISPOSAL SYSTEM

ACCOUNT NO. 975-12-C1

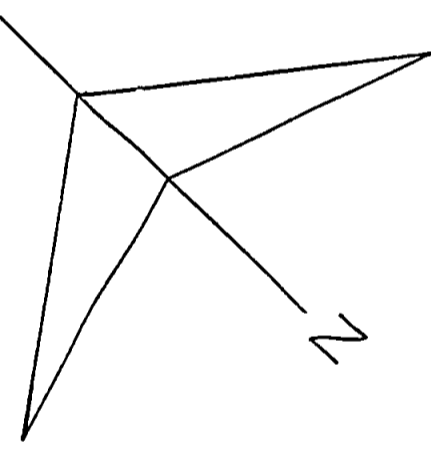
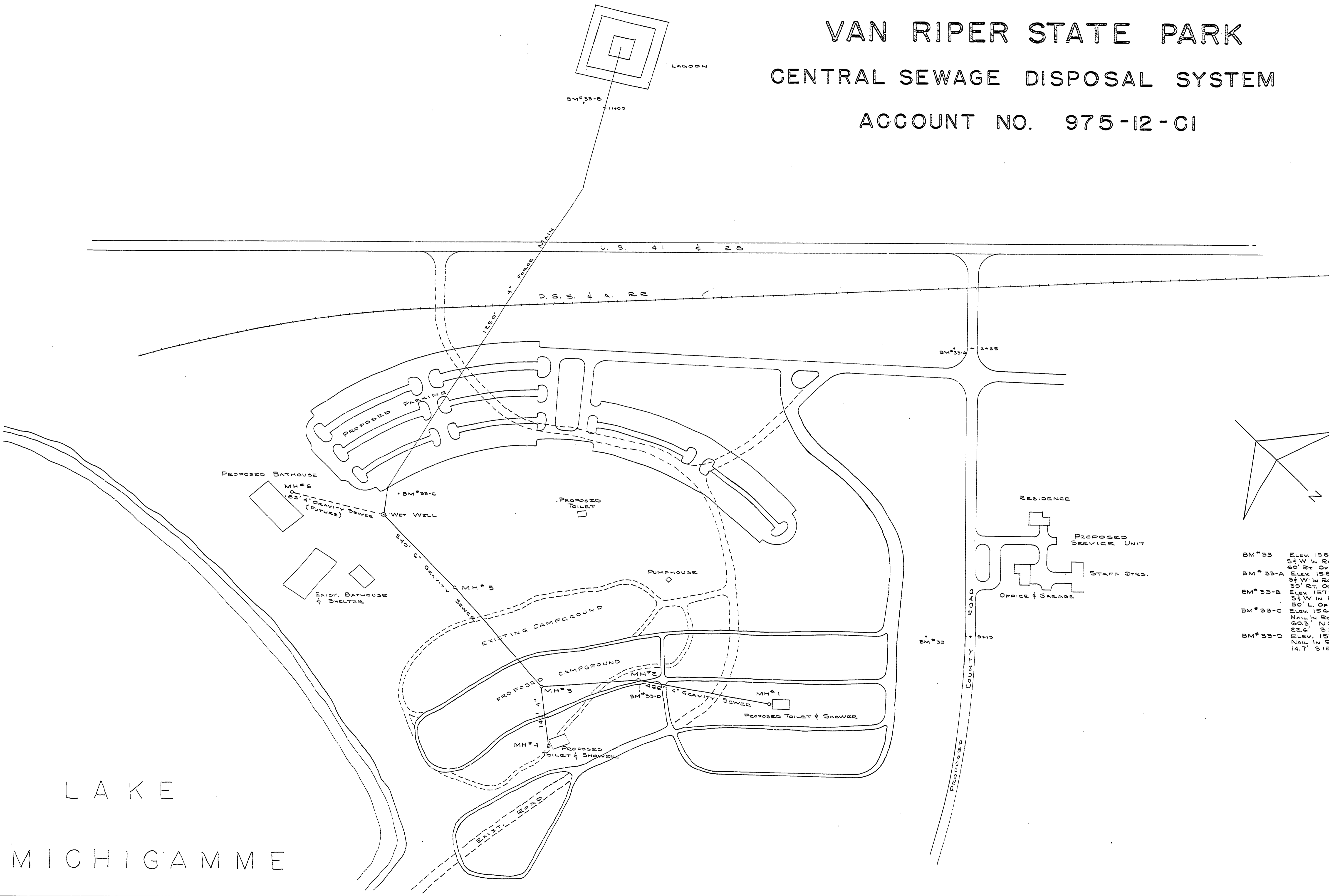

- BM*33 ELEV. 1581.35
5' W IN ROOT OF 8" SPRUCE
60' E OF STA. 2+13
- BM*33-A ELEV. 1581.88
5' W IN ROOT OF 18" SPRUCE
35' RT. OF STA. 2+25
- BM*33-B ELEV. 1571.13
5' W IN ROOT OF 8" SPRUCE
50' L OF STA. 11+00.
- BM*33-C ELEV. 1563.33
NAIL IN ROOT 10" SPRUCE N. SIDE
60.3' N 67° E. OF WET WELL.
22.4' S 34° E. OF STA. 0+65.
- BM*33-D ELEV. 1578.09
NAIL IN ROOT 18" W. E. SIDE
14.7' S 12° W OF MH#2

LAKE
MICHIGAMME