

BEWABIC STATE PARK CONSTRUCTION PLANS FOR BITUMINOUS PAVEMENT

PROJECT NO. 24-1663

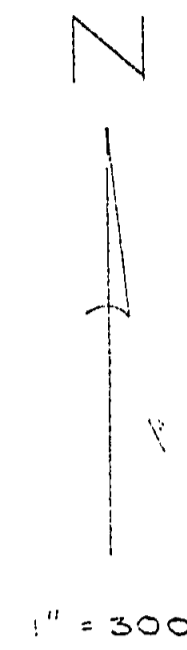

1" = 300'

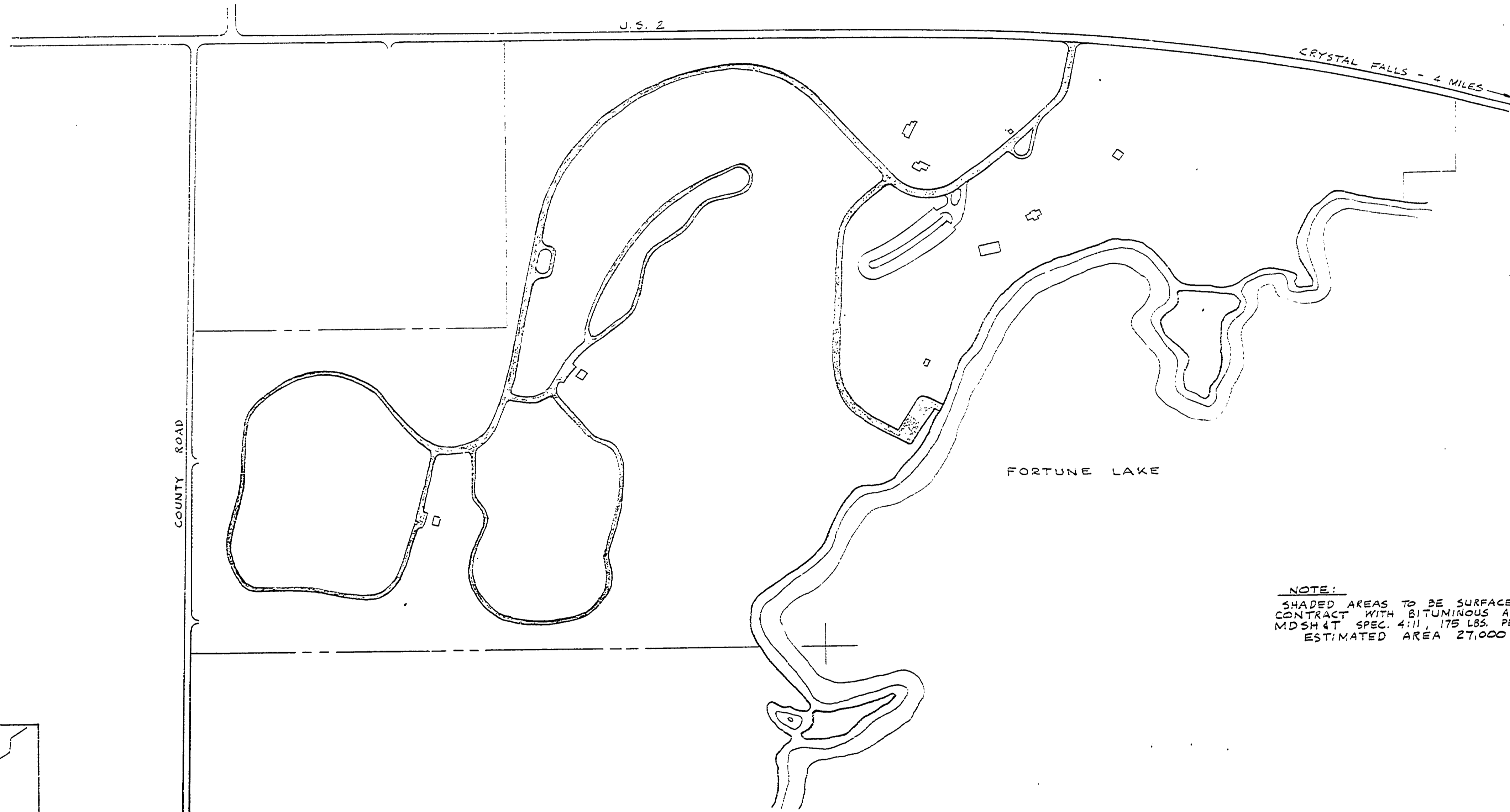

NOTE:
SHADED AREAS TO BE SURFACED UNDER THIS CONTRACT WITH BITUMINOUS AGGREGATE PAVEMENT MDSH&T SPEC. 4:11, 175 LBS. PER SQ. YD. ESTIMATED AREA 27,000 SQ. YDS.

AREA MAP
SCALE: 1" = 300'

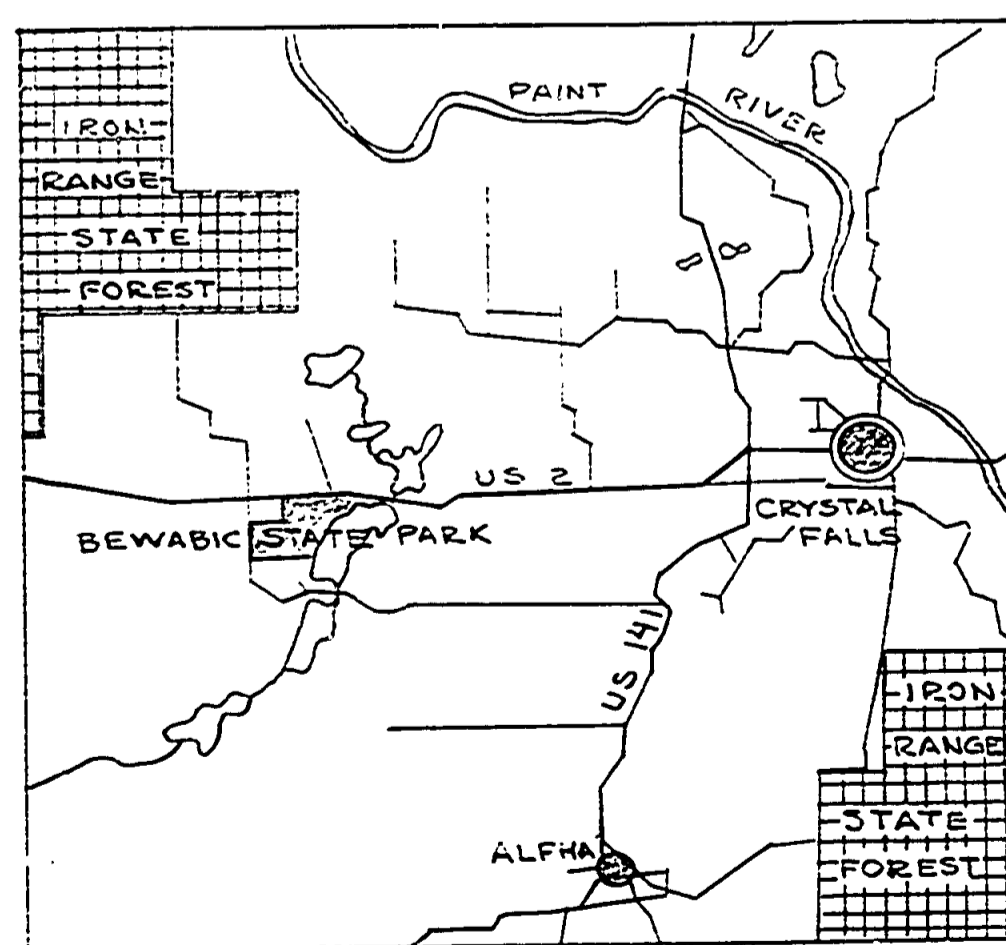

LOCATION MAP

INDEX	
SHT.	SHEET TITLE
1	COVER SHEET
2	ENTRANCE ROAD & BOAT LAUNCH ROAD
3	ENTRANCE ROAD & CAMPGROUND ROADS

BUILDING COMMITTEE APPROVAL	
BY: _____	DATE: _____
RECOMMENDED FOR APPROVAL: <i>W. J. Merrill</i>	DATE: 12-5-74
RECOMMENDED FOR APPROVAL: <i>William C. Cook</i>	DATE: 12-17-74
DIVISION/REGION APPROVAL	
BY: <i>R. J. Schenck</i>	DATE: 12-17-74
APPROVED: <i>H. E. Morrison</i>	
DATE: 12-17-74	
PROJECT NO. 24-1663	
SHEET 1 OF 3	PLAN NO. E-102

DESIGNED BY: R. H. MERRILL	DRAWN BY: J. YPMA	NO. 12	DATE 12-74	BY	REVISIONS	NO. 3	DATE	BY	REVISIONS
DATE	CHECKED BY	DATE	1.			4.			
			2.						

MICHIGAN DEPARTMENT OF NATURAL RESOURCES	COVER SHEET	BEWABIC STATE PARK
	SHEET TITLE	AREA OR PARK
		BITUMINOUS PAVEMENT
		PROJECT