

DESIGNED BY	DATE	REVIEWED	DATE	APPROVED	DATE	NO.	DATE	BY
J. M. H.	3-1-63	ARCHITECTURAL	3-1-63	[Signature]	1	1	3-1-63	[Signature]
DRAWN BY	3-1-63	ENGINEERING	3-22-63	[Signature]	2	2	3-22-63	[Signature]
CHECKED BY	3-1-63	LANDSCAPE	3-20-63	[Signature]	3	3	3-20-63	[Signature]
					4	4		
					5	5		
					6	6		

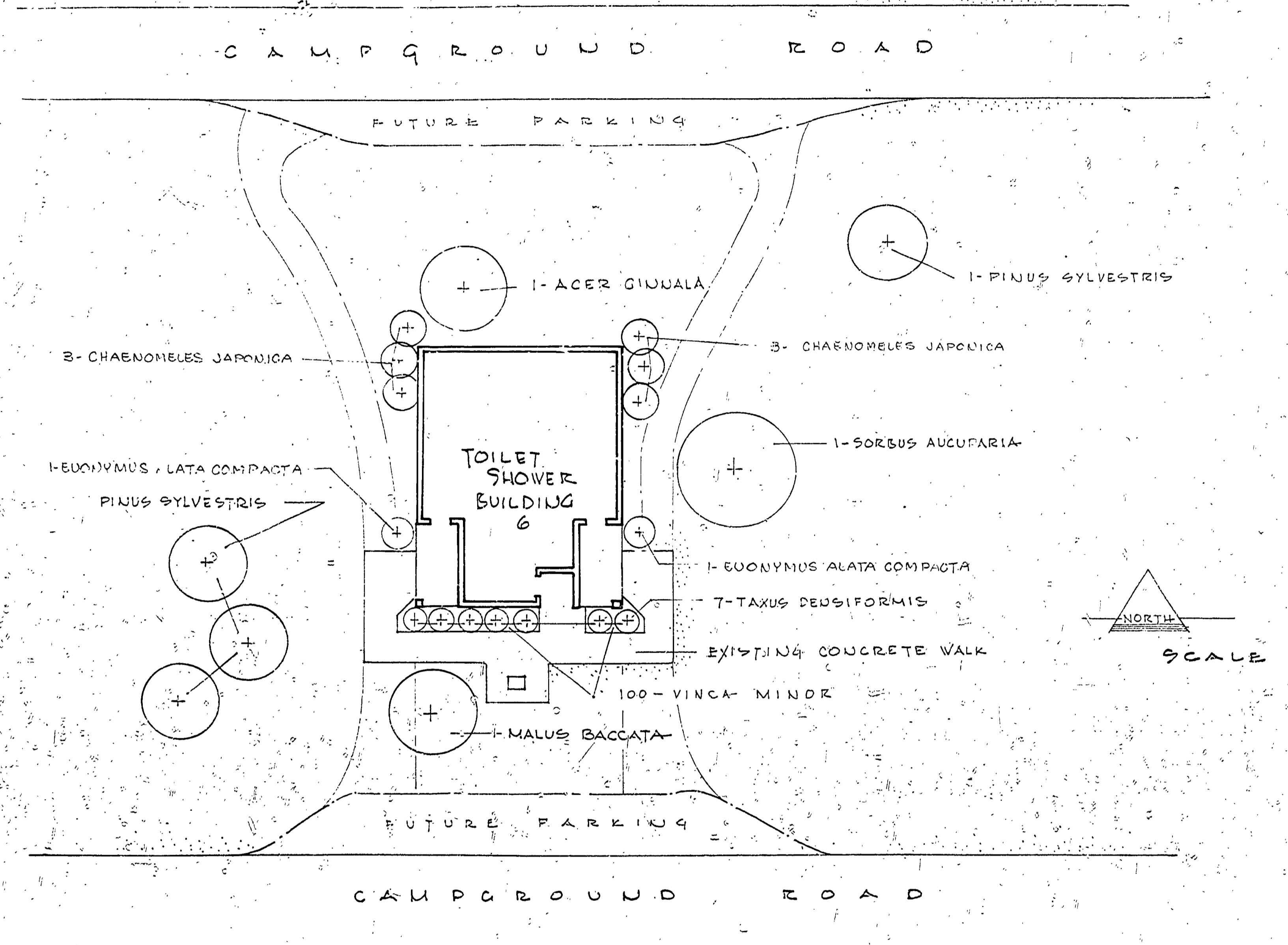

BRIMLEY STATE PARK
PLANT LIST

QUANTITY	SCIENTIFIC NAME	COMMON NAME	SIZE	ROOT	NOTES
1	ACER GINNALA	AMUR MAPLE	6-7'	3" x 15"	INDIVIDUAL BED
2	EUONYMUS A. COMPACTA	DWARF WINGED EUONYMUS	2 1/2-3'	3" x 15"	INDIVIDUAL BED
1	MALUS BACCATA (COLUM.)	COLUMNAR CRABAPPLE	7-8'	3" x 15"	INDIVIDUAL BED
6	PINUS SYLVESTRIS	SCOTCH PINE	6-7'	3" x 15"	INDIVIDUAL BED
1	CHAENOMELES JAPONICA	JAPANESE QUINCE	2-2 1/2'	3" x 15"	GROUP BEDS
1	SORBUS AUCUPARIA	EUROPEAN MT. ASH	8-10'	3" x 15"	INDIVIDUAL BED
1	TAXUS DENSIFORMIS	JAPANESE YEW	2-2 1/2'	3" x 15"	INDIVIDUAL BED
100	VINCA MINOR	GROUND MYRTLE	6" CLD.	3" ON CENTER	

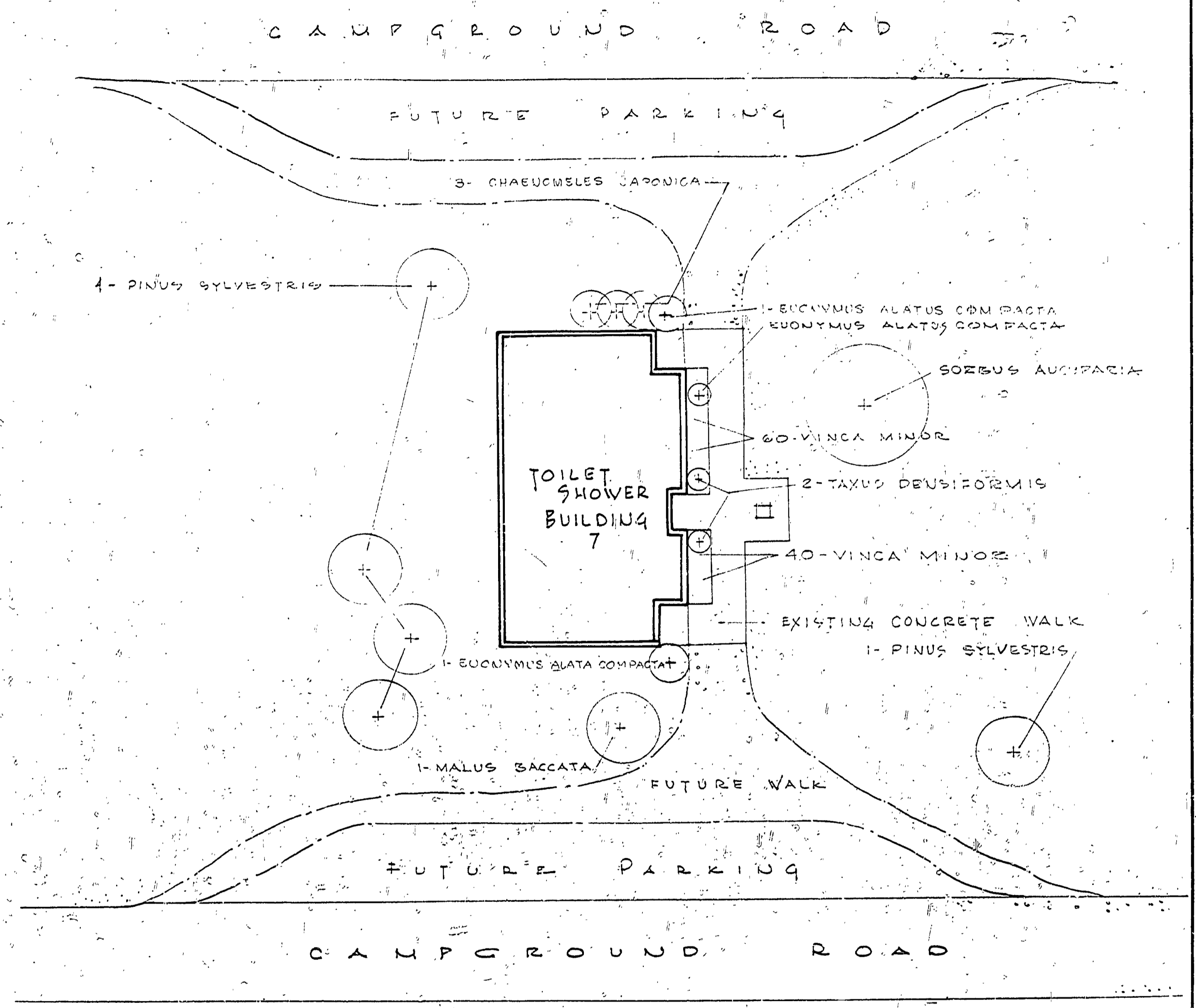

BRIMLEY STATE PARK
PLANT LIST

QUANTITY	SCIENTIFIC NAME	COMMON NAME	SIZE	ROOT	NOTES
3	EUONYMUS ALATUS COMP.	COMP WINGED EUONYMUS	2 1/2-3'	3" x 15"	PLANT AGAINST BLDG.
1	MALUS BACCATA (COLUM.)	COLUMNAR CRABAPPLE	7-8'	3" x 15"	INDIVIDUAL BED
5	PINUS SYLVESTRIS	SCOTCH PINE	6-7'	3" x 15"	INDIVIDUAL BED
1	CHAENOMELES JAPONICA	JAPANESE QUINCE	2-2 1/2'	3" x 15"	GROUP BED
1	SORBUS AUCUPARIA	EUROPEAN MT. ASH	8-10'	3" x 15"	INDIVIDUAL BED
2	TAXUS DENSIFORMIS	JAPANESE YEW	2-2 1/2'	3" x 15"	INDIVIDUAL BED
100	VINCA MINOR	GROUND MYRTLE	6" CLUMP	3" ON CENTER	

MICHIGAN
DEPARTMENT OF CONSERVATION
PARKS AND RECREATION DIVISION

BRIMLEY STATE PARK
BUILDING NO. 6 & 7
AREA B

SHEET
NO. 1
OF 1

PLAN NO.
L-110