

BRIMLEY STATE PARK
 CONSTRUCTION PLANS
 CAMPGROUND TOILET & SHOWER BLDG.
 PROJECT No. 253-2-C1

Richard E. ...
 CHIEF, PARK & RECREATION DIVISION

REVISIONS	NO.	DATE	BY
	1		
	2		
	3		
	4		
	5		

APPROVED BY	DATE
J.P.R.	7-1-58
J.P.R.	7-1-58
J.P.R.	7-1-58

REVIEWED BY SECTIONS	DATE
ARCHITECTURAL	J.P.R. 7-1-58
ENGINEERING	J.P.R. 7-1-58
LANDSCAPE	J.P.R. 7-1-58

DRAWN BY	DATE
J.W.T.	3-27-58

CHECKED BY	DATE
W.D.G.	3-27-58

ASSISTANT CHIEF IN CHARGE OF DESIGN	DATE
J.P.R.	7-1-58

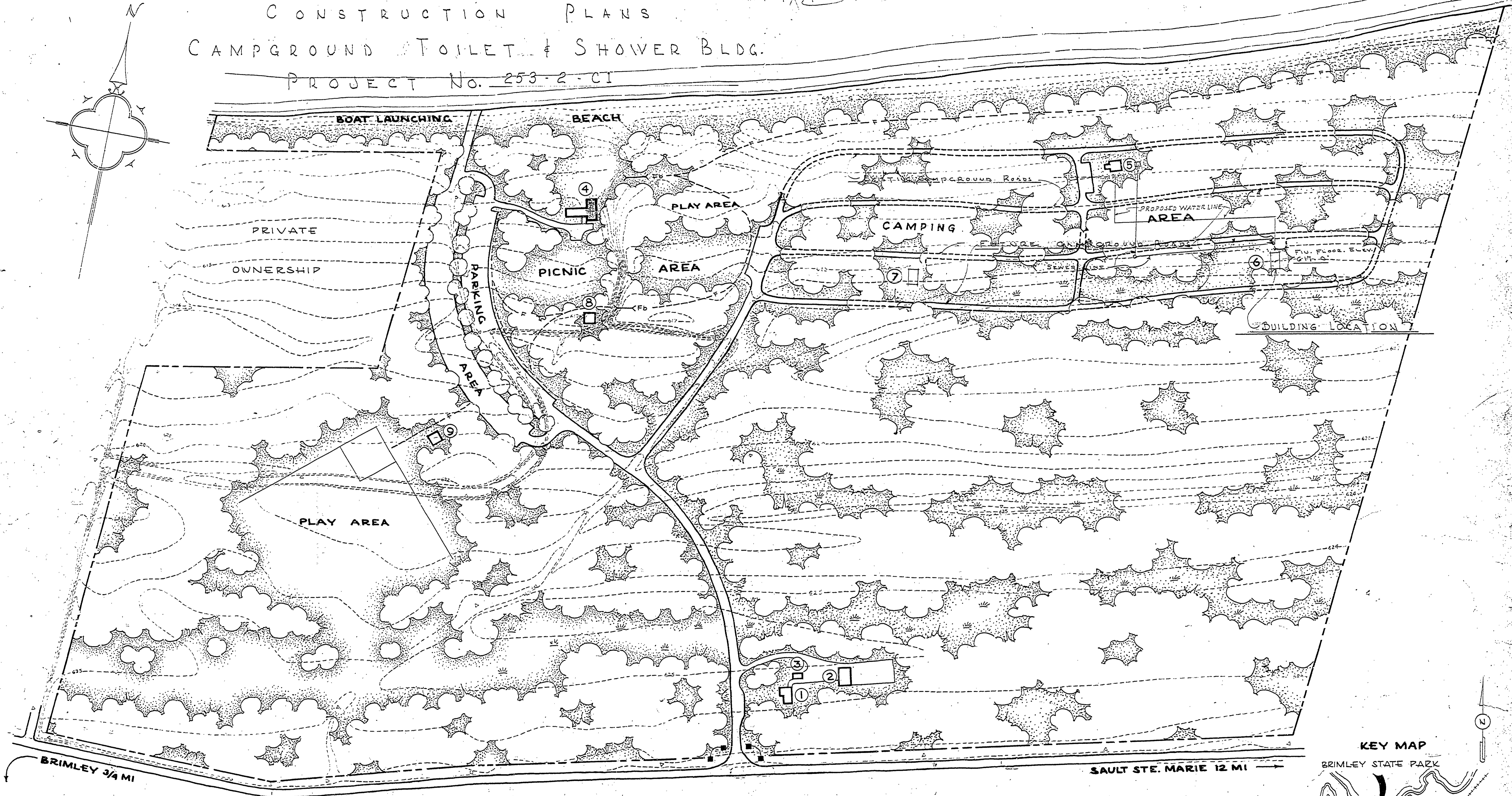

- KEY TO BUILDINGS**
- 1 RESIDENCE
 - 2 WORKSHOP & GARAGE
 - 3 GARAGE
 - 4 BATHHOUSE & CONCESSION
 - 5 LAUNDRY, TOILET & SHOWER
 - 6-7-8-9 TOILETS

- LEGEND**
- PARK ENTRANCE
 - PROPERTY LINE
 - PARK ROADS
 - FOOT TRAIL
 - FOOT BRIDGE
 - MIXED TREE GROWTH
 - SWAMP

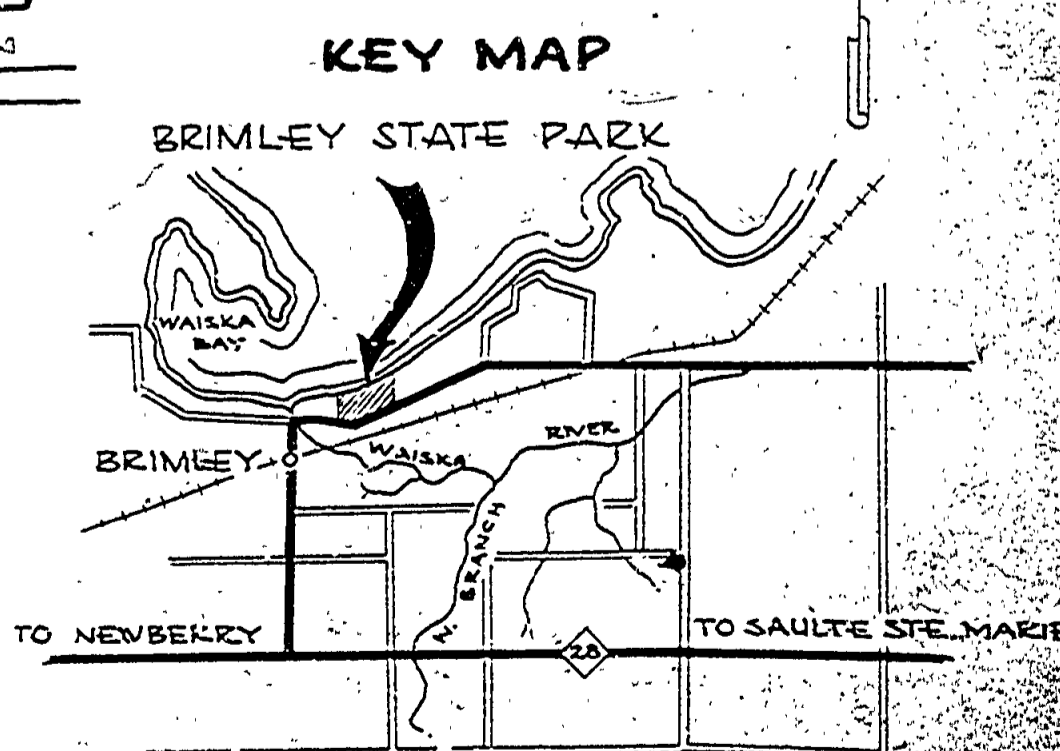

SCALE 1" = 300'

MICHIGAN
 DEPARTMENT OF CONSERVATION
 PARKS AND RECREATION DIVISION

TITLE AND LOCATION PLAN	PROJ. NO. 253-2-C1
BRIMLEY STATE PARK TOILET AND SHOWER BUILDING CAMPGROUND BLDG. 76	SHEET NO. 1 OF 6
	PLAN NO. A-104