

LAKE SUPERIOR

NO.	DATE	BY	REVISIONS
1	1-30-58	J.C. [Signature]	1
2	2-20-58	J.R. [Signature]	2
3	2-20-58	J.R. [Signature]	3
4			4
5			5
6			6

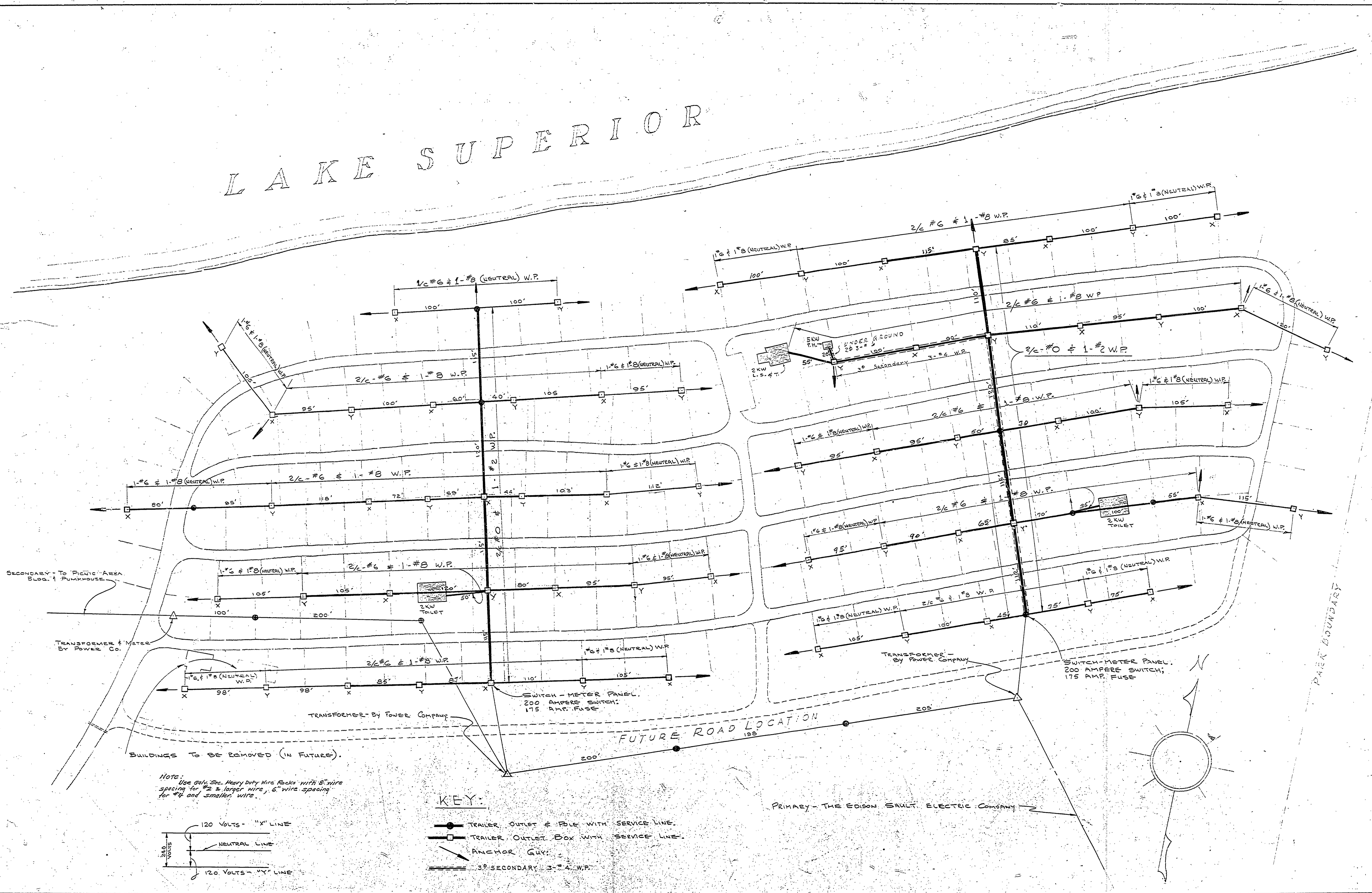

NOTE:
Use galv. Sec. Heavy Duty Wire Rods with 8" wire spacing for #2 & larger wire, 6" wire spacing for #4 and smaller wire.

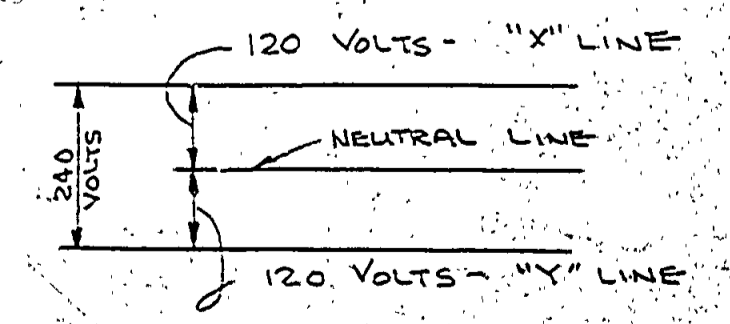

- KEY:
- TRAILER, OUTLET & POLE WITH SERVICE LINE.
 - TRAILER, OUTLET BOX WITH SERVICE LINE.
 - ANCHOR GUY.
 - 3 #2 SECONDARY 3-#4 W.P.

DRAWN BY: N.B.M.
 CHECKED BY: R.A.H.
 DATE: 2-12-58
 REVIEWED BY SECTIONS:
 ARCHITECTURAL: J.R.
 ENGINEERING: J.R.
 LANDSCAPE: J.R.
 APPROVED BY: J.C. [Signature]
 ASSISTANT CHIEF IN CHARGE OF DESIGN DATE: 2-20-58

SCALE - 1" = 50'

MICHIGAN DEPARTMENT OF CONSERVATION
PARKS AND RECREATION DIVISION

BRIMLEY STATE PARK
CAMPGROUND ELECT. DISTRIBUTION SYSTEM

SHEET NO. 1 OF 3
PLAN NO. E-112