

DESIGNED BY	DATE	REVIEWED	DATE	APPROVED	DATE	NO.	DATE	BY
J. Y. Jones	11-24	ARCHITECTURAL				1		
DRAWN BY		ENGINEERING				2		
CHECKED BY	1-25	LANDSCAPE				3		
						4		
						5		
						6		

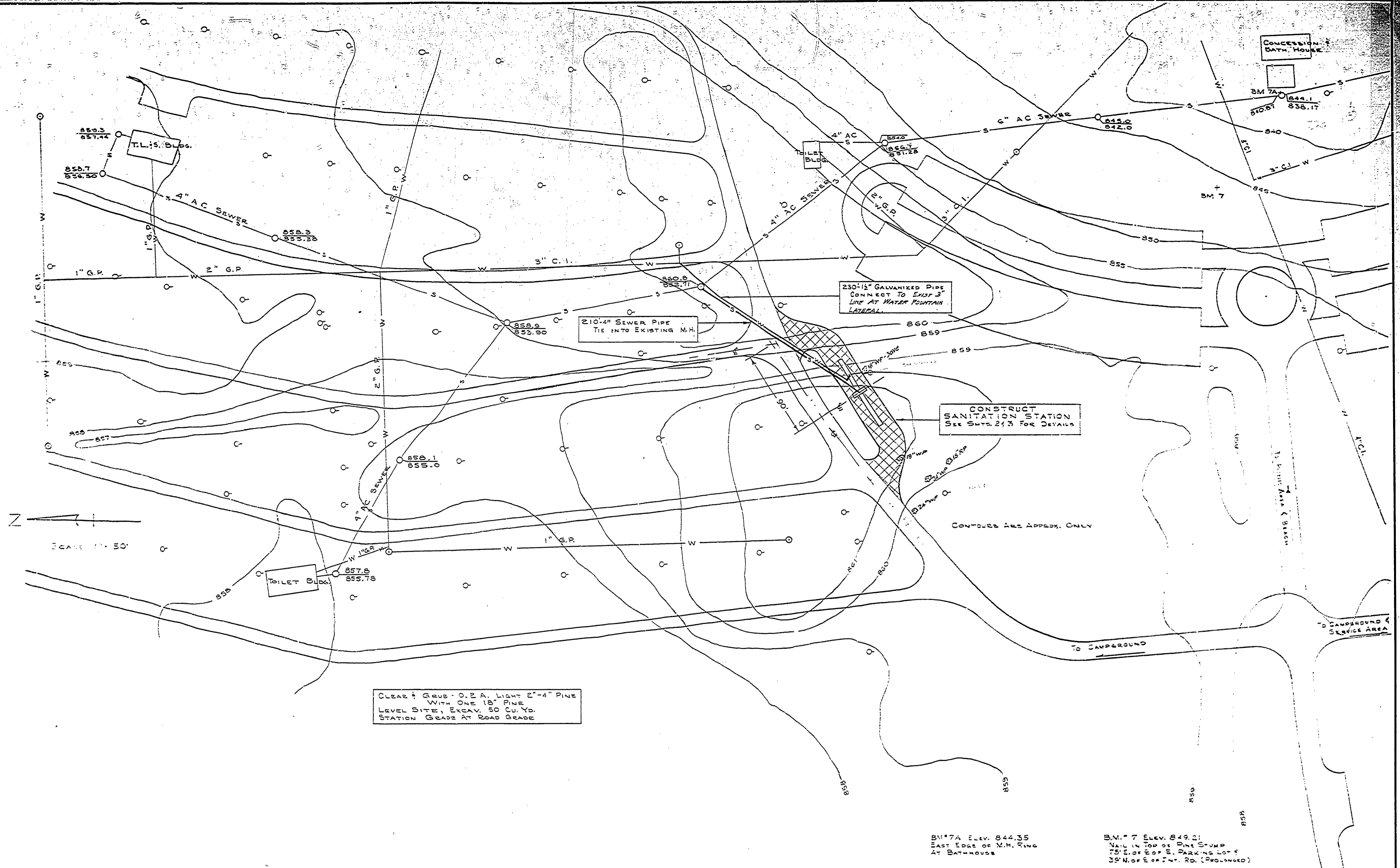

CLEAR + GRUB - 0.2 A. LIGHT 2"-4" PINE WITH ONE 18" PINE LEVEL SITE, EXCAV. 50 CU. YD. STATION GRADE AT ROAD GRADE

CONSERVATION COMMISSION APPROVAL

BY: \_\_\_\_\_ DATE: \_\_\_\_\_

RECOMMENDED DESIGN

FOR APPROVAL: DESIGNER DATE

FOR APPROVAL: *R. P. Jones* 4-12-65

IN CHARGE OF DESIGN DATE

SECTION APPROVAL

BY: *Richard Jones* DATE: 4/7/65

SECTION CHIEF

MICHIGAN DEPARTMENT OF CONSERVATION

APPROVED: *H. C. Madison* 6-7-65

CHIEF ENGINEER DATE

PLAN NO. PROJECT NUMBER SHEET OF

B.M. #7A ELEV. 844.35  
EAST EDGE OF N.H. FENCE  
AT BATHHOUSE

B.M. #7 ELEV. 849.01  
NAIL IN TOP OF DIRT SUMP  
75' E. OF E. OF E. PARKING LOT  
35' N. OF E. OF 2nd RD. (PROPOSED)

MICHIGAN DEPARTMENT OF CONSERVATION  
PARKS AND RECREATION DIVISION

INTERLOCHEN STATE PARK  
SANITATION STATION PLOT PLAN

SHEET NO. 6 OF 16  
PLAN NO. E-121

SF-153 COVER SHEET & DETAILS