

DESIGNED BY	DATE	REVIEWED BY SECTIONS	DATE	APPROVED BY	NO. DATE BY	REVISIONS
TRACED BY	J.I.R. 3-7-57	ARCHITECTURAL	J.I.R. 3-7-57	M.C. [Signature]	1	4
CHECKED BY	J.I.R. 3-7-57	ENGINEERING	J.I.R. 3-7-57	ASSISTANT CHIEF IN CHARGE	2	5
DATE	J.I.R. 3-7-57	LANDSCAPE	J.I.R. 3-7-57	OF DESIGN	3	6

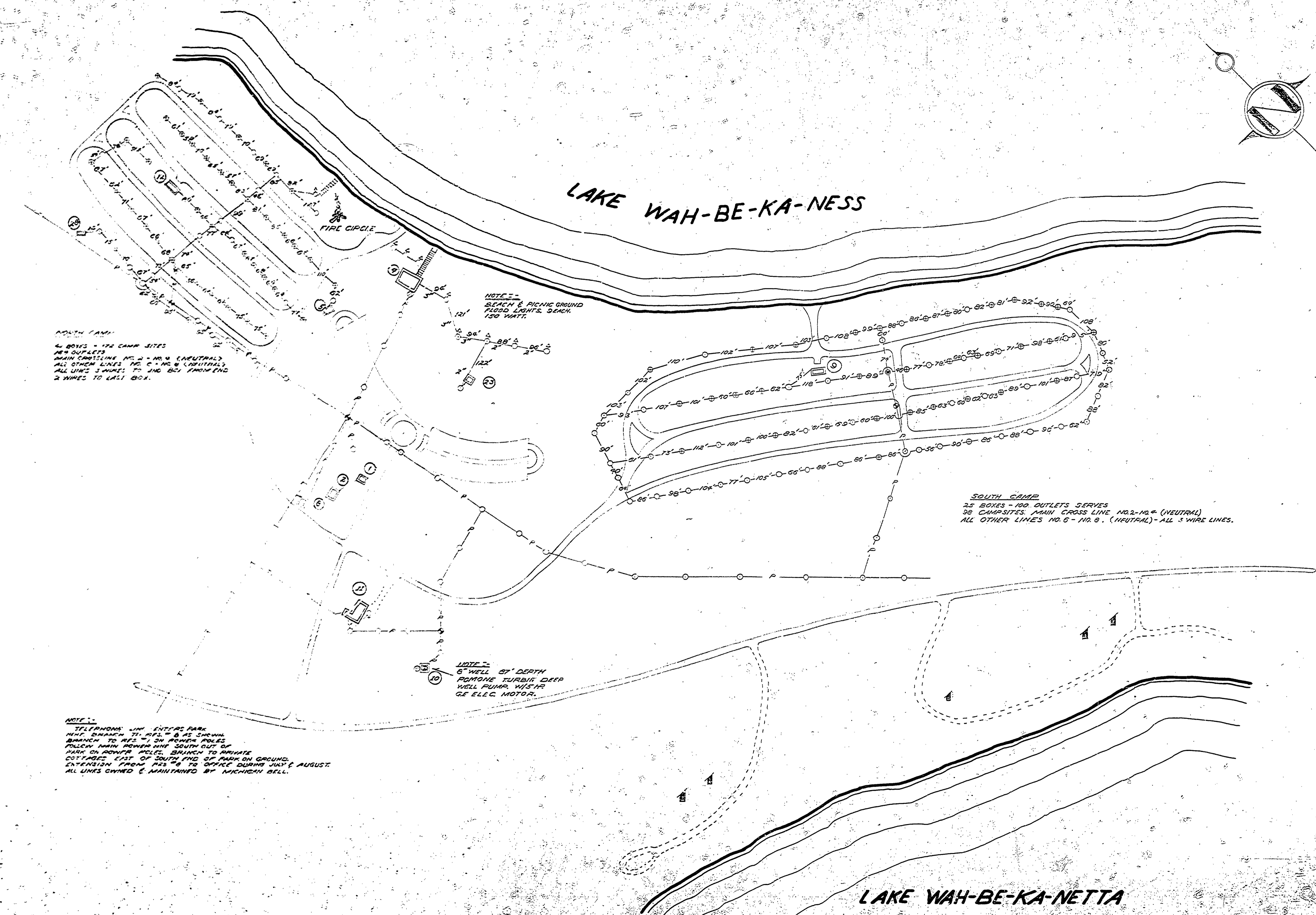

NOTE -
 SOUTH CAMP
 4 BOXES - 172 CAMP SITES
 183 OUTLETS
 MAIN CABLELINE NO. 2 - NO. 4 (NEUTRAL)
 ALL OTHER LINES NO. 6 - NO. 8 (NEUTRAL)
 ALL LINES 3 WIRES TO JUNG. BOX FROM END
 2 WIRES TO LAST BOX.

NOTE -
 BEACH & PICNIC GROUND
 FLOOD LIGHTS, SEACH
 150 WATT.

SOUTH CAMP
 25 BOXES - 100 OUTLETS SERVES
 98 CAMPSITES. MAIN CROSS LINE NO. 2 - NO. 6 (NEUTRAL)
 ALL OTHER LINES NO. 6 - NO. 8 (NEUTRAL) - ALL 3 WIRE LINES.

NOTE -
 6" WELL 57' DEPTH
 PUMPS TURBINE DEEP
 WELL PUMP, W/STHR
 GE ELEC. MOTOR.

NOTE -
 TELEPHONE LINE ENTIRE PARK
 USE BRANCH "T" POLE & AS SHOWN
 BRANCH TO #12 IN POWER POLES
 FOLLOW MAIN POWER LINE SOUTH OUT OF
 PARK ON POWER POLES BRANCH TO PRIVATE
 COTTAGES EAST OF SOUTH END OF PARK ON GROUND.
 EXTENSION FROM #12 TO OFFICE DURING JULY & AUGUST.
 ALL LINES OWNED & MAINTAINED BY MICHIGAN BELL.

LEGEND

- ⊙ GAS PUMP
- UTILITY POLE
- CONSUMER POWER LINE
- OUTLET BOX
- ⊕ METER
- ⊖ METER & SWITCH 200 AMP
- ⊗ TRANSFORMER POLE
- ⊕ FLOOD LIGHT
- STEPS
- TELEPHONE LINE
- LT. & S. LAUNDRY TOILET & SHOWER
- ⊕ PIT TOILET
- W.S. WORK SHOP

BLDG. NO.	DESCRIPTION	DIM.
#1	RESIDENCE	24' X 27'
#2	MISC. STORAGE	
#8	RESIDENCE	26' X 32'
#10	PUMP HOUSE	11' X 18'
#11	OFFICE - GAR. & W.S.	126' X 32'
#25	PICNIC TOILET	20' X 30'
#5	PICNIC TOILET	20' X 30'
#9	LT. & S.	21' X 48'
#12	LT. & S.	
#4	BATHHOUSE	32' X 66'
#28	FISHHOUSE	

GRAND TRAVERSE COUNTY SCALE 1" = 150'

MICHIGAN DEPARTMENT OF CONSERVATION
 PARKS AND RECREATION DIVISION

UTILITY MAP
 INTERLOCHEN STATE PARK
 ELECTRIC SYSTEM

SHEET NO.	PLAN NO.
4	10
OF 4	