

DATE	1-12-52
CHECKED BY	L. M. C.
TRACED BY	L. M. C.
DRAWN BY	L. M. C.
REVIEWED BY SECTIONS	J.T.R. / H.C.H. / J.I.R.
ARCHITECTURAL	
ENGINEERING	
LANDSCAPE	
DATE	1-29-52
APPROVED BY	ASST. MGR. IN CHARGE
NO. DATE	1 11-12-52 L.M.C. M-137 ENTRANCE ROAD & PARKING
	2 1-16-52 F.J.V. ADD PRIMITIVE CAMPING AREA
	3 1-1-52 R.D.G. TRUSSING AREA, PRIMITIVE CAMPING AREA, BOAT LAUNCH ROAD, ADMINISTRATION
REVISIONS	4 BOAT LAUNCH AREA / PARKING OVERLAP
	5
	6
DATE BY	1-14-52

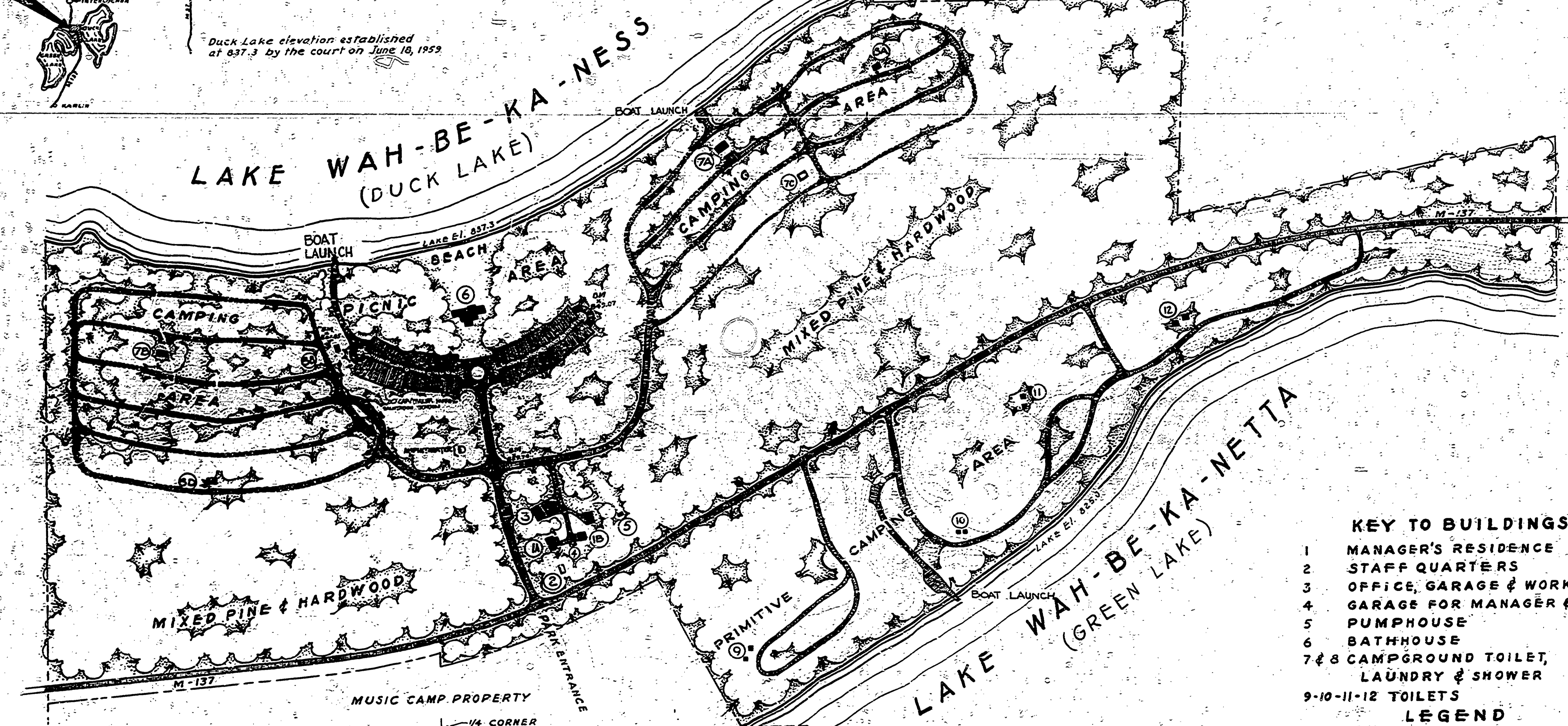
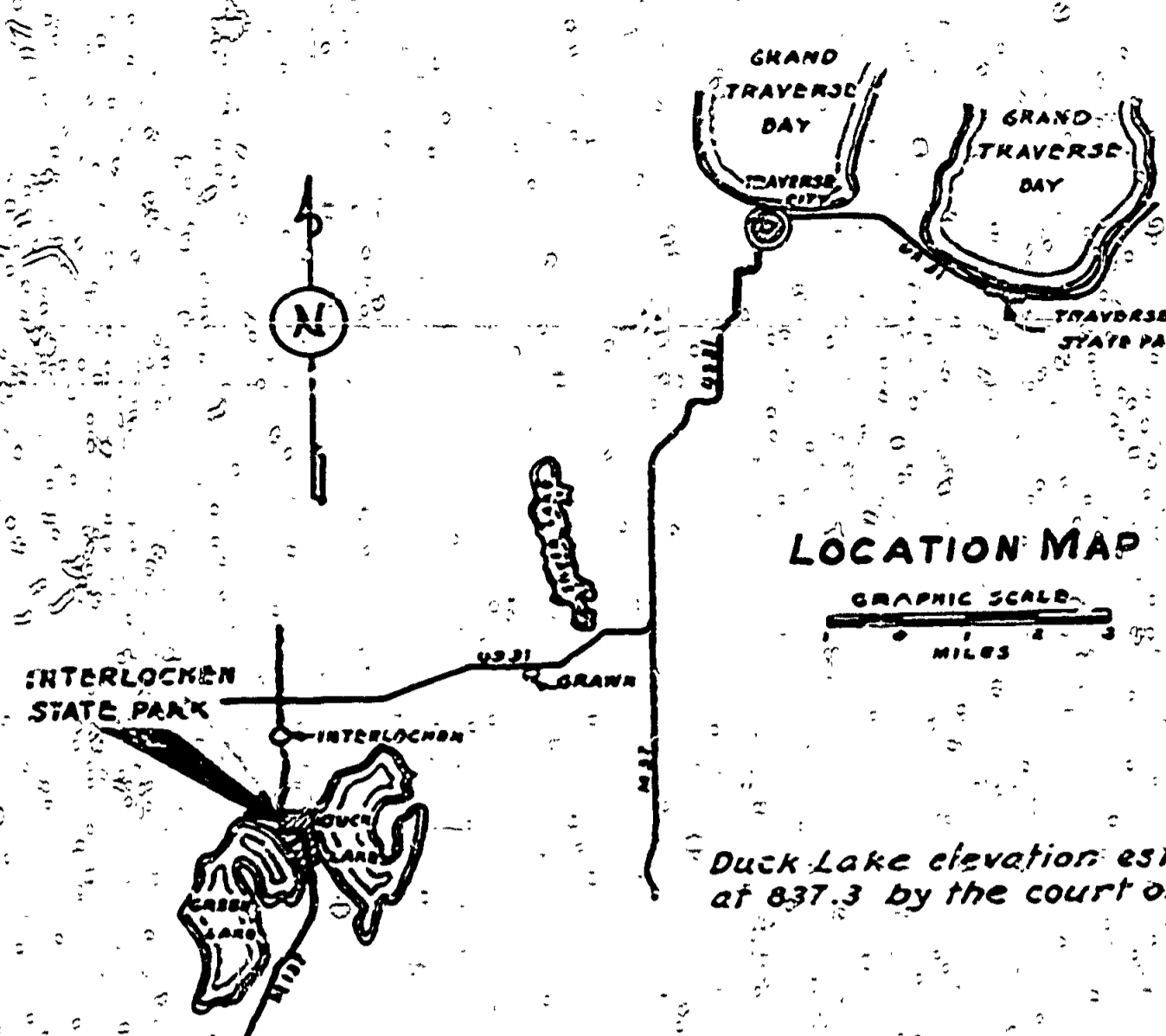

USE AREAS
 DAY-USE PARKING FOR 250 CARS.
 CAMPING AREA FOR 455 LOTTED SITES.
 PRIMITIVE CAMPING AREA 26 ACRES.
 DUCK LAKE FRONTAGE OF 3200 FEET.
 GREEN LAKE FRONTAGE OF 3400 FEET.
 PICNIC AREA OF 7 ACRES.
 TOTAL ACRES - 187.40

- KEY TO BUILDINGS**
- 1 MANAGER'S RESIDENCE
 - 2 STAFF QUARTERS
 - 3 OFFICE, GARAGE & WORKSHOP
 - 4 GARAGE FOR MANAGER & STAFF
 - 5 PUMPHOUSE
 - 6 BATHHOUSE
 - 7 & 8 CAMPGROUND TOILET, LAUNDRY & SHOWER
 - 9-10-11-12 TOILETS
- LEGEND**
- BUILDINGS - EXISTING
 - BUILDINGS - PROPOSED
 - 🌲 MIXED TREE COVER
 - 🌳 LAWN AREAS
 - PARK BOUNDARY
 - == ROADS

SCALE - 1" = 200'

MICHIGAN
DEPARTMENT OF CONSERVATION
PARKS AND RECREATION DIVISION

THE MASTER PLAN
INTERLOCHEN STATE PARK

SHEET NO. 1 OF 1
PLAN NO. L-100