

INTERLOCHEN STATE PARK
 ENTRANCE ROADS, CAMPGROUND ROADS,
 PARKING AREAS, AND EARTH FILL.

PROJECT NO. 52-105-2C.

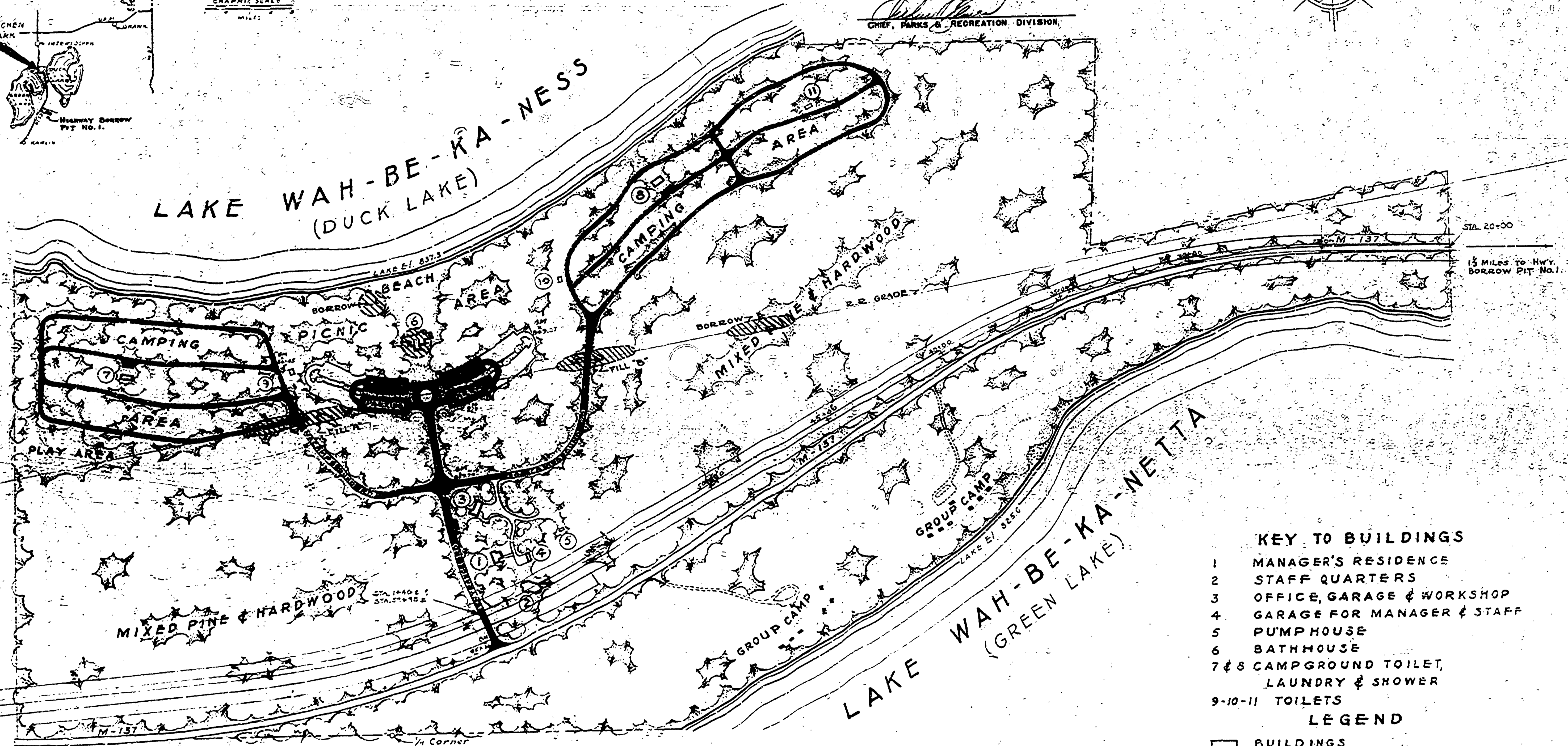
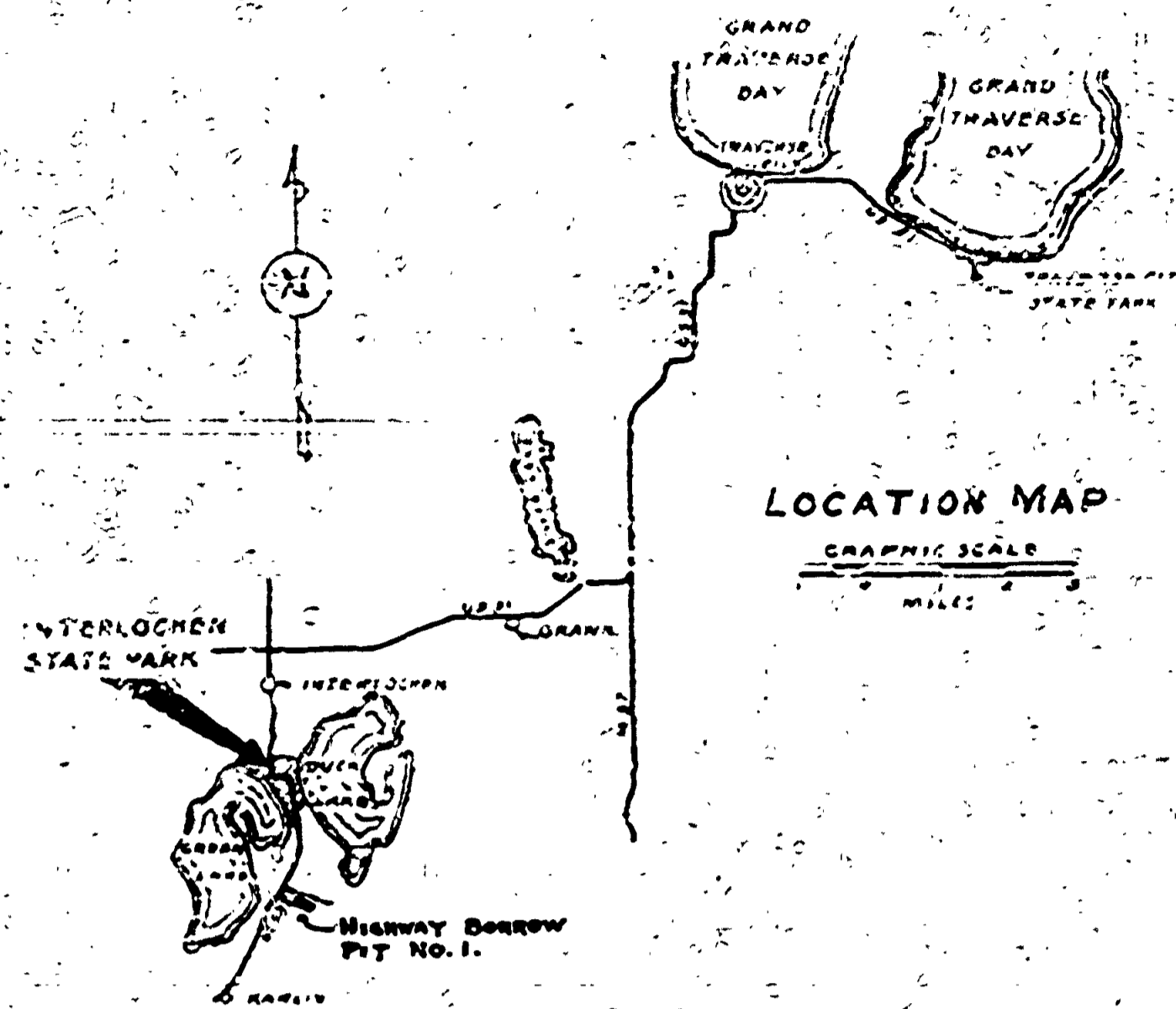
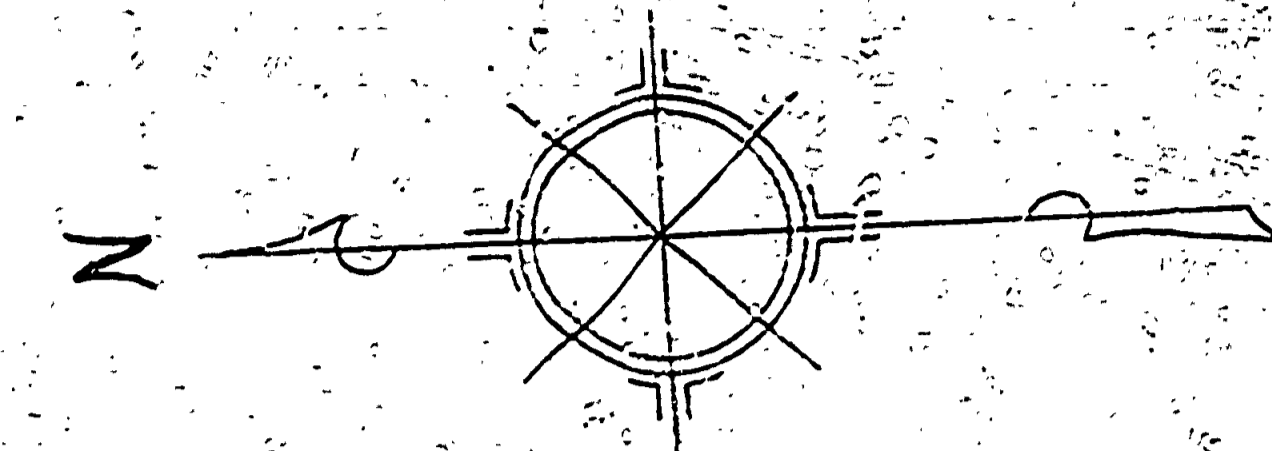

- KEY TO BUILDINGS**
- 1 MANAGER'S RESIDENCE
 - 2 STAFF QUARTERS
 - 3 OFFICE, GARAGE & WORKSHOP
 - 4 GARAGE FOR MANAGER & STAFF
 - 5 PUMPHOUSE
 - 6 BATHHOUSE
 - 7 & 8 CAMPGROUND TOILET, LAUNDRY & SHOWER
 - 9-10-11 TOILETS
- LEGEND**
- [Rectangle] BUILDINGS
 - [Double Line] ROADS
 - [Starburst] MIXED TREE COVER
 - [Wavy Line] LAWN AREAS
 - [Dashed Line] PARK BOUNDARY

DATE	11-12-52			
CHECKED BY	L.M.C.			
DESIGNED BY	L.M.C.			
APPROVED BY	J.T.K.			
DATE	11-12-52			
REVIEWED BY	J.T.K.			
SECTION	ARCHITECTURAL			
NO.	1			
DATE	11-12-52			
BY	J.T.K.			
IN CHARGE	H.C.M.			
DATE	11-12-52			
NO.	1			
DATE	11-12-52			
BY	J.T.K.			
REVISIONS				
NO.	1	11-12-52	L.M.C.	ENTRANCE ROAD & PARKING
NO.	2			
NO.	3			
NO.	4			
NO.	5			
NO.	6			

RELOCATION M-137
 MAY 12 1953

SCALE - 1" = 200'

MICHIGAN
 DEPARTMENT OF CONSERVATION
 PARKS AND RECREATION DIVISION

INTERLOCHEN STATE PARK

SHEET NO. 1 OF 6
 PLAN NO. L-105