

BM #7 - Elev. 849.21
 Nail in 16" pine stump
 33' left of station 11+38
 BM #9 - Elev. 849.07
 Nail in root of 12" oak 33'
 left of station 5+27 on
 South Parking
 BM #11 - Elev. 861.83
 Nail in root of 12" oak 36'
 right of station 9+48 on
 north campground
 entrance road

CURVE DATA (South Parking)
 $\Delta = 31^{\circ}30'$
 $D = 0'$
 $T = 202.16$
 $L = 393.75$
 $R = 716.19$
 $E = 27.9$
 $PC = 0+61.8$
 $PI = 2+64.0$
 $PT = 4+45.35$

CURVE DATA (North Parking)
 See South Parking Curve Data

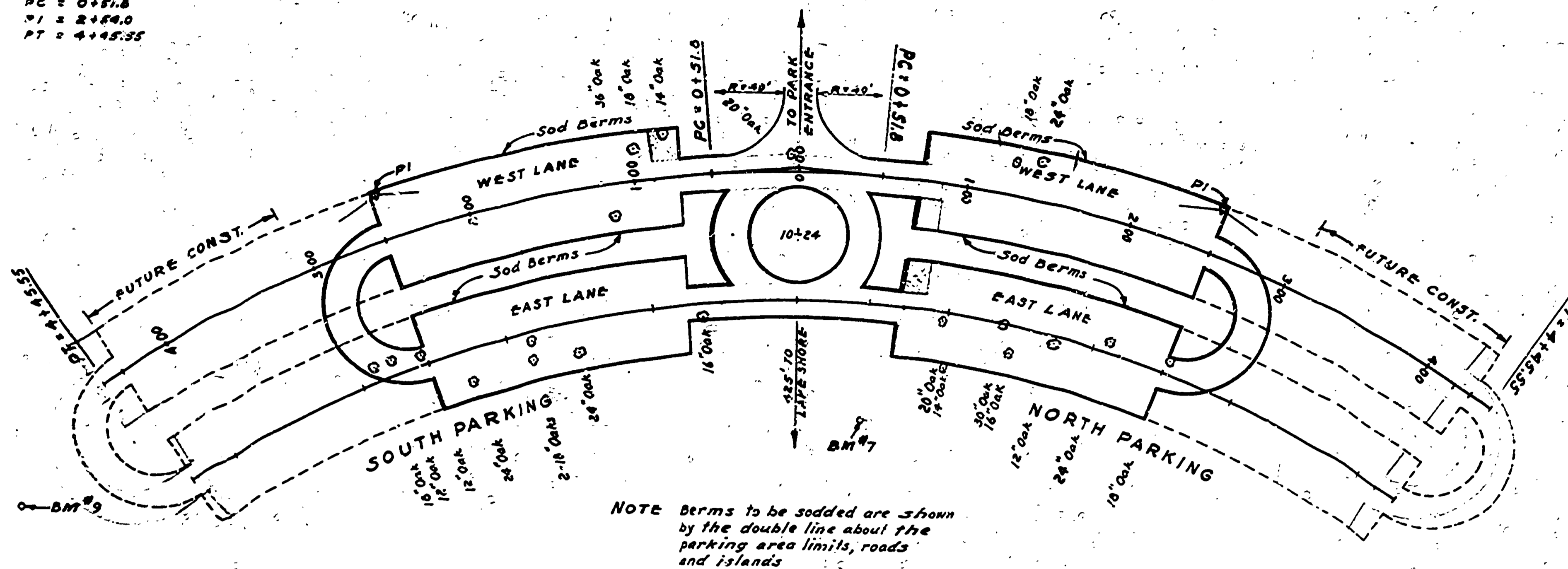

PARKING AREA
 SCALE - 1" = 50'

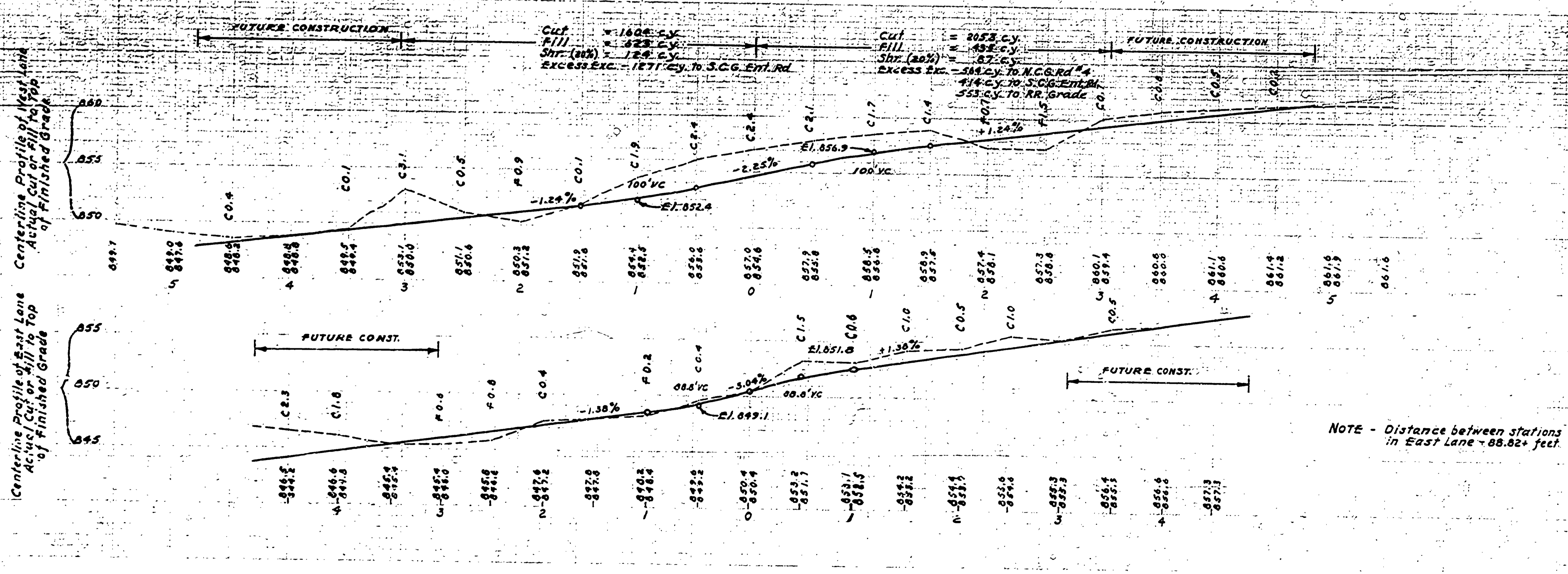

NOTE - Distance between stations
 in East Lane = 88.82+ feet.

SCALE - AS SHOWN

MICHIGAN
 DEPARTMENT OF CONSERVATION
 PARKS AND RECREATION DIVISION

INTERLOCHEN STATE PARK
 PARKING AREA
 PLAN & PROFILE

SHEET NO. 5 OF 8
 PLAN NO. L-105

NO.	DATE	BY	REVISIONS
1			
2			
3			

APPROVED BY	DATE	REVIEWED BY SECTIONS
<i>[Signature]</i>	3-23-53	ARCHITECTURAL ENGINEERING LANDSCAPE

DATE	BY
11-12-52	L.M.C.