

|         |           |                                                             |             |                      |                 |
|---------|-----------|-------------------------------------------------------------|-------------|----------------------|-----------------|
| DATE BY | REVISIONS | NO DATE BY                                                  | APPROVED BY | REVIEWED BY SECTIONS | DRAWN BY        |
|         | 4         | 1 1/27/60 SDR. SERVICE AREA, RESIDENCE, ROAD RECONSTRUCTION |             | ARCHITECTURAL        | F.J.W. 10-28-60 |
|         | 5         | 2 1/27/60 SDR. SERVICE AREA, RESIDENCE, ROAD RECONSTRUCTION |             | ENGINEERING          |                 |
|         | 6         | 3 1/27/60 SDR. SERVICE AREA, RESIDENCE, ROAD RECONSTRUCTION |             | LANDSCAPE            |                 |
|         |           |                                                             |             |                      |                 |

L A K E H U R O N

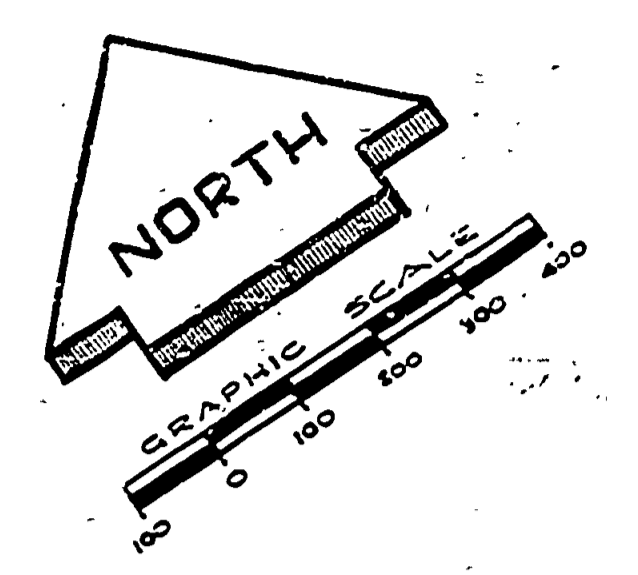

299.74 ACRES

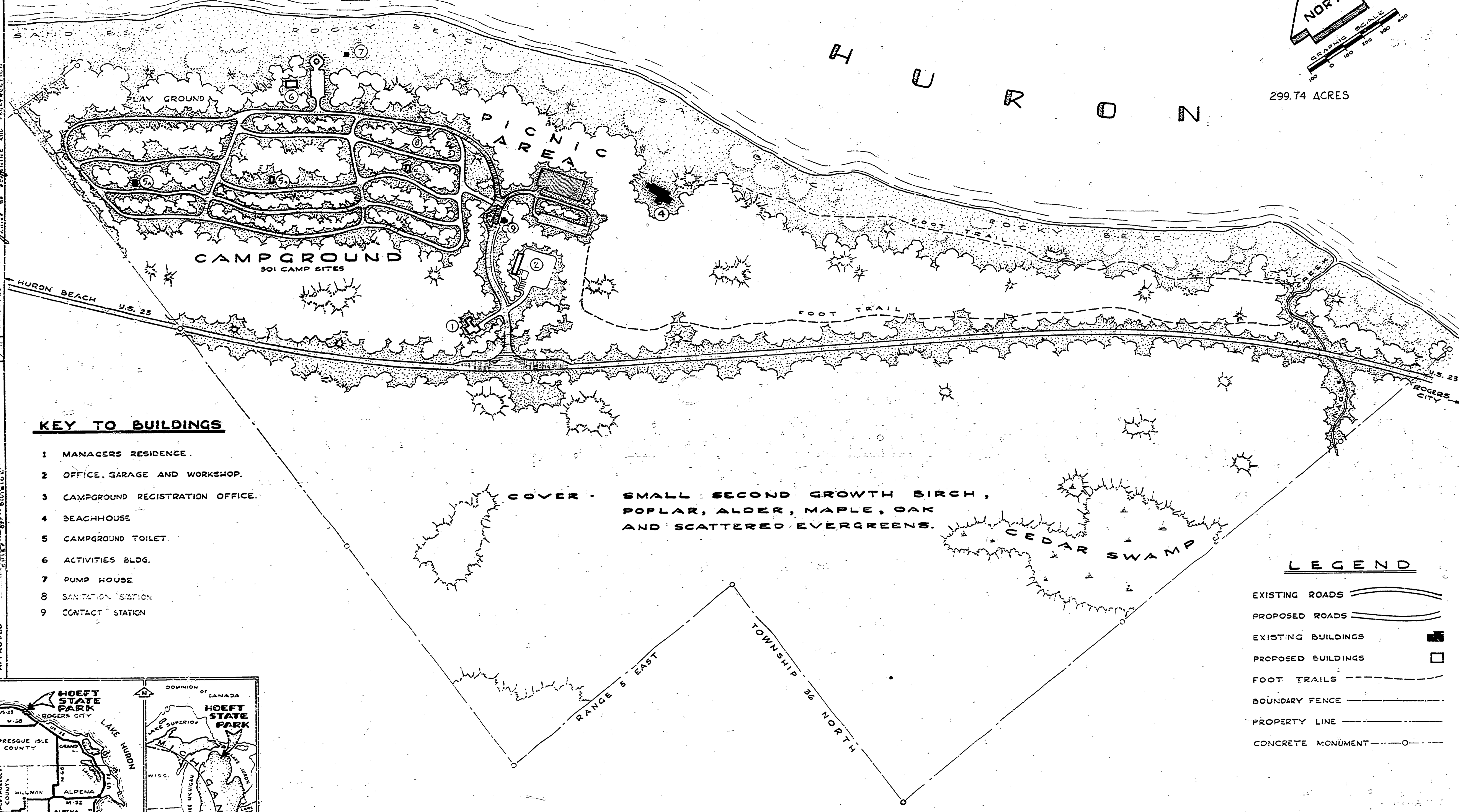

**KEY TO BUILDINGS**

- 1 MANAGERS RESIDENCE.
- 2 OFFICE, GARAGE AND WORKSHOP.
- 3 CAMPGROUND REGISTRATION OFFICE.
- 4 BEACHHOUSE
- 5 CAMPGROUND TOILET.
- 6 ACTIVITIES BLDG.
- 7 PUMP HOUSE
- 8 SANITATION STATION
- 9 CONTACT STATION

COVER - SMALL SECOND GROWTH BIRCH, POPLAR, ALDER, MAPLE, OAK AND SCATTERED EVERGREENS.

**LEGEND**

- EXISTING ROADS
- PROPOSED ROADS
- EXISTING BUILDINGS
- PROPOSED BUILDINGS
- FOOT TRAILS
- BOUNDARY FENCE
- PROPERTY LINE
- CONCRETE MONUMENT

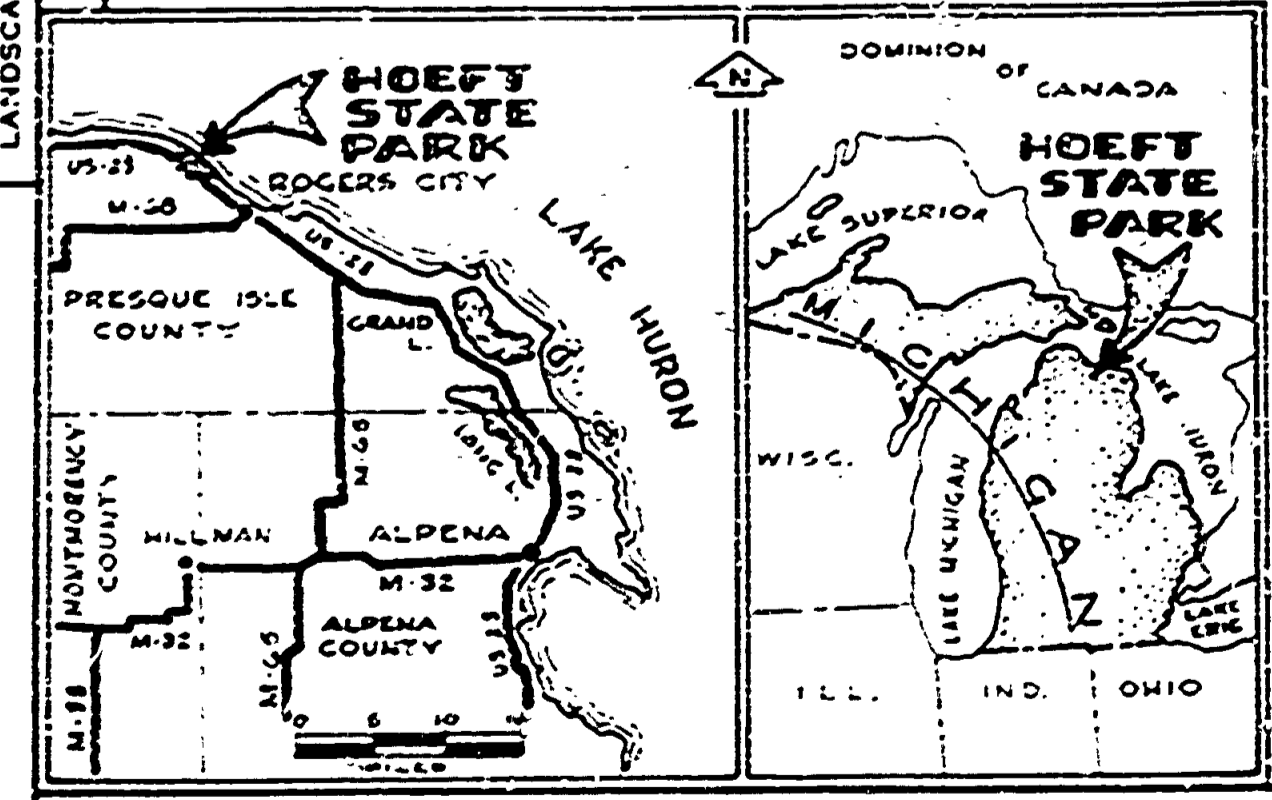

MICHIGAN  
DEPARTMENT OF CONSERVATION  
PARKS AND RECREATION DIVISION

**HOEFT STATE PARK**  
**MASTER PLAN**  
SCALE 1" = 200'

SHEET  
NO. 1  
OF 1

PLAN NO.  
**L-100**