

DESIGNED BY	DATE	REVIEWED	DATE	APPROVED	DATE	NO.	DATE	BY	REVISIONS
BY A.M.C.	MAY '63	ARCHITECTURAL	7/11/63		1				4 Revised as Built
DRAWN BY D.M.C.	FEB '63	ENGINEERING	8/1/63		2				5
CHECKED BY		LANDSCAPE	8/27/63		3				6

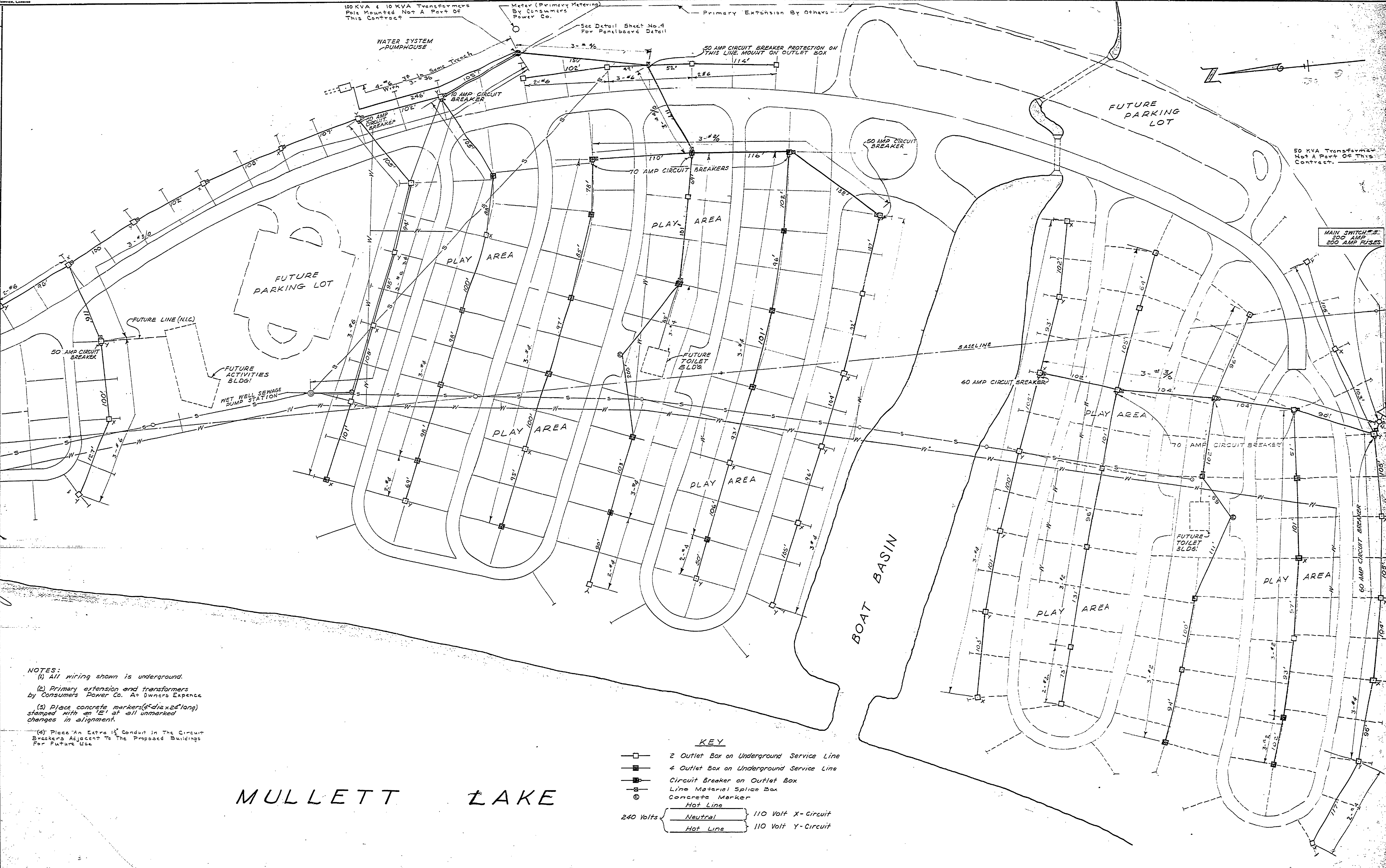

NOTES:
 (1) All wiring shown is underground.
 (2) Primary extension and transformers by Consumers Power Co. At Owners Expense
 (3) Place concrete markers (4" dia x 24" long) stamped with an 'E' at all unmarked changes in alignment.
 (4) Place an Extra 1/2" Conduit in the Circuit Breakers Adjacent to the Proposed Buildings for Future Use.

KEY

- 2 Outlet Box on Underground Service Line
- 4 Outlet Box on Underground Service Line
- ⊠ Circuit Breaker on Outlet Box
- ⊞ Line Material Splice Box
- ⊙ Concrete Marker
- ⊕ Hot Line

240 Volts: Neutral 110 Volt X-Circuit
 Hot Line 110 Volt Y-Circuit

MULLETT LAKE

MICHIGAN DEPARTMENT OF CONSERVATION PARKS AND RECREATION DIVISION

ALOHA STATE PARK ELECTRICAL DISTRIBUTION SYSTEM
 SCALE 1" = 50'

SHEET NO. 3 OF 5 PLAN NO. E100